

How to Download Record Template

To use this record template the user must make a copy. Please follow the five steps below.

Step 1: Select File

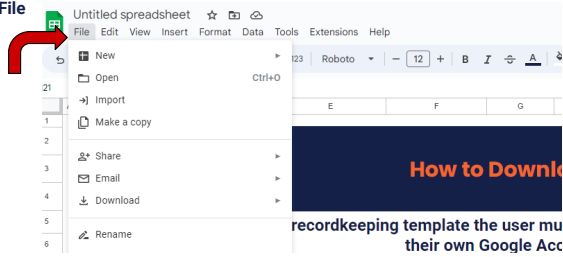

Step 2: Select Make a copy

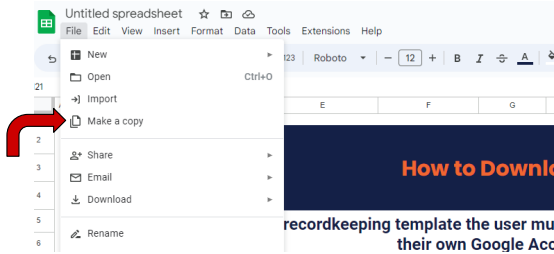

Step 3: Name the File

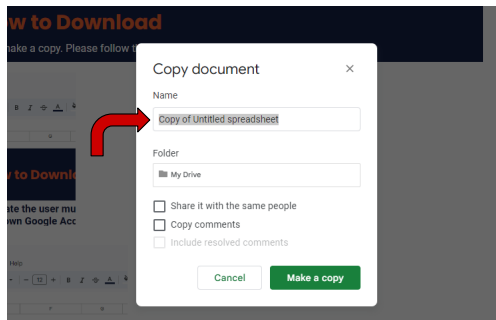

Step 4: Select the File Location

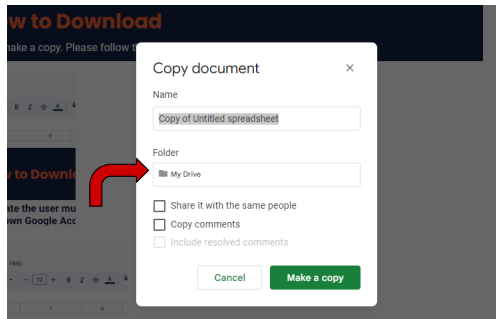

Step 5: Select Make a copy

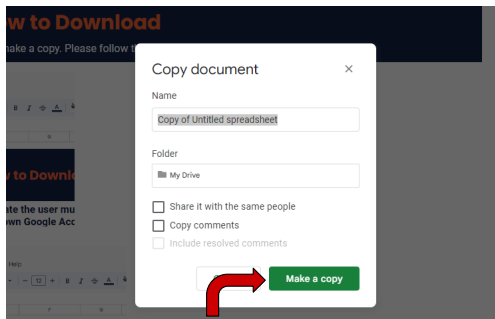

Hover over cells with black in the upper right corners to view helpful notes.
The Operations cell is an example.

To access record logs, select the tabs below or click the links in the table.

You can delete tabs you do not need by right clicking on the tab and selecting Delete. Please note this action cannot be undone!

Instructions:

Review the operations your facility conducts and maintain the associated record logs.
Not all record logs are required. Only use the record logs applicable to your operations.

Operations: [1]	Record Logs:
Asphalt Kettle Operations	Asphalt 12-Month Rolling
Nonroad Engine	Nonroad Engine Location Log
Dust Control (parking and staging areas over 0.10 acre)	Rule 310 Dust Control Logs
	Rule 310 Certified Employees
	Rule 310 Subcontractor List



Rule 310 Daily Self-Inspection Dust Logs

Keep a record of self-inspection on each day dust-generating operations are conducted.

Date:	Inactive:	Soil Stable:	Control Method:	Control Application:	Control Frequency:	Control Amount (gal):	Trackout Control Device Maintenance:	Trackout Present:	Trackout Cleanup:



[1]

When you hover over cells with red corners you can view helpful notes.

[2] The cells in this column will turn yellow if the asphalt 12-month rolling total reaches 90% of the permitted threshold of 6,000 tons/12-months.

The cells in this column will turn red if the asphalt 12-month rolling exceeds the permitted threshold of 6,000 tons/12-months. If the cells turn red a new permit is required, contact the Business Assistance Unit as soon as possible at 602-506-5102.

[3] The cells in this column will turn red if an employee's certificate expires. Certificates expire every three years.

If the cells turn red, ensure the employee retakes the appropriate Rule 310 Dust Control Training. For more information visit www.Maricopa.gov/1875.