

Bombs Away

Rank 4 Encounter

Created by Tate RF

Summary. Bombshell and Electro have been hired by Hammerhead to retrieve a large sum of gambling money owed to him by Marcus Toomes, brother of The Vulture. Finding Marcus at his bar, The Buzz'd Buzzard, the two supervillains have begun tearing the building apart in search of the business' safe.

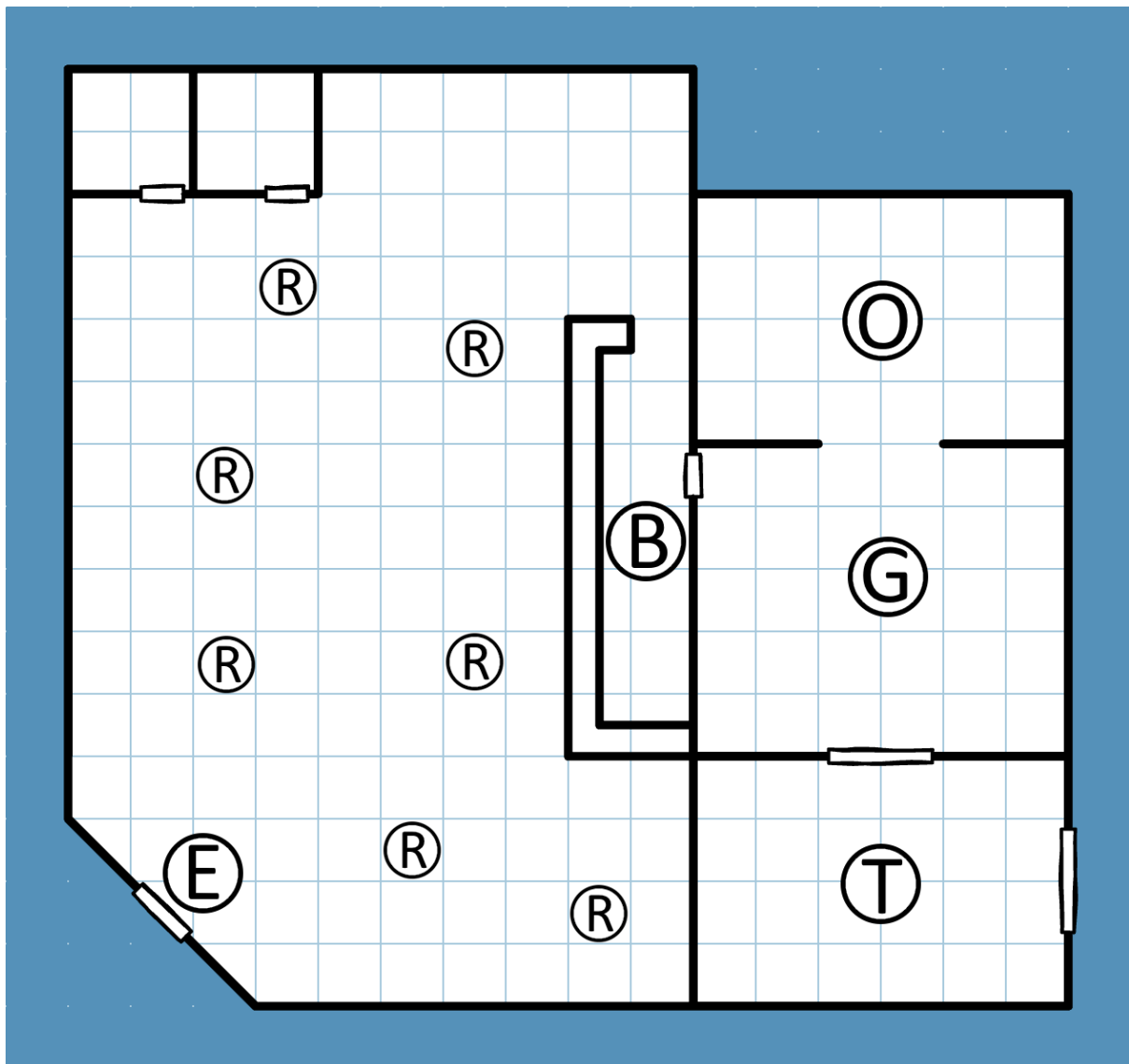

Combatants. Bombshell (Lori Baumgartner) is fighting a group of 3x Goons [Use Shield Agent] in the main bar. Electro (Francine Frye) and Marcus Toomes [Use Average Citizen] are in Marcus' office searching for the safe. If she hears powers other than Bombshell's coming from the bar, she will spend a round picking up Marcus before coming out and using him as a hostage. Three rounds after the heroes arrive, Vulture (Adrian Toomes) and 5x Vulture Goons will fly in through the front entrance searching for Vulture's brother.

Buzz'd Buzzard Features

E - Entrance. The bar's front entrance has been blasted open by Bombshell.

B - Bar. Almost fifty patrons were in the bar when the supervillains attacked. The mass of panicked people make every square of the bar difficult terrain for the first 2 rounds.

G - Gambling Room. Marcus is a gambling addict and has gone thousands into debt due to loans from Hammerhead, figuring his brother's name alone was enough to keep him safe. Marcus has even opened a small gambling den in his bar made up of a half-dozen card tables.

O - Office. Though this is Marcus' bar he rarely ever uses his office. Instead, his brother has mostly been using it as a fake address for his legitimate businesses. Thanks to Electro almost the entire office has been destroyed.

T - Truck. Marcus was preparing to move his safe to his brother's hideout when the two supervillains attacked. He placed the safe on his truck in the loading bay and flees there before driving off at the first opportunity.

R - Rubble. This represents various tables, chairs, bits of fallen ceiling, and other debris. Characters with only a run speed cannot move through these squares. Additionally, Bombshell can target this rubble with her explosions. If she does, the rubble is destroyed and her attack targets everyone within 2 squares of the exploded rubble.

Appendix

NAME: Bombshell (Lori Baumgartner)



RANK **4** HEALTH **150** DR: 2 FOCUS **150** DR: 2

ABILITIES	
ABILITY SCORE	DEFENSE SCORE
2 MELEE	12
3 AGILITY	13
5 RESILIENCE	15
5 VIGILANCE	15
7 EGO	16
1 LOGIC	11

DAMAGE	
AGILITY MELEE	EGO
 x 4 + 2	 x 7 + 6
AGILITY LOGIC	EGO
 x 6 + 3	 x 4 + 1

POWERS

Accuracy 2, Combat Trickery, Discipline 3, Flight 1, Sturdy 2, Uncanny 2, Wisecracker, Ele. Burst (Force), Ele. Blast, Ele. Push, Ele. Ricochet, Ele. Barrage, Supernova

TRAITS & TAGS

Convict, Fearless, Glibness

ITEMS

NAME: Electro (Francine Frye)



RANK **4** HEALTH DR: FOCUS DR:

ABILITIES	
ABILITY SCORE	DEFENSE SCORE
1 MELEE	11
5 AGILITY	15
4 RESILIENCE	14
6 VIGILANCE	16
7 EGO	17
2 LOGIC	17

DAMAGE	
AGILITY MELEE	EGO
 x 4 + 1	 x 4 + 7
AGILITY LOGIC	EGO
 x 4 + 5	 x 4 + 2

POWERS

Flight 2, Wisdom, Ele. Burst (Electricity), Ele. Blast, Ele. Barrier, Ele. Barrage, Ele. Protection 3, Ele. Push, Ele. Reinforcement, Ele. Ricochet, Ele. Form, Supernova

TRAITS & TAGS

Eidetic Memory, Anathema (water)

ITEMS

NAME: Vulture Goon



RANK **1** HEALTH **30** DR: FOCUS **30** DR:

ABILITIES	
ABILITY SCORE	DEFENSE SCORE
1 MELEE	11
2 AGILITY	12
1 RESILIENCE	11
1 VIGILANCE	11
0 EGO	10
0 LOGIC	10

DAMAGE	
AGILITY MELEE	EGO
 x 1 + 1	 x 1 + 0
AGILITY LOGIC	EGO
 x 1 + 2	 x 1 + 0

POWERS

Flight 1, Fast Strikes, Chain Strikes, Grappling Technique

TRAITS & TAGS

Tech Reliance

ITEMS