

Infinite Campus - Upload SPED Profile

Open the Sped Profile document in Google Docs

- Go to File
- Download
 - Choose PDF

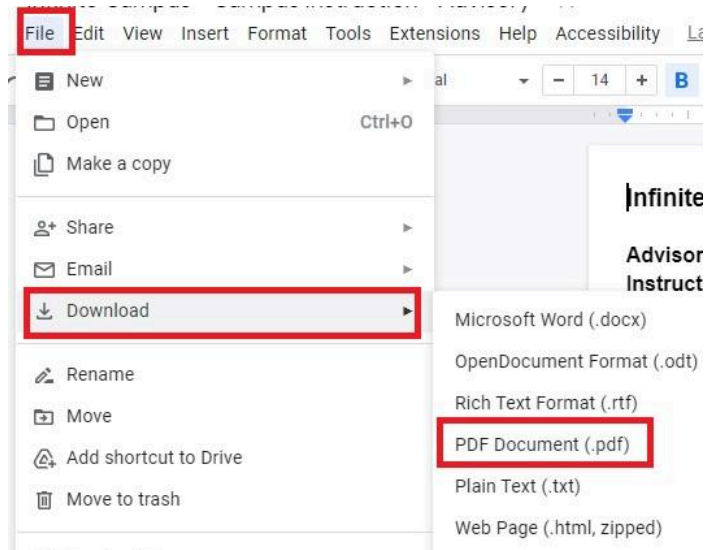

Open Infinite Campus

- Expand Student Information
- Choose Person Documents.

****Note**** When naming files to upload to Infinite Campus - the name can NOT contain characters such as . / , * , etc....

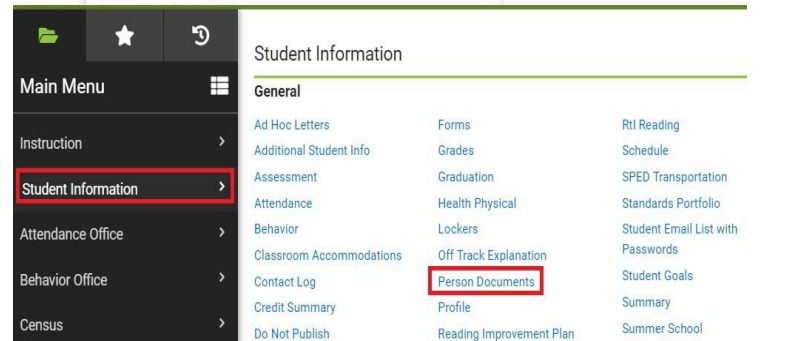

- Select Upload Document

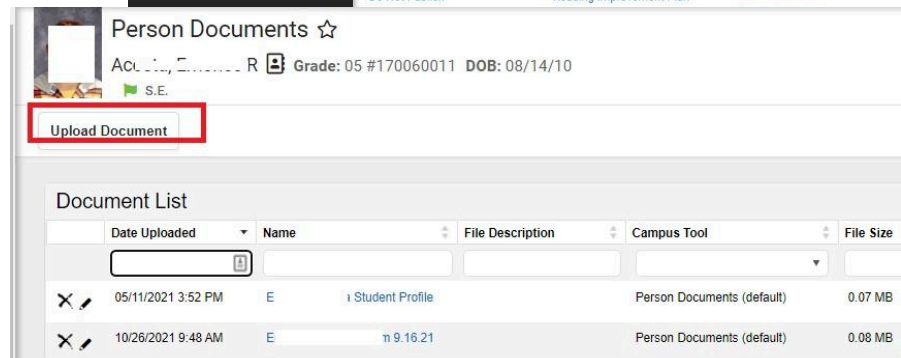

- Select Add Files
- Find the Profile documents you want uploaded
- Fill in the Description - SPED Profile
- Select Upload

