

Society for the Study of Measurement (SSM)  
Inaugural Conference  
Agenda & Maps  
July 27, 2024

**Dates:** August 4-August 8, 2024

**Location:** Berkeley Way West Building  
University of California, Berkeley  
2121 Berkeley Way West  
Berkeley, CA 94720  
USA

**Rooms:** 1<sup>st</sup> Floor: 1102, 1215  
4<sup>th</sup> Floor: 4101, 4310, 4500



**Pre-conference Workshop Day (4 August)**

Note: All workshops are in-person

9:00-12:00 Workshop A, Room 4500  
Measurement Across the Sciences Workshop  
Luca Mari & Mark Wilson

9:00-1:00 Workshop C, Room 4310  
Open Strategy Workshop: Developing AI-powered Futures for Learning & Work  
Luciano Oviedo & Tiburon Batriedo

1:30-4:30 Workshop D, Room 4500  
Learning Machines and Measurement-Related Issues Workshop  
Alessandro Giordani, Luca Mari & Mark Wilson

2:30-4:30 Workshop E, Room 4101  
ACER ConQuest Software Workshop  
Perman Gochyyev

## **Day 1 (5 August)**

- 7:45            Registration Desk is open on the ground floor of the BWW Building
- 8:15-8:45      Opening Session, Room 1102  
Welcome: Michelle Young, Dean of the Berkeley School of Education
- 8:45-9:30      Invited Talk 1, Room 1102: Chair, Eran Tal  
Patient Centered Measurement  
Leah McClimans  
University of South Carolina, USA
- 9:35-11:05    Session 1A & 1B
- 1A, Room 1102. Measurement and Data Science: Chair, Alessandro Giordani  
Philosophical Challenges with Using Deep Learning to Measure Animal Behavior in Neuroscience  
Nedah Nemati, Andrew Matheson  
Columbia University, USA  
Rethinking the Relationship Between Measurement and Simulation  
Alessandro Giordani, Luca Mari  
Università Cattolica del Sacro Cuore di Milano, Italy  
Machine-Learning for Explanatory Educational Measurement: Combining the Power of Decision Trees and the Four-Building Blocks for Auto-Scoring  
Yunting Liu, Alexis Ava Fernandez, Cindy Zhang, Yijun Xiang, Alexis Ava Fernandez, University of California, Berkeley, USA
- 1B, Room 1215. Educational and Psychological Measurement Applications, I: Chair, Yukie Toyama  
When Knowledge Measures Need Epistemological Frameworks & How to Build Valid Knowledge Items: Insights from a Validation of Teachers' Propositional Knowledge of Dyslexia and Dyslexia Screening  
Tyler Ogata, Jill Yochim  
UC Berkeley, USA  
Identification of Measurement Disturbances in Affective Item Types  
Judy R. Wilkerson, W. Steve Lang  
University of South Florida, USA  
An Item Response Theory Analysis of The Implicit Theories of Intelligence Scale in Teachers of a Developing Country  
Carmen Maura Taveras  
Pontificia Universidad Católica de Chile, Chile
- 11:05-11:35   Morning Break (30 mins.) Coffee etc. in the Foyer
- 11:35-1:05    Sessions 2A & 2B
- 2A, Room 1102. Measurement Applications: Chair, Svetlana Beltyukova  
Validation of a French-speaking Version of Motivated Strategies for Learning

Nadine Talbot

Université du Québec à Trois-Rivières, Canada

Validating the Construct Specification Equation and Gross Motor Unit as a Universal Measurement Scale and Standardized, Reproducible Unit for Gross Motor Development

Bryant Seamon, Cindy L. Sears, Emily Anderson, Craig A. Velozo

Medical University of South Carolina, USA

Rasch-Informed vs. Rasch-Based Objective Standard Setting: A Case Study of Designing and Validating an Assessment Tool to Measure Clinical Performance of Medical Students During their Clerkship Phase

Svetlana Beltyukova, Stephanie Mann, Rjat Kaul

The University of Toledo, USA

2B, Room 1215. Models in Measurement: Chair, Eunjung Myoung

Democratizing the Democratization of Measurement: From the Three Estates of Expertise to the Encounter of Values

Chris Borst

Dept. of Sociology, McGill University, Montreal, Canada

Phenomenological Measurement

Gabriel Siegel

Washington University, St. Louis, USA

A Keyword Network Analysis of Published Articles in the Journal of Educational Measurement From 1964 to 2024

Eunjung Myoung, Hyemin Park

Stanford University and University of California, Berkeley, USA

1:05-2:35 Lunch (on your own) and Posters: Ground Floor Foyer

History, Philosophy and Sociology of Measurement,

Chair: Alexander Blum

Defining the Theoretical and Empirical Domains of Structural Racism in American Schools

Norma Hancock, A. B. Fox, T. P. Hogan

MGH Institute of Health Professions, Boston, MA, USA

Communication of Measurement

Mona Wehming

Physikalisch-Technische Bundesanstalt (PTB), Berlin, Germany

Integrating Item Response Theory into Korea's CSAT: Challenges and Opportunities for Enhanced Educational Assessment

Hyemin Park, Eunjung Myoung

University of California, Berkeley, and Stanford University, CA, USA

Impact of Seasonality on Rasch Calibration and Equating

Chunyan Liu, Richard Feinberg, Raja Subhiyah

National Board of Medical Examiners, Philadelphia, PA, USA

An Interdisciplinary Approach to Measuring Well-Being in Office Spaces

Vivien Peltason, Jeanette Melin, Daniel Hutzschenreuter, Barbara Jung

Physikalisch-Technische Bundesanstalt (PTB), Berlin, Germany

2:35-4:05      Session 3 Spotlight, Room 1102:  
History, Philosophy and Sociology of Measurement Symposium: What's So Great about  
Uncertainty? Chair, Kent Staley

How Uncertainty Allows Measurement to Produce Useful Results

Pierre Hugues Beauchemin, Kent Staley

Tufts University, Medford, MA, USA; Saint Louis University, St. Louis, MO,  
USA

Quantum Uncertainty and Metrological Uncertainty

Jacques Pienaar, Eran Tal

University of Massachusetts, Boston, MA, USA; McGill University, Montreal,  
Quebec, Canada

Measurements of Carbon in Soil

Aja Watkins

University of Wisconsin-Madison, WI, USA

The Role of Uncertainty in the Measurement of Inequality

Alessandra Basso

University of Cambridge, UK

4:05-4:35      Afternoon Break (30 mins.) Coffee, etc. in the foyer

4:35-6:05      Sessions 4A & 4B

4A, Room 1102. Symposium: Modernizing vs Ecologizing? Implications of Measurement for  
Social and Economic Organization: Chair, William Fisher

Modern vs Unmodern Measurement and Science: Consequences for Co-Produced Social  
Orders

William Fisher

BEAR Center, UC Berkeley; Living Capital Metrics LLC, Sausalito CA USA

Use of the Activity Inventory in the Low Vision Rehabilitation Network

Robert Massof

Johns Hopkins University, Baltimore, MD, USA

False Dichotomies: Tensions & Opportunities for the Evolution of Scientific  
Measurement

Celeste Combrinck

University of Pretoria, South Africa

4B, Room 1215. Symposium: Back-End Construct Map Development using an Exploratory Item  
Response Modeling Approach: Chair, Jerred Jolin

Developing a Teacher Professional Development Progress Variable Using Exploratory  
Item Response Modeling

Jerred Jolin; College of Education; Department of Special Education; Eastern  
Oregon University, La Grande, OR, USA

Alexander Mario Blum; Stanford Graduate School of Education; Enrich Your  
Academics, Palo Alto, CA, USA

Proposing Construct Maps for Teacher Development of an Anti-Racism Value Stance  
Using Exploratory Item Response Modeling

Jerred Jolin; College of Education; Department of Special Education; Eastern  
Oregon University, La Grande, OR, USA



Alexander Mario Blum; Stanford Graduate School of Education; Enrich Your  
Academics, Palo Alto, CA, USA

Mark Wilson; Graduate School of Education; University of California, Berkeley  
Uncovering Patterns of Difficulty in Oral Production of Inflected Words Among Students  
with Dyslexia Compared to Typical Readers

Robin Irey, Alexander Blum, Jet Vonk, Marilu Gorno-Tempini  
UC San Francisco, CA, USA

6:30 Happy Hour (no-host bar)

Cornerstone Berkeley  
2367 Shattuck Ave, Berkeley, CA 94704-1552

## Day 2 (6 August)

8:15-8:30 Day 2 Orientation, Room 1102

8:30-10:00 Sessions 5A & 5B

5A, Room 1102. Symposium: Rethinking Ongoing Debates in Measurement from the Perspective of Theory, Instrumentation, Scales & Units, Modeling: The TISM framework: Chair, David Torres Irribarra

The TISM Framework and Validity: Reinterpreting Longstanding Debates

Joshua McGrane

Assessment and Evaluation Research Center, University of Melbourne,  
Australia

The TISM Framework and the Concept of Multidimensionality

Derek Briggs

University of Colorado, Boulder, CO, USA

The TISM Framework and Reliability: Communicating Uncertainty in Human  
Measurement

David Torres Irribarra

Pontificia Universidad Católica de Chile, Chile

5B, Room 1215. Symposium: The Praxis of Measurement for Liberation towards the Development of the Soul of HBCU STEM Leadership Assessment: Chair, David Sul

The Theoretical Infrastructure for the Liberatory Praxis of Large-Scale Culturally  
Specific Assessment

David Sul

University of the Virgin Islands, USA

Putting Liberatory Measurement Theory into Practice: Constructing the CASL Soul of  
HBCU STEM Leadership Assessment

Angelicque Tucker-Blackmon

University of the Virgin Islands, USA

Reflection on the Liberatory Praxis of HBCU-Specific Assessment: HBCU Assessment  
Developers Reflect on their Journey towards Assessment Autonomy

David Sul, Angelicque Tucker-Blackmon, Kimarie Engerman, Elizabeth Jaeger

University of the Virgin Islands, USA

10:00-10:30 Morning Break (30 mins.) Coffee, etc. in the foyer

10:30-12:00 Sessions 6A & 6B

6A, Room 1102. History and Social Studies of Measurement: Chair, Bob Massof

Non-Epistemic Values in Health-Related Quality of Life Measurement Design

Sebastian Rodriguez Duque

McGill University, Canada

“Exacte measurynge, and speady reckenynge all maner lande [and] squared tymber”:

Innovation and Resistance in Early Modern Anglophone Measurement

Jennifer Egloff

NYU Shanghai, China  
Measurement in the Dictator Game: Constructs, validity and the threat of methodological artifact

Maria Jimenez-Buedo  
Logic, History and Philosophy of Science Dept. UNED-Madrid

6B, Room 1215. Models and their Assessment: Chair, Perman Gochyyev  
Have Validity Theories Run Their Course? A Model-Based, Metrological Alternative from a Psychometric Perspective  
Daniel Katz  
Northwest Education Association (NWEA), Beaverton, OR, USA

Towards a Model Agnostic Assessment of Metric Invariance  
Noah Padgett, Tyler VanderWeele  
Harvard University, USA  
Novel Psychometric Indicator Assessments: The Relative Excess Correlation and Associated Matrices  
Tyler VanderWeele, Noah Padgett  
Harvard University, USA

12:00-1:00 Lunch (on your own)

1:00-2:15 SSM Business Meeting, Room 1102.

2:15-2:30 Group Photo, Ground Floor Patio

2:30-4:00 Session 7, Room 1102:  
Spotlight: Issues in Measurement and Generative AI I. Chair, Namsoo Shin  
The Gen AI intern – Adventures in using ChatGPT as a measurement assistant  
Celeste Combrinck  
University of Pretoria, South Africa  
Utilizing Generative AI in Measurement Development: Under the Guidance of Mari et al.'s Hexagon Framework  
Perman Gochyyev, Mark Wilson, University of California, Berkeley, CA, USA  
Using Generative Artificial Intelligence to Measure Student Performance in Usable Knowledge  
Namsoo Shin, Sangeetha Suresh, Parisa Kordjamshidi, Joseph Krajcik  
Michigan State University, East Lansing, MI, USA

4:00-4:30 Afternoon Break (30 mins.) Coffee, etc. in the foyer

4:30-6:00 Sessions 8A & 8B  
8A, Room 1102. Structure in Measurement: Chair, Eran Tal  
Measurement and the Riddle of Factuality  
Eran Tal  
McGill University, Montreal, Quebec, Canada  
Measurement And Instrument Development in The Human Sciences

Mariam Thalos  
University of Tennessee Knoxville, USA  
Some Pathologies of Measurement in The Human Sciences  
Mark Wilson  
Berkeley School of Education, UC Berkeley, CA, USA

8B, Room 1215. Educational and Psychological Measurement Applications, II: Chair, David Sul  
On the Validity of Self-Report Surveys of Racial Discrimination

Morgan Thompson  
Cornell University, Ithaca, NY, USA

Causal Analyses of Discrimination

Florence Robinson Adams  
University of Cambridge, UK

The Problem of Isolating and Measuring Empathy

Riana Betzler  
San Jose State University, San Jose, CA, USA

7:00 Conference Dinner  
Faculty Club, UC Berkeley campus

### **Day 3 (7 August)**

8:30-8:45 Day 3 Orientation, Room 1102

8:45-9:30 Invited Talk 2, Room 1102: Chair, Mark Wilson  
Scaling and its Relationship with Measurement: Past, Present and Future  
Derek Briggs  
University of Colorado, Boulder, CO, USA

9:35-11:05 Session 9  
9, Room 1102. Epistemic Issues: Chair, Luca Mari  
Signposts on the Path from Nominal to Ordinal Scales  
Roza Nalbandyan, Ben Domingue  
Stanford University, USA  
Navigating Uncertainty --- Climate Models as Epistemic Tools  
Matthias Ackermann  
Leibniz Universität, Hannover, Germany  
Unit Standards: Towards a Realist Conventionalism about Measurement  
Gerald Teng  
University of Toronto, Canada

11:05-11:35 Morning Break (30 mins.) Coffee, etc. in the foyer

11:35-1:05 Sessions 10A & 10B  
10A, Room 1102. Philosophy of Measurement: Chair, Russell Almond  
The Intransitivity of Indifference  
James Norris  
University of Cambridge, UK  
Analogy and Measure: Overview of a Thomistic Approach to Measurement  
Thomas Ciavatti  
Center for Thomistic Studies, University of St. Thomas, TX, USA  
Context, Claims and Constructs in the Evidentiary Argument  
Russell Almond  
Florida State University, USA

10B, Room 1215. Educational and Psychological Measurement Applications, III: Chair,  
William P. Fisher, Jr.  
Do the Scales Measuring School Engagement have Equivalent Meaning for Students in  
Kindergarten, Primary and Secondary Education?  
Catalina Miranda  
Pontificia Universidad Católica de Chile, Chile  
The Role of Gender and Depressive Symptoms in Measuring Religiosity in Elderly  
Pawel Zagodzón, Kacper Jagiełło, Tomasz Zdrojewski  
Medical University of Gdansk, Poland

The Effect of 'Mathematics Self-Efficacy' Mediated by 'Effort and Persistence in Mathematics' on 'Mathematics Achievement' Using PISA 2022 Data: A Comparison of South Korea, the USA, and Finland

Sun-Geun Baek, Seojin Kim, Yunah Kang, Woori Song

Department of Education, Seoul National University, South Korea

1:05-2:35 Lunch (on your own) and Posters: Ground Floor Foyer

Narratives and Literacy: Chair, Smriti Mehta

Use of Narrative Story Production Assessment in a Universal Screener

Mónica Zegers, Lillian Durán, Cengiz Zopluoglu, Amy Pratt, Javier Jasso,

Gabriella Parham-Cruzado

University of California San Francisco, USA

Parents' Perceptions of the Importance of Phonics Instruction to Produce Proficient Readers

Qing Cai

University of California, Berkeley, USA

Measuring Adults' Digital Data and Safety Literacy (DDSL)

Shinyi Kang

Harvard Graduate School of Education, USA

Using Explanatory Item Response Models to Investigate Factors That Influence Word Recognition

Yukie Toyama, Elfrieda H. Hiebert, Robin Irey

University of California, Berkeley, USA

2:35-4:05 Session 11, Room 1102.

Spotlight: Validation and Explanatory Models: Chair, Florian Kaiser

Belonging in Science: A focus on the Construct

Linda Morell

University of California, Berkeley, USA

The Campbell Paradigm: A Model for Measuring Attitudes

Florian Kaiser, Mark Wilson

Otto-von-Guericke University Magdeburg, Germany

Measurement of Sensory Magnitudes: Reinterpretation of the Weber-Fechner Law

Robert Massof

Johns Hopkins University, USA

4:05-4:35 Afternoon Break (30 mins.) Coffee, etc. in the foyer

4:35-6:05 Session 12A & 12B

12A, Room 1102. On the Measurable and Immeasurable: Chair, Smriti Mehta

Which (If Any) Psychological Constructs Can Be Measured?

Smriti Mehta

University of California, Berkeley

Leibniz Against the Absolute View of Quantity

Jen Nguyen

Bucknell University, USA

Integrating History and Philosophy of Measurement: Reflections on Its Past, Present and Future

Rebecca L. Jackson, Michele Luchetti  
Max Planck Institute for the History of Science, Germany

12B, Room 1215. Issues in Measurement and Generative AI II. Chair: Linda Morell

AI and Measurement concerns: Dealing with imbalanced data in autoscoring

Yunting Liu, Xutao Feng, Yukie Toyama  
University of California, Berkeley, USA

A Psychometric Investigation of the Self-Directed Online Learning Scale (SDOLS)  
Through Rasch Rating Scale Modeling

Hongwei Yang, Jian Su, Kelly D. Bradley  
University of West Florida, USA

Inq-ITS: Leveraging learning sciences and computational sciences for real time,  
AI-driven assessment of students' science competencies and implications for learning and teaching

Janice Gobert  
Rutgers University & Apprendis, USA

6:05-6:20 Closing Session, Room 1102

#### **Day 4 (8 August)**

9:00-10:30 Campus Tour: Chair (Walking), Smriti Mehta

Meet at the Berkeley Way entrance of the Berkeley School of Education at 8:30 am or directly at the [Springer Gateway](#) near Oxford and Addison at 8:45 for a prompt departure at 9:00 from Springer Gateway.

## MAPS

BWW Building ...

### FLOOR PLAN

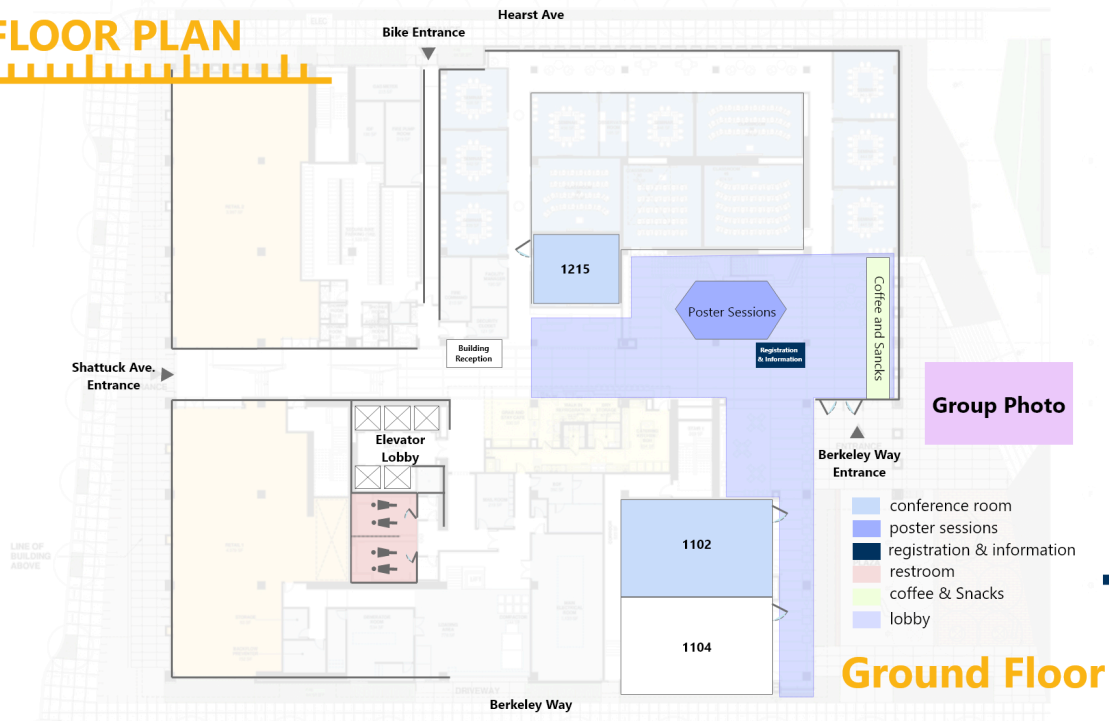

## Conference Map

### Ground Floor

### FLOOR PLAN

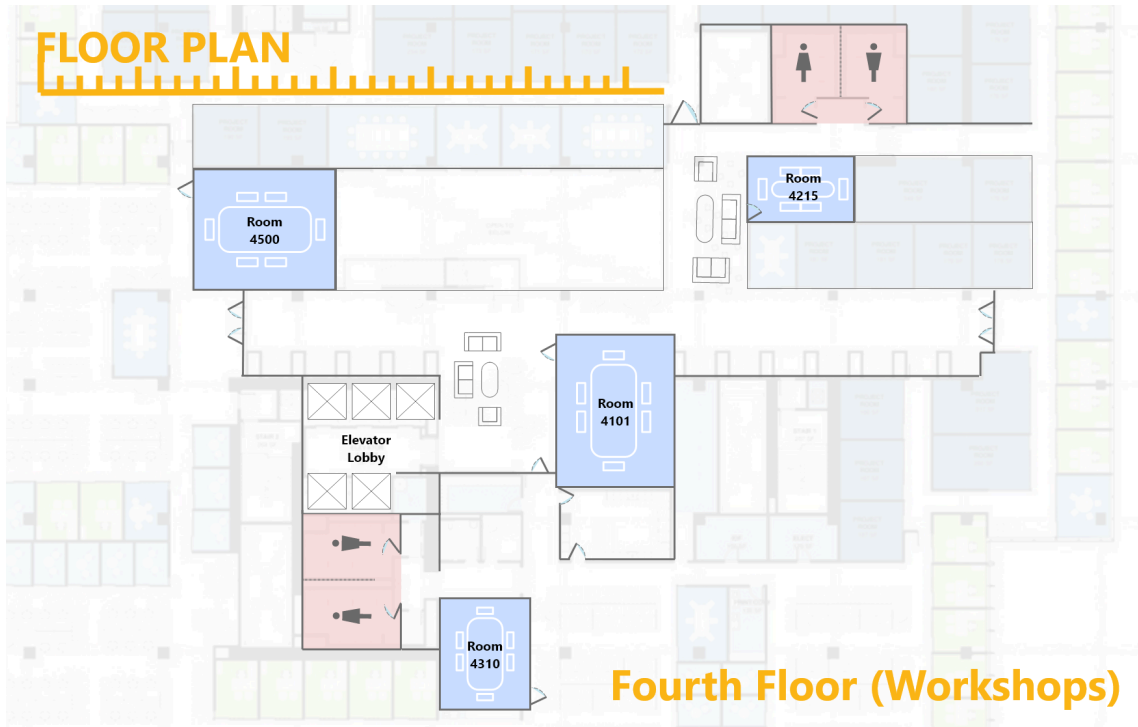

## Conference Map

### Fourth Floor (Workshops)



From the BWW Building to the Faculty Club ...

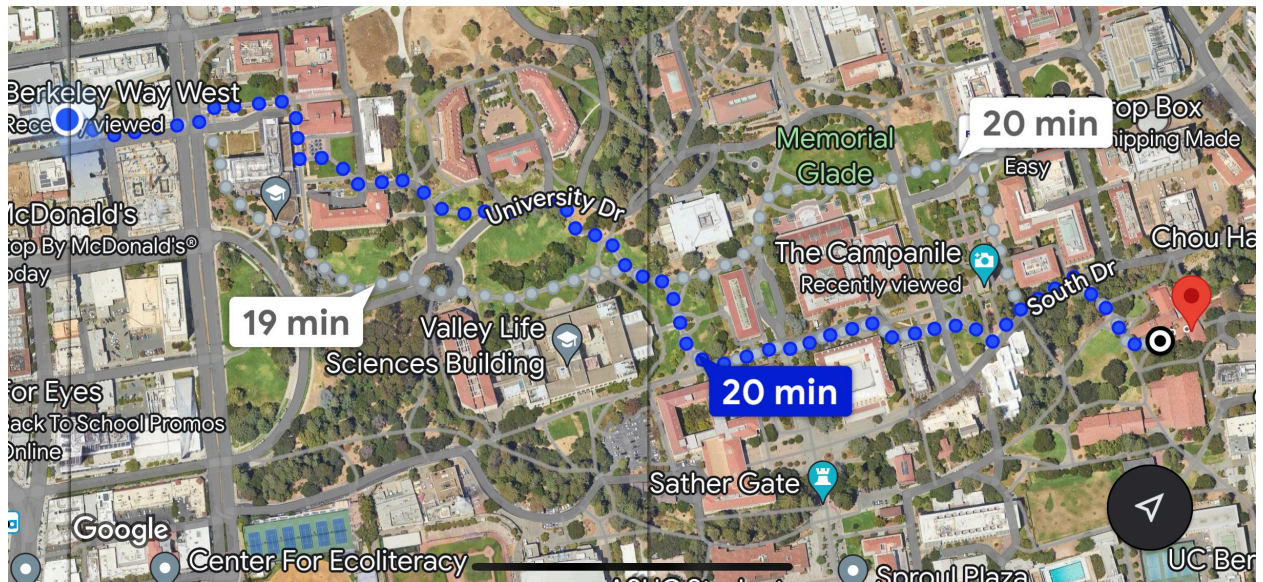

See also:

[https://maps.app.goo.gl/mgTedp4PojoGXMf2A?g\\_st=com.google.maps.preview.copy](https://maps.app.goo.gl/mgTedp4PojoGXMf2A?g_st=com.google.maps.preview.copy)