



Destination Imagination Tournament Event Guide Wisconsin South Central Region 2026

Welcome! This guide is designed to help you plan for and navigate the event with confidence, with information to support a wide range of access needs and experiences. Images and image descriptions can be found at the end of the guide.

About the Event

A Destination Imagination (DI) tournament includes two main components: the **Team Challenge** and the **Instant Challenge**.

Each team presents its **Team Challenge** solution at a scheduled time and location. The Team Challenge falls in one of seven categories: Technical, Scientific, Fine Arts, Improvisational, Engineering, Service Learning, or Early Learning. These presentations are about eight minutes and may include loud sounds, flashing lights, or quiet dialogue, depending on the team's approach. Each Presentation Site varies in size, seating, and acoustics, and audiences may come and go between teams. Spectators are welcome at the Team Challenge sites.

The **Instant Challenge** is a surprise activity that teams complete in a private setting. Instant Challenge areas are quiet zones. No spectators are allowed at the Instant Challenge sites.

The tournament concludes with a lively **Awards Celebration**, which may be noisy and crowded; ear defenders or plugs are welcome.

Spectators are encouraged to attend with the following information: team name, Challenge, Team Number, school/organization, and Presentation time and place of the team they are coming to see.

Event Snapshot

- Date & Time: Saturday, March 7th at 9am
- Location: Parkview Jr. Sr. High School, 408 W Beloit St, Orfordville, WI 53576 [Link to Directions](#)
- Access Contact: Ashley Nelson, ashley.nelson@wisconsindi.org

- General Questions: Ashley Nelson, ashley.nelson@wisconsindi.org
- Tournament Schedule: [Link](#)
- Event Map: [Link](#)

Navigating the Venue

- Main entrances are wheelchair accessible and marked with signage.
- Check-in Location: Main Commons off Door #1
- Volunteers will wear purple Destination Imagination shirts and/or name badges and can assist you.
- Wayfinding maps will be posted via QR Code at the Tournament Site and available online: [South Central Tournament Event Page](#)hhhh

Inclement Weather

- In case of inclement weather, teams will be notified via: Email
- Tornado shelters can be found: In the bathrooms next to the commons in hallway leading to the gym.

Emergency Procedures

- Fire alarms have flashing lights and loud, repetitive sirens.
- Follow exit signage when necessary.
- First aid kits are available: At the Merch Table in Main Commons Area
- In case of a medical emergency, notify the nearest tournament volunteer. We will immediately call 911.

Core Accessibility Features

Mobility Information

- Accessible parking is available at the Main Entrance near Door 1.
- Wheelchair-accessible paths lead to Main Entrance near Door 1.
- Accessible restrooms are located in bathrooms off Main Commons.
- We recommend bringing any mobility aids, as Presentation Sites are spread out.

Sensory Regulation & Quiet Space

- A Quiet Room/Regulation Room is available at Room 302 and Room 109

- This room offers low lighting, seating, and a calm atmosphere.
- This room is for use by anyone needing a sensory break, medication space, prayer, etc.
- We welcome your self-advocacy and want to support you. Feel free to:
 - Stand or move as needed
 - Use stim devices
 - Use your preferred method of communication

Communication Access

- The main language of the event: English
- Please contact Ashley Nelson (ashley.nelson@wisconsindi.org) at least 7 days in advance for communication needs, including:
 - Sign Language interpretation
 - Presentation in another language
 - Large-print materials

Restroom Information

- Men's and Women's restrooms are available throughout the venue.
- Accessible stalls: Most bathrooms
- Restrooms with baby changing tables: located in the men's and women's bathrooms.
- Menstrual products: Available in a dispenser in the women's bathrooms. Quarters are needed.

Lactation & Family Room

- A private room for nursing parents is available in room 302.
- It includes seating, outlets, and privacy signage

Scent-Free Policy

- This is a low-scent event. Please avoid perfumes and scented products.
- Signage will be posted at entrances.

Service Animals

- Service animals are welcome throughout the venue. Relief areas will be indicated on the site map.

Food/Drink & Allergens

- Food vendors will post allergen information.
- An allergen-free eating space: will be labeled with a sign in the main commons area.
- Teams may not bring their own food unless needed for medical or dietary reasons—please eat in the cafeteria near the main entrance.
- Our tournament is free from latex and peanuts.

Immunity Precautions & First Aid

- Our event will adhere to local health and safety restrictions.
- First aid kits can be found at the Merch table located in the cafeteria.

Accommodation Requests

If anyone on your team needs specific accommodations:

- Fill out the [Accommodation Request Form](#).
 - (<https://share.hsforms.com/1jAPgfYBsR26vThhUUVCHjQ1mraj>)
- We recommend submitting requests at least 7 days before the event.
- On-the-day needs: Please speak with the Information/Check-in Table.

We are happy to provide support around:

- Physical access
- Communication needs
- Visual/sensory supports
- Scheduling flexibility

Code of Consideration

We aim to co-create a welcoming space for everyone. Please:

- Avoid perfumes, colognes, or scented lotions.
- Use quiet voices in sensory or rest areas.

- Respect personal space and mobility devices.
- Ask before touching assistive tools or service animals.

Thank you for helping make this a more inclusive, creative, and respectful experience for all!

Disclaimer: This guide is offered to help attendees know what to expect and prepare for the tournament. While we are not in charge of the building and cannot guarantee it meets specific accessibility laws or standards, we do our best to advocate for access, provide accommodations, and choose venues that are as accessible as possible.

Tournament Images



Image Description: Photo of Parkview's Exterior with the main entrance and accessible parking in view. The building is brown and white in color. There is a flag pole and a parking lot in front of the building.



Image Description: Photo of one of the rooms that will be used as a challenge presentation site. The classroom has large lights built into the ceiling tiles, white walls with a clock, whiteboard, smartboard and some windows, and brown tables and cabinets with a dark counter top. This is a science classroom so there's lots of room for students to work and stools for students to sit at. This room will be modified to accommodate the challenge presentation requirements.

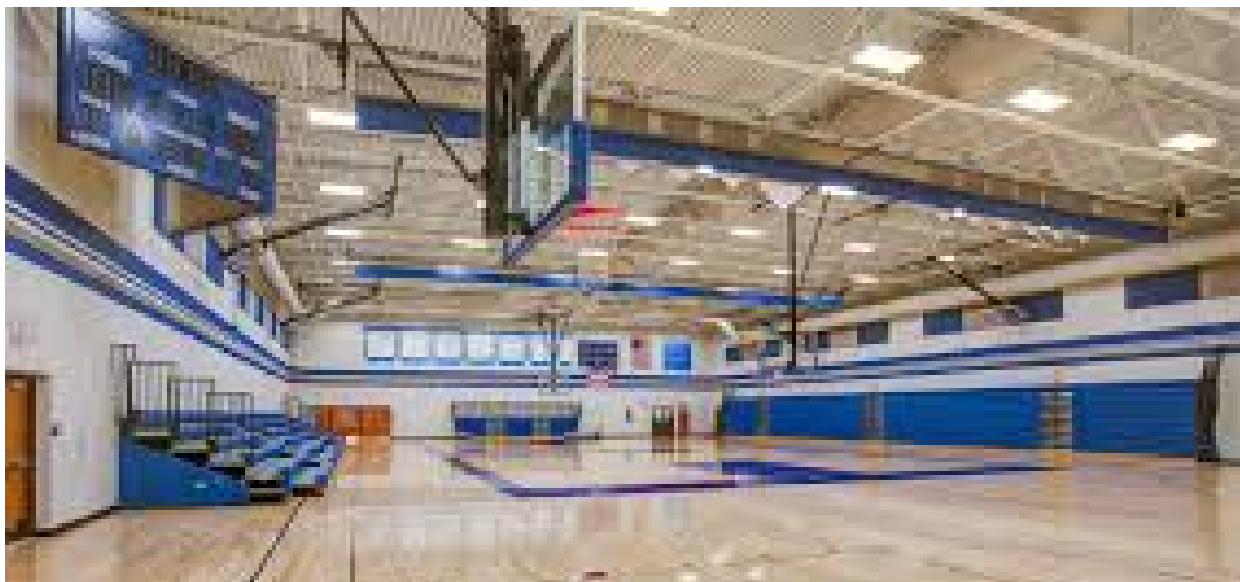

Image Description: Photo of the gym awards will be presented in. It's a long gym with blue bleachers on the side and very shiny wood floors.



Image Description: Photo of the Main Commons area which is where food and the merch table will be located. In the photo the tables are folded up and placed against the wall, during the tournament the tables will be out for people to use. The tile floor has large tiles of white, cream and blue in a pattern of rectangles and squares. The walls are mostly white and the top half of the main wall has "Parkview Vikings" and the school logo (a Viking with a sword) in blue.

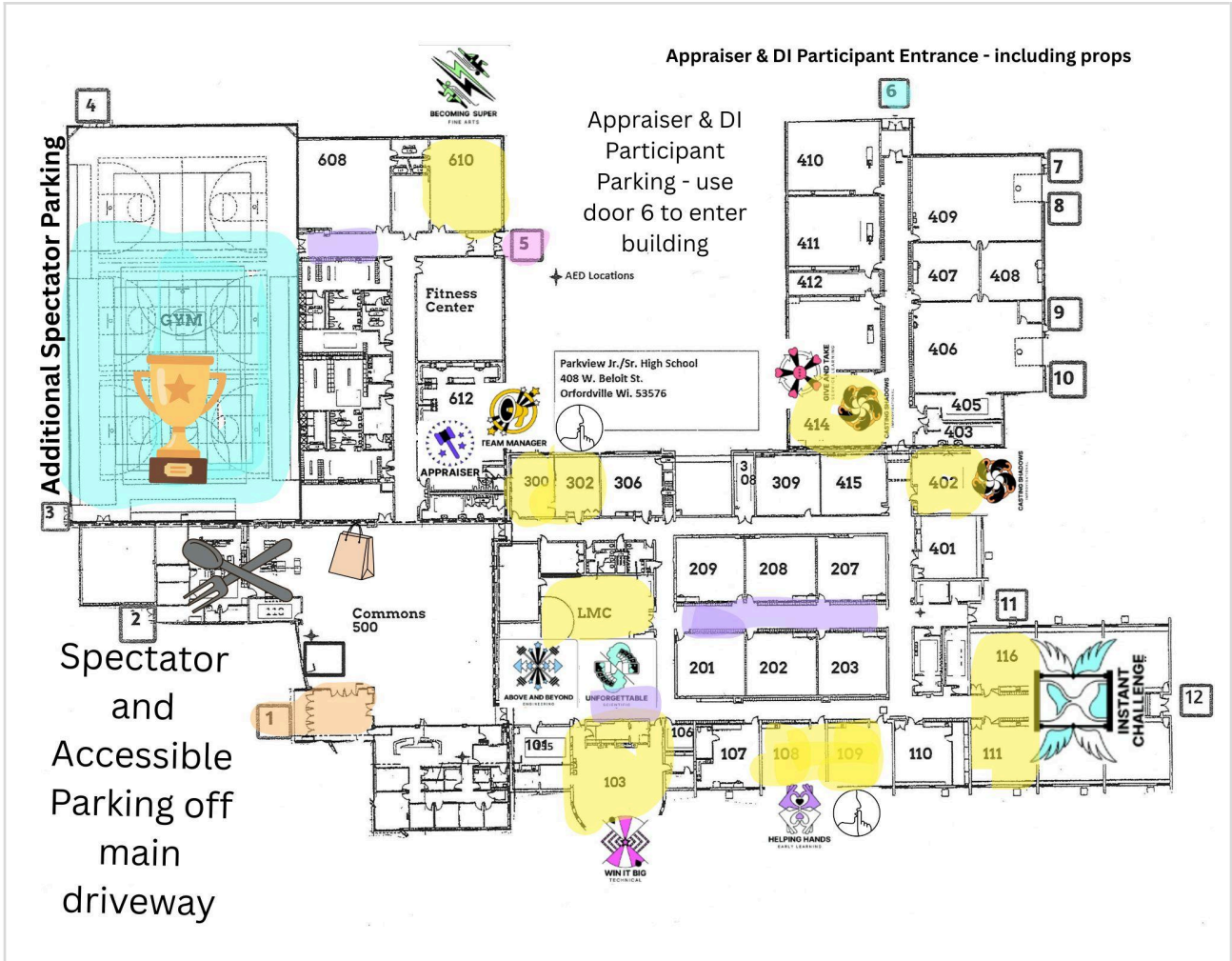

Image Description: Overhead view of the venue layout with colors and symbols denoting different areas throughout the tournament. Text on various sides of the building layout describe where parking is available and what kinds. Rooms with challenge symbols next to them may be loud in between performances. The awards area which is in blue may be loud leading up to and during awards. There are two quiet areas (room 302 and room 109) that can be utilized if you need a quiet place to go during the tournament.