

Game Changer FAQ's

Manager FAQ's:

What game should I be using?

You should use the game that is associated with your league, i.e., if it says PHBA Pioneer under your game, then that was the one loaded by the league, and you should use that one.

How important are the stats in Game Changer?

We are using Game Changer to track the pitch count and score. Once a game is completed, the score still needs to be added to TeamSnap.

We care about the pitch count and the score. If we get stats from using Game Changer, that is an added bonus.

What happens if my game is rained out or rescheduled?

All the games are loaded in Game Changer right now. If a game gets rescheduled, just message your commissioner to have the game updated in Game Changer. We have to update from the league side.

What if there are duplicate games loaded in my Game Changer?

The game associated with your league is the one that we are tracking from the league. If you have used the wrong game, you need to go in and update.

Can we see live scoring and follow along even if we are not the scorekeeper?

Yes, the idea with Game Changer is that you should be able to see updated live scoring from the home team's scorekeeper.

Doesn't Game Changer make it so scorekeepers can't watch their kids play?

I know it might seem like it is going to take forever to figure out Game Changer, but once you do, it will be way faster and more accurate than doing it by hand.

We know that change is hard, but this is going to be way more efficient in the long run. We are hearing it takes about two games to really hit your stride.

Does my scorekeeper need a staff position or can I let my coaches have it?

The scorekeeper absolutely needs to have a staff position; the other spots on the staff can be used for a head coach and anyone else planning on scoring a game. You should keep the PHBA owner of GameChanger on the staff so they can make changes.

Do I need to set my roster before each game?

Yes, and if you are not going to do that, then you need to have a paper copy that you can provide to the scorekeeper.

How do I stream live video to my team community?

To get started with live streaming, schedule a game for your team and tap the “Go Live” button for that event. You can stream directly in the app or using an external camera. Be sure to set the audience and video quality for your stream. Both streaming and viewing live video are completely free for Team Staff and the team community.

Scorekeeping FAQ's:

Game Changer Scorekeeping University: <https://gc.com/gcu/scorekeeping-baseball-softball>

How do I end an inning if we hit the cap in an inning?

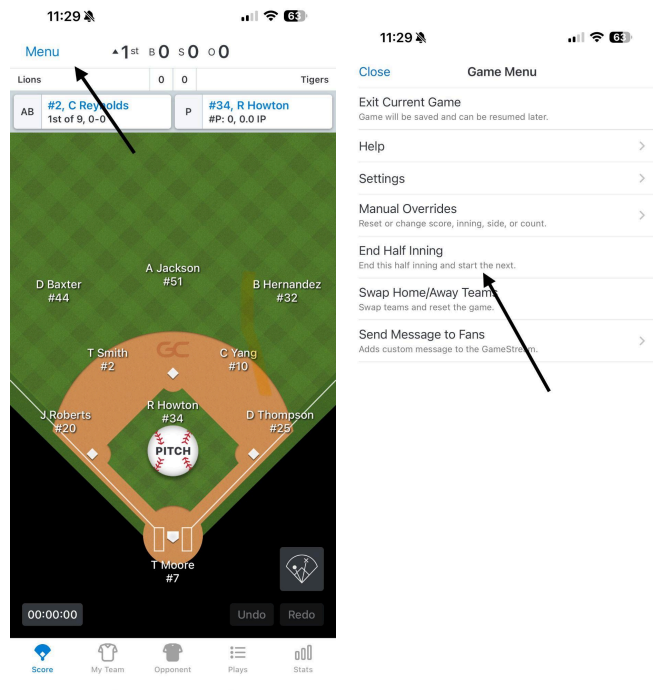

How do I log the action when the coach comes in to pitch to finish an at-bat?

When a batter gets walked in Pioneer softball or baseball and the coach comes in to finish off the at bat, you have to wait to log the pitch after ball 3 and just record the action. If the batter strikes out and you just log that as a **Batter Out: Other**. We don't want to add pitches to a pitcher that didn't throw pitches.

InSoftball how do I add a fourth outfielder?

Step 1

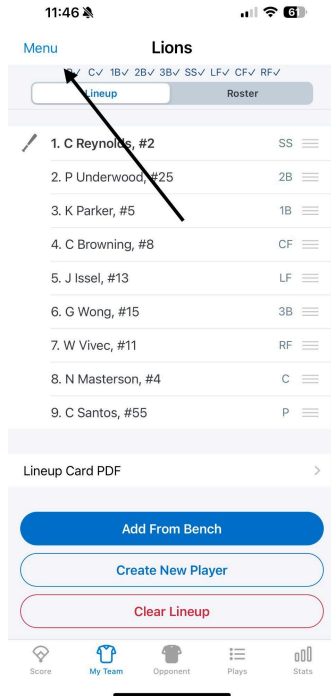

Step 2

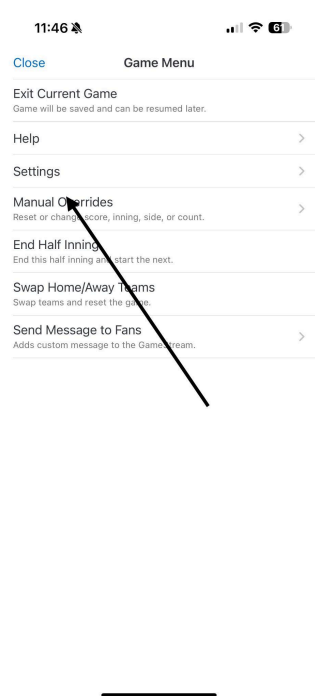

Step 3

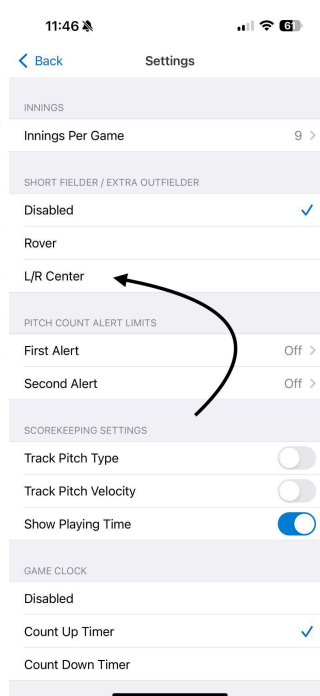

GAMECHANGER. Scorekeeping Cheat Sheet

- 1 Set your **Starting Lineup** from the game screen
- 2 Tap **"Score Game"**
- 3 Go to **Opponents** screen to add their lineup or lineup placeholders
- 4 Tap **Pitch** button to begin each at bat
- 5 Drag Fielders to where the ball is hit
- 6 Manually advance runners or call them out on the base paths by dragging them **SAFE** or **OUT**
- 7 Tap on a player in the field or from the lineup to make a **substitution**

GAMECHANGER. Scorekeeping Cheat Sheet

Made a Mistake? Don't Sweat It

- 1 Use the **Undo** button to correct a mistake on the last play
- 2 Change previous scoring decisions from the **Plays** tab
- 3 Correct play outcomes and fix missed substitutions

Advanced Tips

- 1 Drag N Drop Players to edit your batting order
- 2 Tap on the player to set **DH or DP/Flex**
- 3 Players will be listed as extra hitter (EH) if they aren't assigned a position

Experience More from the Game Menu

- 1 Set Pitch Count alerts
- 2 Track pitch velocity
- 3 Turn on the game clock
- 4 Add a 10th fielder