

# INSTRUCTION MANUAL

SLOW JUICER

MODEL: WJE-NB-G

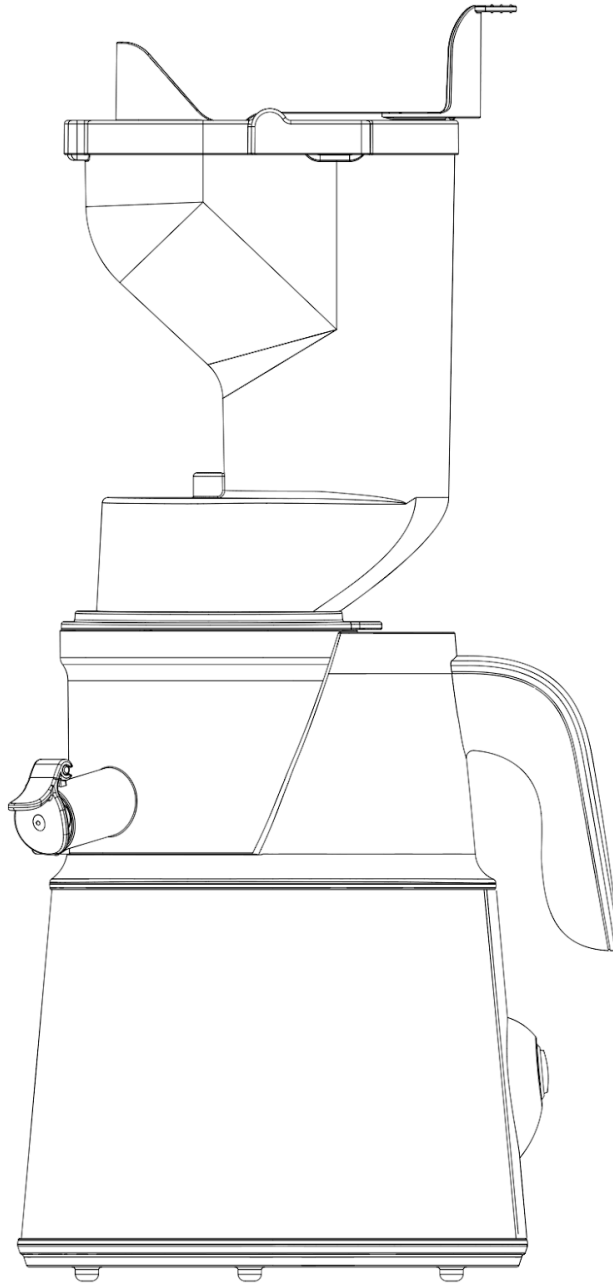

FOR HOUSEHOLD USE ONLY

## ●IMPORTANT SAFE INSTRUCTION

When use electrical appliances, basic safety precaution should always be followed including below:

read all instruction carefully before using

to protect against risk of electrical shock, do not put main body(motor) in water or any liquid

children should be supervised to ensure they do not play with the appliance

do not operate any appliance with damaged cord or plug or after the appliance malfunctions, or it is dropped or damaged in any manner. return the appliance to nearest authorized service agent for examination, repair or electrical or mechanical adjustment.

if the supply cord is damaged, it must be replaced by manufacturer or its service agent or similar qualified person in order to avoid hazard

always unplug when it is not in use or before assembling or taking off parts or cleaning.

forbid to touch moving parts

do not use any attachments which is not supplied by manufacturer ,otherwise it may lead to fire, electrical shock or other injury

always ensure to switch off appliance and motor has been stopped completely before disassembling

do not put your fingers or any foreign into the juicer when it is working. If food is stuck in the inlet ,use pusher to push it down or use reverse switch to unstick .if this manner can not solve the problem, then to stop juicer immediately and after ensure the motor is stopped completely to disassemble appliance to move food.

do not use appliance outdoor

do not use appliance for other intended purpose

do not put any parts into dishwasher for cleaning

do not use the appliance more than 20min constantly to avoid motor is damaged. Use it again until appliance is cool(around 20min)

do not use appliance to extract had material, like large seeds, ice ,frozen fruit and so on.

This appliance is not intended for use by persons (including children)with reduced physical, sensory or mental capabilities, or lack of experience and knowledge, unless they have been given supervision or instruction concerning use of the appliance by a person responsible for their safety. Children should be supervised to ensure that they do not play with the appliance.

17,switch off the appliance and unplug from socket before changing accessories or approaching parts that move in using.

## ●installation & operation instruction

### parts instruction

1-hopper

2-auger head

3-Filler

4-bowl

5-pusher

6-clean brush

7-pulp cup

8-juice cup

9-base

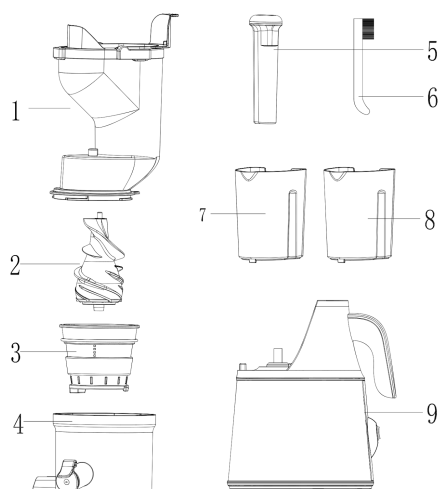

Friendly hint: do not operate appliance with empty bowl, otherwise it will speed up abrasion of parts

### assembling instruction

importance: prior to assemble the juicer, please check this point: at the base of bowl, there is a rubber stopper ,correctly fix the stopper to ensure all of the juice only exits via the juicer outlet, before extracting always ensure the rubber stopper is firmly in place. See below fig.

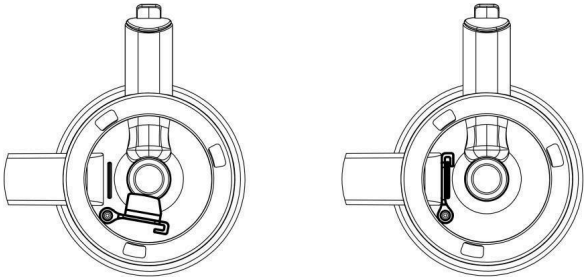

1,assemble bowl onto the base. Put bowl on the base and clockwise rotate to lock the bowl. Make sure the bowl is always locked on the base tightly. See below fig.



2,put the filter into the bowl, pls note there is a sign ▲ on the filter edge ,this sign must align with the same sign ▲ on the edge of bowl. The correct assembling makes the filter can not be rotated in the bowl. See below fig.



3,insert the auger head into the filter, make sure the auger head' s axes must be tightly fixed on the base' s axes. See below fig.



4, assemble hopper onto the bowl: Align the convex point of hopper edge with the sign ▲ on the bowl and then clockwise rotate the hopper to fix tightly .see below fig.

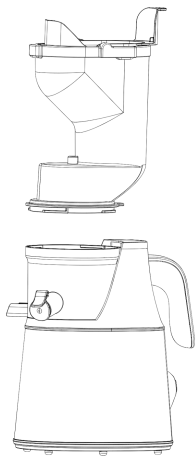

## operation instruction

### important:

—do not switch on appliance prior to imputing materials

—do not operate appliance more than 20min at one times

1, plug in appliance

2, place cups under outlet of juice and outlet of pulp

3, know of switch: ON/ OFF /REV ---see switch button on product

ON-starts the motor and juicing process

OFF-switch off appliance

REV-reverse rotation, only use the function when something is stuck in the bowl and need to be unclogged

4, put materials into the hopper to extract juice

. ensure pieces are not large to enter into hopper

. remove hard seeds or pips or other hard part of material

. do not overstuff the hopper or force material in. put material slowly one by one. the pusher only be used if materials are stuck

5, switch on juicer to extract juice ,at the same time put materials into hopper one by one as step4.

6, if materials are stuck or clogged ,stop juicer and then shift switch to REV to unclog materials. If such action is not working ,stop juicer and disassemble hopper to clean material ,then assemble hopper again to go on work. ( **very important: before disassemble hopper ,must unplug from power socket**)

7, when finished or leave juicer for a while ,switch off the juicer and unplug from power socket.

**how to clean juicer**

- 1,switch off juicer and unplug from power socket before cleaning
- 2,as per step of assembling to be reverse method to disassemble all parts of juicer one by one
- 3,use brush to clean all parts under water tap
- 4,use damp cloth to wipe base ,make sure do not let any liquid go into the base

**technical data**

input voltage: DC220-240V  
Frequency :50/60Hz  
Power:150watts  
Speed:DC motor 75RPM  
Max operation time: less than 20min

**trouble shooting**

before you call for service ,review the trouble shooting firstly

problem	Possible cause	What to do
No power to work	.Juicer is not plugged in correctly	.Check the juicer to plug in tightly
	.incorrect to assemble hopper	.re-assemble hopper correctly
Motor is stopped during working	.Bowl is overfill with material .hard material inside or much fiber inside that cause juicer be stuck	Press reverse button to unclog material .if not working ,then disassemble hopper to clean material and then assemble hopper again to try .if juicer still is not working ,stop juicer to call service agent
Leakage from beneath the bowl	Rubber plug on base of bowl is not inserted correctly.	Disassemble all parts to check rubber plug and re-plug in correctly
Stain on the bowl, filter, spinning brush	Natural color from juicing material	This is perfectly normal
Damage filter	Frozen material, seeds, pips, and other hard material in bowl	Ensure you have read the manual carefully and operate correctly
Squeaking noise during working	.Juicing noise from squeezing screw	.This is perfectly normal. Ensure you did not overstuff material
	.some hard material in the bowl	.stop juicer to disassemble hopper to clean material

● **disposal of bad product**

Correct Disposal of this product



This marking indicates that this product should not be disposed with other household wastes throughout the EU. To prevent possible harm to the environment or human health from uncontrolled waste disposal, recycle it responsibly to promote the sustainable reuse of material resources. To return your used device, please use the return and collection systems or contact the retailer where the product was purchased. They can take this product for environmental safe recycling.