

Add-ons for Google Forms

by - Eric Curts

Table of Contents:

- [What are Add-ons](#)
 - [How to install an Add-on](#)
 - [How to use installed Add-ons](#)
 - [How to remove installed Add-ons](#)
 - [Recommended Add-ons for Google Forms](#)
-

What are Add-ons

Google Forms is already a very powerful, full-featured program that allows you to create forms, surveys, polls, quizzes, and more. However even with all its options, there may still be some features missing from the Forms that you would like.

Thankfully Google allows third-party people to create **Add-Ons** that can be easily installed, which add new features and tools to Google Forms.



How to install an Add-on

When you are using Google Forms you can find and install new Add-ons as follows:

- Click the “**More**” button (three vertical dots) in the top right corner
- Choose “**Add-ons**” from the drop-down menu
- This will open the **Add-ons window**.
- You can scroll through the available Add-ons, or narrow down the choices with the **filter** menu, or type in a **search** term.
- If you find an Add-on that looks interesting, you can click on it to get **more details**.
- In the pop-up window you can read more about the Add-on, see images and/or videos, and see reviews and ratings.
- If you decide to install an Add-on, click the blue **+FREE** button.
- You will then get a pop-up window explaining what privileges the Add-on needs, and asking for your permission to install it.
- Click the blue **Accept** button to allow the Add-on to install.

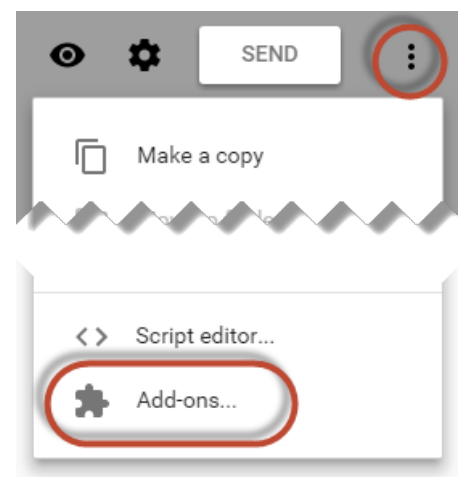

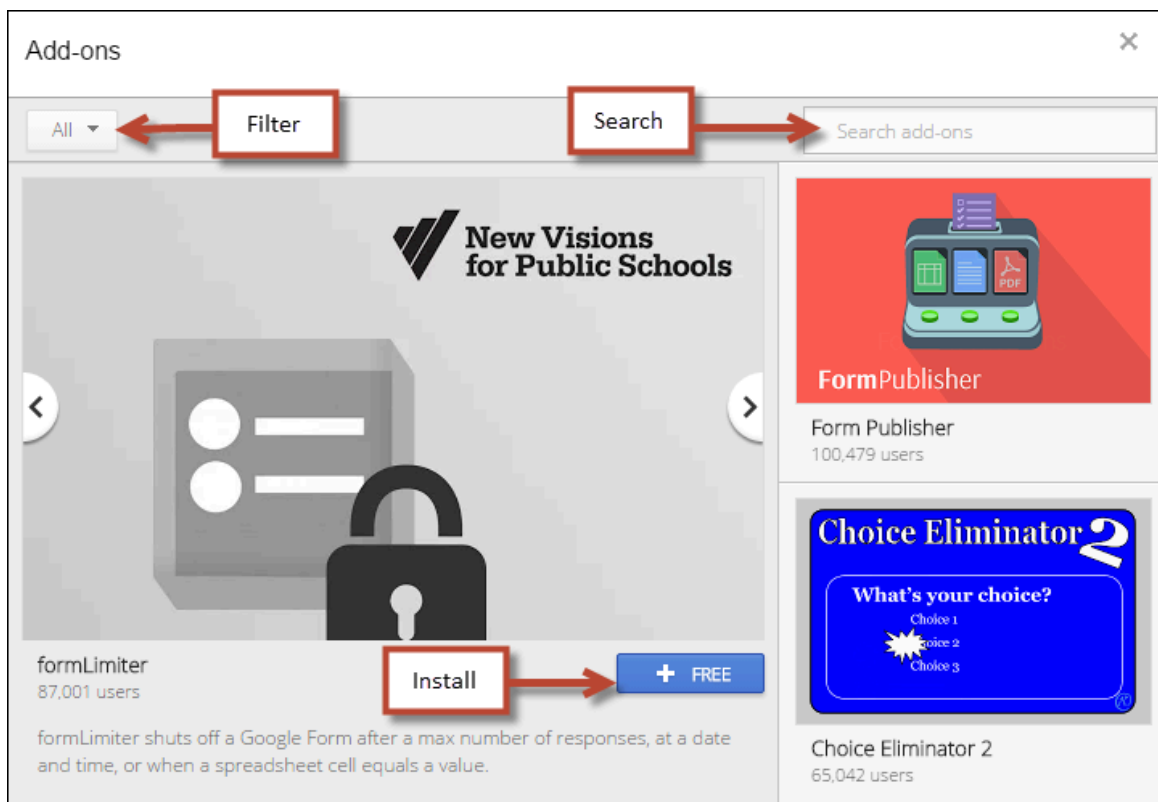

How to use installed Add-ons

Once you have installed an Add-on, it will show up in the drop-down menu when you click the puzzle piece icon in the top menu bar. To use an Add-on:

1. Click the **Add-ons** icon (puzzle piece) menu
2. Click on the Add-on you want to use in the drop-down menu
3. A side menu will pop-up and will typically include a menu item to launch the Add-on.

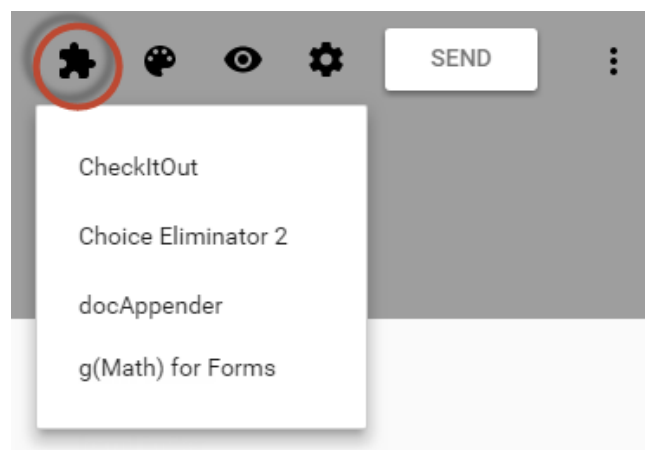

How to remove installed Add-ons

If you decide you no longer need a particular Add-on, you can remove it easily.

1. Click the “**More**” button (three vertical dots) in the top right corner
2. Choose “**Add-ons**” from the drop-down menu
3. This will open the **Add-ons window**.
4. Locate the Add-on you want to remove.
5. Click the **Manage** button below the Add-on.
6. Click **Remove** from the drop down menu.
7. The Add-on will now be uninstalled.
8. If desired, you can always reinstall the Add-on again.

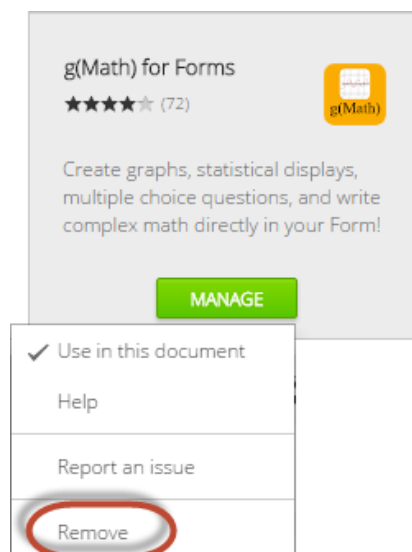

Recommended Add-ons for Google Forms

There are many excellent Add-ons for Google Forms, with more being added all the time. Below is a small sample of recommended Add-ons for Forms.

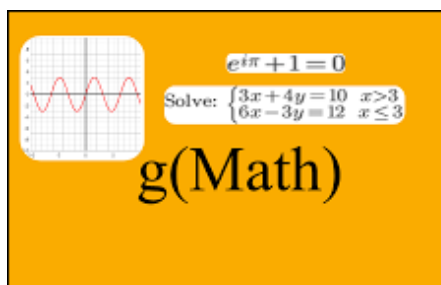

g(Math) - [Add-on link](#)

Create graphs, statistical displays, multiple choice questions, and write complex math directly in your Form. You can also deploy a Form to allow responders to craft responses using g(Math) tools. This is an invaluable tool for any math class or math teacher.

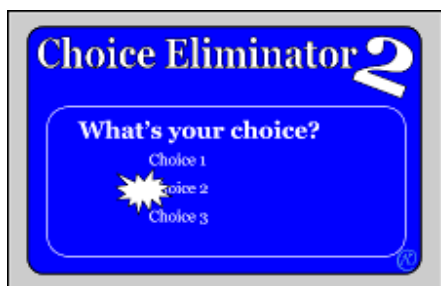

Choice Eliminator 2 - [Add-on link](#)

Choice Eliminator will eliminate options from a multiple-choice, list, or checkbox type of question. Great for signing up for time slots or having students choose topics without doubling up.



formLimiter - [Add-on link](#)

formLimiter automatically sets Google Forms to stop accepting responses after a maximum number of responses, at a specific date and time, or when a spreadsheet cell contains a specified value. Great for time-bound assignments, event registrations with limited seats, or other first-come, first-served signup scenarios.



Form Values - [Add-on link](#)

Form Values allows you to store and use lists that you use regularly in forms. This could be a list of staff, students, timings, rooms, resources or anything you want.



docAppender - [Add-on link](#)

Appends Google Form question responses to the bottom of selected Google Docs. Use a Google Form to select which Doc(s) to append from a list, multiple-choice, or checkbox Form question -- pre-populated with Doc titles from a folder in Drive.



CheckItOut - [Add-on link](#)

Used for checking in and out items, this add-on will create a question set or multiple sets. One question is for items that are IN and another for items that are OUT. Questions can be Multiple-Choice, List or Checkboxes. When someone fills out the form selected items will be moved between the two questions. This allows for a very easy check in/out form.



formRanger - [Add-on link](#)

formRanger allows you to auto-populate the choices in list, multiple choice, checkbox or grid question options from columns of data in any Google Sheet or Doctopus roster. Great for ensuring form choices match values in an existing database of records, such as students, inventory items, expected attendees, workshop or session titles, etc.

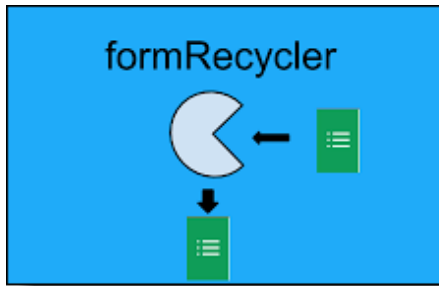

formRecycler - [Add-on link](#)

Recycle questions from other Forms in your Drive by selecting them in the Sidebar. Just pick the Form in the popup window and it will populate with the questions from that Form. Select the ones you want to insert and the formRecycler will automatically insert them at the end of the Form.



Data Director - [Add-on link](#)

The Data Director for Forms Add-on has multiple features. It can send the form response to an alternate spreadsheet. It can send an email or multiple emails when the Form is submitted. It can add a guest to your calendar event. Data Director will also create an Edit URL and/or a PreFilled URL, and save those links to the spreadsheet.

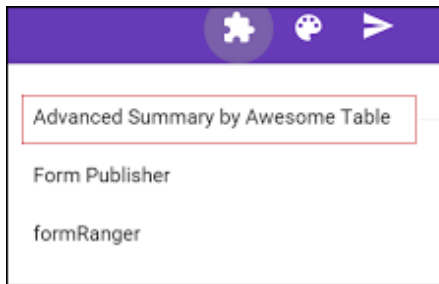

Advanced Summary - [Add-on link](#)

Advance Summary of responses generates charts and filters based on a Google Form responses. Advanced Summary of Responses takes advantage of Awesome Table to quickly build a summary of your form responses. You can select the items to display, and the summary will automatically update.

More resources

- Bring me to your organization: My training and consulting services - on-site or online - [link](#)
- All of my free training materials, help guides, presentations, videos, and more - [link](#)

© 2016 - Eric Curts - ericcurts@gmail.com - www.ericcurts.com - plus.google.com/+EricCurts1 - [@ericcurts](https://twitter.com/ericcurts)



This document is licensed under a Creative Commons Attribution Non-Commercial 3.0 United States license. For more information about this license see <http://creativecommons.org/licenses/by-nc/3.0/> (In short, you can copy, distribute, and adapt this work as long as you give proper attribution and do not charge for it.)