

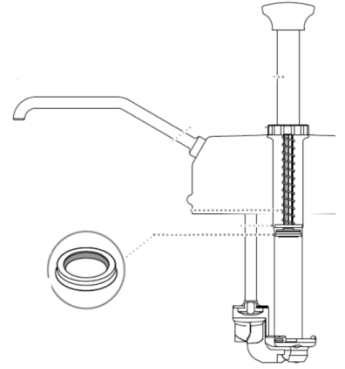

# Fudge & Caramel Pump Troubleshooting

## Problems with Flow or Portions?

1. Clean pump
2. Food product may be too thick or have solids that will not pass through pump
3. If using gagging collar(s) ensure they are undamaged and are installed correctly on head tube



## Plunger Doesn't Return to Top After Dispensing?

1. Ensure that the spring works
  - Replace if spring is broken
2. Ensure that the washer is placed between the spring and piston head

## Food Product Comes Out Around Locking Collar?

1. Ensure seal is properly placed on piston
  - **TIP:** Ensure the washer is placed between spring and piston head

## Pump Drips?

- Clean discharge tube with provided brush
- Inspect all O-Rings
  - Replace if damaged
- Food product may be too thin