

How to use RemoteApps @ TKASA with Android

We use Microsoft Remote Desktop Services (RDS) @ TKASA to offer Remote Desktop and RemoteApps across all devices. To access RDS follow these instructions.

You will need to install the Microsoft Remote Desktop app. Search for "Microsoft Remote Desktop" in the relevant app store

Android -

https://play.google.com/store/apps/details?id=com.microsoft.rdc.android&hl=en_GB

Alternatively you can use the HTML5 client on your device via a web browser however we would recommend using the app for more functionality. Visit

<https://gateway.tkasa.org.uk/RDWeb/webclient/> to load the HTML5 RDP client

Remote Apps through the Android Microsoft Remote Desktop app



Open the Microsoft Remote Desktop

It's lonely here.

To get started, add the remote desktop that you want to connect to using this device. You can also add remote resources to work with apps and desktops your administrator has set up for you.



Once on the Home screen for the app, press the + symbol and select "Remote Resource Feed". You will be prompted to enter the Feed URL. Enter

<https://gateway.tkasa.org.uk/>

It's lonely here

Desktop
Remote Resource Feed

To get started, add the remote desktop that you want to connect to using this device. You can also add remote resources to work with apps and desktops your administrator has set up for you.

If this doesn't work add the full address for the feed

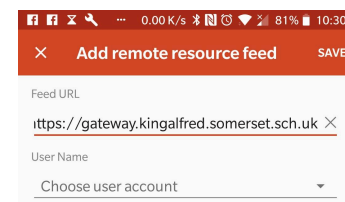

<https://gateway.tkasa.org.uk/RDWeb/feed/webfeed.aspx>

Press the username dropdown and select "Add user account"

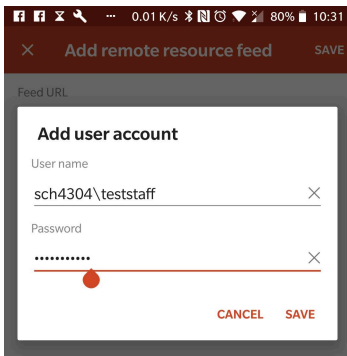

Enter **your own** TKASA user details in the format sch4304\username and add your current password. Click save.

Use the drop down to select the user account that you have just added and click save.

If you have done the above steps correctly and your TKASA Network username and password is valid you will find "Full Desktop" appear in the Desktops tab. This will give you a full remote desktop experience that you may be familiar with.

Tap to open a session

Under Apps you will find a list of the remote applications you have access to. Tap to open a remote application. On an iOS or Android device this will open fullscreen in the Microsoft Remote Desktop app.

