

Zidoo Other Settings

1. Language Setting

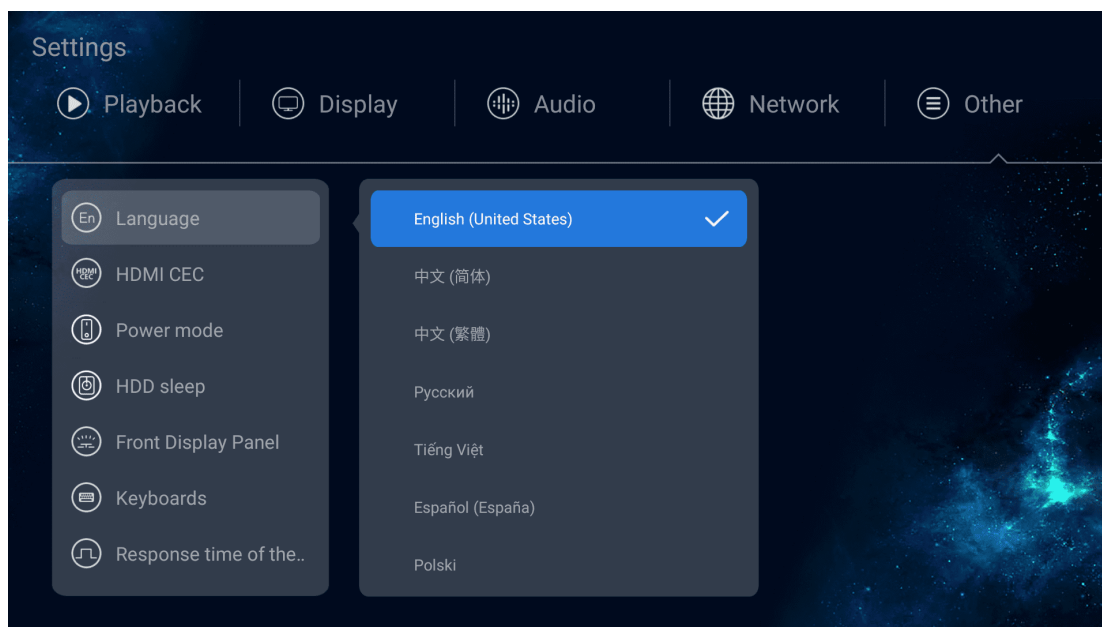

2. HDMI CEC

Consumer Electronics Control (CEC) is a feature of HDMI designed to control HDMI connected devices by using only one remote controller; so, individual CEC enabled devices can command and control each other without user intervention. For example, a television set remote controller can also control a set-top box and a DVD player.

Tip:When HDMI audio output is RAW, control signals will be sent from Zidoo media player to amplifier or TV by CEC. Please make sure HDMI CEC functions in all devices are turned on. And there might be compatibility problems and not all devices can be controlled!

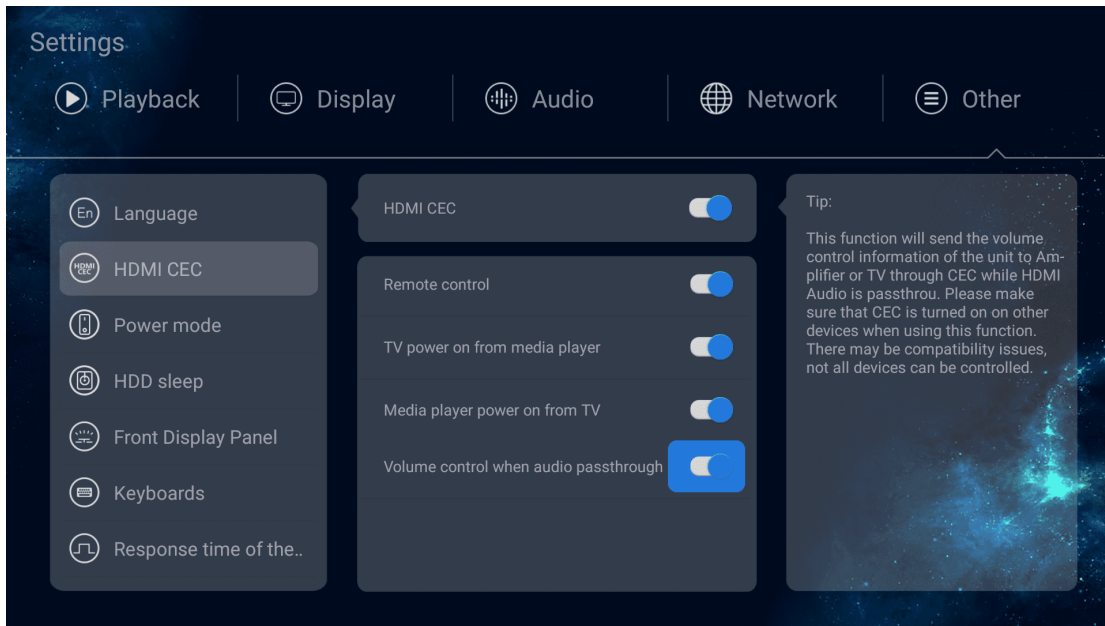

3. Power Mode

Standby while power plug in: Zidoo media player will be standby when powering on, it is needed to press the "Power"key on the remote control to switch on.

Starting up while power plug in: Zidoo media player will switch on once it is powering on.

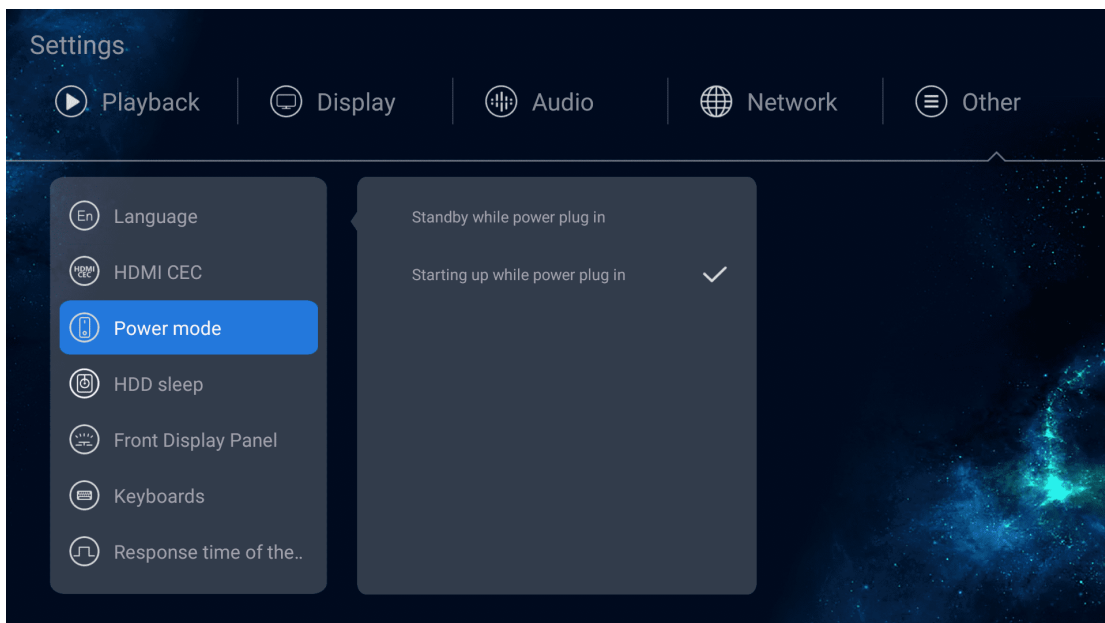

4.HDD Sleep

Turning on the HDD sleep function can not only save power but also extend the lifespan of the hard drive.
If users play local film from the hard drive when it is sleeping, the system will awake the hard drive automatically.

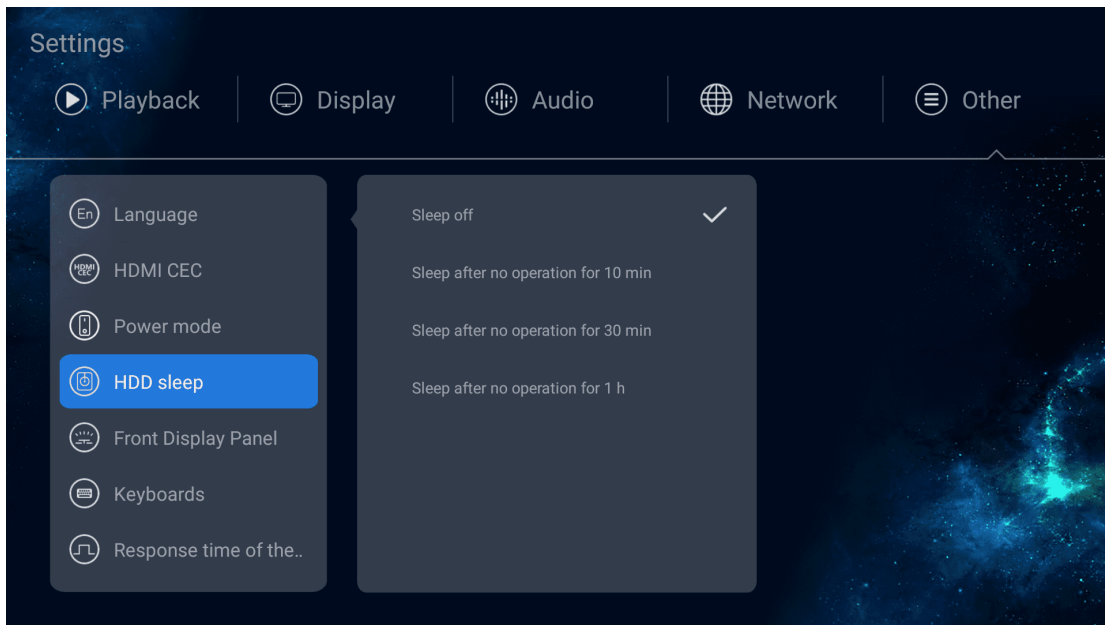

5. Front Display Panel

5.1 Brightness Setting

It is a small function but some users don't want to be bothered by bright panels when watching movies, so that they can adjust the brightness with this setting.

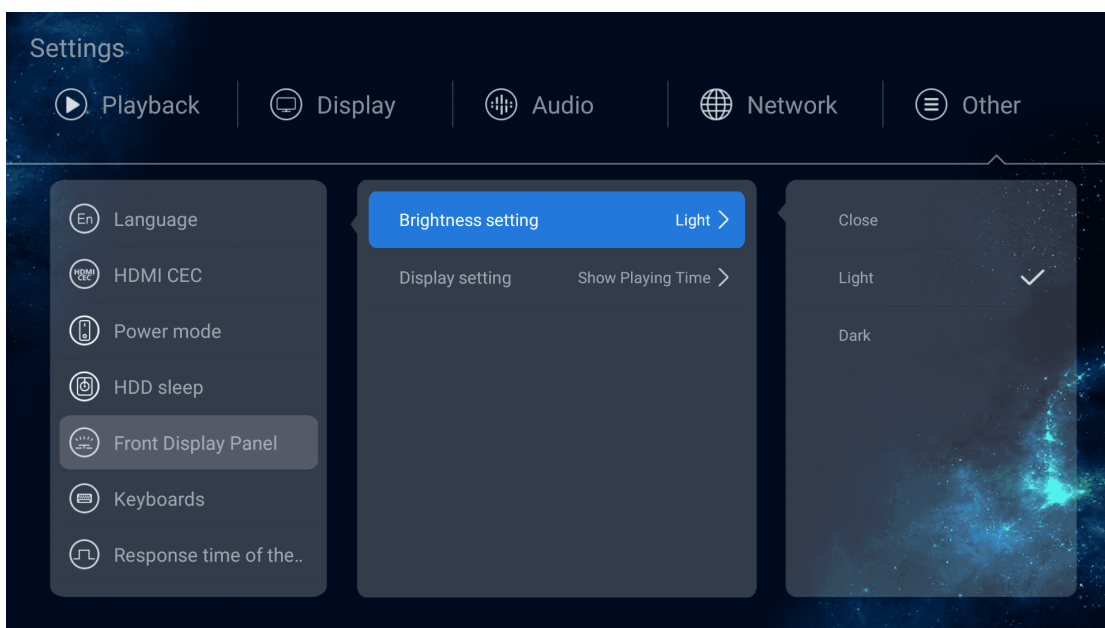

5.2 Display Setting

The front panel can be set to show playing time, remaining time or clock according to your preference.

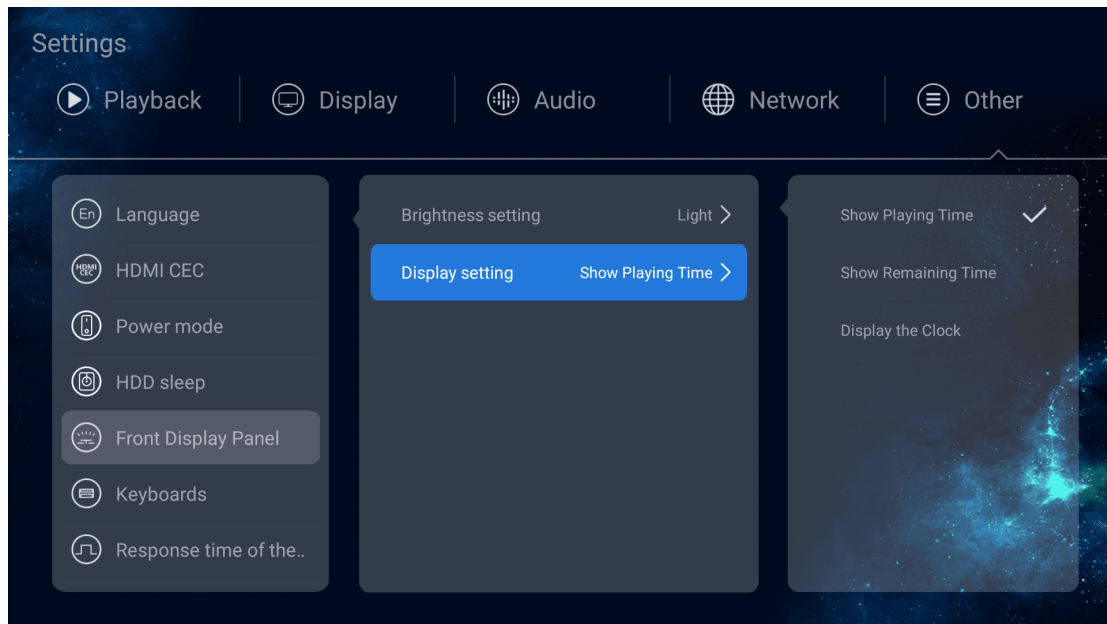

6. Keyboards

Virtual keyboards can be downloaded and installed. Then we can choose the virtual keyboards here.

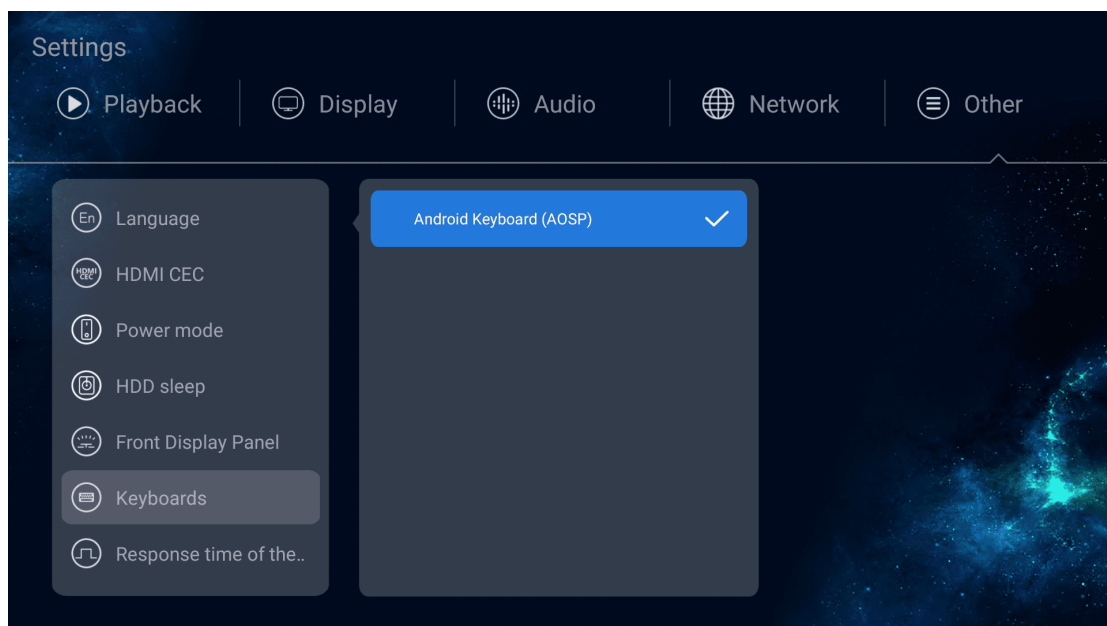

7. Response time of the long key press

The response time of long pressing the OK key on remote control can be adjusted since firmware V6.3.35.

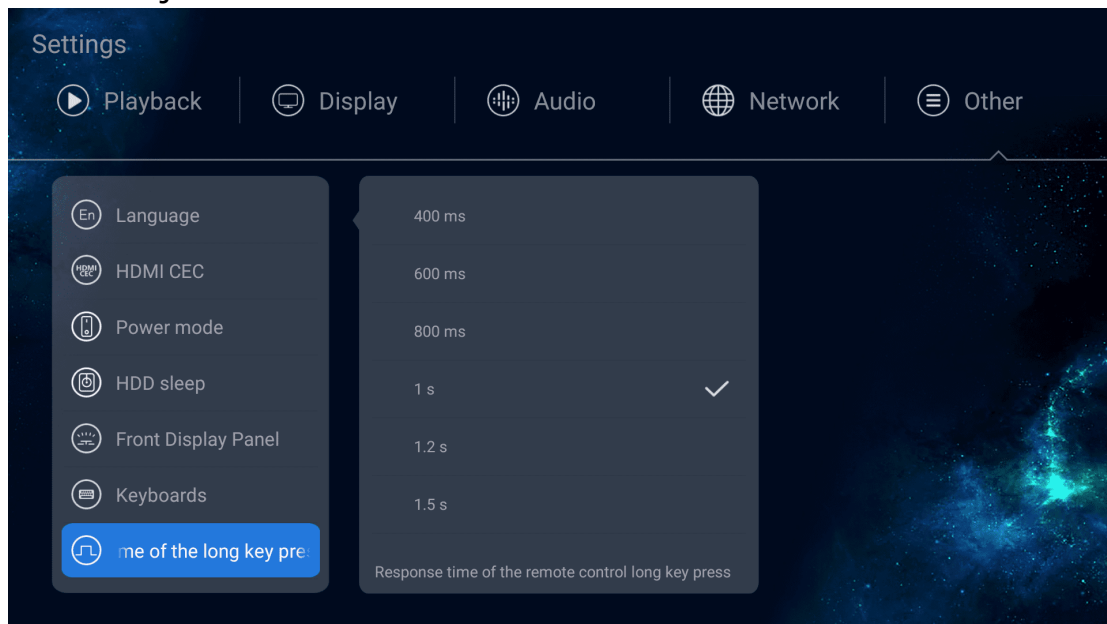

8. Upgrade

Zidoo will update firmware regularly, the system will send a popup message when new firmware is available.

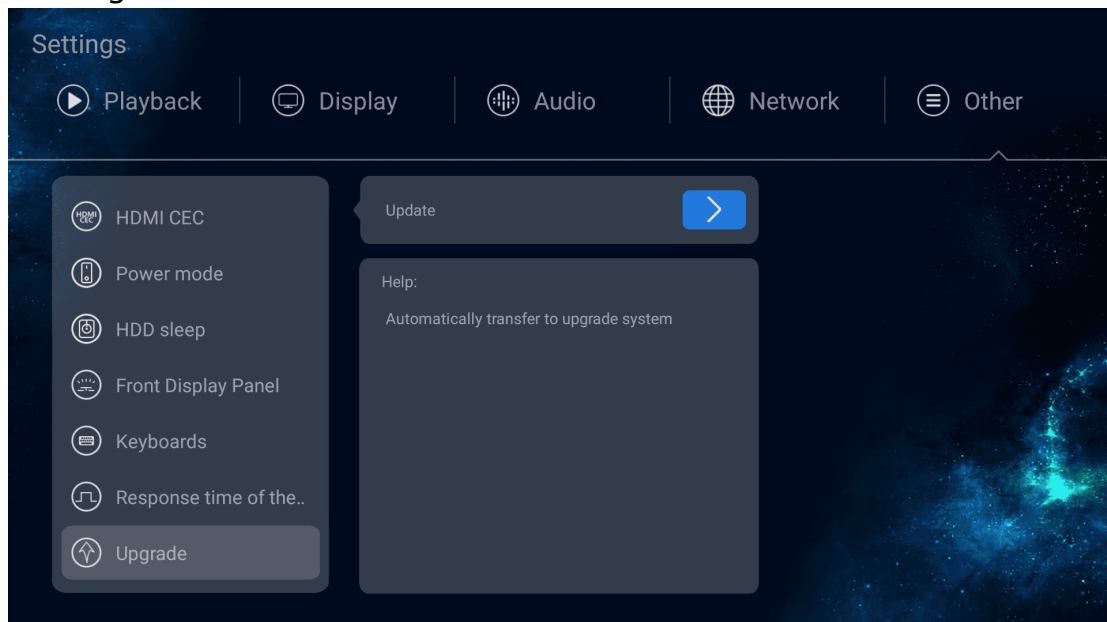

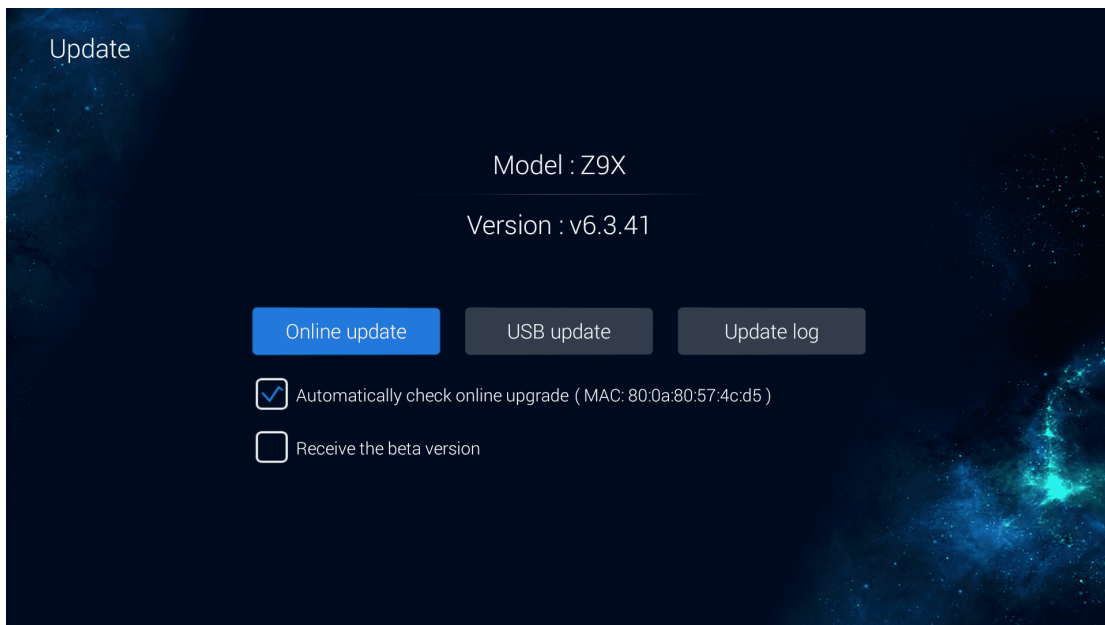

9. Recovery and Reset

9.1 Clear System application data.

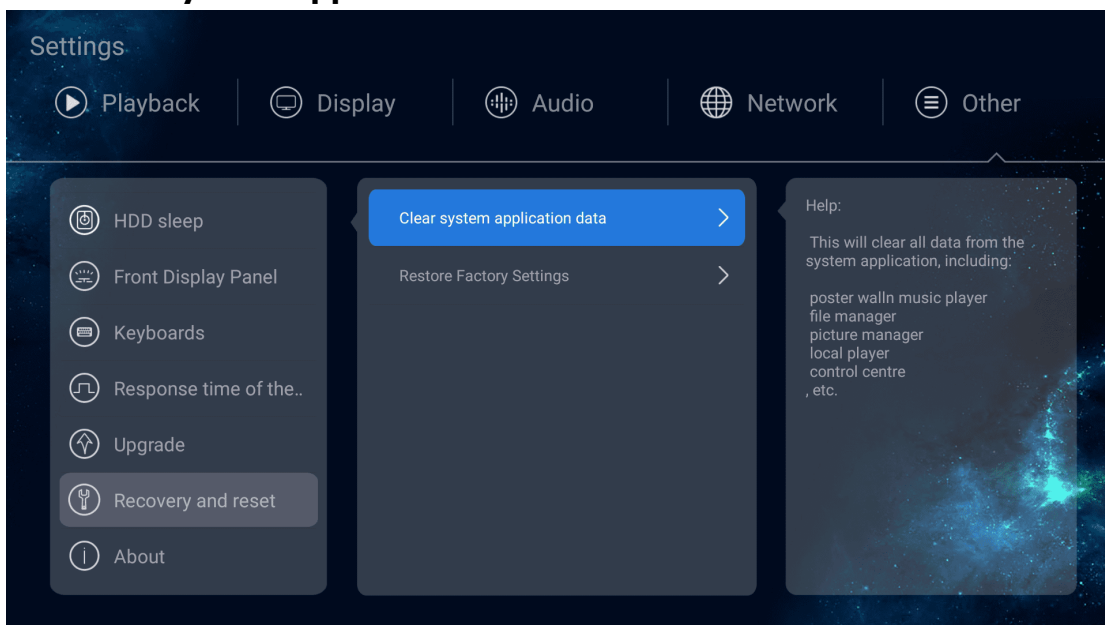

9.2 Restore Factory Settings.

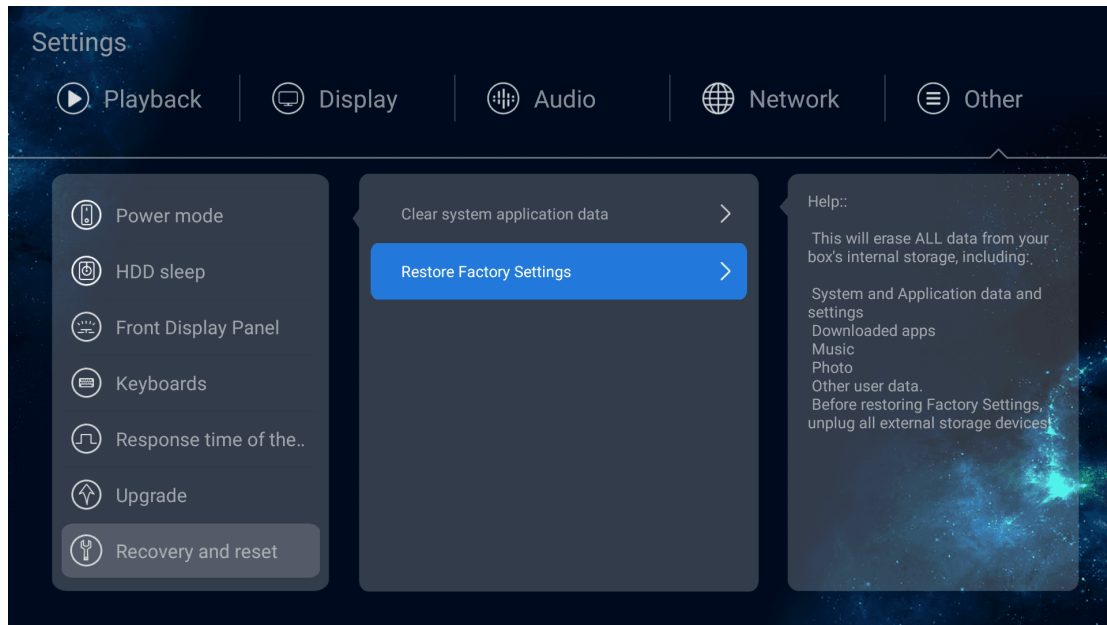

10. About

The menu will show model, MAC, firmware version and IP info etc. Advanced settings can be accessed.

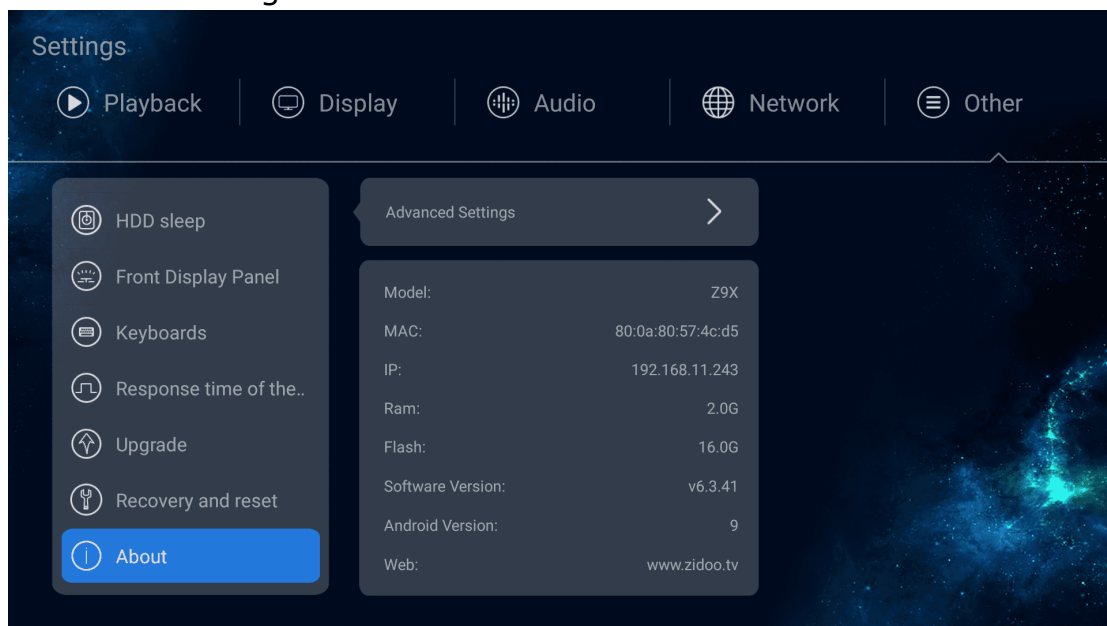

THE END