



**Indigo Dyeing Workshop 藍染体験**  
**at Kawasaki City Dentou Kougeikan 川崎市伝統工芸館**  
**Next to the Open-Air Folk House Museum 川崎市立日本民家園**  
**Friday, March 3, 2023**

You can experience a simple indigo dyeing at the Dentou Kougeikan (Traditional Arts & Crafts Museum) in Kawasaki City.

There are going to be 2 sessions - at 10:00 am or 1:00 pm, 12 participants each. You will be dyeing an eco bag (1,500 yen) or Tenugui Japanese towel (1,200 yen) and taking home your own piece of art. There is the Open Air Folk House Museum with beautiful Japanese old folk houses relocated from all over the country, and you are more than welcome to visit before or after the Workshop with a 500 yen admission fee. You may have a box lunch at the outdoor kabuki theater (or at the visitor center if rains) if you wish. Workshop lasts approximately 1.5 hours.



Location:

- The Workshop will be held at Dentou Kougeikan, located at the West Gate of the Minkaen. It is a little apart from the Main Gate, through a sloping road (see Map)

- If you come directly to the Dentou Kougeikan from Mukogaoka Yuen Station, you can get on the Odakyu Bus at the north exit of MukogaokaYuen Station and get off at the “Senshu Daigaku-mae” stop. It is a 5 minutes walk from the bus stop.
- If you come by car, the Ikuta Ryokuchi West Exit Parking Lot (with fee) is the closest.

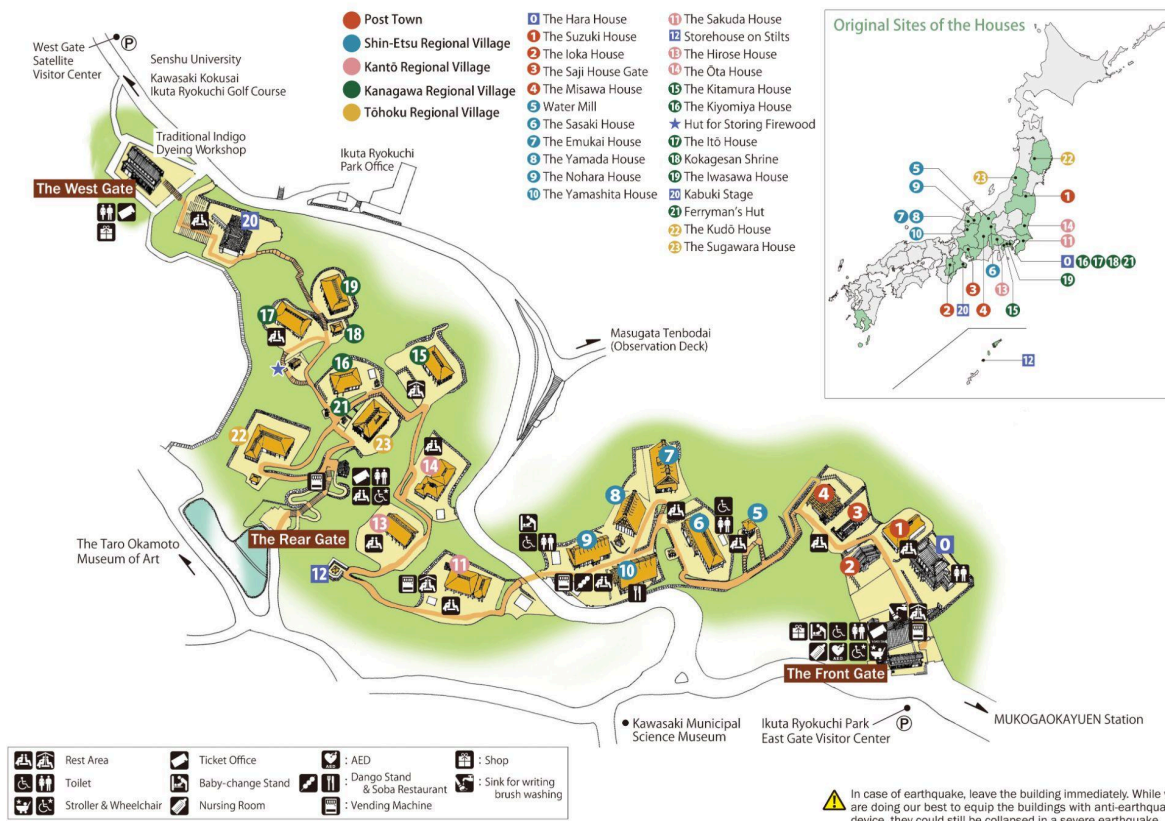

I will be at the North Exit of the Mukogaoka Yuen Station at 9:20 am, then take the 9:32 am bus to the Dentou Kougeikan. If you are attending the AM session or PM session but coming early, you may meet me at the Station.

### Cost (CASH ONLY):

Eco bag 1,500 yen or Tenugui Japanese towel 1,200 yen

Admission to the Minkaen Folk House Museum 500 yen (optional)

Bento Box Lunch 1,200 yen (optional)

### What to Bring:

**Rubber gloves, plastic bag** (you will put your semi dyed item in to take home)

### Note:

The indigo liquid splashes and may stain clothes and shoes. **Please wear clothes and shoes which you would not mind getting stained.**

### Lunch:

If you would like to order lunch, please do so by February 24 on Signup Genius. It's 1,200 yen each including tea. Lunch will be delivered to the workshop site at 11:30.

AM participants will have lunch after the workshop. (optional) You may opt to visit the outdoor museum or return home afterwards. PM participants may stroll around the museum in the morning and have lunch at 11:30 (optional), or come directly to the workshop by 1:00 pm.



Please feel free to contact me at [villageconnections@pta.asij.ac.jp](mailto:villageconnections@pta.asij.ac.jp) or 070-8360-7682 if you have any questions.

Shino Torigoe-Yeh  
Village Connections Coordinator