

# NØGGLE SHELF

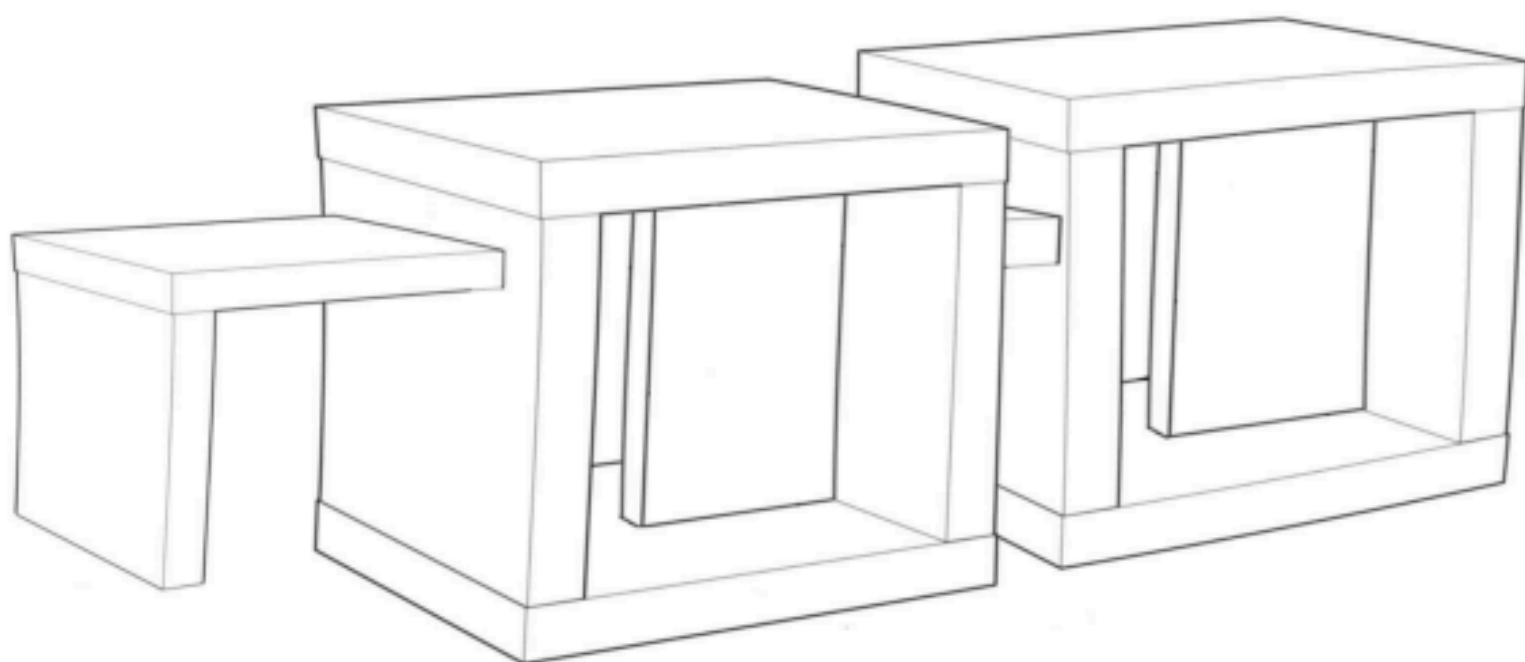

Design Nounish and Quality

You will need the following tools to complete the Noggle Shelf...

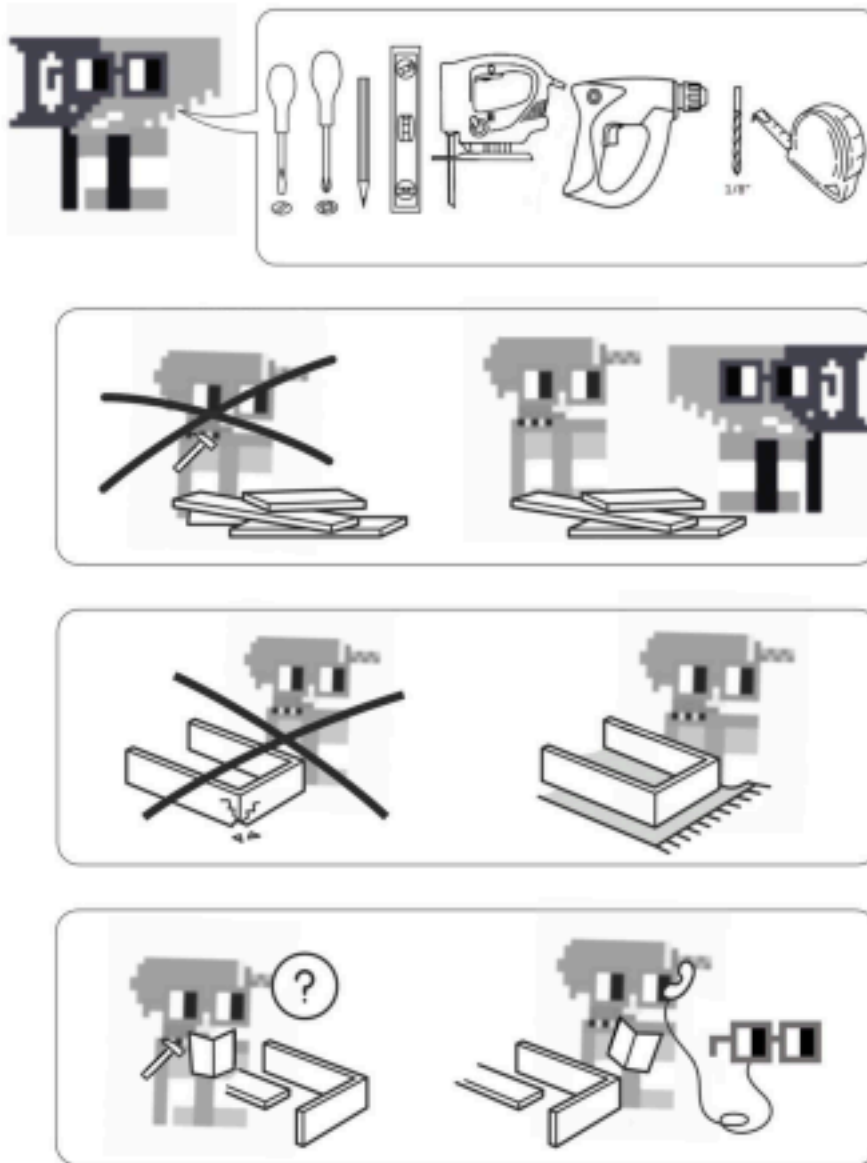

1

Buy the following parts from IKEA using the skews below **(About \$122.00 usd)**

1. [KALLAX \[Product # 203.015.54\]](#) x2 **(About \$70.00 usd)**
2. [STUBBARP \[Product #102.935.64\]](#) x1 **(About \$12.00 usd)**
3. [BILLY \[Product #502.867.50\]](#) x2 **(About \$20.00 usd)**
4. [LACK \[Product #502.821.77\]](#) x2 **(About \$20.00 usd)**

# KALLAX

2x

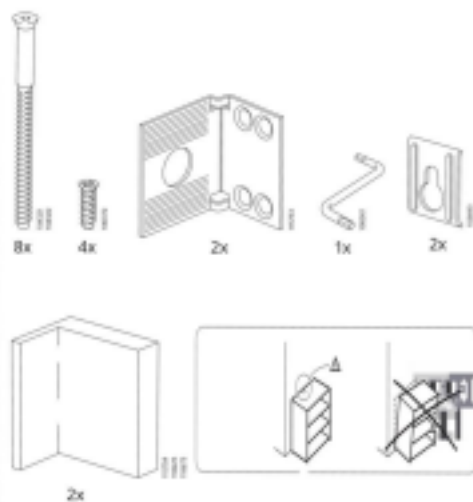

# STUBBARP

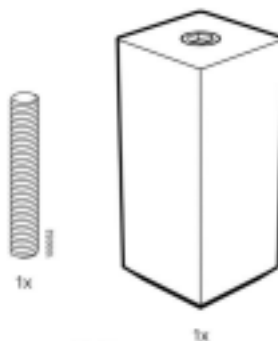

# LACK

11 3/4 x 10 1/4



# BILLY

14 x 10"

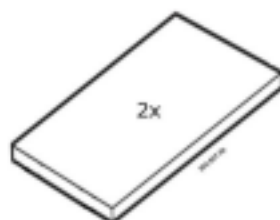

Step 1 and Step 2 are using the KALLAX parts...

**1**

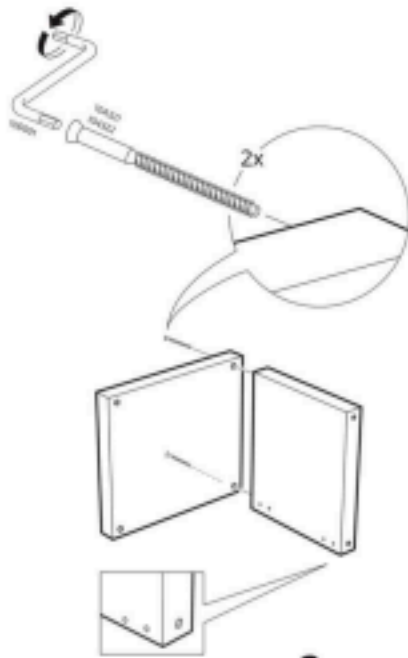

**2**

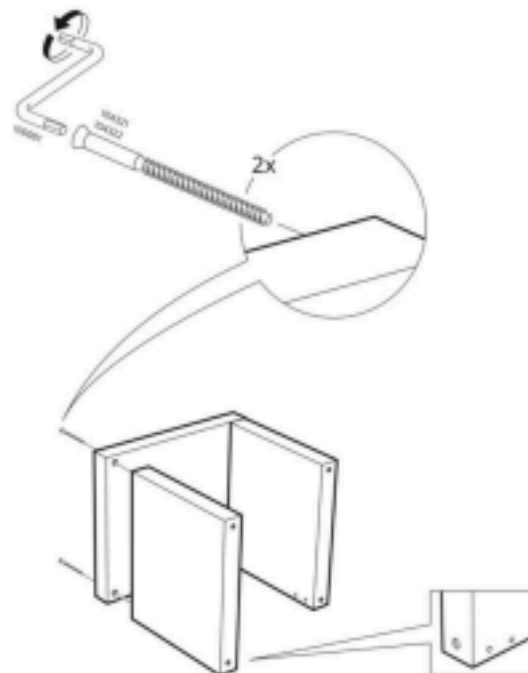

**3**

Continue building the KALLAX in steps 3 and 4 and add on the wall mount...

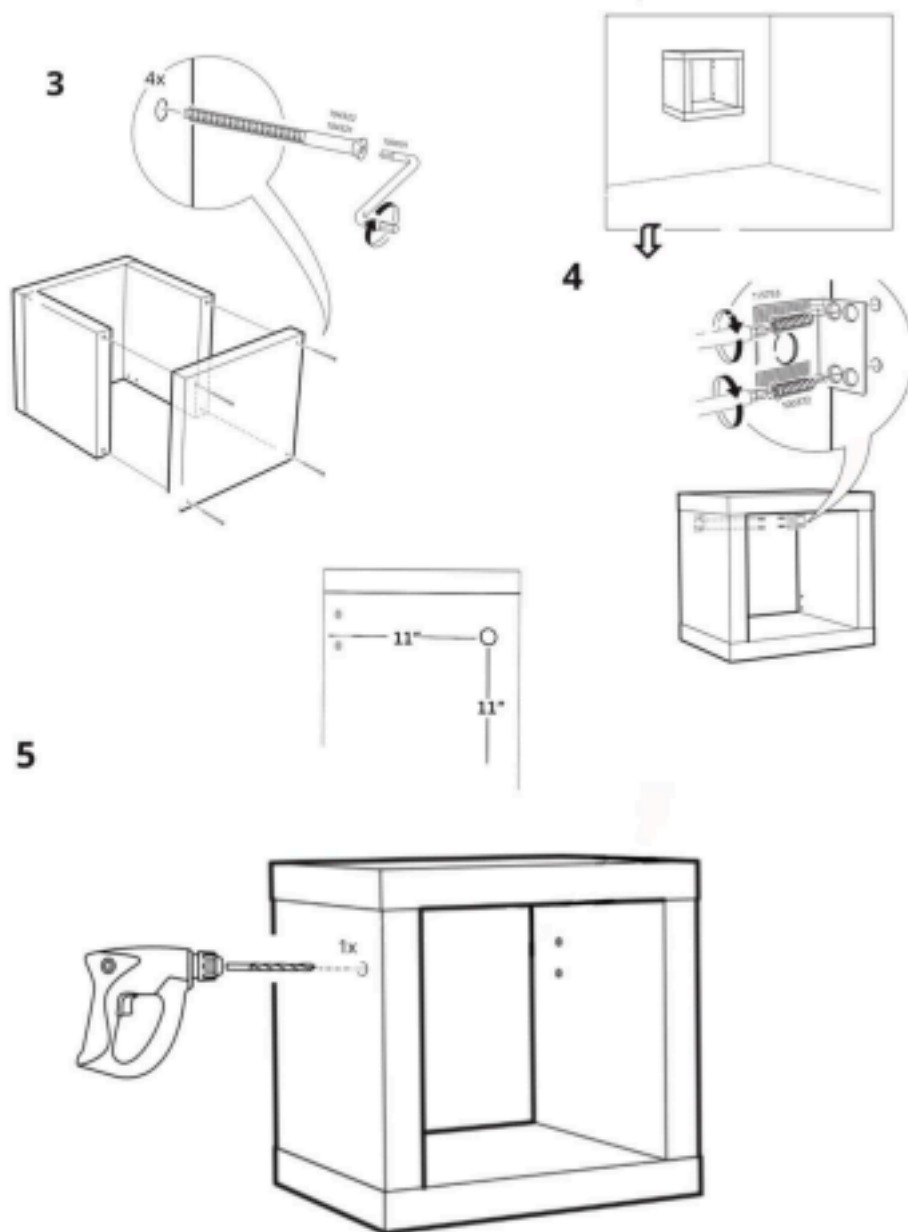

Next use the STUBBARD foot to create the “bridge” of the Noggle, by attaching it to the KALLAX...

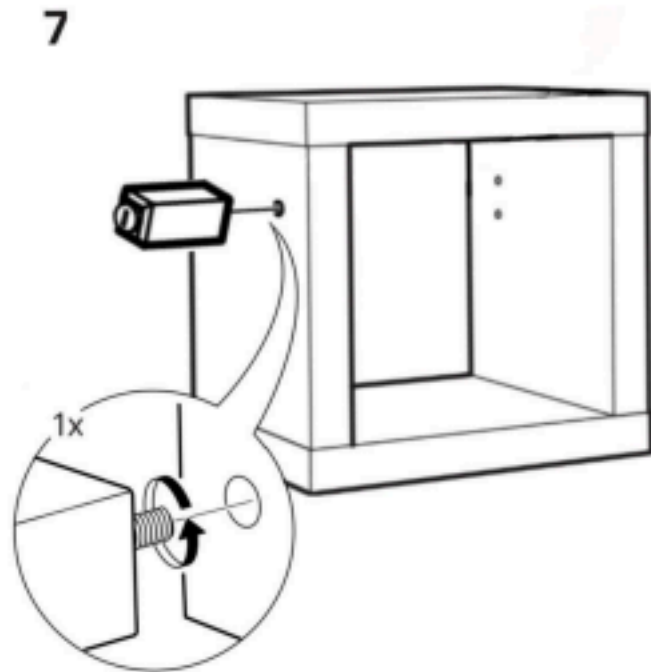
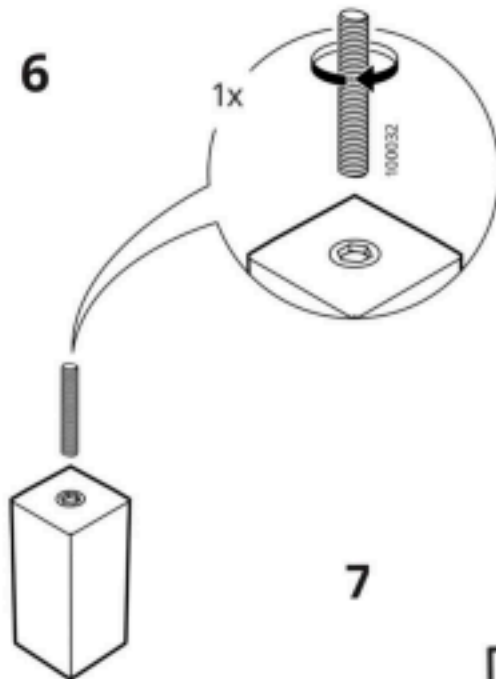

Cut the BILLY board to length. Level and mark the wall based on where you would like to hang the Noggle Shelf. Here you'll be aligning the right Noggle when looking at the wall. Attach a screw to the wall for mounting...

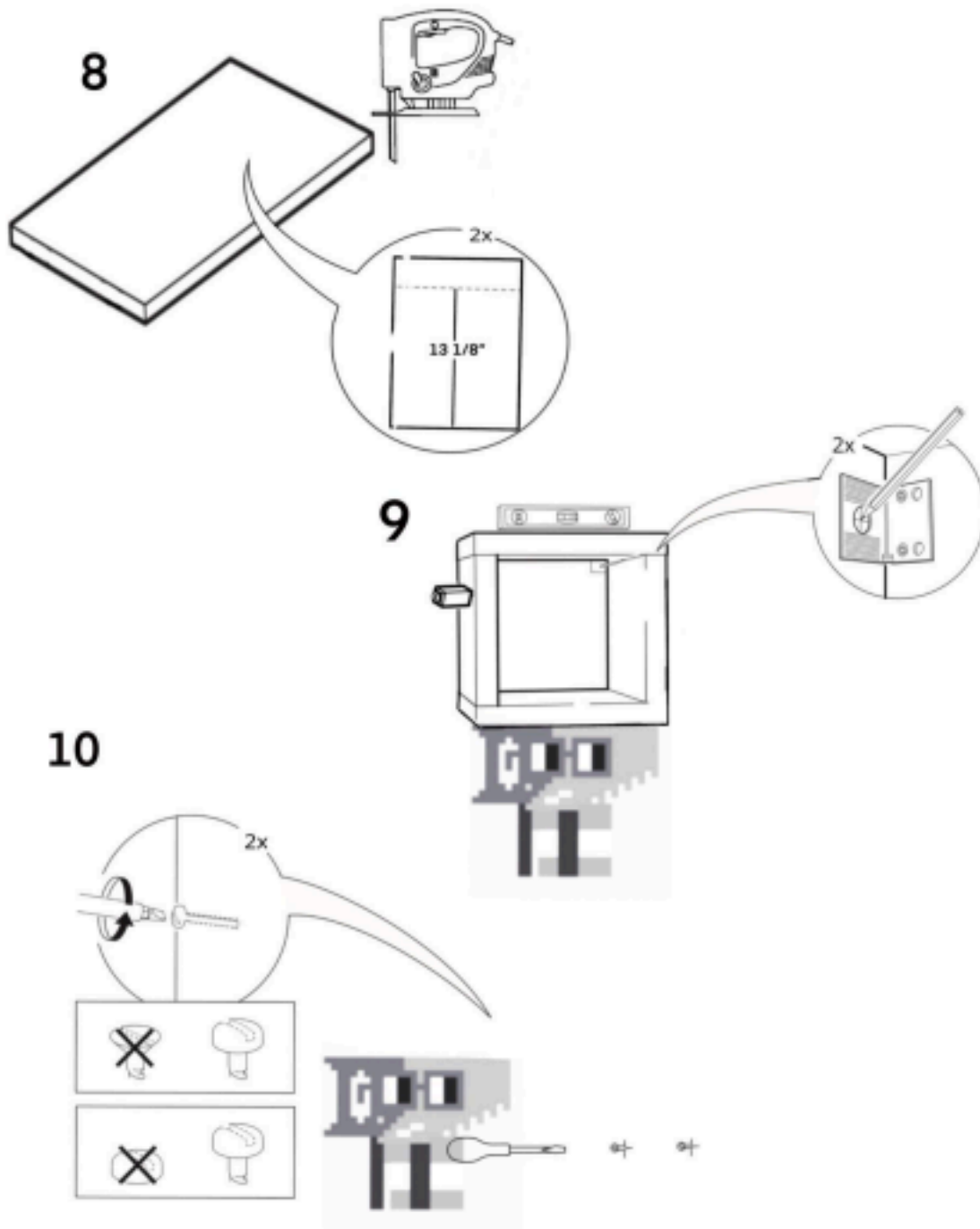

Attach the right Noggle to the wall based on your alignment from page 6

11

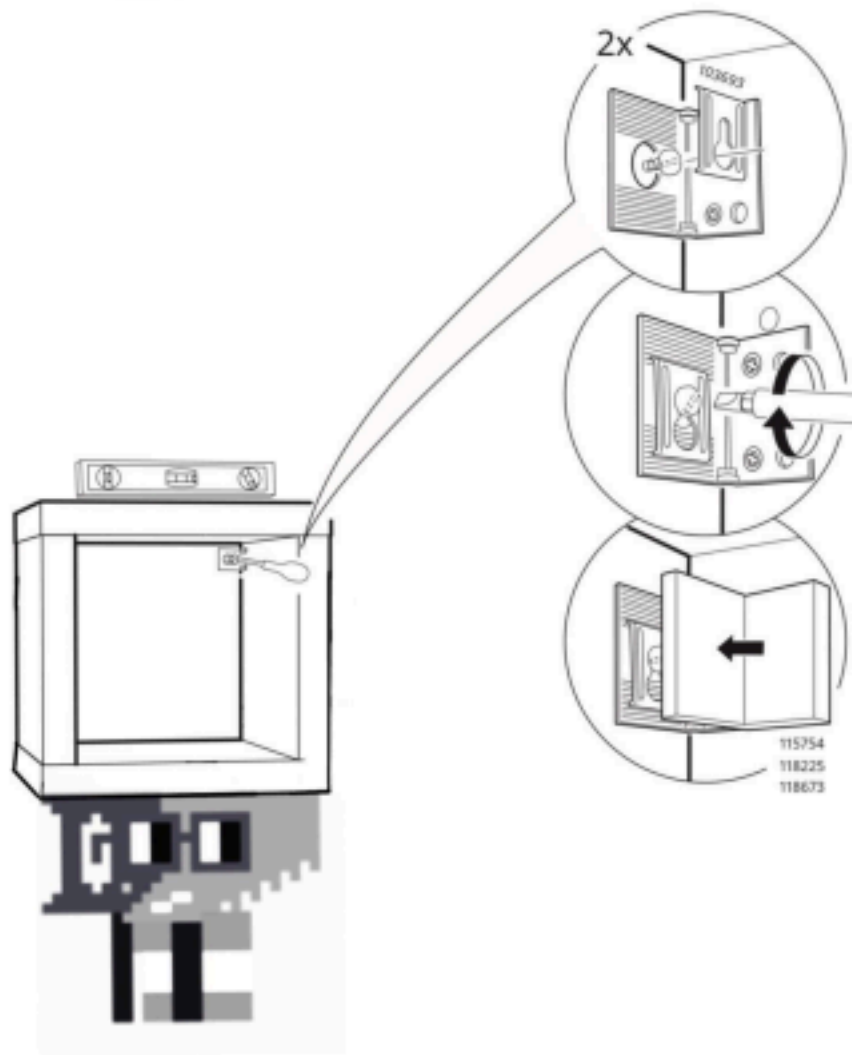



Align the Left Noggle to the wall, and mark based on where you placed your right Noggle.  
Attach a screw to the wall for mounting...

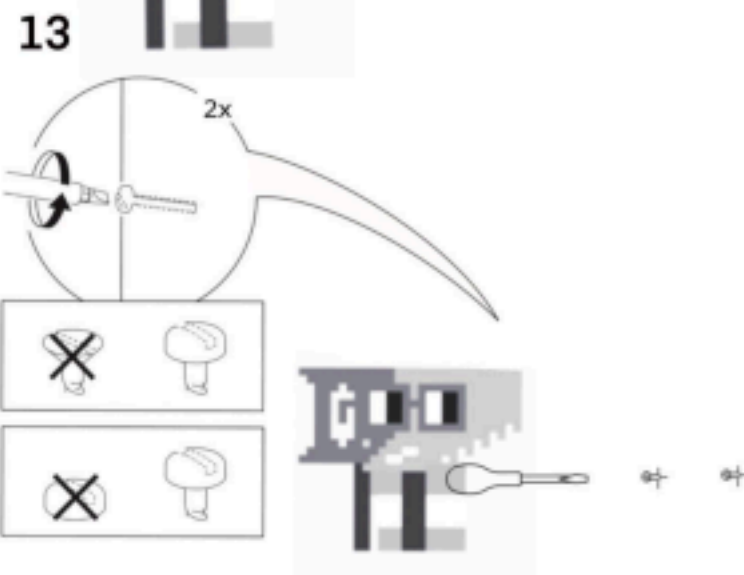
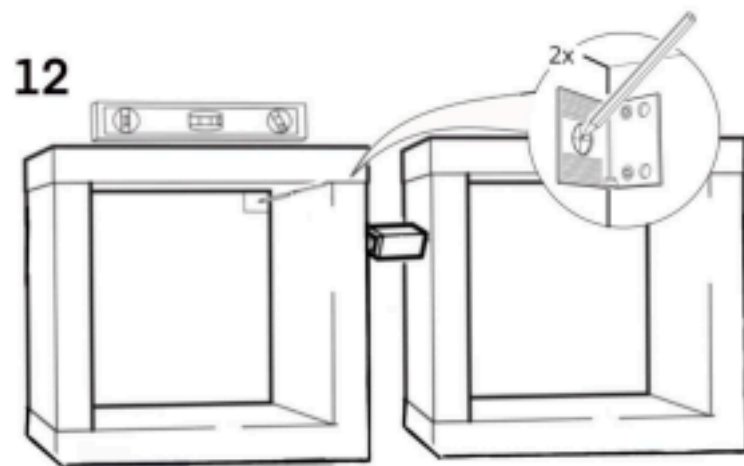

Attach the Left Noggle to the wall...

14

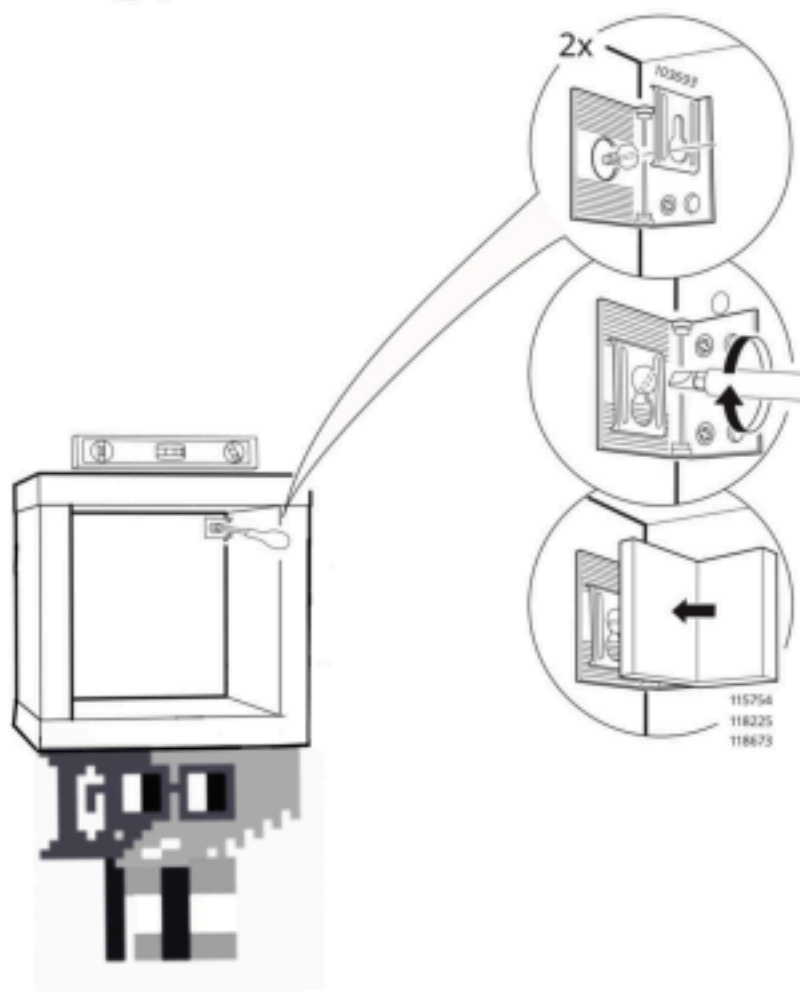

15

22.5 cm  
8 7/8"

2x

2x

10

Align and attach the second LACK shelf as the side of the Noggle arm as seen in the diagram below...

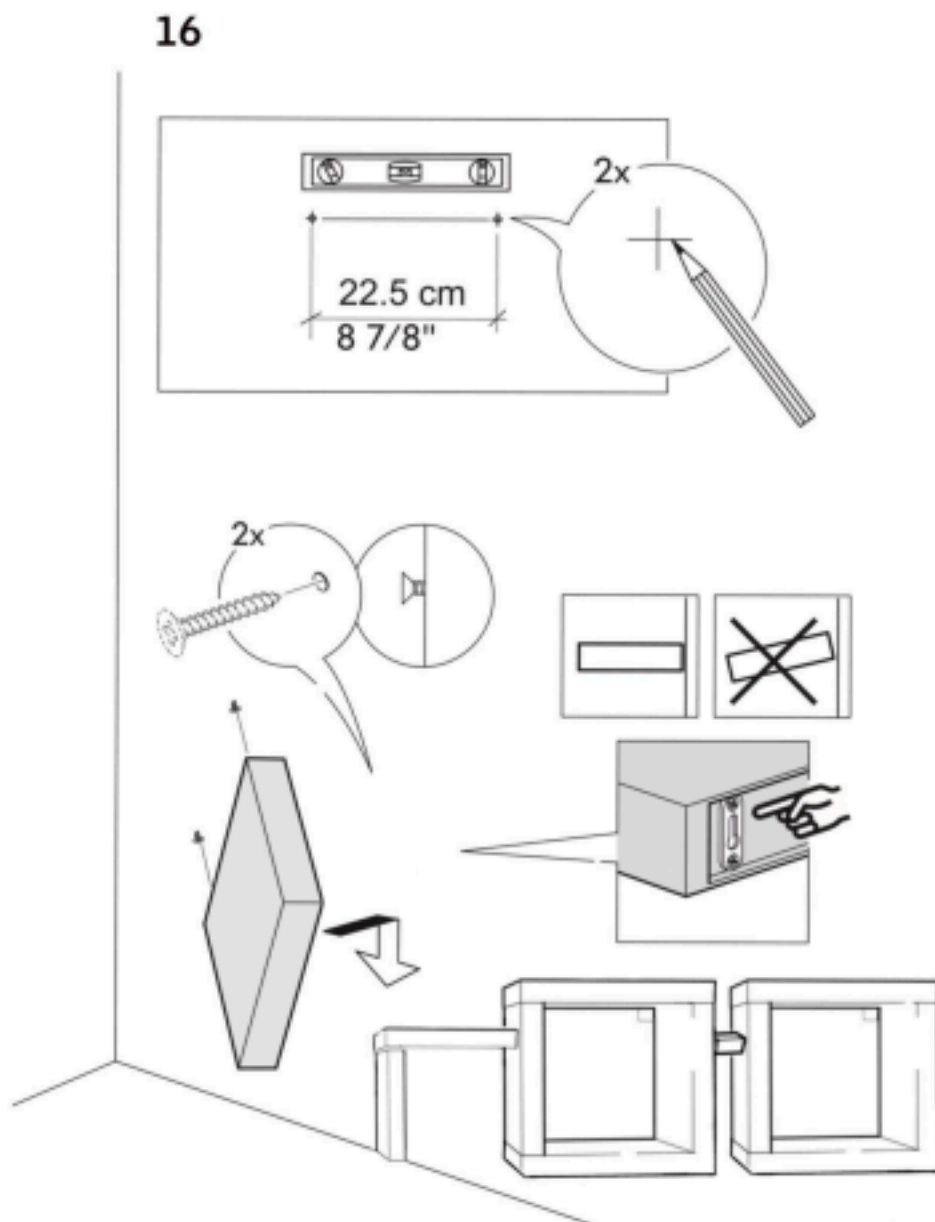

Insert the cut BILLY shelves into the center of the KALLAX cabinets, shifted whichever way you want your Noggles looking .

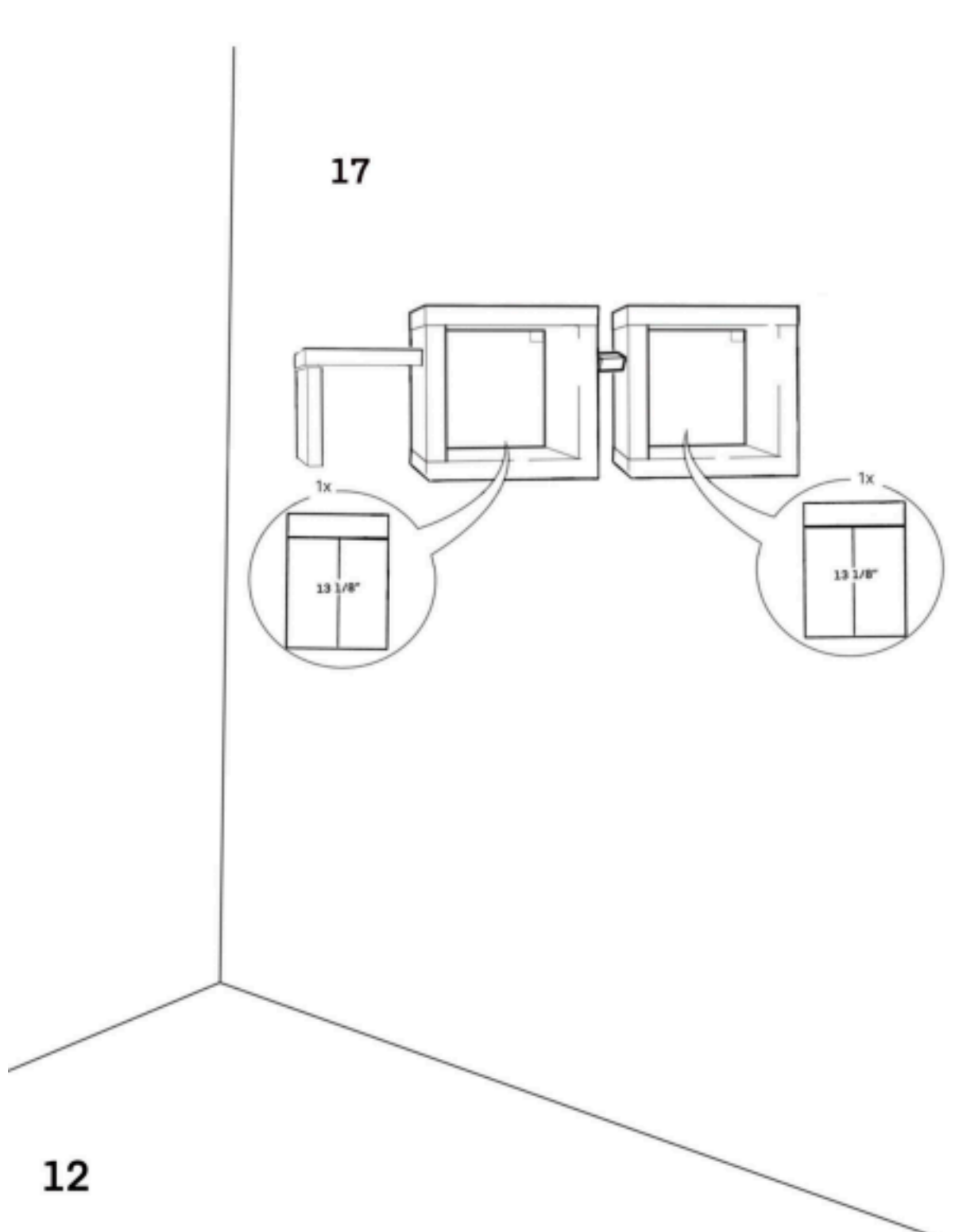

Decorate your Noggle shelf! Enjoy!



**Disclaimer:**

- Follow all IKEA mounting instructions.
- Build at your own risk.
- Prices may vary per area.
- This has no affiliation with IKEA.