

Set Up Email on Your Phone

Go to the Apple App Store or the Google Play Store and download the GMail App



Once it is added to your screen, click on the app.



Click on Sign In (If you are adding another GMail account instead, see the directions on pg. 6)



Select Google

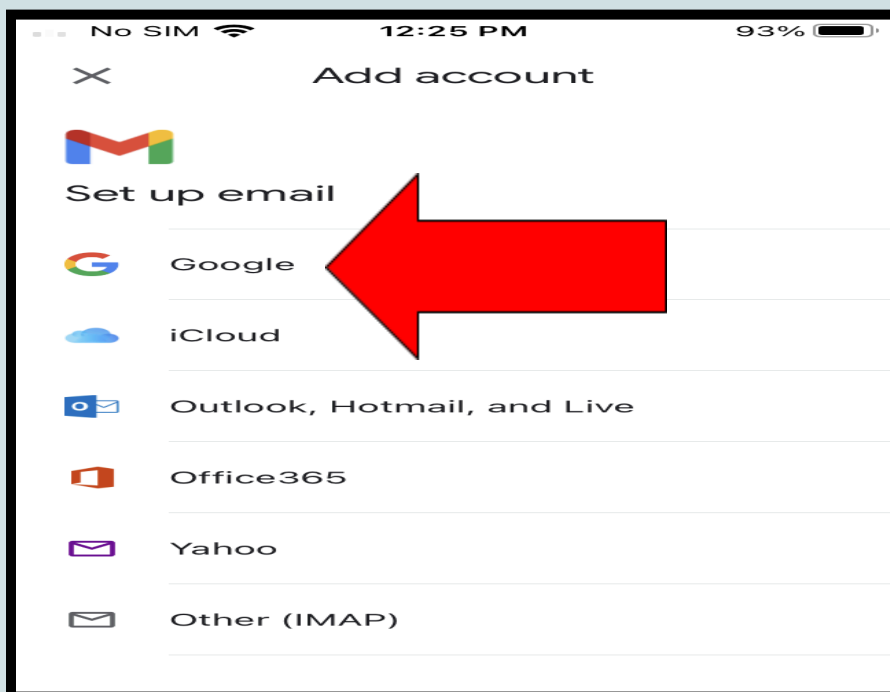

Click Continue

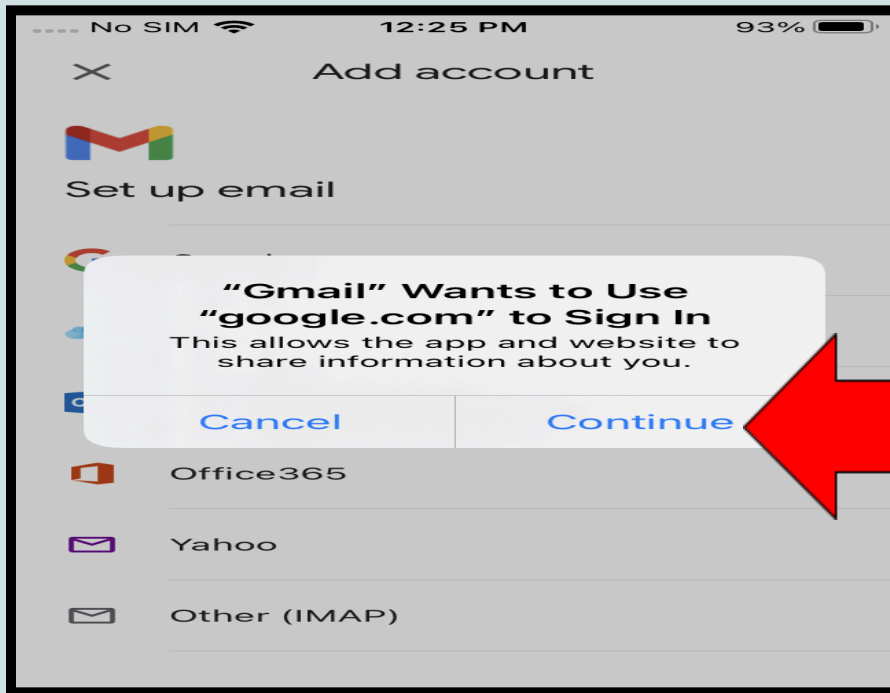

Enter your school email address and click Done

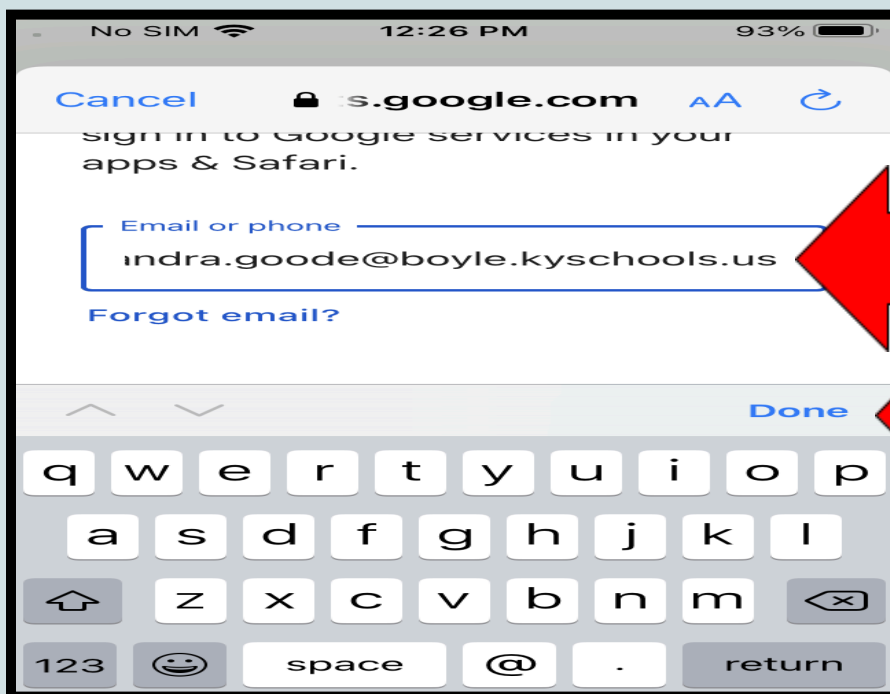

Click Next

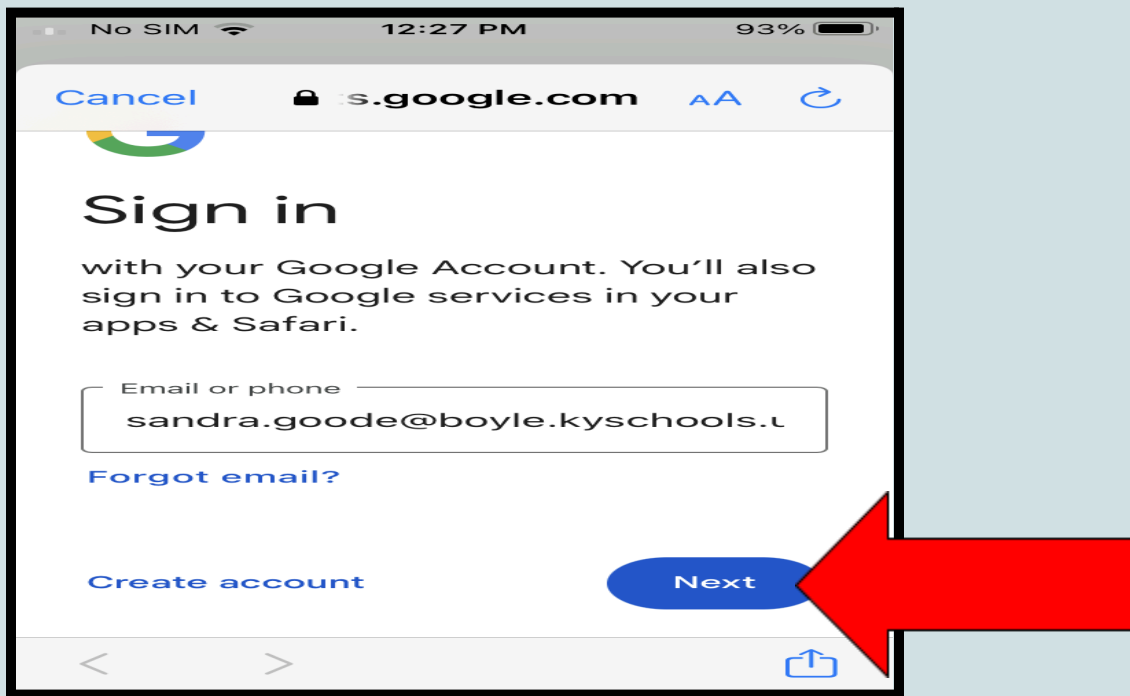

Enter your email passphrase (15/+ characters) and click Done

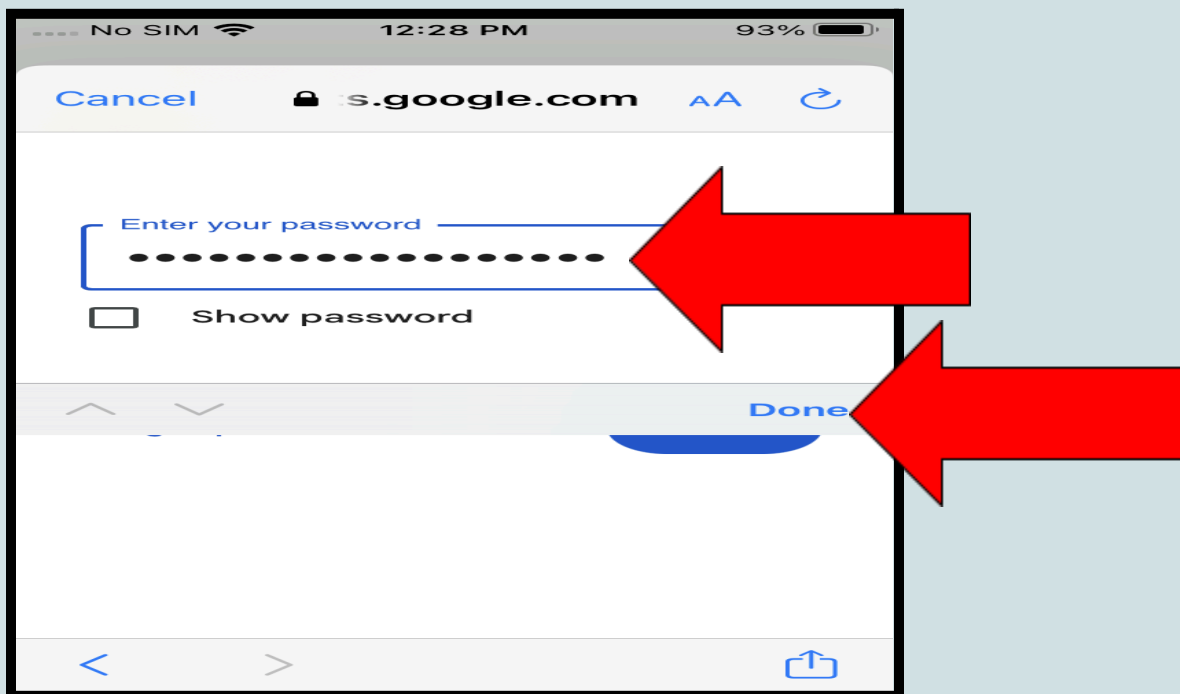

Click Next

Cancel s.google.com AA

Hi Sandra

sandra.goode@boyle.kyschools.us

Enter your password

Show password

Forgot password? Next

With the 2-Step Verification, it will text your phone to verify that it is you logging in. Just click on Yes, its me

Cancel s.google.com AA

2-Step Verification

To help keep your account safe,
Google wants to make sure it's really
you trying to sign in

sandra.goode@boyle.kyschools.us

Your Inbox should open

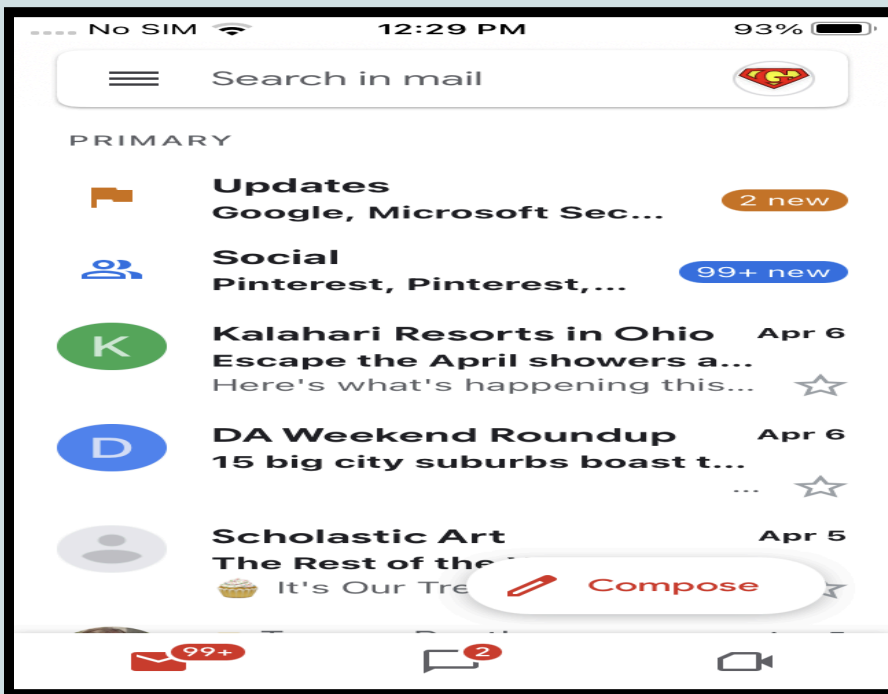

Adding Another Account

If you are adding another account to Gmail. Open the Gmail app. Click on your avatar in the top right corner

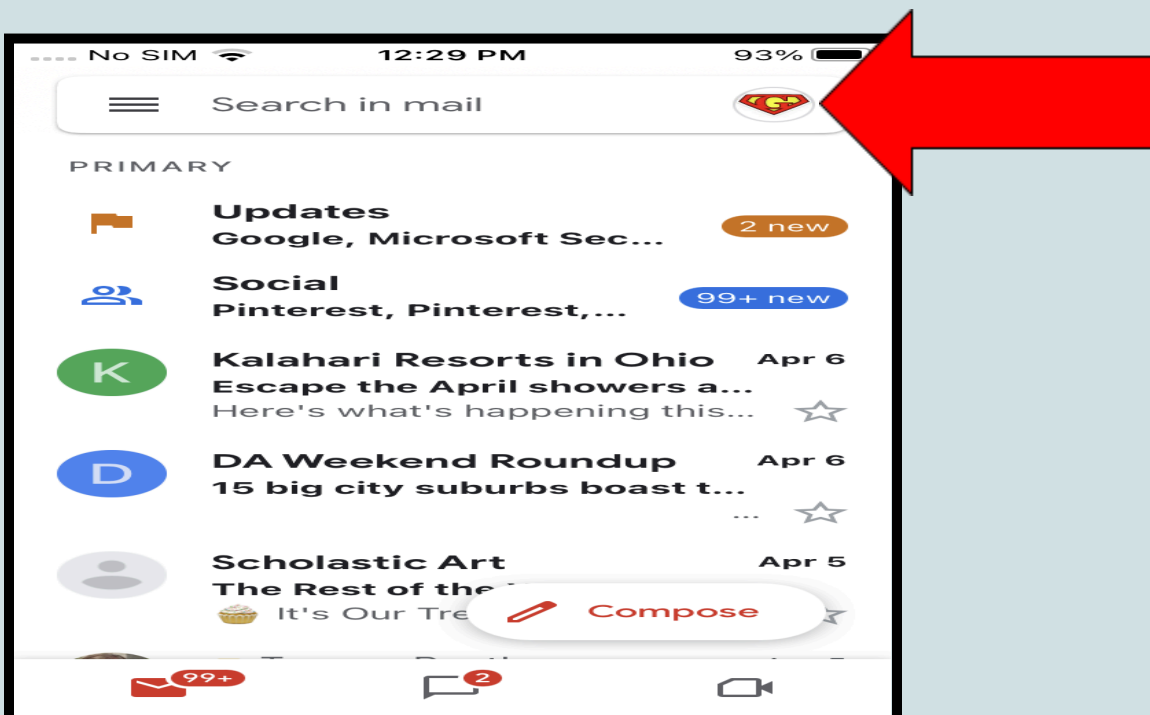

Click on Add Another Account

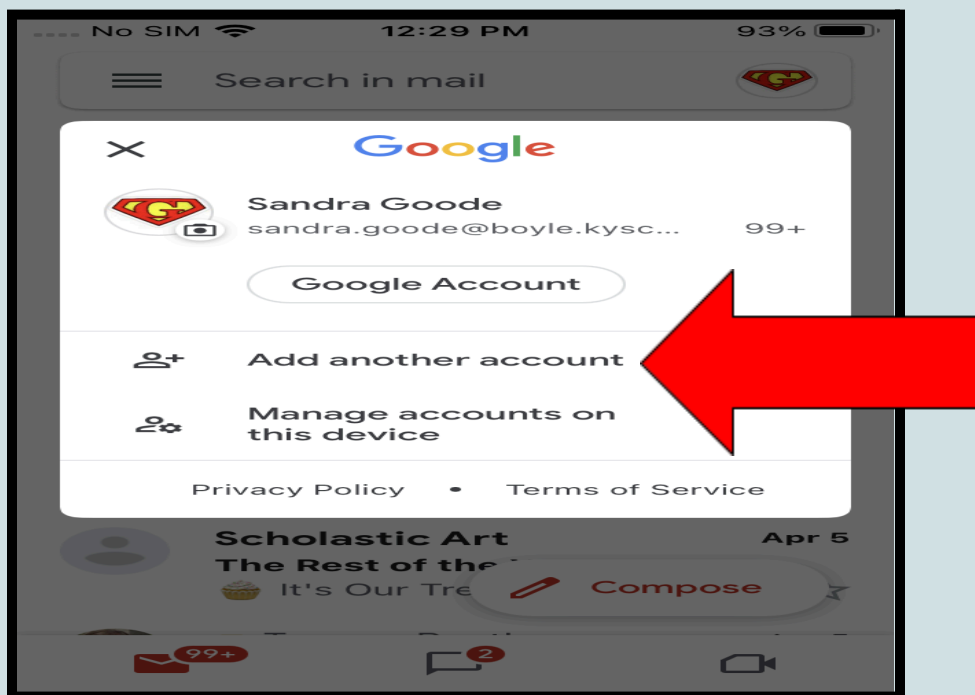

Now just follow the same steps after Sign In (pg. 2).

Remove an Account

If you need to remove an email account from a device. Click on your avatar in the top right corner and then click on Manage Accounts on this Device

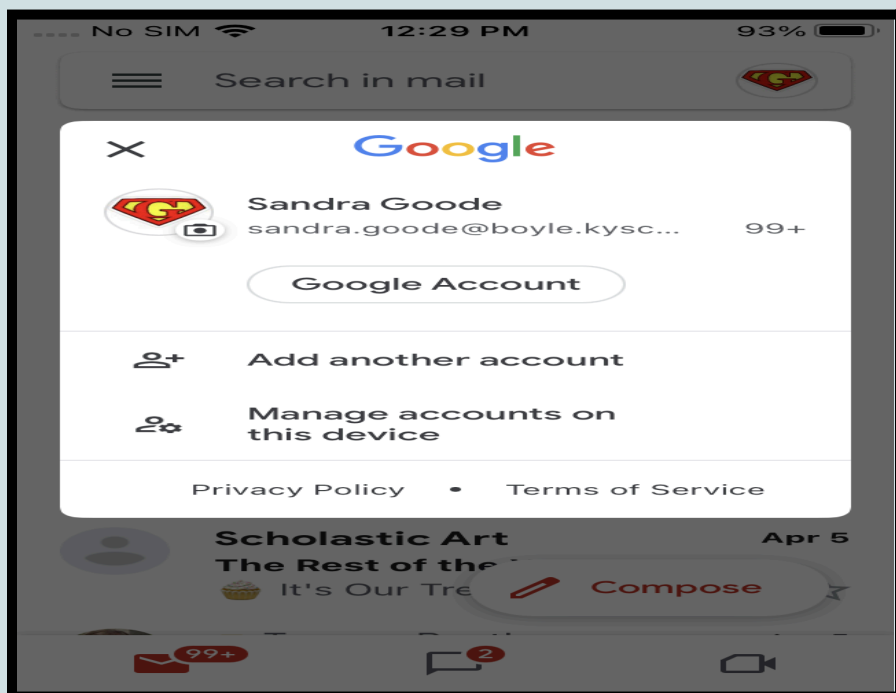

Click on Remove from this Device

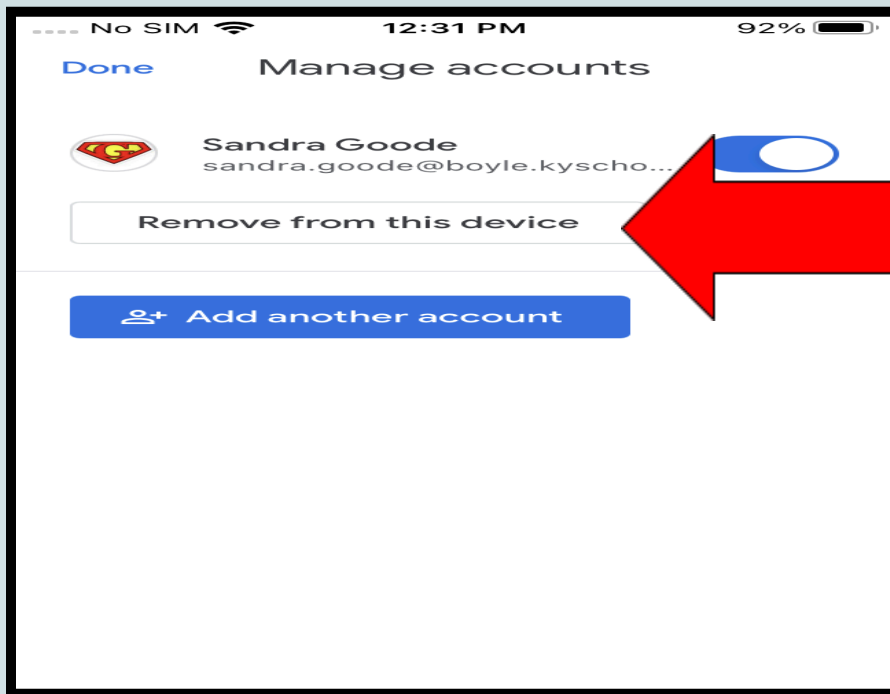

Click Remove

