

DSLR FILM NOOB Podcast #53 Show notes:



A flexible LED light panel that holds its shape. Meet the [Brightcast](#). At \$199 US, these [fairly affordable LED light panels](#) sport a CRI of 93 and sport a color range of 3200K To 5600K.

Way cheaper than other [flex options](#) on the market.



Panasonic Makes a mistake and provides free V-log to users via the 2.3 firmware update. [Here's how you get it.](#)

“We are aware of an oversight in our Panasonic Image App which allows enabling of V-Log L as a “custom” setting without purchase. This was not our intent, and our apologies for the oversight.” - Panasonic

“Use of the V-Log L workaround associated with firmware Version 2.3 runs the risk of the Zebra Function not working and the Histogram reading improperly.” - Panasonic

[New video from Canon's ME20f](#)

Canon's recently announced ME20F-SH camera caused a bit of a stir due to its headline equivalent ISO of 4,000,000. The camera's full frame sensor is tuned for maximum sensitivity and as a result only has a resolution of 2.2MP. Those pixels are supersized, however, which helps greatly improve its sensitivity to light: essentially, the user is able to record in the dark.

Canon Japan have posted vision from the camera, which shows some of the expected applications of the \$30,000 body: shooting wildlife at night and underwater photography are two examples. And although it's destined for specialist shooters it's nice to see a few dings and scrapes on the camera body. This may be a prototype but it certainly looks like it's been tested in the real world.

Screengrab of iso 4,560,000 at night with no lights (and no moon I guess) see 2:55 of video

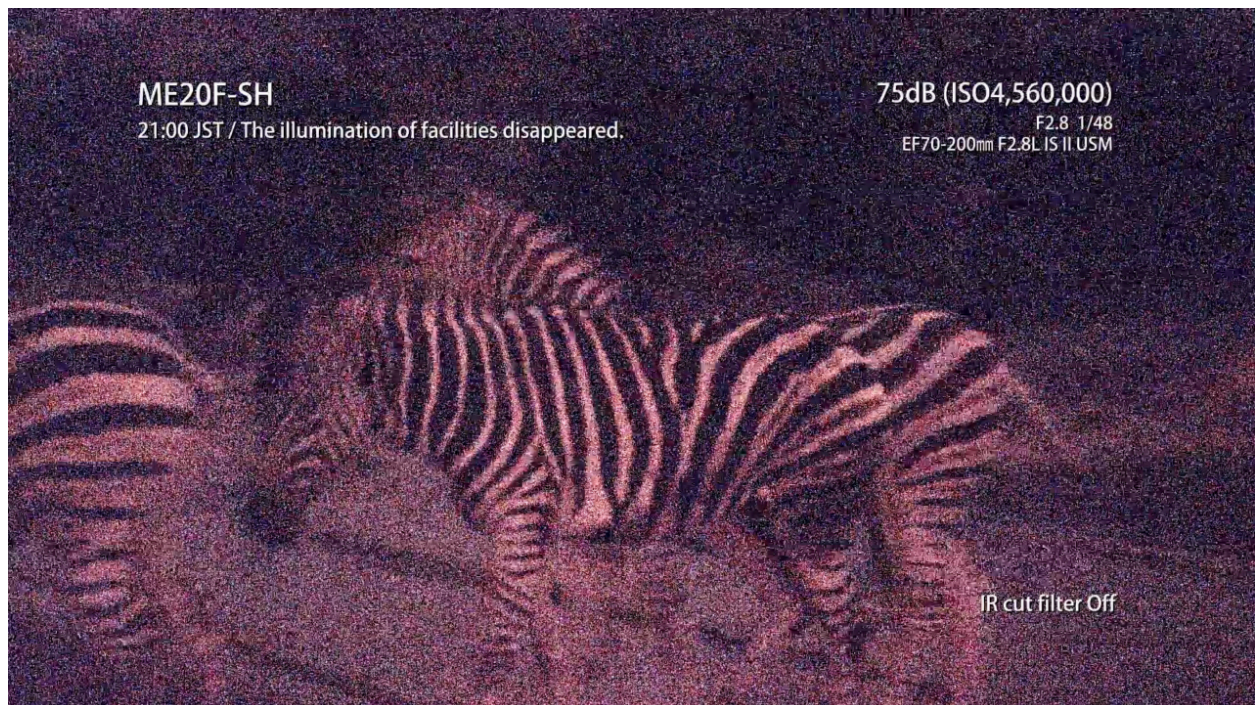



402,000
804,000
1,600,000
3,200,000



So I bought a [Drobo](#). I don't normally go this route, but I was running out of drive space in my editing bay and needed to beef things up. USB 3.0 gives me just 200MB reads/writes with the latest version of the 4 bay drobo and it was very easy to setup.

Tell us more about the [Canon Expo](#)

ok - [new post today about expo](#)

[40mm f2.8 review on the 5ds.](#)

Canon Expo tour can be found here: https://expo.usa.canon.com/?page_id=373

Genus Variable ND Filter



Ever since the beginning of the DSLR revolution camera operators have complained about having to use screw-in neutral density (ND) filters or matteboxes – countless shots have been missed as shooters fiddle around changing filters. Variable NDs can be a useful option but they need to be swapped between lenses and can introduce colour shifts and polarisation effects.

Their lens adapter with built-in electronic ND is designed specifically for mirrorless cameras and will look similar to adapters from Metabones, Novoflex, Aputure, MTF and others. The one we were shown was a Canon EF to Sony E-mount version.

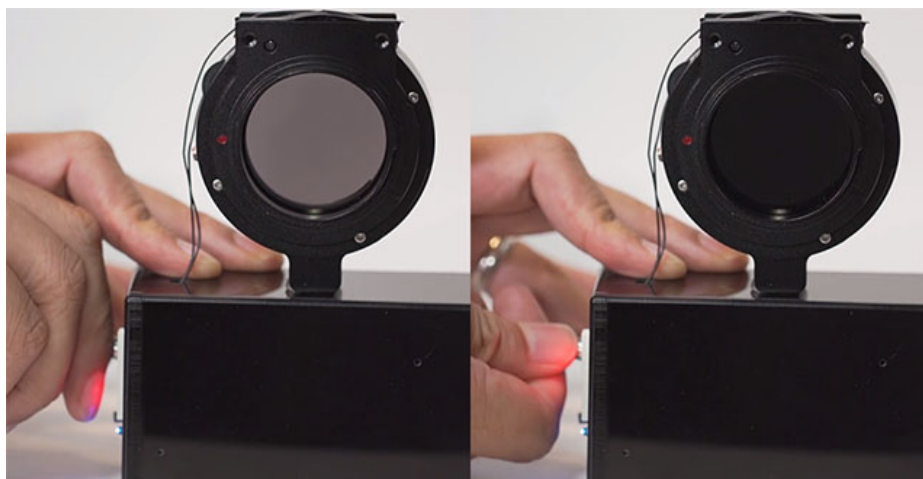



A Mitakon has released a \$399 [voigtlander 25mm f0.95](#) M43 competitor called the [SPeedmaster](#). Half the price and it comes in a fancy leather box. Will the optics look as sharp as the packaging?

Timings:

Flexlight: 2:05

ME20F-SH : 7:50

Panasonic GH4 mistake: 20:00

Drobo: 27:30

Canon Expo: 36:00

Genus variable ND: 43:10

Mitakon Lens: 50:20