

SPOTLIGHT THEATER

Technical Packet

Revised May 2021

COVID-19 Addendum

All information contained in this document is subject to current guidelines from the State of Vermont related to capacity, policies and procedures. Any rentals or other scheduled use of the space can be altered or cancelled in accordance with State guidelines.

About Spotlight's Black Box,

Although its primary use is for performing arts education, The Black Box is a very versatile intimate performance space. There is no fixed seating: portable staging and seating risers enable the creation of any kind of theatrical space—arena, thrust, or endstage. Or, for small, informal musical events, café style tables and chairs can be used. Lighting positions allow theatrical lighting anywhere in the space.

Black theatrical draperies can be closed to mask the dance mirrors. Plans include adding a second drapery track behind the black to support versatile combinations of soft goods including rain curtains, projection, and a variety of textures and colours.

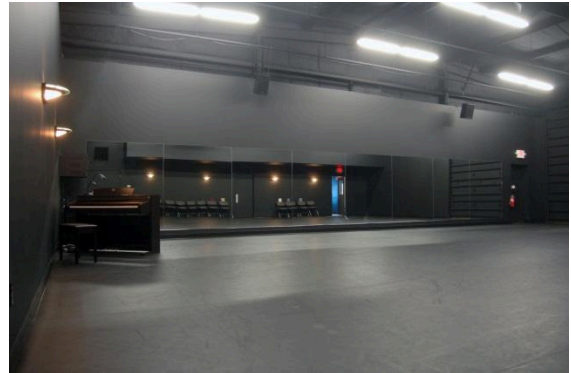

NOTE: WHENEVER POSSIBLE, THE EQUIPMENT DESCRIBED THROUGHOUT THIS DOCUMENT HAS LINKS TO PRODUCT MANUALS FOR YOUR CONVENIENCE. SIMPLY CLICK ON THE EQUIPMENT NAME AND THE MANUAL WILL OPEN.

Technical Specifications

House

Per the Fire Marshall, when in use as a performing arts facility, seating capacity in Spotlight Theater is limited to 80 seats. The total capacity for Spotlight Theater is 100 including performers, staff, crew and audience members.

Space Dimensions

47' X 32', 1,500 square feet (roughly the footprint of the Flynn Center mainstage).

The lighting pipes are 13' 9" from the floor.

Floor

As you might expect given its primary use as a dance studio, the entire floor of the performance space in Spotlight Theater is fully sprung and optimized for dance and performance. The floor and subfloor are manufactured by StageStep of Philadelphia. Specifically, the subfloor is [Springstep IV](#), and the surface is [Timestep](#), the ultimate multi-purpose dance flooring, ideally suited for all movement activities including ballet, tap, theatrical, jazz,

folkloric, modern, ballroom, and character. This heavy-duty permanent flooring can handle heavy scenery, props, and percussive dance.

Nailing or screwing items into the floor is strictly prohibited.

Load-in

There is a large (12' X 14') overhead door on the south side of the studio.

NOTE: Motorized vehicles are strictly prohibited on the floor. The Springstep subfloor cannot support the weight and will be damaged beyond repair. Renters are liable for the cost of replacement of the entire floor and subfloor.

Stage Equipment

80 chairs for theatrical seating
[Intellistage portable stage/seating risers.](#)
(8) 16 sq. ft. platforms
(8) 8" Risers

(1) 12' Fiberglass Ladder (300lb capacity)
(1) 6' Fiberglass Ladder (300 lb Capacity)

Café seating is allowed. The studio has (10) 24 inch round tables and (5) 30 inch round tables that may be used.

[Yamaha Clavinova CLP-330 piano](#) (w/dolly)

Kurzweil SY88 Stage Piano

(1) [Behringer K900FX](#) Ultra-Flexible 90-Watt 3-Channel PA System /
Keyboard Amplifier with FX and FBQ Feedback Detection

Behringer [Eurolive B105D](#) - 50 Watt Personal Monitor

Backstage Facilities

1 green room (teacher's lounge in mezzanine) accommodating 8 people,
chairs, tables, coffee maker, microwave, and mini-fridge;
2 dressing rooms accommodating a total of 14 people (one located in the
front Studio section).
2 accessible toilet rooms

Lighting, sound, video control booth located in the mezzanine.

Communication

At this time the studio does not have any communication/intercom
equipment in house. We can recommend rental options.

Network Infrastructure

Our ISP is Comcast Business. Spotlight has commercial grade service with a guaranteed 1G/35m download/upload speed.

Spotlight Vermont's facility has a WiFi guest network for use by patrons, students and family. The SSID for the network is "Spotlight Guest" Please see front desk personnel for the guest network password.

The facility is also served by a wired network with Cat6 cable throughout. Wired ethernet access is available in each studio and also in the mezzanine control room. This network is secured and generally not available for public use. If you need access please contact us.

Video Capture/Streaming Infrastructure

Spotlight Media Productions, a subsidiary of Spotlight Vermont, manages and operates the video capture/streaming infrastructure throughout the facility. Cameras, video displays, audio capture and robust transport using Newtek's NDI network infrastructure are installed throughout.

- Each studio has one or more cameras, a large video display, audio capture and PCs with Zoom (Spotlight's remote teaching solution) and several other communication clients installed.
- Our Black Box theatre supports robust HD quality streaming and capture with a potential for 7 camera mixing under normal circumstances. We have several discreetly located PTZ (pan/tilt/zoom) cameras permanently installed and a collection of 4k ZCam cinema cameras as well as HD and 4k professional cameras with dollies. All cameras are connected to downstream video and audio equipment using NDI.
- Our camcorders are programmed with profiles to allow for seamless integration between handheld video quality and ZCAM video quality.
- Our video switching platform is vMix 4k Professional. Audio sourcing is through our Behringer x32 digital mixer. We have the ability to provision green screens, virtual backgrounds and more here!

Projection

70" 4k Flat Screen video display hung over a mirror - This display can be used in a variety of ways. Typically it is used as the main display for Zoom participants when classes are underway.

Ceiling mounted digital projector – NEC PA-550W (1280x800 3LCD, 5,500

lumen) w/NEC NP13ZL Lens. Currently used to project on the Mezzanine wall for talent info and/or karaoke nights.

Rose Brand stretch shapes also available for use as projection surfaces (additional charges apply).

Remote Controls

Remote controls for the in room monitor, digital projector and CD player are located in a carousel on the PC Desk in the northeast corner of the studio.

A computer with VMIX installed is located in the mezzanine above the studio. It can be used to remotely control our PTZ cameras (more information below)

Sound

The standard house installed system is comprised of two Community Veris 8 full range speakers, 18' Subwoofer, Behringer EP1500 amplifier, Rolls Mixer and Tascam CD player with Ipod dock. The electronics are located in a wall mounted rack in the northeast corner of the studio. From an output standpoint, this system is usually more than adequate for most needs anticipated within the space.

If needed, the house has a complement of more robust equipment that can be used to replace or augment the installed system. (Additional charges apply).

Input:

- (4) Shure SM57 Dynamic Microphones
- (1) Shure Beta 58 Dynamic Microphone
- (3) Shure A2WS
- (2) AKG D1000E Dynamic Microphones
- (2) AKG D880 Dynamic Microphones
- (2) Behringer C-2 Matched Studio Condenser Microphones
- (1) Behringer C-3 Dual-Diaphragm Studio Condenser Microphone
- (2) Behringer B-2 Large Diaphragm Studio Condenser Microphones
- (2) Audio Technica AT2020 medium diaphragm side-address studio condenser microphone
- (1) Audio Technica ATM650 Hypercardioid Dynamic Instrument Microphone
- (1) MXL V67Q Stereo Condenser Microphone
- (1) Freeway ATW-T602B Condenser Microphone
- (1) VidPro XM-55 Condenser Microphone
- (1) Rode NTG-1 Condenser Microphone
- (1) MXL V67Q STEREO Condenser Microphone

- (1) [ROLLS RM69](#) Mic/Source Mixer
- (1) Behringer [Compact X32 Digital Mixer](#) - 40-Input, 25-Bus Digital Mixing Console

- (1) Lenovo tower computer with NDI and ASIO connectivity
- (1) Cockos Reaper License with ability to record 16 track Audio
- (1) [Tascam CD-200I](#) CD PLAYER w/IPOD DOCK
- (1) [Lexicon MX200](#) Dual Reverb/Effects Processor

Output:

- (2) [Behringer EP1500](#) Power Amplifiers (2ch X 260w @ 8ohms)
- (1) [QSC DCA-1622](#) Power Amplifier (2ch X 300w @ 8ohms)

- (2) Community Veris 8 FOH Speakers (dead hung)
- (2) Community Veris 6 Speakers

- (1) Marathon PA18100 18" Subwoofer
- (2) JBL SF12M 2-Way 12" Stage Monitor
- (2) Behringer B1520 2-Way 15" Speaker

Misc:

- (1) 100 ft. 12/4 XLR Snake (permanent install)
- (1) 100 ft. 8/4 XLR Snake
- Supply of Various length XLR Microphone Cables
- (10) Microphone Stands

Control:

Sound can be run either from the house or the sound/lighting booth in the mezzanine. There is a 100' 12/4 snake to the booth that provides return to the FOH amplifiers and monitor feed.

Theatrical Lighting

House Plot:

There is a standard plot in place which provides general lighting control across 6 areas. The house EOS control system has submaster control at a discrete area level. There is both a cool and warm side wash as well and several stage washes with patterns. Finally, there are three moving lights

patched for special needs.

Service:

There are (24) 20 Amp circuits (Edison) available, four on either end of three 40' long, 1½ inch Schedule 40 pipes that span the studio. Additionally, there are (2) 20 Amp circuits on a separate leg for House lights. This provides enough service for a potential of 104 channels of 600w dimming.

Dimming:

Spotlight Theater uses portable dimmer packs throughout the facility. This provides maximum flexibility. At present, the house has enough packs to provide 58 channels of 600w dimming as well as 8 channels of DMX power control.

- (10) [Elation DP-DMX-20L](#) 4 Channel (1200w/channel. 2400w total, 1,2 or 4 channel operation)
- (2) Elation PP-DMX-20L 4 Channel Power Control (non-dimming 1200w/channel. 2400w total, 1,2 or 4 channel operation)
- (3) [Lightronics AS-40D](#) 4 Channel (600w/channel, 2400w total)
- (1) [Lightronics AS-62D](#) 6 Channel (1200w/channel, 4800w total)

Control:

- (1) ETC NOMAD 2 Universe License
- (1) Asus touchscreen laptop with EOS 2 Universe Dongle
- (1) ETC 2 X 20 Universal Fader Wing
- (1) Acer UT-241Y Touch Screen Monitor

Fixtures:

- (6) Source Four Jr. Zoom 25-50
- (1) Source Four Jr. 36 degree
- (3) Selecon Pacific 23-50 degree Zoomspot
- (1) Selecon Pacific 90 degree
- (4) Altman 2205 Zoom Ellipsoidal
- (12) Altman 65Q/165Q Fresnel (8) Par 56 w/ 300w Lamps (7 used for House)
- (5) Par 64 w/ 500w Narrow Beam Lamps
- (2) Altman 2112 6X12
- (4) Altman 2113 8x13
- (2) Stage Right RGBA Moving Lights
- (1) Elation ZCL 360i RGBA Moving Light

Use of Equipment

With the exception of the standard in-studio sound system and overhead fluorescent lighting, the use of the lighting and sound equipment contained within Spotlight Theater is limited to Spotlight Media Productions staff or technical personnel approved by Spotlight's Technical Director who have been through a technical orientation session. No exceptions will be made.

There is a house lighting plot that covers the general performance area directly in front of the mirrors. The plot has three main areas; left, center and right with the most control in the center. All areas can be lit cool, warm or mixed. The house plot also includes four pattern washes that cover most of the playing area in both cool and warm colors.

Any alterations to the house plot, color, Smartfade patching or Yamaha Mixer patching must be restored at the end of the rental. Otherwise, a \$200 restoration charge will be added to your rental fee.

SPOTLIGHT VERMONT USAGE GUIDELINES

Please help us to keep the theatre in good condition for all uses by following these simple requirements for usage:

- NO PAINTING IS ALLOWED INSIDE THE THEATRE
- NO DUMPING OF PAINT OR PAINT THINNERS, OR CLEANING OF PAINTING TOOLS IS ALLOWED INSIDE ANY THEATRE SINK OR TOILET
- ANY SPILL OF ANY SUBSTANCE ON CARPETS OR FLOORS NEEDS TO BE MOPPED UP OR VACUUMED IMMEDIATELY
- ALL DECORATIONS, SET PIECES, ETC. USED IN THE THEATER SHOULD BE FREE-STANDING.
- DECORATIONS IN THE LOBBY WILL BE MINIMAL, AND NOT OCCUR DURING BUSINESS HOURS.
- MUST GET PRIOR AUTHORIZATION FOR ANY NAILING, SCREWING, STAPLING OR TAPING OR OTHERWISE ATTACHING ANYTHING TO THE WALLS.
- NAILING, SCREWING, STAPLING ANYTHING INTO THE STAGE STEP FLOORING IS STRICTLY PROHIBITED.
- ITEMS WEIGHING NO GREATER THAN 100 LBS TOTAL MAY BE SUSPENDED FROM THE CURTAIN HANGER IRONS IF THE STAGE BLACKS ARE NOT BEING USED. ITEMS WEIGHING LESS THAN 2 POUNDS EACH MAY BE HUNG FROM THE VALANCE TRACK
- ANY ADDITIONAL LIGHTING INSTRUMENTS HUNG ON THEATER ELECTRIC PIPES MUST EMPLOY APPROPRIATE SAFETY CABLES. NO SCENERY, PROPS OR OTHER ITEMS MAY BE HUNG FROM THE ELECTRICS BECAUSE OF FIRE HAZARD CONSIDERATIONS

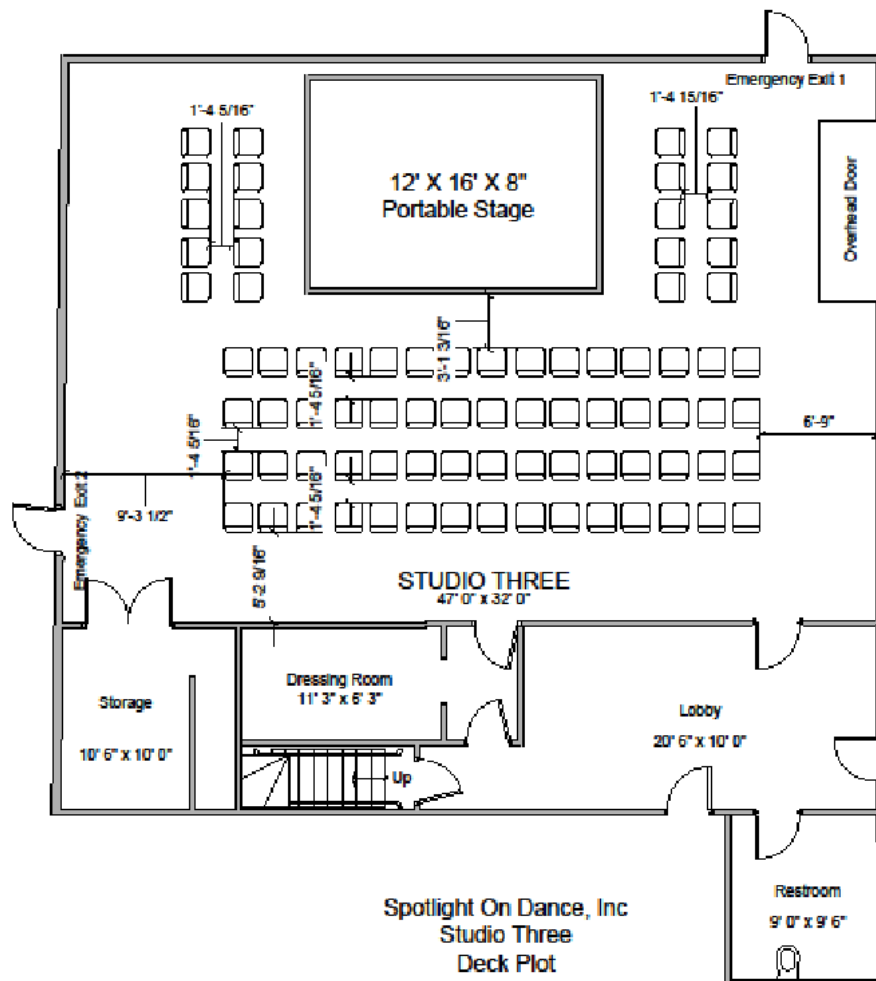

Spotlight On Dance, Inc
 Studio Three
 Deck Plot
Standard Stage Seating
 80 Chairs
 Scale - 1/8" = 1'