

How to Thread the Sewing Machine

created by Kim Naples 5/14/2015

1. Pick out your thread and a bobbin with the same color thread. This is a bobbin.

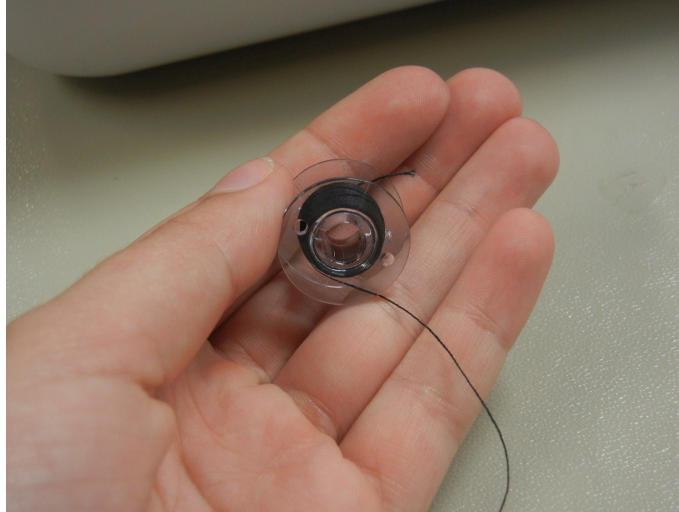

You can find them in a white bag in one of the white boxes.

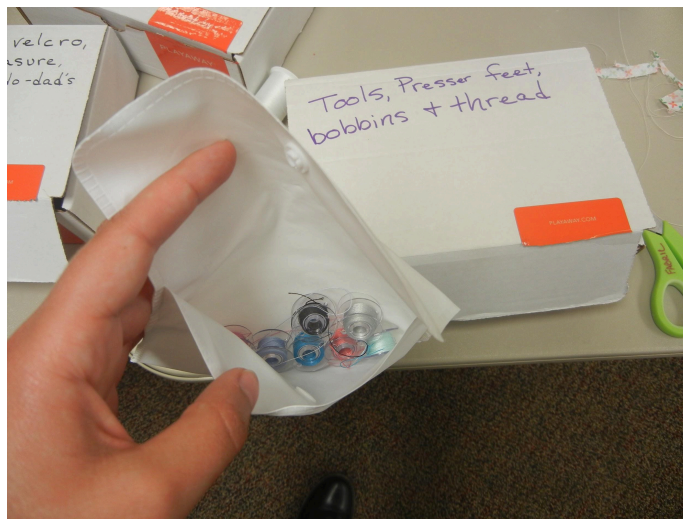

(If you can't find a bobbin in the color you need, go to the "How to Make a Bobbin" tutorial.)

2. OK, now head over the sewing machine and pull up the metal rod at the top.



3. Place the main spool of thread on this rod, not the bobbin.
4. Pull some thread out to the left and hook on the metal do-hickey like so: (There are also drawings on the machine to follow)

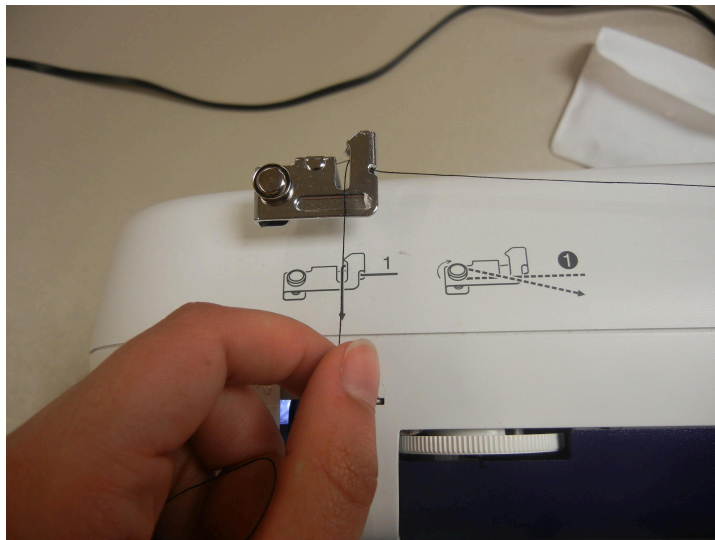

5. Now pull the thread towards you and down into the right of two slots in the front of the machine:



6. Then loop the thread back up into the slot on the left. The machine has numbers with arrows to guide you as well.



7. And then pull the string towards you and down again. Make sure it loops on the metal device inside the slot on the left.



8. Now, the thread needs to go through the head of the needle on the machine. You can do this by hand as shown:

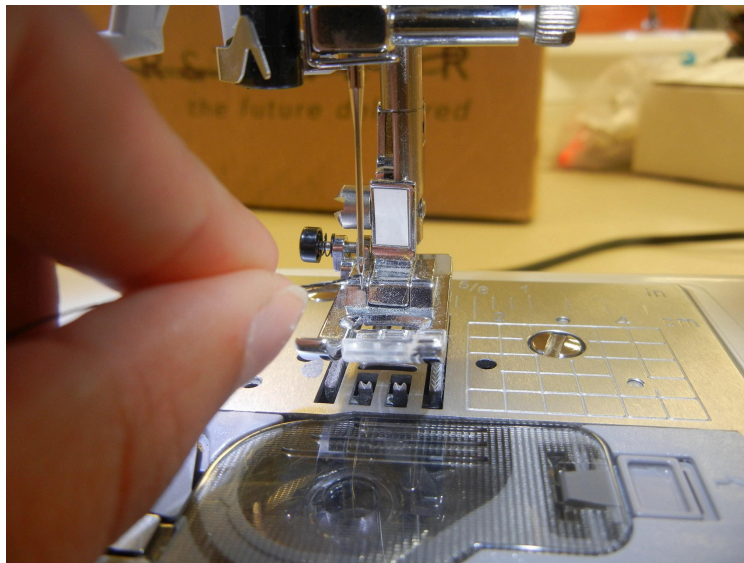

OR use the threader. The threader is tricky at first, but once you get it down, it makes your sewing life much easier.

9. To use the threader, lower it down a little using the lever to the upper left of the needle:

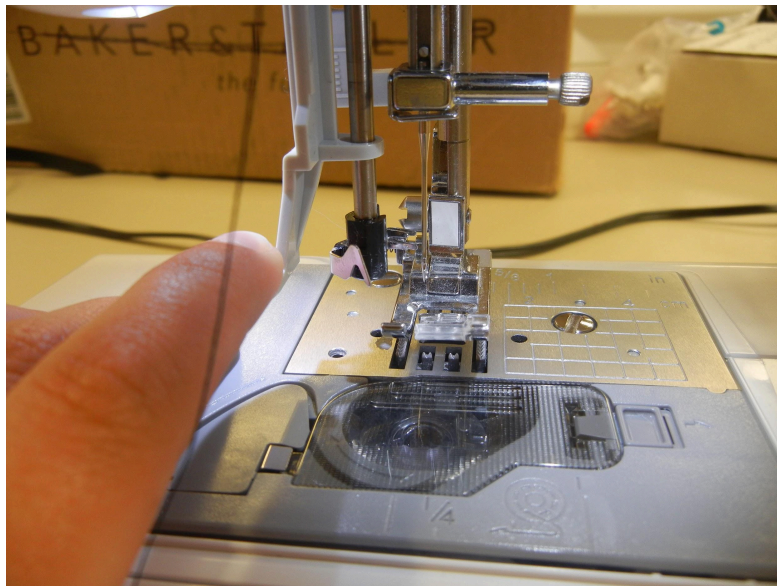

10. Loop the thread around the bit of metal that looks like an elbow, now push the lever down so the elbow hook is level with the head of the needle. Place the thread in front of the head of the needle- it will make a right angle now looped on the elbow.
11. Now push the lever all the way down, so the four- pronged teeth things surround the needle. The thread should be in between the top and bottom sets of teeth. Continue to push down until you feel a small click- this is a small hook coming out between the metal forks. This hook is very hard to see. Lift the thread slightly to allow the hook to grab the thread.
This step should look like this:



12. Slowly, slowly slooowly stop pushing down on the lever, gently guide it back up (don't immediately let it go and snap back). The prongs will rotate back and hopefully the little hook will pull the thread through the head of the needle.
13. Now it should look like this:

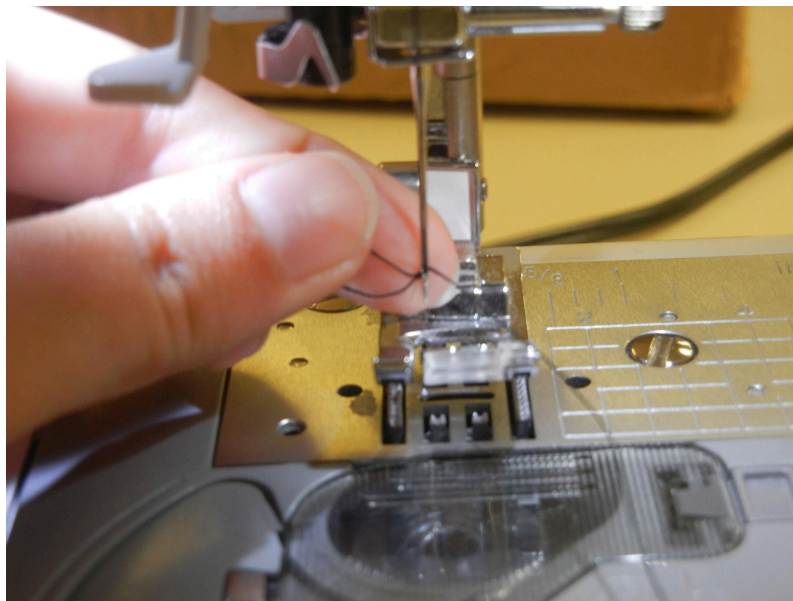

pull the loop so the end of the thread comes through.

14. Now slip the thread in the slot between the metal and plastic part of the foot, like so:



Now you have threaded the top part of the machine!

15. It is time now to thread the bottom of the machine. On this machine, you have thread that comes from the top and bottom that gets woven together to create stitches. First, put the bobbin in place. To do this, open up its little home.

- a. Push the little square to the right (shown below) to release the grayish-clear cover/guard.

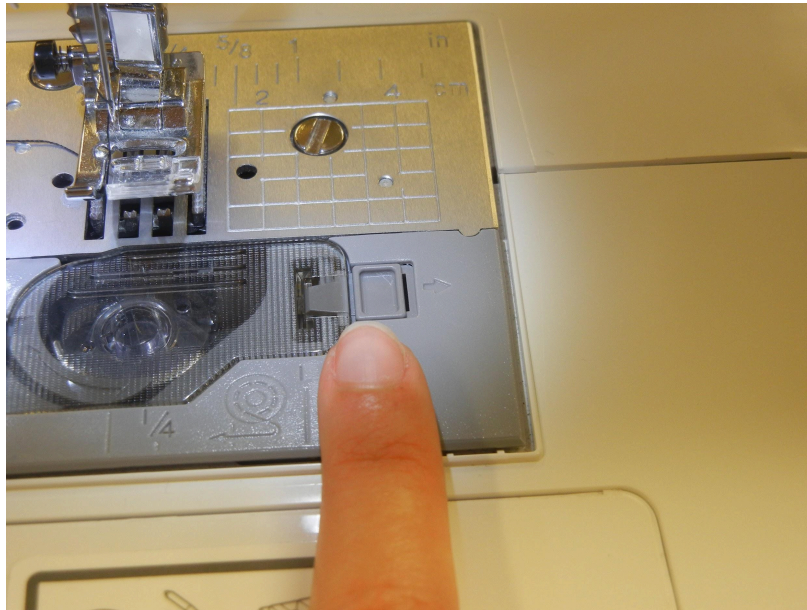

Slide the guard to the right until it pops up a little. Now you should be able to slide it to the right.

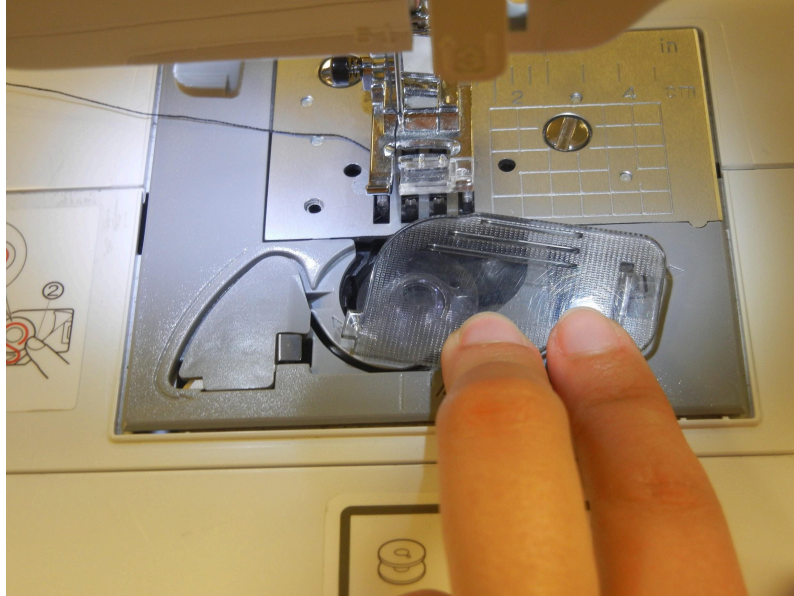

16. Place the bobbin in the little well that you can now see with the thread going to the left as shown in the illustration on the machine.





Follow the arrows to the left to curve the thread up and around. Then pull it to the right until it breaks on the small built-in blade.

17. Replace the cover by sliding it to the left and pushing down.
18. Now you need to bring the bottom (bobbin) thread to the top. To do this, first lower the needle by pressing the far-right button (with a needle on it) on the front of the machine. Hold onto the top thread as you do this.



19. While still holding the top thread, push this button again to raise the needle back up. Now, **gently** pull on the top thread until the bobbin thread on the bottom comes up with it. A tiny bit of thread might come up that you can't grab with your fingers. If needed, use a pair of tweezers like this:

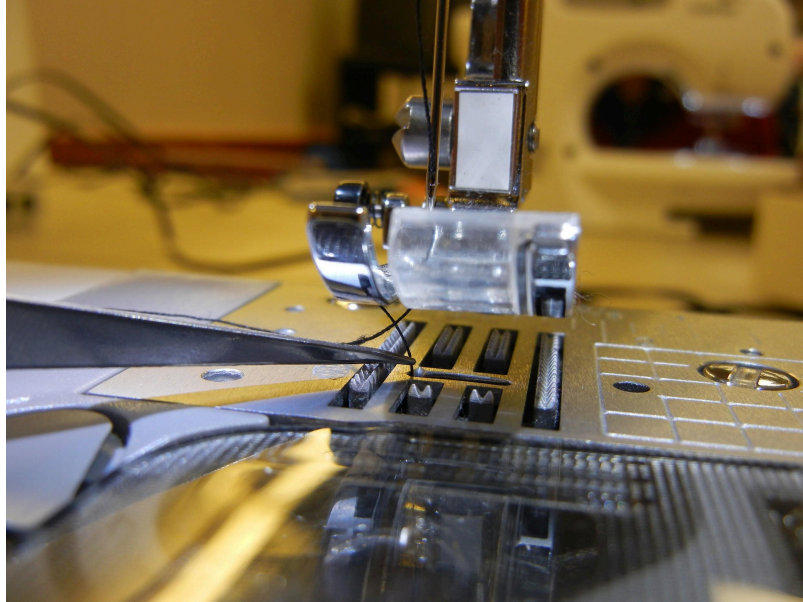

(you can find tweezers magnetized to the front of the 3D printer or in the “Tool” box.)

20. Pull a few inches of bobbin thread from the bottom, until it is the same length of top thread. Place both threads to the side like this:



Now you are ready to begin sewing!

Tip: Make sure your excess thread doesn't get tangled underneath your fabric. If there is a tangle, the machine will make an awful noise, stop working, and E6 will be shown on it's screen. [E6 means there is a tangle, E1 means the foot is not down- these are the most common errors. Others are printed in the last page of

the machine's manual.] To fix the tangle, stop sewing, lift the foot and needle, and remove the fabric from the machine. Remove all of the tangled thread. If the tangle is really bad, you might need tweezers. If it is really, really bad, remove the bobbin and find the small white screwdriver found in the white box with the machine's tools. Use this screwdriver to take off the metal casing under the needle. This will allow you to get at the incriminating thread easier.