

# MSW 550 Pre-Library Session Assignment

How to use this document:

1. Make a copy of this document: **File** → **Make a Copy** →

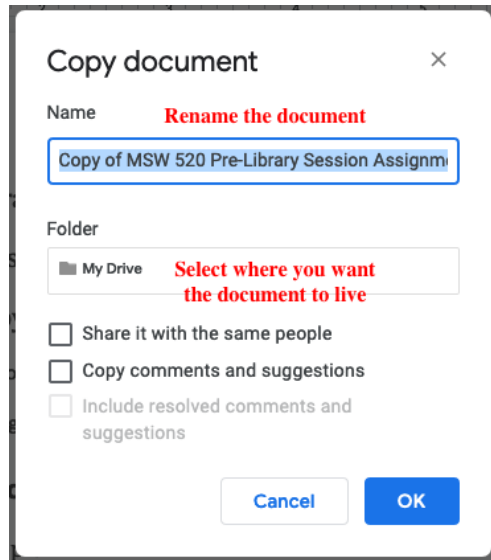

2. Review all tabs on the [MSW 550 library course guide](#).
3. Once completed, export your doc for cougar courses by clicking **File**→**Download**→**PDF**.  
**This assignment is due before the live library session.**

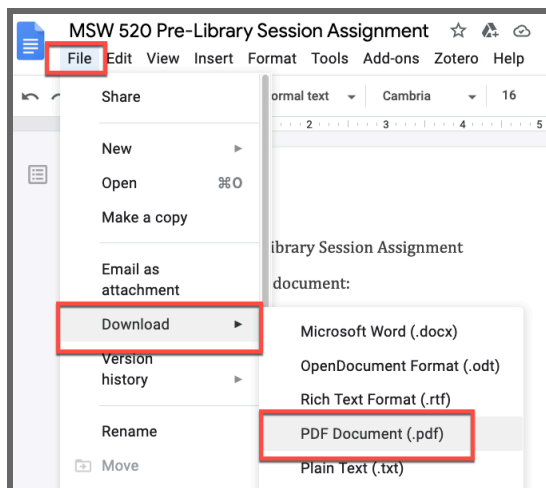

## Research Process Table

Complete the steps below by filling out the right side of the table. *Note: Before you fill out this table, carefully review the content on the [MSW 550 library course guide](#).*

<b>Name</b>	
<p>1. Write your draft Evidence-Based Practice Question.</p> <p>Highlight the 2-3 most important keywords in your question.</p>	
<p>2. Brainstorm <b>several synonyms</b> and/or related terms for each main keyword identified in #1.</p>	<p>Keyword 1:</p> <p>Keyword 2:</p> <p>Keyword 3:</p>
<p>3. Turn your brainstorm into a <b>search strategy</b> that can be used to search within a database.</p> <p><a href="#">Examples on guide</a></p>	
<p>4. Choose a <b>database</b> from the <a href="#">course guide</a> to try out your search. Review the <b>subject headings</b> attached to the resulting articles and note down any useful or alternative words you discovered.</p>	<p>Database:</p> <p>Subject headings found:</p>

<p>5. Write the <b>APA citation</b> for one useful research article you found related to your EBP question.</p>	
<p>6. After going through this process, what are <b>2 questions</b> you still have or 2 things you are confused about?</p>	<p>1:</p> <p>2:</p>