

# 2025 Participating Schools & Advisors

## Students – Chapters

### Region 9 – Level 1

147 students/ 10 advisors

Boyertown MS East – Todd Kennedy & John Brass

Boyertown MS West – Kevin Reigner & Ed Stallman

Daniel Boone MS – Karen Worrell

Easton Area MS- Brian Gaumer

JT Lambert Intermediate School – Philip & Maria Lazowski

Stroudsburg JHS – Matt Rimbey

Oley Valley MS – Jenn Hoffman

### Region 9 – Level 2

337 students/ 15 advisors

Bangor Area HS – Ken Brewer

Boyertown Area HS – Josh Pennington

Boyertown Freshmen Academy – Josh Pennington

Daniel Boone Area HS – Kevin Wayland

East Stroudsburg Area HS North – Michael Korb

Easton Area HS – Brian Gaumer/Marcus Chillot

Exeter Township SHS – Terry Lorah & Zach Potter

Moravian Academy HS – Jarred Weaver

Oley Valley HS - Chris Buckner & Angela Marino

Schuylkill Valley HS - Stacy Hallman

Stroudsburg Area HS – Kirk George

Upper Perkiomen HS – Blake Bardman

**Results Online  
Within 72 Hours**



## "Tune into Technology"

### Region 9 Conference

Stroudsburg Junior High School

Stroudsburg, PA

Early Submission: January 14, 2025

In Person: January 25, 2025



**Region 9 Conference Program  
Conference Schedule**

**7:30 – 8:00 AM REGISTRATION (Auditorium Lobby)**

---

**8:00-8:30 AM Judges Orientation (Cafeteria)**

---

**8:15 –8:40 AM OPENING CEREMONY  
Auditorium  
Opening Remarks and Announcements**

---

**8:45 –9:30 AM EVENTS REGISTRATION/DROP OFF  
Middle School & High School**

*\* All events must be registered by 9:30 to be eligible for competition.*

*\* All sign ups for time slots must occur during this time.*

---

**9:30 AM – 2:00 PM MS and HS Events**

*\* Events will not begin until 9:30*

---

**Time: TBD Special Interest Session (Auditorium)  
Fundraising in TSA  
Anyone not in an event may attend**

---

**11:00 AM – 1:00 PM LUNCH**

---

**12:00 – 2:00 PM Problem Solving Events**

---

**2:00 – 2:30 PM OPEN VIEWING OF EVENTS  
Do not enter rooms if judging is still going on**

---

**2:45 – 4:30 PM AWARDS CEREMONY & MIRACLE MINUTE  
Auditorium**

---

**4:30 – 4:45 PM EVENT PICK-UP**

*Dates to Remember*

---

*PA-TSA State Conference April 23-26, 2025  
Seven Springs Resort, Champion, PA*

---

*National TSA Conference June 27-July 1, 2025  
Nashville, TN*

---

*TSA Mission Statement*

*The Technology Student Association fosters personal growth, leadership, and opportunities in Science, Technology, Engineering, and Mathematics (STEM); members apply and integrate these concepts through co-curricular activities, competitions, and related programs.*

*We would like to thank all of the advisors, judges, and parents who helped make the 2025 Region 9 Conference a success. It is with your help and support that our students have the opportunity to compete today and better themselves for the State Conference in April, and then the National Conference in June. These students are truly "Learning to lead in a technical world."*

*Congratulations to all of the students today for your hard work and dedication, best wishes to you today as you compete respectfully with your peers.*

*Thank you,*

*The Region 9 Planning Team*

*Kirk George, Stacy Hallman, Breanna McNamara,  
Josh Pennington, Mike Quendro, Matt Rimbey*

**Notify judges of all event conflicts!**

### HIGH SCHOOL EVENTS

| Events                        | Type                 | Room #/ Time  |
|-------------------------------|----------------------|---|
| Architectural Design          | Drop/Interview       | Drop off & Sign up @ room AM/PM B134                              |
| Audio Podcasting              | Early Sub            | Submitted January 14th  |
| Biotechnology Design          | Drop Off             | B-132- Setup during drop-off time                                 |
| Board Game Design             | Drop/Interview       | Sign up @ room AM – Interviews E121                               |
| Chapter Team                  | Onsite               | E-110 AM  |
| Children's Stories            | Drop off             | A-125 (Back)  |
| Coding                        | Onsite               | E118 – PM 9:45-10:45  |
| CAD Architecture              | Set up/ Onsite       | Library–Setup drop off time/ Comp AM                              |
| CAD Engineering               | Set up/ Onsite       | Library–Setup drop off time/ Comp AM                              |
| Debating Technological Issues | Onsite               | Sign up @ room AM (against another school) Prep D107 & Heats D104 |
| Digital Video Production      | Early Sub            | Submitted January 14th  |
| Dragster Design               | Drop Off             | Drop Off Gym AM /Testing PM                                       |
| Engineering Design            | Drop/Interview       | Sign up @ room AM / A123  |
| Extemporaneous Presentation   | Onsite               | Sign up @ room AM/ Prep D107 & Heats D106 / AM & PM               |
| Fashion Design                | Drop Off             | A129  |
| Flight Endurance              | Drop off/Testing     | Drop off Gym AM/ Testing  |
| Forensics Science             | Onsite               | Check-in @ room AM/ E113 – AM                                     |
| Future Technology Teacher     | Onsite               | Sign up @ room AM/ Present Lesson Plan – D104 AM                  |
| Geospatial Technology         | Drop off             | A123  |
| Manufacturing Prototype       | Drop off             | B-133   |
| Music Production              | Early Sub            | Submitted January 14th  |
| Photographic Technology       | Drop Off             | A124 (Front)  |
| Prepared Presentation         | Onsite               | Sign up @ room AM/D105 AM & PM                                    |
| Promotional Design            | Drop Off             | E-116   |
| Robotics                      | Onsite               | Sign Up in AM - testing in PM - Main office lobby                 |
| Senior Solar Sprint           | Drop off/Testing     | Sign up @ GYM-Drop Off / Testing PM                               |
| Software Development          | Onsite               | Sign up @ room AM/Interviews - E120 AM                            |
| Structural D & Engineering    | Drop off             | Drop Off Auditorium Stage AM Testing PM                           |
| Technology Bowl               | Onsite               | <b>D103</b>   |
| Tech Problem Solving          | Onsite               | D101 – PM   |
| Transportation Modeling       | Drop Off             | Drop off Gym AM   |
| Video Game Design             | Early Sub/ Interview | Sign up @ room AM/ Interviews –E119                               |
| Webmaster                     | Early Sub/ Interview | Sign up @ room AM/Interviews –A126 AM & PM                        |
| PA - Materials Process        | Drop Off             | A128  |
| PA - Robotics                 | Onsite               | Main Office Lobby - Sign up/Testing – AM                          |
| PA - Safety Illustration      | Drop Off             | A130  |
| PA RC-Off Road                | Onsite               | Aux Gym   |

### MIDDLE SCHOOL EVENTS

| Events                        | Type                 | Room #/ Time   |
|-------------------------------|----------------------|--|
| Biotechnology                 | Drop Off             | B-132- Setup during drop-off time                                |
| CAD Foundations               | Set up/ Onsite       | Library – Setup during drop off time/ Library - Competition - AM |
| Career Prep                   | Early Sub            | Submitted January 14th   |
| Challenging Technology Issues | Onsite               | Sign up @ room AM/ Prep D107 & Heats D108 / AM                   |
| Chapter Team                  | Onsite               | E-110 AM   |
| Children's Stories            | Drop Off             | A125 Front   |
| Coding                        | Onsite               | E118 – AM 12:30 pm-1:30 pm                                       |
| Digital Photography           | Drop Off             | A-124 (Front)  |
| Dragster                      | Drop Off             | Drop Off Gym AM /Testing PM                                      |
| Essays On Technology          | Early Sub            | Submitted January 14th   |
| Flight                        | Drop off/Testing     | Drop off Gym AM/ Testing   |
| Forensics Technology          | Onsite               | Check In @ room AM/ E112   |
| Inventions and Innovations    | Drop/Interview       | Drop off/Sign up @ room AM/ E-114                                |
| Junior Solar Sprint           | Drop off/Testing     | Sign up @ GYM-Drop Off / Testing AM                              |
| Leadership Strategies         | Onsite               | Sign up @ room AM/ Prep D107 & Heats D106 PM                     |
| Mass Production               | Drop/Interview       | Sign up @ room AM/ B-133   |
| Mechanical Engineering        | Drop Off/Testing     | Signup/ Drop Off Testing AM Gym Lobby                            |
| Medical Technology            | Drop Off             | E-114  |
| Off The Grid                  | Drop off             | D-109  |
| Prepared Speech               | Onsite               | Sign up @ room AM/ D105  |
| Problem-Solving               | Onsite               | D100 – PM  |
| Promotional Marketing         | Drop Off             | E116   |
| STEM Animation                | Early Sub            | Submitted January 14th   |
| Structural Engineering        | Drop Off             | Drop Off Auditorium Stage AM Testing PM / MS Tested First        |
| Tech Bowl                     | Onsite               | D-103  |
| Video Game Design             | Early Sub/ Interview | Sign up @ room AM/ Interviews –E119                              |
| Website Design                | Early Sub/ Interview | Sign up @ room AM/ Interviews –A126                              |
| PA - Delta Dart               | Drop off/Testing     | Drop off Gym / Testing   |
| PA - Materials Process        | Drop Off             | A128   |
| PA – Robotics                 | Onsite               | Main Office Lobby - Sign up/Testing – AM                         |
| PA -Safety Illustration       | Drop Off             | A130   |
| PA – Snapshot                 | Drop Off             | A-124 Back   |
| PA RC-Off Road                | Onsite               | Aux Gym  |

EMERGENCY EVACUATION PLAN

ROOM # D102

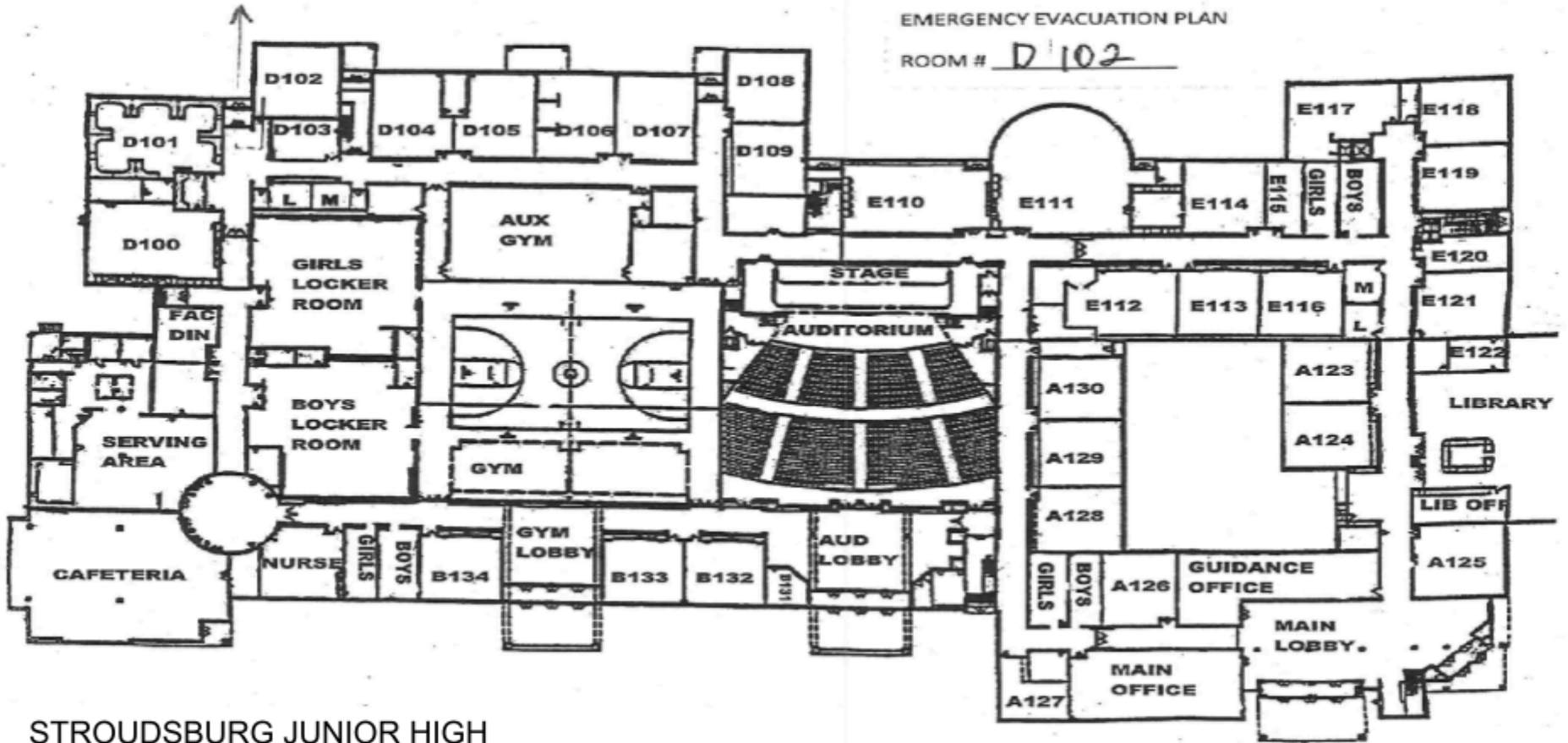

STROUDSBURG JUNIOR HIGH  
FIRST FLOOR PLAN