

**Property Ownership Research Methods
for Los Angeles County
by Joel Montano (jxmontano@gmail.com)**

Research Methods used in my capstone project:

Piercing the Corporate Veil of LLC Landlordism: A Predatory Landlord's Eviction Machine of Black and Brown Bodies in Los Angeles' Working-Class Neighborhoods, 1996-2019

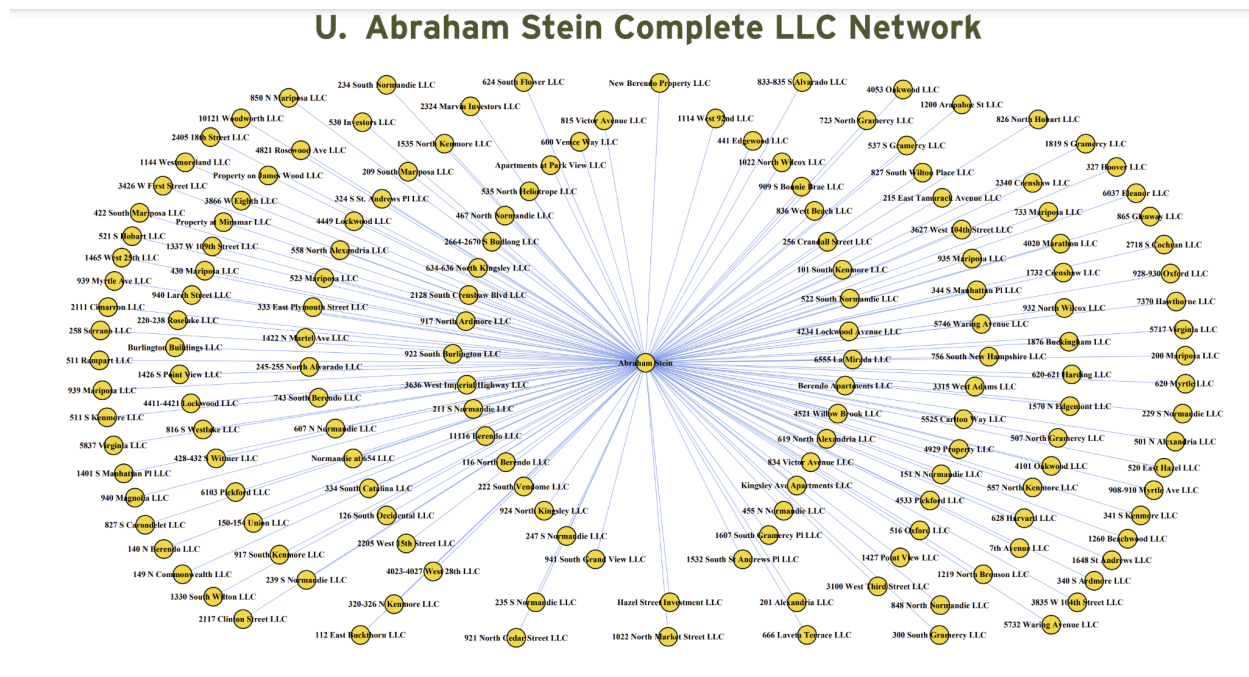

Figure T Network of all LLC Properties Owned by Abraham Stein (1996-2019)

Montano, J. (2020). Piercing the Corporate Veil of LLC Landlordism: A Predatory Landlord's Eviction Machine of Black and Brown Bodies in Los Angeles' Working-Class Neighborhoods, 1996-2019 [Master's Thesis]. UCLA Department of Urban Planning.

What is the address of the property?

For example: 1819 S Gramercy Pl Los Angeles, CA 90019

1) Find the assessor parcel number (APN) or assessor identification number (AIN) -- a unique number identifier for each piece of land in the County.

- Los Angeles City
 - If in the city of Los Angeles, you can use:
 - <http://zimas.lacity.org/> (Los Angeles Zoning Information & Map Access System)

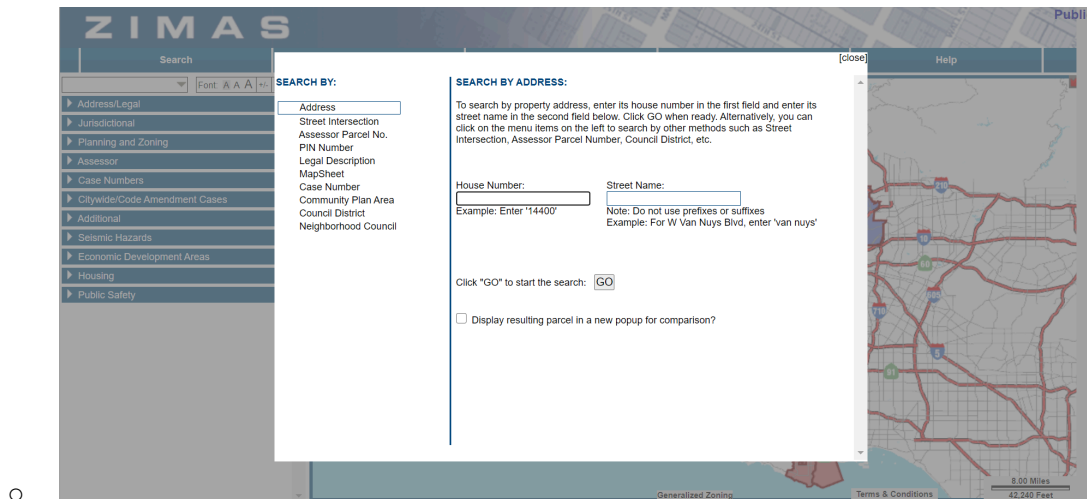

○

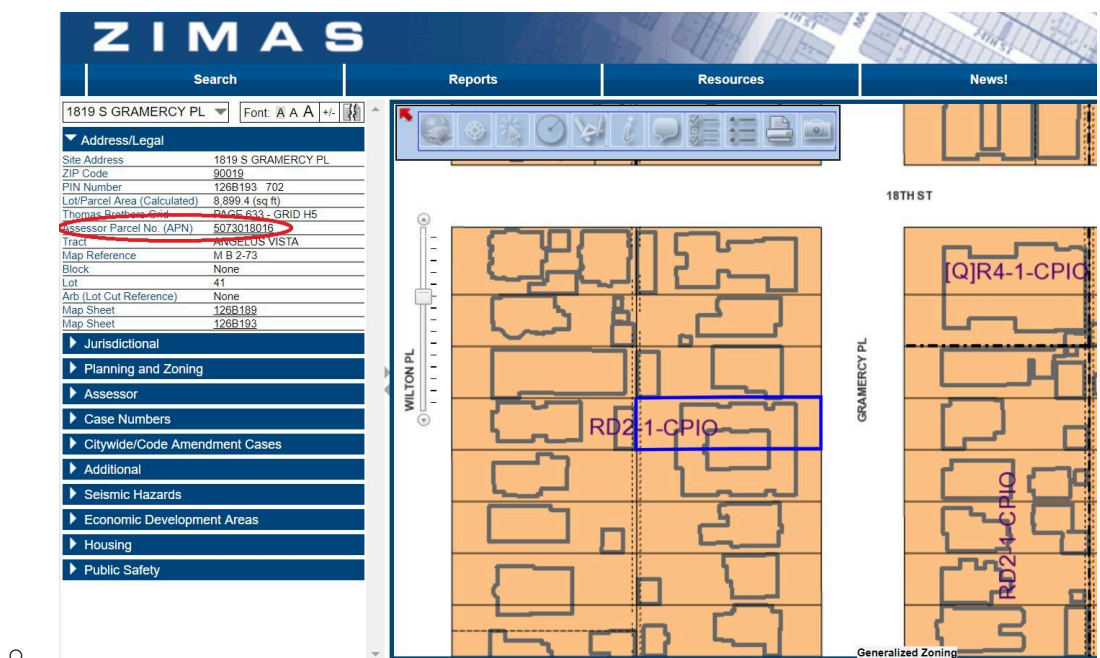

○

ZIMAS Public

Search Reports Resources News! Help

Map Sheet: 1006182

Jurisdictional

Planning and Zoning

Assessor

Assessor Parcel No. (APN) 5073018016

Ownership (Assessor)

Owner1

Address

Ownership (Bureau of Engineering - Land Records)

Owner

Address

APN Area (Co. Public Works) 0.409 (ac)

Use Code 0500 - Residential - Five or More Units or Apartments (Any Combination) - 4 Stories or Less

Assessed Land Val. \$2,417,665

Assessed Improvement Val. \$494,424

Net Owner Change 02/24/2015

Net Sale Amount \$3,100,031

Tax Rate 7.305

Deed Ref No. (City Clerk) 2611839-40

Deed Ref No. (City Clerk) 200028

Deed Ref No. (City Clerk) 1166923

Deed Ref No. (City Clerk) 0-522

Year Built 1972

Number of Units 18

Number of Bathrooms 18

Building Square Footage 15,851.0 (sq ft)

Building 2 No data for building 2

Building 3 No data for building 3

Generalized Zoning

Terms & Conditions

0.02 Miles

100 Feet

- Los Angeles County
 - If outside of the city of Los Angeles, but inside the County use:
 - <https://portal.assessor.lacounty.gov/> (Los Angeles County Assessor Portal)

Los Angeles County Assessor Portal Map Search PAIS Assessor Internet

LOS ANGELES COUNTY OFFICE OF THE ASSESSOR
JEFFREY PRANG

Basic Search Legal Search Map Search

Search by AIN or Address

© 2017- Los Angeles County Assessor Contact Us | Disclaimer | FAQ

f t in yt

Summary

AIN: 5073-018-016

Situs Address:
1819 S GRAMERCY PL
LOS ANGELES CA 90019-6362

Use Type:
Multi-Family Residence
Parcel Type:
Regular Fee Parcel
Tax Rate Area:
00067

Parcel Status: **ACTIVE**
Create Date:
Delete Date:
Tax Status: **CURRENT**
Year Defaulted:
Exemption: None

Building (0101) & Land Overview

Use Code: 0500 # of Units: 18 Year Built: 1972
Design Type: 0500 Beds/Baths: 33/18 Effective Year: 1972
Quality Class: D6 Building SqFt: 15,851 Land SqFt: 17,799



Parcel Map / Map Index

		2021 Roll Preparation	2020 Current Roll	RC	Year	2015 Base Value
Land	\$	2,466,018	\$ 2,417,665	T	2015	\$ 2,200,000
Improvements	\$	1,008,823	\$ 989,043	T	2015	\$ 900,000
Total	\$	3,474,841	\$ 3,406,708			\$ 3,100,000

Assessor's Responsible Division



1819 S Gramercy Pl, Los Angeles, CA 90019-6362

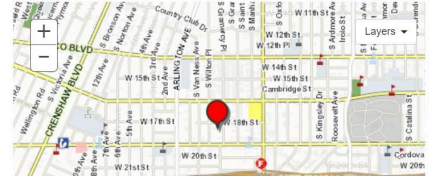

Events History

Ownership Parcel Change

Show Re-Assessable Only: ☐

	Recording Date	Seq. #	Re-Assessed	Doc #	OC1	OC2	Doc Type	Doc Reason	# Parcels	%	Ver. Code	DTT Sale Price	Assessed Value
+	02/24/2015	50	Yes	0200628	3	5	Y	A	1	00%-0	K	\$ 3,100,031	\$ 3,100,000
+	05/18/2005	50	Yes	1168923	3	5	Y	A	1	00%-0	K	\$ 1,850,018	\$ 1,850,000
+	10/12/2004	50	Yes	2611840	3	5	Y	A	1	00%-0	K	\$ 1,000,000	\$ 1,000,000
+	06/03/1970	50	Yes	0003069			A			00%-0		\$ 0	\$ 0

Assessment History

Show All: ☐ Hide Inactive Rolls: ☐

Showing 1 to 10 of 49 entries.

Roll Detail														Real Property Value					
Bill Number	Bill Type	Bill Status	Date Created	Date to Auditor	Recording Date	Seq #	Doc #	Doc Type	Doc Reason	OC1	OC2	%	Total Value	Land Value	Reason Code	Base Year	Improvement Value	Reason Code	Base Year
221-PSEG					02/24/2015	50	0200628	Y	A	3	5	00%-0	\$ 3,474,841	\$ 2,466,018	T	2015	\$ 1,008,823	T	2015
2200000	R	A	07/06/2020	07/06/2020	02/24/2015	50	0200628	Y	A	3	5	00%-0	\$ 3,406,708	\$ 2,417,665	T	2015	\$ 989,043	T	2015
2190000	R	A	07/01/2019	07/01/2019	02/24/2015	50	0200628	Y	A	3	5	00%-0	\$ 3,339,910	\$ 2,370,260	T	2015	\$ 969,650	T	2015
2180000	R	A	07/19/2018	07/19/2018	02/24/2015	50	0200628	Y	A	3	5	00%-0	\$ 3,274,423	\$ 2,323,785	T	2015	\$ 950,638	T	2015
2170000	R	A	06/26/2017	06/26/2017	02/24/2015	50	0200628	Y	A	3	5	00%-0	\$ 3,210,220	\$ 2,278,221	T	2015	\$ 931,999	T	2015

2) Confirm ownership of the property by viewing the deed

- Preview of property deeds are available going back until 2010:
- Los Angeles County
 - datastore.netronline.com/losangeles (Net R Online)

NETRONLINE Property Data Store Public Records Online Environmental Data Historic Aerials [Login](#)

[Sign Up](#)
[Search](#)
[Pricing](#)
[Support](#)

Search
Property Owners, Deeds & More

Address: [Start Search](#)
Powered By Neighbor Who

Search the Los Angeles County Registrar-Recorder Index
Database current to 2024-07-25
[About the Los Angeles County Recorded Document Search](#)

Date Range From: To:

Company

Name

Signator ☒ grantor ☐ grantee

or

AIN Document #

[Search](#)

Links available for LA County Records

Select: [California](#) [Los Angeles](#)

LOS ANGELES COUNTY PUBLIC RECORDS

The Golden State

[Official State Website](#) [UCC Info](#) [Corporation, LP, LLC Search](#)

Name	Phone	Online	Report
Los Angeles Treasurer / Tax Collector	(213) 974-2111	Go to Data Online	Fix
Los Angeles Recorder	(800) 201-8999	Website Only	Fix
Los Angeles Assessor	(213) 974-3211	Go to Data Online	Fix
City of Los Angeles Mapping/GIS		Go to Data Online	Fix
Los Angeles NETR Recorder Clerk Online Index		Go to Data Online	Fix
Los Angeles Mapping / GIS		Go to Data Online	Fix
Historic Aerials		Go to Aerials	Fix
Los Angeles NETR Mapping and GIS		Map	

- To search by APN or AIN number:
 - Enter number in AIN text entry
- To search by Document #:
 - Enter year of Recording Date, plus the Doc # from the County Assessor's Events History section
- To search by Company:
 - Enter LLC, LP, or Inc name and select Grantee
- To search by individual name:
 - Enter first and last name and select Grantee

Search

Pricing

Support

About the Los Angeles County Recorded Document Search

Date Range From: 01/01/1977 To: 09/28/2020

Company

Name FIRST LAST

Signator ☒ grantor ☐ grantee

or

AIN 5073018016 Document #

Search

1 document found

Doc #	Date	Type	Grantors	Grantees
20150200628	2015-02-24	DEED	SIM KAP SEUNG SIM KONG KUN	1819 S GRAMERCY LLC

Add to cart

3) Search for the 'Manager' agent filed with the CA Secretary of State office

- California

- <https://bizfileonline.sos.ca.gov/search/business> (CA Business Search)

- Business Search Homepage

Business Search

The California Business Search provides access to available information for **corporations**, **limited liability companies** and **limited partnerships** of record with the California Secretary of State, with **free PDF copies** of over 17 million imaged business entity documents, including the most recent imaged Statements of Information filed for Corporations and Limited Liability Companies.

Currently, information for Limited Liability Partnerships (e.g. law firms, architecture firms, engineering firms, public accountancy firms, and land survey firms), General Partnerships, and other entity types are **not contained** in the California Business Search. If you wish to obtain information about LLPs and GPs, submit a Business Entities Order paper form to request copies of filings for these entity types. Note: This search is not intended to serve as a name reservation search. To reserve an entity name, select Forms on the left panel and select Entity Name Reservation ? Corporation, LLC, LP.

Basic Search

- A Basic search can be performed using an entity name or entity number. When conducting a search by an entity number, where applicable, **remove "C"** from the entity number. Note, **a basic search** will search **only ACTIVE entities** (Corporations, Limited Liability Companies, Limited Partnerships, Cooperatives, Name Reservations, Foreign Name Reservations, Unincorporated Common Interest Developments, and Out of State Associations). The basic search performs a contains ?keyword? search. The Advanced search allows for a ?starts with? filter. To search entities that have a status other than active or to refine search criteria, use the **Advanced** search feature.

Advanced Search

- An Advanced search is required when searching for publicly traded disclosure information or a status other than active.
- An Advanced search allows for searching by specific entity types (e.g., Nonprofit Mutual Benefit Corporation) or by entity groups (e.g., All Corporations) as well as searching by ?begins with? specific search criteria.

Disclaimer: Search results are limited to the 500 entities closest matching the entered search criteria. If your desired search result is not found within the 500 entities provided, please refine the search criteria using the Advanced search function for additional results/entities. The California Business Search is updated as documents are approved. The data provided is not a complete or certified record.

Although every attempt has been made to ensure that the information contained in the database is accurate, the Secretary of State's office is not responsible for any loss, consequence, or damage resulting directly or indirectly from reliance on the accuracy, reliability, or timeliness of the information that is provided. All such information is provided "as is." To order certified copies or certificates of status, (1) locate an entity using the search; (2) select Request Certificate in the right-hand detail drawer; and (3) complete your request online.

Advanced ▾

- Enter organizational entity name

Business Search

The California Business Search provides access to available information for **corporations**, **limited liability companies** and **limited partnerships** of record with the California Secretary of State, with **free PDF copies** of over 17 million imaged business entity documents, including the most recent imaged Statements of Information filed for Corporations and Limited Liability Companies.

Currently, information for Limited Liability Partnerships (e.g. law firms, architecture firms, engineering firms, public accountancy firms, and land survey firms), General Partnerships, and other entity types are **not contained** in the California Business Search. If you wish to obtain information about LLPs and GPs, submit a Business Entities Order paper form to request copies of filings for these entity types. Note: This search is not intended to serve as a name reservation search. To reserve an entity name, select Forms on the left panel and select Entity Name Reservation ? Corporation, LLC, LP.

Basic Search

- A Basic search can be performed using an entity name or entity number. When conducting a search by an entity number, where applicable, **remove "C"** from the entity number. Note, **a basic search** will search **only ACTIVE entities** (Corporations, Limited Liability Companies, Limited Partnerships, Cooperatives, Name Reservations, Foreign Name Reservations, Unincorporated Common Interest Developments, and Out of State Associations). The basic search performs a contains ?keyword? search. The Advanced search allows for a ?starts with? filter. To search entities that have a status other than active or to refine search criteria, use the **Advanced** search feature.

Advanced Search

- An Advanced search is required when searching for publicly traded disclosure information or a status other than active.
- An Advanced search allows for searching by specific entity types (e.g., Nonprofit Mutual Benefit Corporation) or by entity groups (e.g., All Corporations) as well as searching by ?begins with? specific search criteria.

Disclaimer: Search results are limited to the 500 entities closest matching the entered search criteria. If your desired search result is not found within the 500 entities provided, please refine the search criteria using the Advanced search function for additional results/entities. The California Business Search is updated as documents are approved. The data provided is not a complete or certified record.

Although every attempt has been made to ensure that the information contained in the database is accurate, the Secretary of State's office is not responsible for any loss, consequence, or damage resulting directly or indirectly from reliance on the accuracy, reliability, or timeliness of the information that is provided. All such information is provided "as is." To order certified copies or certificates of status, (1) locate an entity using the search; (2) select Request Certificate in the right-hand detail drawer; and (3) complete your request online.

Advanced ▾

- Search results will display underneath the search bar.
- Once you have identified the correct organizational entity, click on the blue box which will open a new pop-up window on the right-hand side of the screen.
- Click on View History to open a new pop-up window that provides a selection of records to download & view

Business Search

The California Business Search provides access to available information for **corporations, limited liability companies and limited partnerships** of record with the California Secretary of State, with **free PDF copies** of over 17 million imaged business entity documents, including the most recent imaged Statements of Information filed for Corporations and Limited Liability Companies.

Currently, information for **Limited Liability Partnerships** (e.g. law firms, architecture firms, engineering firms, public accountancy firms, and land survey firms), **General Partnerships**, and other entity types are **not contained** in the California Business Search. If you wish to obtain information about LLPs and GPs, submit a Business Entities Order paper form to request copies of filings for these entity types. **Note:** This search is not intended to serve as a name reservation search. To reserve an entity name, select Forms on the left panel and select Entity Name Reservation ? Corporation, LLC, LP.

Basic Search

- A Basic search can be performed using an entity name or entity number. When conducting a search by an entity number, where applicable, **remove "C"** from the entity number. **Note, a basic search will search only ACTIVE entities** (Corporations, Limited Liability Companies, Limited Partnerships, Cooperatives, Name Reservations, Foreign Name Reservations, Unincorporated Common Interest Developments, and Out of State Associations). The basic search performs a contains ?keyword? search. The Advanced search allows for a ?starts with? filter. To search entities that have a status other than active or to refine search criteria, use the **Advanced** search feature.

Advanced Search

- An Advanced search is required when searching for publicly traded disclosure information or a status other than active.
- An Advanced search allows for searching by specific entity types (e.g., Nonprofit Mutual Benefit Corporation) or by entity groups (e.g., All Corporations) as well as searching by ?begins with? specific search criteria.

Disclaimer: Search results are limited to the 500 entities closest matching the entered search criteria. If your desired search result is not found within the 500 entities provided, please refine the search criteria using the Advanced search function for additional results/entities. The California Business Search is updated as documents are approved. The data provided is not a complete or certified record.

Although every attempt has been made to ensure that the information contained in the database is accurate, the Secretary of State's office is not responsible for any loss, consequence, or damage resulting directly or indirectly from reliance on the accuracy, reliability, or timeliness of the information that is provided. All such information is provided "as is." To order certified copies or certificates of status, (1) locate an entity using the search; (2)select Request Certificate in the right-hand detail drawer; and (3) complete your request online.

1819 S Gramercy LLC

Advanced

Results: 1

Entity Information	Initial Filing Date	Status	Entity Type	Formed In	Agent
1819 S. GRAMERCY, LLC (201501010200)	1/06/2015	Active	Limited Liability Company - CA	CALIFORNIA	MARIA BARBA

1819 S. GRAMERCY, LLC (201501010200)

Request Certificate

Initial Filing Date

Status

Standing - SOS

Standing - FTB

Standing - Agent

Standing - VCPFC

Formed In

Entity Type

Principal Address

Mailing Address

Statement of Info Due Date

Agent

01/06/2015

Active

Good

Good

Good

Good

CALIFORNIA

Limited Liability Company - CA

6420 WILSHIRE BLVD., SUITE 1420
LOS ANGELES, CA 90048

6420 WILSHIRE BLVD., SUITE 1420
LOS ANGELES, CA 90048

01/31/2023

Individual
MARIA BARBA
6420 WILSHIRE BLVD., SUITE 1420
LOS ANGELES, CA 90048

View History

Request Access

- Most important files to download are: Initial Filing & most current Statement of Information

History			
Statement of Information - 10/6/2020			
Amendment Type Statement of Information Control ID LBA33683190 Date 10/6/2020 Image Download Download	Field Name Legacy Comment	Changed From Legacy number: 20E03894	Changed To
System Amendment - SI Delinquency for the year of 0 - 2/6/2019			
Amendment Type System Amendment - SI Delinquency for the year of 0 Control ID LBA33683188 Date 2/6/2019			
Statement of Information - 12/16/2017			
Amendment Type Statement of Information Control ID LBA33683189 Date 12/16/2017 Image Download Download	Field Name Legacy Comment	Changed From Legacy number: 17B77080	Changed To
Initial Filing - 1/6/2015			
Amendment Type Initial Filing Control ID 201501010200 Date 1/6/2015 Image Download Download			

• Initial Filing

LLC-1	Articles of Organization of a Limited Liability Company (LLC)	<div style="font-size: 24pt; font-weight: bold;">201501010200</div> <div style="text-align: center; margin-top: 20px;"> FILED Secretary of State State of California JAN 06 2015 </div> <div style="text-align: center; margin-top: 10px;"> <i>ICC</i> <small>This Space For Office Use Only</small> </div>
<p>To form a limited liability company in California, you can fill out this form, and submit for filing along with:</p> <ul style="list-style-type: none"> - A \$70 filing fee. - A separate, non-refundable \$15 service fee also must be included, if you drop off the completed form. <p>Important! LLCs in California may have to pay a minimum \$800 yearly tax to the California Franchise Tax Board. For more information, go to https://www.ftb.ca.gov.</p> <p>LLCs may not provide "professional services," as defined by California Corporations Code sections 13401(a) and 13401.3.</p> <p>Note: Before submitting the completed form, you should consult with a private attorney for advice about your specific business needs.</p>		
<p>For questions about this form, go to www.sos.ca.gov/business/be/filing-tips.htm.</p>		
<p>LLC Name (List the proposed LLC name exactly as it is to appear on the records of the California Secretary of State.)</p> <p>① <u>1819 S. GRAMERCY, LLC</u></p> <div style="display: flex; justify-content: space-between; font-size: 8pt;"> <div><i>Proposed LLC Name</i></div> <div>The name must include: LLC, L.L.C., Limited Liability Company, Limited Liability Co., Ltd. Liability Co. or Ltd. Liability Company; and may not include: bank, trust, trustee, incorporated, inc., corporation, or corp., insurer, or insurance company. For general entity name requirements and restrictions, go to www.sos.ca.gov/business/be/name-availability.htm.</div> </div>		
<p>Purpose</p> <p>② The purpose of the limited liability company is to engage in any lawful act or activity for which a limited liability company may be organized under the California Revised Uniform Limited Liability Company Act.</p>		
<p>LLC Addresses</p> <p>③ a. <u>3660 Wilshire Blvd., #218</u> <u>Los Angeles</u> <u>CA</u> <u>90010</u></p> <div style="display: flex; justify-content: space-between; font-size: 8pt;"> <div><i>Initial Street Address of Designated Office in CA - Do not list a P.O. Box</i></div> <div><i>City (no abbreviations)</i></div> <div><i>State</i></div> <div><i>Zip</i></div> </div> <p>b. _____</p> <div style="display: flex; justify-content: space-between; font-size: 8pt;"> <div><i>Initial Mailing Address of LLC, if different from 3a</i></div> <div><i>City (no abbreviations)</i></div> <div><i>State</i></div> <div><i>Zip</i></div> </div>		
<p>Service of Process (List a California resident or a California registered corporate agent that agrees to be your initial agent to accept service of process in case your LLC is sued. You may list any adult who lives in California. You may not list an LLC as the agent. Do not list an address if the agent is a California registered corporate agent as the address for service of process is already on file.)</p> <p>④ a. <u>Melvin H. Malat, Esq.</u></p> <div style="display: flex; justify-content: space-between; font-size: 8pt;"> <div><i>Agent's Name</i></div> </div> <p>b. <u>270 North Canon Dr. #300</u> <u>Beverly Hills</u> <u>CA</u> <u>90210</u></p> <div style="display: flex; justify-content: space-between; font-size: 8pt;"> <div><i>Agent's Street Address (if agent is not a corporation) - Do not list a P.O. Box</i></div> <div><i>City (no abbreviations)</i></div> <div><i>State</i></div> <div><i>Zip</i></div> </div>		
<p>Management (Check only one.)</p> <p>⑤ The LLC will be managed by:</p> <div style="display: flex; justify-content: space-around;"> <input checked="" type="checkbox"/> One Manager <input type="checkbox"/> More Than One Manager <input type="checkbox"/> All Limited Liability Company Member(s) </div>		
<p>This form must be signed by each organizer. If you need more space, attach extra pages that are 1-sided and on standard letter-sized paper (8 1/2" x 11"). All attachments are made part of these articles of organization.</p> <div style="display: flex; justify-content: space-between; align-items: flex-end; margin-top: 20px;"> <div style="text-align: center;"> Organizer - Sign here </div> <div style="text-align: center;"> <u>Melvin H. Malat, Esq.</u> Print your name here </div> </div>		
<div style="display: flex; justify-content: space-between;"> <div> <p>Make check/money order payable to: Secretary of State</p> <p>Upon filing, we will return one (1) uncertified copy of your filed document for free, and will certify the copy upon request and payment of a \$5 certification fee.</p> </div> <div style="text-align: center;"> <p>By Mail</p> <p>Secretary of State Business Entities, P.O. Box 944228 Sacramento, CA 94244-2280</p> </div> <div style="text-align: center;"> <p>Drop-Off</p> <p>Secretary of State 1500 11th Street, 3rd Floor Sacramento, CA 95814</p> </div> </div>		
<div style="display: flex; justify-content: space-between;"> <div> <p>Corporations Code §§ 17701.04, 17701.08, 17701.13, 17702.01, Revenue and Taxation Code § 17941 LLC-1 (REV 01/2014)</p> </div> <div style="text-align: right;"> <p>2014 California Secretary of State www.sos.ca.gov/business/be</p> </div> </div>		

- Statement of Information - Typically there will be one Manager-Member identified, along with the business mailing address for the entity.

 Secretary of State Statement of Information (Limited Liability Company)	LLC-12	20-E03894 FILED In the office of the Secretary of State of the State of California OCT 06, 2020 This Space For Office Use Only
IMPORTANT — Read instructions before completing this form. Filing Fee — \$20.00 Copy Fees — First page \$1.00; each attachment page \$0.50; Certification Fee - \$5.00 plus copy fees		
1. Limited Liability Company Name (Enter the exact name of the LLC. If you registered in California using an alternate name, see instructions.) 1819 S. GRAMERCY, LLC		
2. 12-Digit Secretary of State File Number 201501010200		3. State, Foreign Country or Place of Organization (only if formed outside of California) CALIFORNIA
4. Business Addresses		
a. Street Address of Principal Office - Do not list a P.O. Box 6420 Wilshire Blvd., Suite 1420		City (no abbreviations) Los Angeles
b. Mailing Address of LLC, if different than item 4a 6420 Wilshire Blvd., Suite 1420		City (no abbreviations) Los Angeles
c. Street Address of California Office, if item 4a is not in California - Do not list a P.O. Box 6420 Wilshire Blvd., Suite 1420		City (no abbreviations) Los Angeles
State Zip Code CA 90048		
5. Manager(s) or Member(s) <small>If no managers have been appointed or elected, provide the name and address of each member. At least one name and address must be listed. If the manager/member is an individual, complete items 5a and 5c (leave item 5b blank). If the manager/member is an entity, complete items 5b and 5c (leave item 5a blank). Note: The LLC cannot serve as its own manager or member. If the LLC has additional managers/members, enter the name(s) and addresses on Form LLC-12A (see instructions).</small>		
a. First Name, if an individual - Do not complete item 5b kmm Management, Inc		Middle Name Last Name Suffix
b. Entity Name - Do not complete item 5a kmm Management, Inc		
c. Address 6420 Wilshire Blvd., Suite 1420		City (no abbreviations) Los Angeles
		State Zip Code CA 90048
6. Service of Process (Must provide either individual OR Corporation.) INDIVIDUAL - Complete items 6a and 6b only. Must include agent's full name and California street address.		
a. California Agent's First Name (if agent is not a corporation) Maria		Middle Name Last Name Suffix
b. Street Address (if agent is not a corporation) - Do not enter a P.O. Box 6420 Wilshire Blvd., Suite 1420		City (no abbreviations) Los Angeles
		State Zip Code CA 90048
CORPORATION - Complete item 6c only. Only include the name of the registered agent Corporation.		
c. California Registered Corporate Agent's Name (if agent is a corporation) - Do not complete item 6a or 6b		
7. Type of Business a. Describe the type of business or services of the Limited Liability Company Ownership of Real Property		
8. Chief Executive Officer, if elected or appointed		
a. First Name		Middle Name Last Name Suffix
b. Address		City (no abbreviations) State Zip Code
9. The information contained herein, including any attachments, is true and correct.		
10/06/2020 Date	Gerald A. Malat esq Type or Print Name of Person Completing the Form	attorney Title
Signature		
Return Address (Optional) (For communication from the Secretary of State related to this document, or if purchasing a copy of the filed document enter the name of a person or company and the mailing address. This information will become public when filed. SEE INSTRUCTIONS BEFORE COMPLETING.)		
Name: []		
Company:		
Address:		
City/State/Zip: []		

- Run the Business Search again if the named Manager-Member is an organizational entity

Business Search

The California Business Search provides access to available information for **corporations, limited liability companies and limited partnerships** of record with the California Secretary of State, with **free PDF copies** of over 17 million imaged business entity documents, including the most recent imaged Statements of Information filed for Corporations and Limited Liability Companies.

Currently, information for Limited Liability Partnerships (e.g. law firms, architecture firms, engineering firms, public accountancy firms, and land survey firms), General Partnerships, and other entity types are **not contained** in the California Business Search. If you wish to obtain information about LLPs and GPs, submit a Business Entities Order paper form to request copies of filings for these entity types. *Note: This search is not intended to serve as a name reservation search. To reserve an entity name, select Forms on the left panel and select Entity Name Reservation ? Corporation, LLC, LP.*

Basic Search

- A Basic search can be performed using an entity name or entity number. When conducting a search by an entity number, where applicable, **remove "C"** from the entity number. **Note, a basic search will search only ACTIVE entities** (Corporations, Limited Liability Companies, Limited Partnerships, Cooperatives, Name Reservations, Foreign Name Reservations, Unincorporated Common Interest Developments, and Out of State Associations). The basic search performs a contains "keyword" search. The Advanced search allows for a "starts with" filter. To search entities that have a status other than active or to refine search criteria, use the **Advanced** search feature.

Advanced Search

- An Advanced search is required when searching for publicly traded disclosure information or a status other than active.
- An Advanced search allows for searching by specific entity types (e.g., Nonprofit Mutual Benefit Corporation) or by entity groups (e.g., All Corporations) as well as searching by "begins with" specific search criteria.

Disclaimer: Search results are limited to the 500 entities closest matching the entered search criteria. If your desired search result is not found within the 500 entities provided, please refine the search criteria using the Advanced search function for additional results/entities. The California Business Search is updated as documents are approved. The data provided is not a complete or certified record.

Although every attempt has been made to ensure that the information contained in the database is accurate, the Secretary of State's office is not responsible for any loss, consequence, or damage resulting directly or indirectly from reliance on the accuracy, reliability, or timeliness of the information that is provided. All such information is provided "as is." To order certified copies or certificates of status, (1) locate an entity using the search; (2) select Request Certificate in the right-hand detail drawer; and (3) complete your request online.



Advanced ▾

Results: 1

Entity Information ▾	Initial Filing Date ▾	Status ▾	Entity Type ▾	Formed In ▾	Agent ▾
KMM MANAGEMENT, INC. (3139495) >	02/13/2009	Active	Stock Corporation - CA - General	CALIFORNIA	SHARON STEIN

KMM MANAGEMENT, INC.
(3139495) X

Request Certificate

Initial Filing Date	02/13/2009
Status	Active
Standing - SOS	Good
Standing - FTB	Good
Standing - Agent	Good
Standing - VCFCF	Good
Formed In	CALIFORNIA
Entity Type	Stock Corporation - CA - General
Principal Address	6420 WILSHIRE BOULEVARD, SUITE 1420 LOS ANGELES, CA 90048
Mailing Address	6420 WILSHIRE BOULEVARD, SUITE 1420 LOS ANGELES, CA 90048
Statement of Info Due Date	02/28/2023
Agent	Individual SHARON STEIN 6420 WILSHIRE BLVD, SUITE 1420 LOS ANGELES, CA 90048

View History

Request Access

- The name of an individual has been identified



**California Secretary of State
Electronic Filing**



Corporation - Statement of Information

Entity Name: KMM MANAGEMENT, INC.

Entity (File) Number: C3139495

File Date: 03/13/2022

Entity Type: Corporation

Jurisdiction: CALIFORNIA

Document ID: H324782

Detailed Filing Information

1. Entity Name: KMM MANAGEMENT, INC.
2. Business Addresses:
 - a. Street Address of Principal Office in California: 6420 Wilshire Boulevard, Suite 1420
Los Angeles, California 90048
United States of America
 - b. Mailing Address: 6420 Wilshire Boulevard, Suite 1420
Los Angeles, California 90048
United States of America
 - c. Street Address of Principal Executive Office: 6420 Wilshire Boulevard, Suite 1420
Los Angeles, California 90048
United States of America
3. Officers:
 - a. Chief Executive Officer: Sharon Stein
6420 Wilshire Boulevard, Suite 1420
Los Angeles, California 90048
United States of America
 - b. Secretary: Sharon Stein
6420 Wilshire Boulevard, Suite 1420
Los Angeles, California 90048
United States of America

Document ID: H324782

Use bizfile.sos.ca.gov for online filings, searches, business records, and resources.

- All states

-

 Enter a person or company name to search

O

Search for people or companies

Refine Your Search

States

1 Results Found

Officers: Kmm Management, Inc. , Abraham Stein

✕



- Use organizational entity names to search on NetR
 - Pickford Partners LLC or Lockwood Investors LLC (No direct address included in name)
 - Entity names no longer highlighted may no longer be active – i.e. property may have been sold (522 South Normandie LLC or 558 North Alexandria LLC)
 - If names are not found, experiment with the names a bit and do some additional vetting, for example returning to use the state's Business Search (256 Crandall Street LLC or 1144 Westmoreland LLC)

- Additional Searching
 - <https://opencorporates.com/> (Open Corporates)
- Search by name of Officers

opencorporates

About

Our Purpose

Our Data

Governance

Our Team

Latest

Contact

Sign In

The largest open database
of companies in the world

Search 187,932,997 companies

All jurisdictions

Q

Companies

Officers

Browse all jurisdictions →

Found 53 officers

Searching All jurisdictions > United States > California

Sharon Stein

GO

☐ exclude inactive

Advanced Options

inactive

SHARON L STEIN

chief executive officer,

inactive

LATROBE INVESTMENTS, INC. (California (US), 20 Jan 2004-30 Nov 2017)

SHARON M STEIN

agent,

inactive

SMS IMAGING, INC. (California (US), 1 May 2024-)

inactive

SHARON STEIN

agent,

inactive

USER INTERFACE TECHNOLOGY, INC. (California (US), 26 Jul 1991-1 Nov 1993)

inactive

SHARON STEIN

chief executive officer,

inactive

SHASTE MANAGEMENT, INC. (California (US), 20 Dec 1999- 8 Mar 2012)

inactive

SHARON STEIN

manager,

inactive

STEIN AUTOMOTIVE, LLC (California (US), 5 Sep 2012-10 Jun 2013)

inactive

SHARON STEIN

manager,

inactive

258 SERRANO, LLC (California (US), 28 Jan 2000-1 May 2012)

SHARON STEIN

manager,

inactive

SHASTE HOUSING FUND NO. 1, LLC (California (US), 6 Feb 2018-)

inactive

SHARON STEIN

agent,

inactive

838 VICTOR AVENUE, LLC (California (US), 3 Aug 2007-2 Dec 2013)

inactive

SHARON STEIN

manager,

inactive

723 NORTH GRAMERCY, LLC (California (US), 29 Aug 2003-1 Apr 2015)

inactive

SHARON STEIN

manager,

inactive

865 GLENWAY, LLC (California (US), 17 Oct 2006-1 Apr 2015)

inactive

SHARON STEIN

inactive

826 NORTH HOBART, LLC (California (US), 28 Feb 2002-)

inactive

SHARON STEIN

manager,

inactive

2117 CLINTON STREET, LLC (California (US), 21 Mar 2003-3 Oct 2011)

inactive

SHARON STEIN

manager,

inactive

826 NORTH HOBART, LLC (California (US), 28 Feb 2002-)

inactive

SHARON STEIN

manager,

inactive

149 N. COMMONWEALTH, LLC (California (US), 22 Oct 2002-1 May 2012)

inactive

SHARON STEIN

manager,

inactive

341 S. KENMORE, LLC (California (US), 22 Sep 1999-27 Sep 2013)

SHARON STEIN

agent,

inactive

SHASTE HOUSING FUND NO. 1, LLC (California (US), 6 Feb 2018-)

inactive

SHARON STEIN

manager,

inactive

247 S. NORMANDIE, LLC (California (US), 9 Nov 2001-27 Jan 2015)

SHARON STEIN

secretary,

nonprofit

THE STEIN FAMILY FOUNDATION (California (US), 2 Aug 2007-)

inactive

SHARON STEIN

inactive

723 NORTH GRAMERCY, LLC (California (US), 29 Aug 2003-1 Apr 2015)

inactive

SHARON STEIN

inactive

341 S. KENMORE, LLC (California (US), 22 Sep 1999-27 Sep 2013)

inactive

SHARON STEIN

inactive

140 N. BERENDO, LLC (California (US), 3 Aug 2001-1 May 2013)

inactive

SHARON STEIN

SHASTE HOUSING FUND NO. 1, LLC (California (US), 6 Feb 2018-)

inactive

SHARON STEIN

inactive

865 GLENWAY, LLC (California (US), 17 Oct 2006-1 Apr 2015)

Filtered by jurisdiction

53 California (US)

remove filter

Filter by position

7 agent

4 chief executive officer

1 director

20 manager

2 secretary

19 [blank]

Filter by nationality

53 [blank]

Filter by occupation

53 [blank]

Officer's name

SEARCH



☐ Companies ☒ Officers ☒ only in California (US)

[Log in](#)/[Sign up](#)

Found 85 officers

Searching All jurisdictions > United States > California

Abraham Stein

GO

☐ exclude inactive

Advanced Options

inactive	ABRAHAM STEIN	agent,	inactive	511 RAMPART, LLC	(California (US), 22 Apr 1996-)
inactive	ABRAHAM STEIN	agent,	inactive	2128 SOUTH CRENSHAW BLVD., LLC	(California (US), 31 Jul 2003-)
inactive	ABRAHAM STEIN	agent,	inactive	1260 BEACHWOOD, LLC	(California (US), 18 Dec 1997-)
inactive	ABRAHAM STEIN	agent,	inactive	912 SOUTH BERENDO, LLC	(California (US), 11 Oct 2005-)
ABRAHAM STEIN agent, LARRABEE CONDO PROJECT, L.P. (California (US), 10 May 1989-)					
inactive	ABRAHAM STEIN	agent,	inactive	2205 WEST 15TH STREET, LLC	(California (US), 8 Feb 2005-)
inactive	ABRAHAM STEIN	agent,	inactive	1275 NORTH HAVENHURST DRIVE CONDOMINIUMS	(California (US), 28 Mar 1979-)
inactive	ABRAHAM STEIN	agent,	inactive	1275 HARPER, INC.	(California (US), 8 Apr 1991-)
inactive	ABRAHAM STEIN	agent,	inactive	7TH AVENUE, LLC	(California (US), 19 Feb 1997-)
inactive	ABRAHAM STEIN	agent,	inactive	KRAS, INC.	(California (US), 31 Aug 1983-)

Filtered by jurisdiction

85 California (US)

✖ remove filter

Filter by position

85 agent

Filter by nationality

85 [blank]

Filter by occupation

85 [blank]

5) Search LLC entities on Net R Online to collect property addresses

- Use company and grantee search options

Date Range From: 01/01/1977 To: 09/28/2020

Company: Property on James Wood LLC

Name FIRST LAST

Signator ☐ grantor ☒ grantee

or

AIN Document #

Search 1 document found

Doc #	Date	Type	Grantors	Grantees
20150634587	2015-06-01	DEED Add to cart	2743 JAMES M WOOD LLC	PROPERTY ON JAMES WOOD LLC

○

RECORDING REQUESTED BY
North American Title Company, Inc.

AND WHEN RECORDED MAIL DOCUMENT TO:
Property on James Wood, LLC
3660 Wilshire Blvd #218
Los Angeles, CA 90010



Space Above This Line for Recorder's Use Only

A.P. No. 5077-025-022

GRANT DEED

The Undersigned Grantor(s) Declare(s): DOCUMENTARY TRANSFER TAX \$1,210.00; CITY TRANSFER TAX \$4,950.00;
SURVEY MONUMENT FEE \$

[X] computed on the consideration or full value of property conveyed, OR
[] computed on the consideration or full value less value of liens and/or encumbrances remaining at time of sale,
[] unincorporated area; [X] City of Los Angeles, and

FOR A VALUABLE CONSIDERATION, receipt of which is hereby acknowledged, 2743 JAMES M. WOOD, LLC, a
California limited liability company

hereby GRANTS to Property on James Wood, LLC, a California limited liability company

the following described property in the City of Los Angeles, County of Los Angeles, State of California:

LOT 22 OF THE STASSFORTH TRACT, IN THE CITY OF LOS ANGELES, COUNTY OF LOS
ANGELES, STATE OF CALIFORNIA, AS PER MAP RECORDED IN BOOK 1 PAGE 29 OF MAPS, IN
THE OFFICE OF THE COUNTY RECORDER OF SAID COUNTY.

Has Tax Statements To: SAME AS ABOVE

11E

BizProfile - www.bizprofile.net

- Search by Agent Name of the Landlord's LLCs

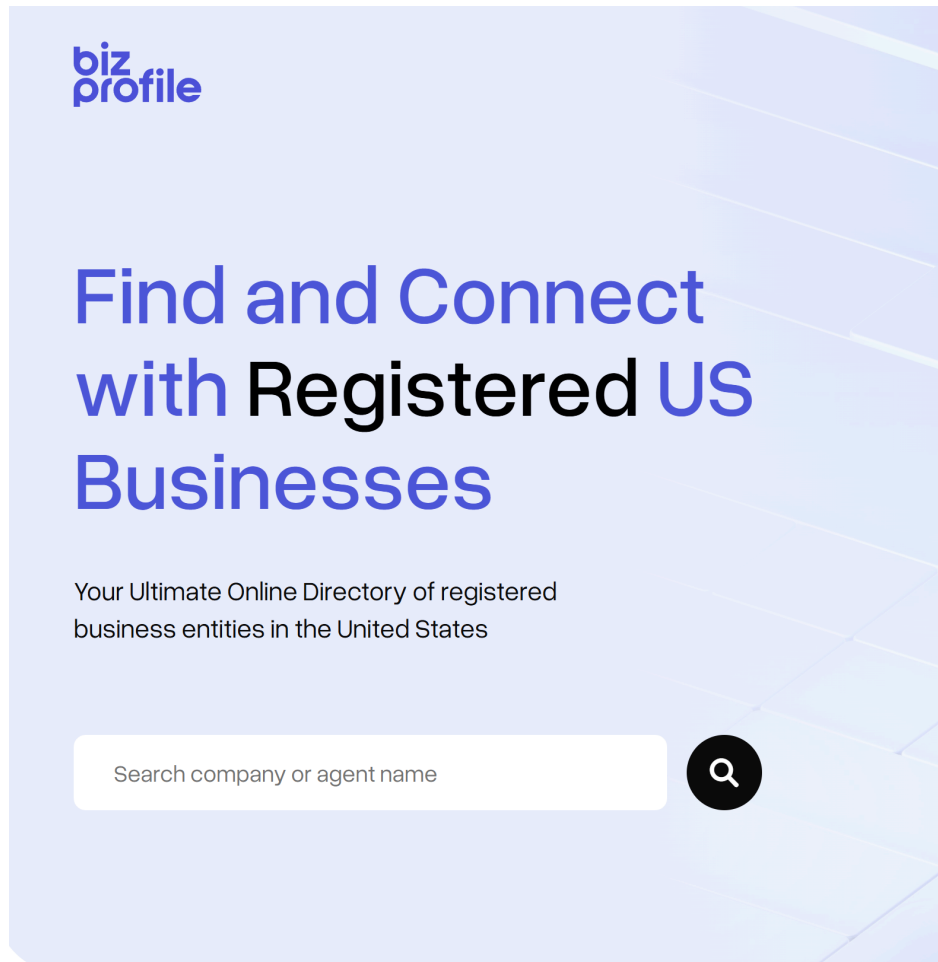

**Vast database of U.S.
businesses, from a large
corporation to a small startup**

Welcome to Bizprofile — online directory of registered business entities in the United States, offering comprehensive information on registered business entities across the US

It serves as a gateway to a vast database of U.S. businesses, catering to a wide range of needs, whether one is searching for a large corporation or a small startup.

Results for *MARIA BARBA*

Q Showing 50 companies

Company name	Address	Filing date	Status	Entity type	Register Agent	Participants
Burlington Buildings, LLC	2220 Ave. Of The Stars #2001 Los Angeles, CA 90067	3/15/2011	Active	Cooperative Association	MARIA BARBA	MOISES WITEMBERG
756 South New Hampshire, LLC	2220 Ave. Of The Stars #2001 Los Angeles, CA 90067	12/27/2010	Active	Cooperative Association	MARIA BARBA	MOISES WITEMBERG
211 S. Normandie, llc	6420 Wilshire Blvd #1420 Los Angeles, CA 90048	10/26/2017	Active	Cooperative Association	MARIA BARBA	KMM MANAGEMENT, INC. A CALIFORNIA CORPORATION
557 North Kenmore, LLC	2220 Avenue Of The Stars, 2001 Los Angeles, CA 90067	4/5/2012	Active	Cooperative Association	MARIA BARBA	MOISES WITEMBERG
924 North Kingsley, LLC	6420 Wilshire Blvd., Suite 1420 Los Angeles, CA 90048	4/1/2004	Active	Cooperative Association	MARIA BARBA	KMM MANAGEMENT INC, A CALIFORNIA CORPORATION
1819 S. Gramercy, LLC	6420 Wilshire Blvd., Suite 1420 Los Angeles, CA 90048	1/6/2015	Active	Cooperative Association	MARIA BARBA	kmm Management, Inc

Filing information

[Update information about my company](#)

Company Name	1819 S. Gramercy, LLC
Entity type	Limited Liability Company
Governing Agency	California Secretary of State
Document Number	201501010200
Date Filed	January 6, 2015
Company Age	10 years 7 months
State	CA
Status	Active
Formed In	California
Standing	
Secretary of State	Good
Franchise Tax Board	Good
Agent	Good
Victims of Corporate Fraud Compensation Fund	Good
Type of Business	OWNERSHIP OF REAL PROPERTY

The data on 1819 S. Gramercy, LLC was extracted from the California Secretary of State's Registry (<https://bizfileonline.sos.ca.gov/search/business/>) as of 7/15/2025.



Company Contacts



Principal Address

6420 Wilshire Blvd., Suite 1420
Los Angeles, CA 90048

[Principal address for 4 entities. See all →](#)



Mailing Address

6420 Wilshire Blvd., Suite 1420
Los Angeles, CA 90048



Agent

Individual

Maria Barba

6420 Wilshire Blvd. Suite 1420
Los Angeles, CA 90048

[Registered agent for 9 entities](#)



Principal(s)

Manager

Kmm Management,inc

6420 Wilshire Blvd., Suite 1420
Los Angeles, CA 90048

[Authorized person for 6 entities. See all →](#)

Open Data

Los Angeles City Open Data portal - <https://data.lacity.org/>

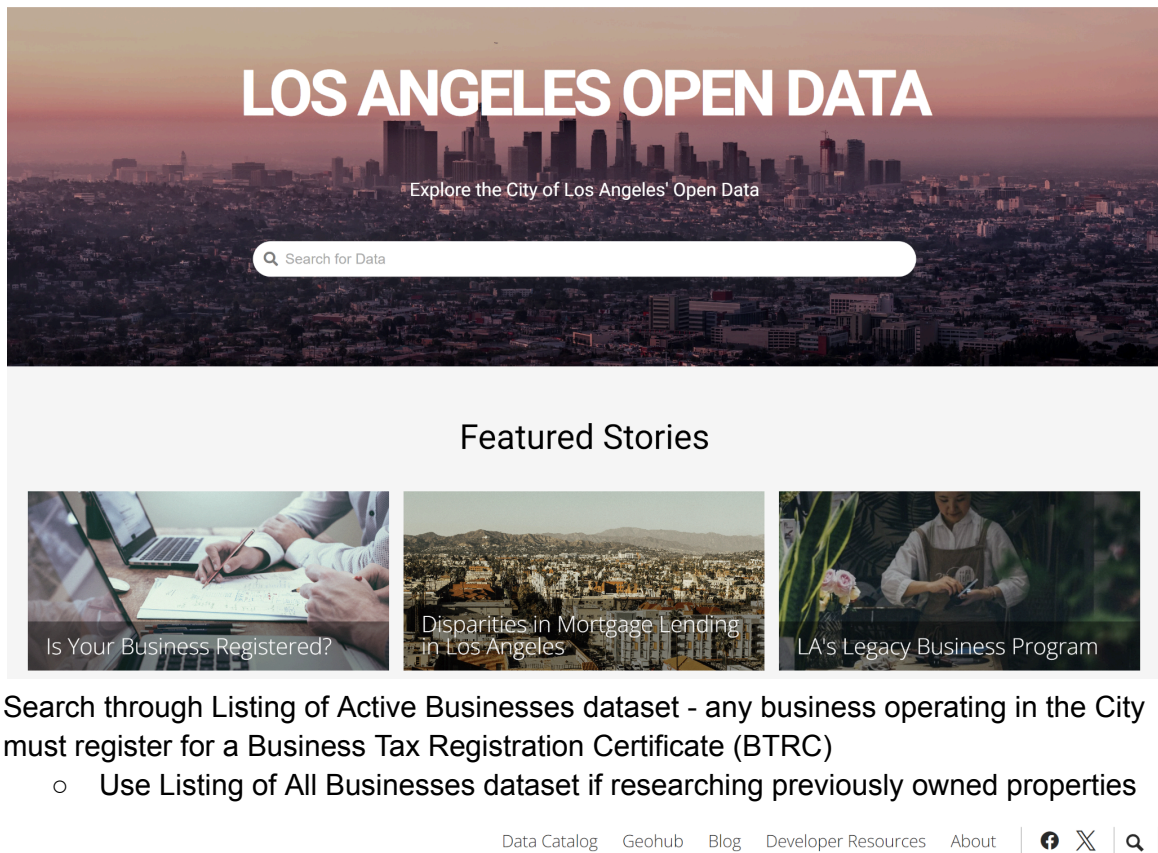

-
- Search through Listing of Active Businesses dataset - any business operating in the City must register for a Business Tax Registration Certificate (BTRC)
 - Use Listing of All Businesses dataset if researching previously owned properties

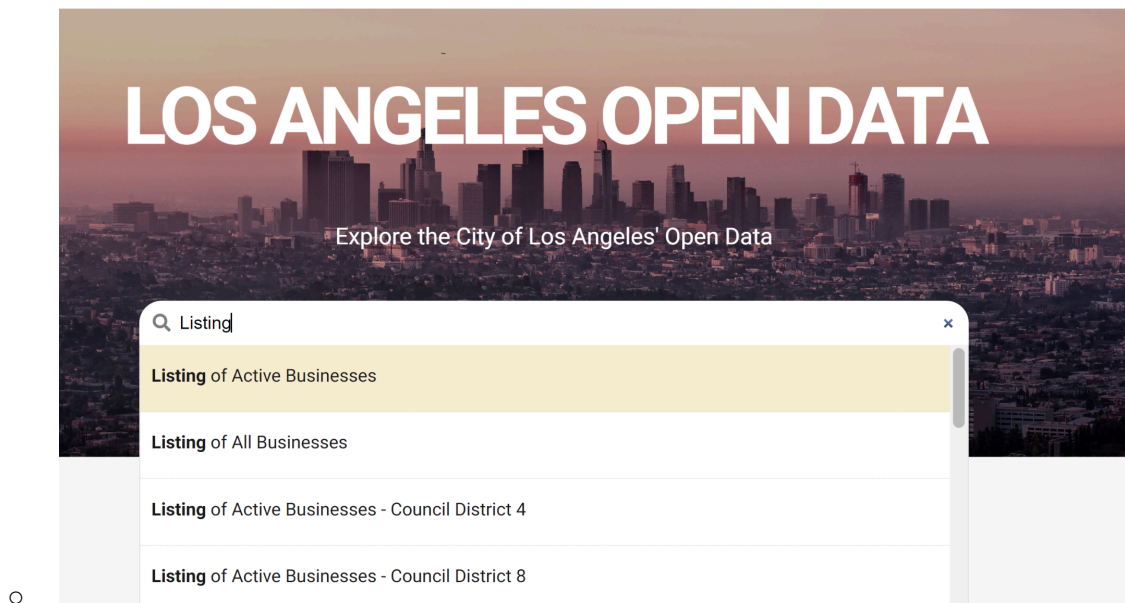

- Search results

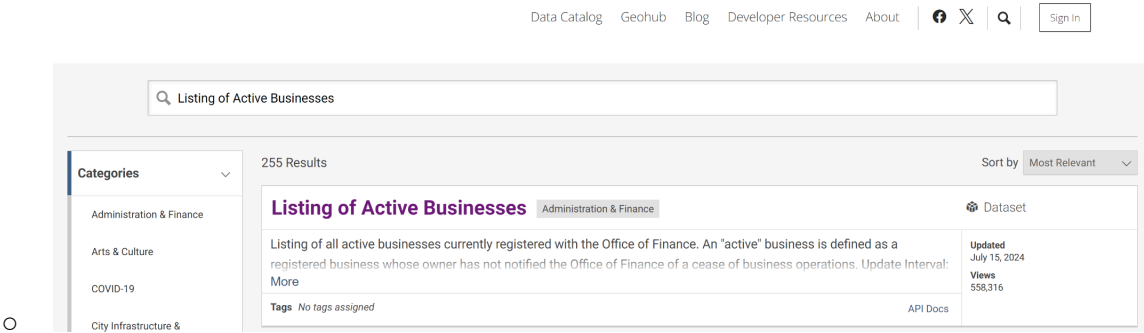

- Click on the Data tab

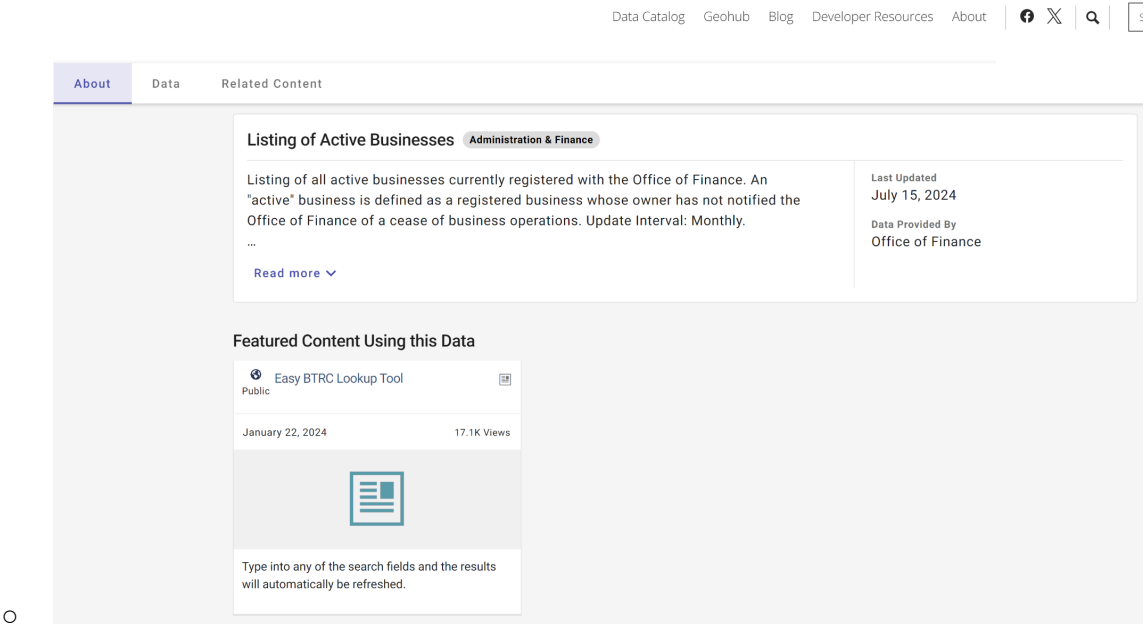

- Enter business mailing addresses in the search bar

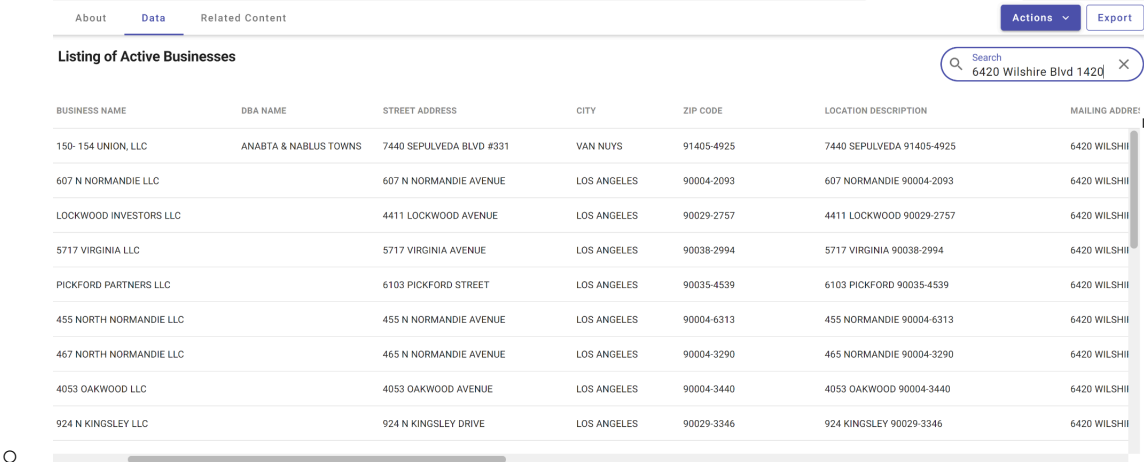

- Query to download specific data

About Data Related Content						
Listing of Active Businesses						
LOCATION ACCOUNT #	BUSINESS NAME	DBA NAME	STREET ADDRESS	CITY	ZIP CODE	LOCATION DESCRIPTION
0000000108-0001-3	PALACE OF VENICE GUEST HOME /C		1727 CRENSHAW BLVD	LOS ANGELES		1727 CRENSHAW
0000000121-0001-9	WILCARE ECONOMIC DEVELOPMENT CO		9911 AVALON BLVD	LOS ANGELES		9911 AVALON 900
0000000132-0001-7	CARLOS ANGEL		1221 W 7TH STREET SUITE #N-111	LOS ANGELES		1221 7TH 90017-4
0000000133-0001-1	A A OFICINA CENTRAL HISPANA DE LOS		4917 S BROADWAY	LOS ANGELES	90037-3211	4917 BROADWAY
0000000141-0001-6	A A OFICINA CENTRAL HISPANA DE LOS		1330 WILSHIRE BLVD #208	LOS ANGELES	90017-1705	1330 WILSHIRE 90
0000000150-0001-5	A A OFICINA CENTRAL HISPANA DE LOS		2015 W TEMPLE STREET	LOS ANGELES	90026-4913	2015 TEMPLE 900
0000000156-0001-2	SPRINGBOARD NON-PROFIT CONSUMER MONEY MANAGEMENT INTER		1605 W OLYMPIC BLVD #9023	LOS ANGELES	90015-3828	1605 OLYMPIC 90
0000000168-0001-5	KIMBERLY FREESH		10926 OWENSMOUTH AVENUE	CHATSWORTH	91311-1342	10926 OWENSMO
0000000171-0001-7	EAST LA COMMUNITY CORP		121 N CHICAGO STREET	LOS ANGELES	90033-2904	121 CHICAGO 900

- Enter mailing addresses and download as a csv file

Back to overview Switch to grid view						
LOCATION ACCOUNT #	BUSINESS NAME	DBA NAME	STREET ADDRESS	CITY	ZIP CODE	LOCATION DESCRIPTION
0000563712-0001-6	150- 154 UNION, LLC	ANABTA & NABLUS TOWNS	7440 SEPULVEDA BLVD #331	VAN NUYS	91405-4925	7440 SEPULVEDA 914C
0000802784-0002-0	1427 POINT VIEW LLC		1427 S POINT VIEW STREET	LOS ANGELES	90035-3966	1427 POINT VIEW 900C
0002075511-0001-8	607 N NORMANDIE LLC		607 N NORMANDIE AVENUE	LOS ANGELES	90004-2093	607 NORMANDIE 9000
0002086223-0001-0	LOCKWOOD INVESTORS LLC		4411 LOCKWOOD AVENUE	LOS ANGELES	90029-2757	4411 LOCKWOOD 9002
0002086237-0001-1	5717 VIRGINIA LLC		5717 VIRGINIA AVENUE	LOS ANGELES	90038-2994	5717 VIRGINIA 90038-4

- Add data to a My Google Maps

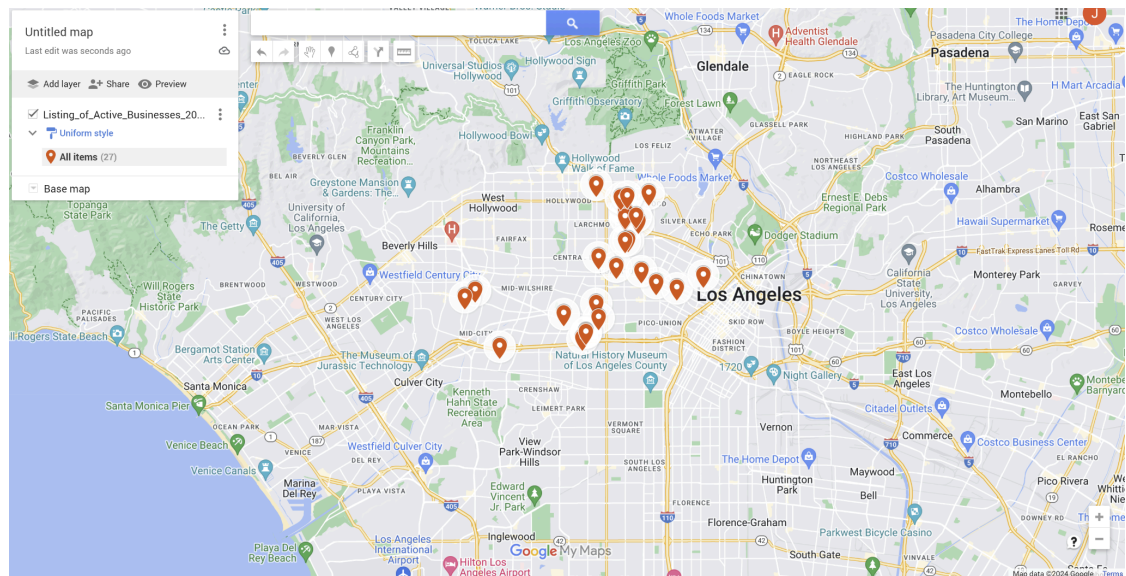

PropertyRadar

Paid subscription - <https://www.propertyradar.com/>



Customers

Features

Learn

Login

Pricing

Try It Free

**Find and connect with
property owners by *phone*,
email, *direct mail*, *in-person*,
and *online*.**

Discover opportunities in property and owner data to grow your business. Research residential and commercial properties using enhanced public records data.

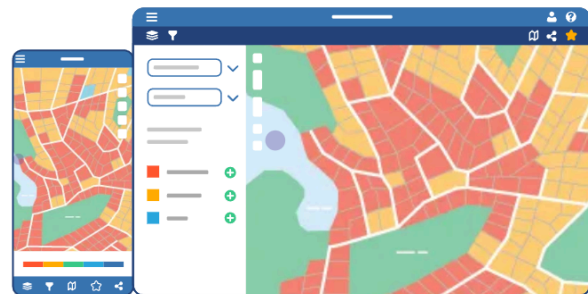

Try It Free

Watch a Demo ▶

-
- Search by property address - click the property icon

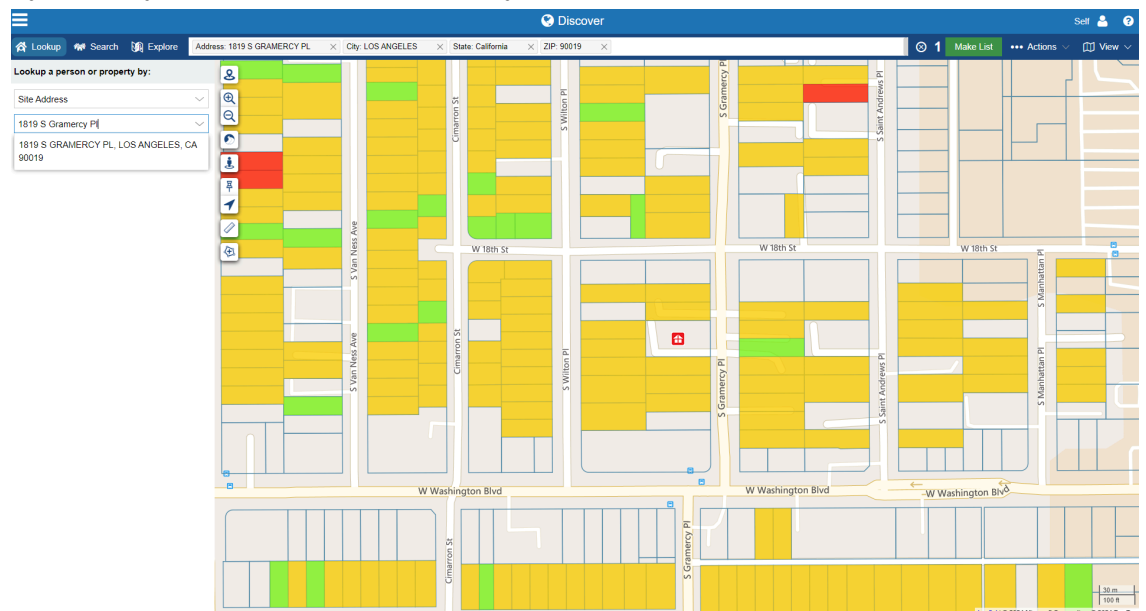

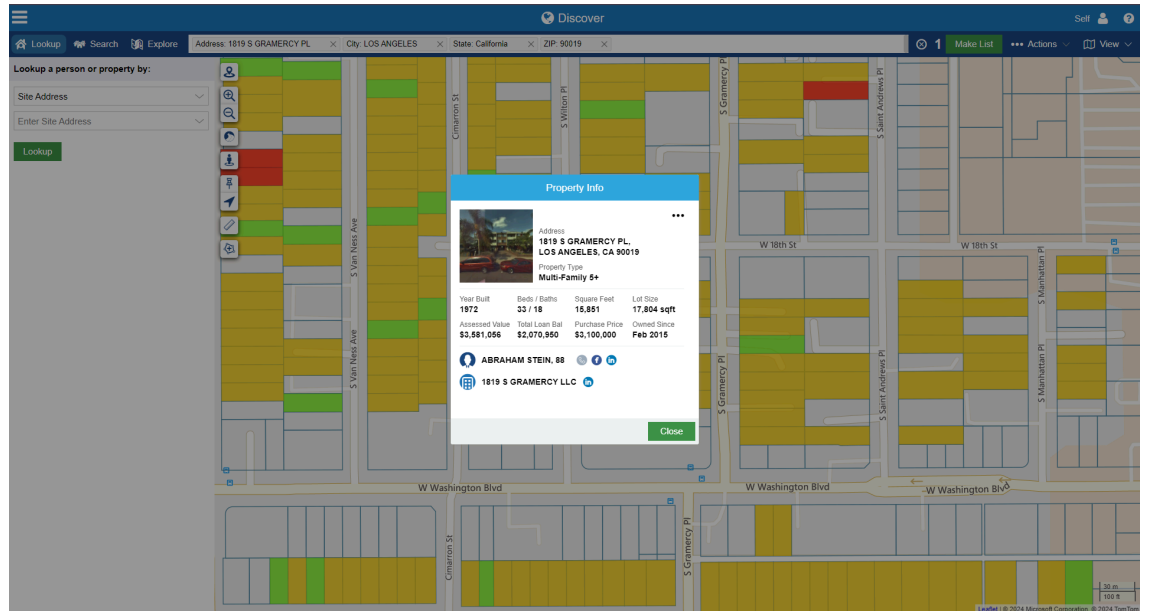

- Click the Transactions tab to view the transaction history of the property

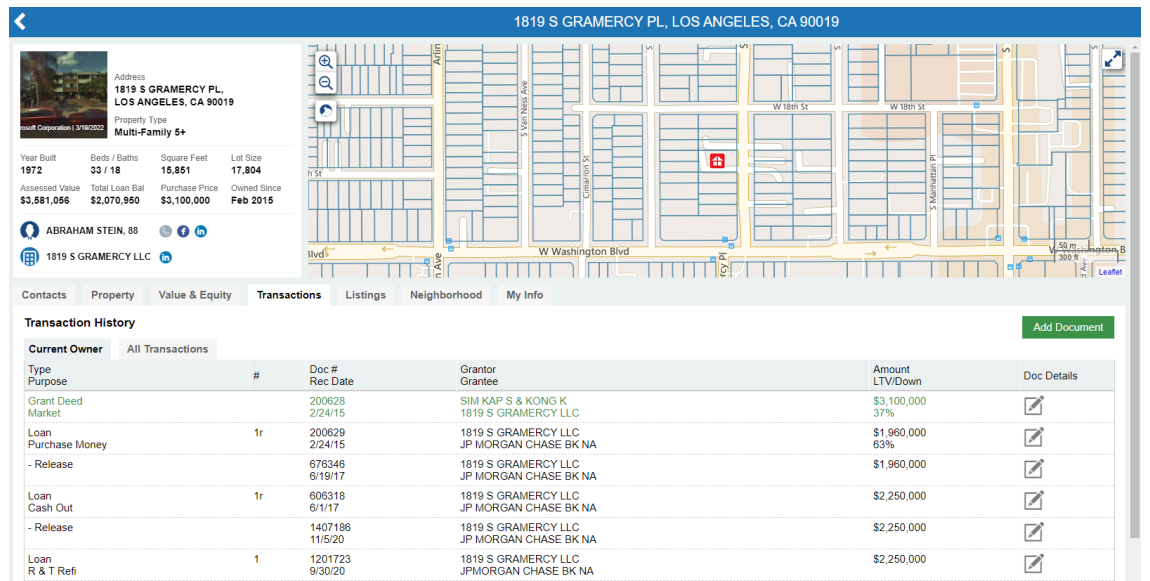

- Click the Property tab to view the listed business mailing address & other connected properties



1819 S GRAMERCY LLC [edit](#)

Person Type

Company

Ownership Role

Owner

Primary Contact

☐

Phone [edit](#)



[Add Phone](#)

Email [edit](#)



[Add Email](#)

Social [edit](#)



Skip Trace







Mailing Address

3660 WILSHIRE BLVD 218, LOS ANGELES, CA 90010

Notes

No Notes

o

Contacts	Property	Value & Equity	Transactions	Listings	Neighborhood	My Info
<div> ABRAHAM STEIN edit</div>						
Person Type		Person				
Ownership Role		Principal				
Gender		Male				
Age		88				
Primary Contact		<input checked="" type="checkbox"/>				
Phone edit		<div> Unlock Phone (250 of 250 remaining).</div> <div> Add Phone</div>				
Email edit		<div> Add Email</div>				
Social edit		<div> </div>				
Skip Trace		<div><input type="text" value=""/></div>				
Mailing Address		10660 WILSHIRE BLVD 1501, LOS ANGELES, CA 90024				
Primary Residence		10660 WILSHIRE BLVD 1501, LOS ANGELES, CA 90024				
Other Properties		<div>133 S PARK VIEW ST, LOS ANGELES, CA 90057 557 N KENMORE AVE, LOS ANGELES, CA 90004 731 S NEW HAMPSHIRE AVE, LOS ANGELES, CA 90005 235 S NORMANDIE AVE, LOS ANGELES, CA 90004 Unknown, Unknown, CA 239 S NORMANDIE AVE, LOS ANGELES, CA 90004 535 N HELIOTROPE DR, LOS ANGELES, CA 90004 501 N ALEXANDRIA AVE, LOS ANGELES, CA 90004 1554 S GRAMERCY PL, LOS ANGELES, CA 90019 2664 S BUDLONG AVE, LOS ANGELES, CA 90007 816 S WESTLAKE AVE, LOS ANGELES, CA 90057 1200 ARAPAHOE ST, LOS ANGELES, CA 90006 743 S BERENDO ST, LOS ANGELES, CA 90005 3315 W ADAMS BLVD, LOS ANGELES, CA 90018 150 UNION PL, LOS ANGELES, CA 90026 4929 ROSEWOOD AVE, LOS ANGELES, CA 90004 2340 CRENSHAW BLVD, LOS ANGELES, CA 90016 909 S BONNIE BRAE ST, LOS ANGELES, CA 90006 4023 W 28TH ST, LOS ANGELES, CA 90018 10660 WILSHIRE BLVD 1501, LOS ANGELES, CA 90024</div> <div>More results available. Use Lookup.</div>				

- Search by Mailing Address

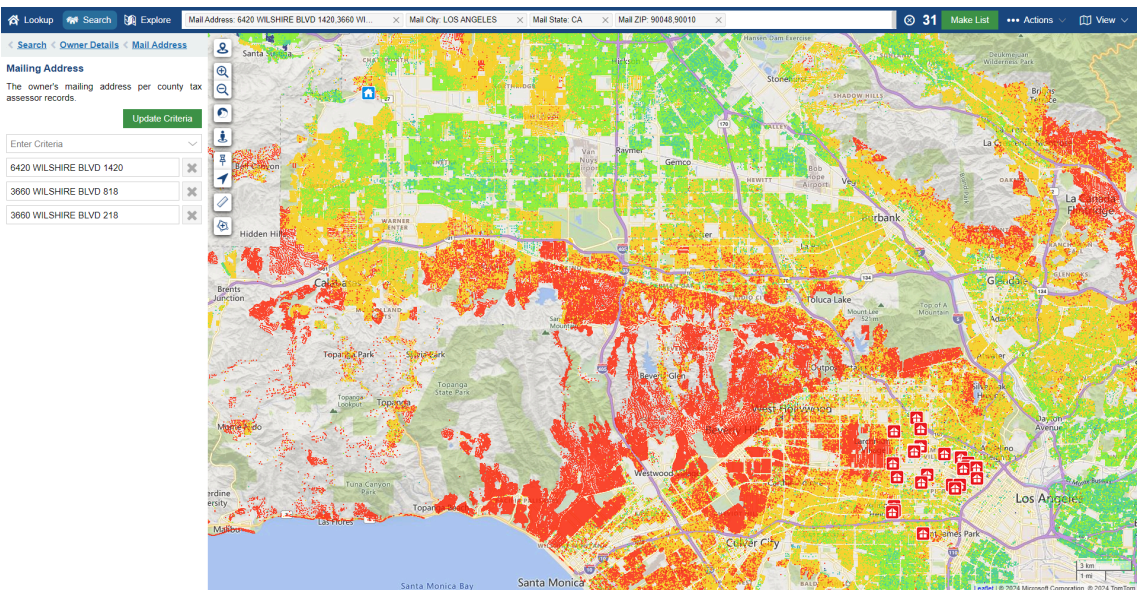

-
-

Workshop Evaluation

