

HAZIRLAYAN: AHMET ULUSOY

PROJE :

TARİH

26-10-2022

(KONYA AÇIK HAVA MÜZESİ.ST4)

## ÝÇÝNDEKÝLER

Sayfa 1	ÖZET VE SİSTEMİN TANITILMASI	
Sayfa 2	-YAPI 3D GÖRÜNÜŞÜ	
Sayfa 3	-TEMEL APLİKASYON PLANI	
Sayfa 4	-1. NORMAL KAT KALIP APLİKASYON PLANI	
Sayfa 5	-2. NORMAL KAT KALIP APLİKASYON PLANI	
Sayfa 6	-DÖĐEME YÜK ANALÝZÝ	
Sayfa 7	-KÝRÝĐ YÜK ANALÝZÝ	
Sayfa 8	-STA4-CAD PROGRAMI	
Sayfa 9	-BETONARME HESAP YÜK KOMBÝNASYONU	
Sayfa 10	-KAT DIYAFRAMLARI	
Sayfa 11	-DEPREM RAPORU	
Sayfa 13	-DEPREMDE YAPI DÜZENSÝZLÝKLERÝNÝN KONTROLU	Sayfa
14	-MODAL ANALÝZ MOD GRAFÝĐÝ (1000 x Dep. vektörü)	Sayfa
15	-KÝRÝĐ DÜĐEY YÜK BÝLGÝLERÝ	
Sayfa 17	-KOLON YÜK BÝLGÝLERÝ	
Sayfa 20	-DUVAR YÜK BÝLGÝLERÝ	
Sayfa 21	-DÖĐEME ĐERÝT BÝLGÝLERÝ	
Sayfa 22	-DÖĐEME BÝLGÝLERÝ	
Sayfa 23	-MANTAR DÖĐEME STATÝK HESAP SONUÇLARI	(tm)
Sayfa 27	-DÖĐEME BETONARME HESAP SONUÇLARI	
Sayfa 28	-KÝRÝĐ VE PANEL BÝLGÝLERÝ	
Sayfa 29	-KÝRÝĐ STATÝK HESAP SONUÇLARI	
Sayfa 34	-KÝRÝĐ BETONARME HESAP SONUÇLARI	
Sayfa 37	-KOLON STATÝK HESAP SONUÇLARI	
Sayfa 40	-KOLON BETONARME HESAP SONUÇLARI	
Sayfa 41	-GÜÇLÜ KOLONLARIN, KAT KESME GÜVENLÝĐÝ (t)	
Sayfa 42	-KUBATILMIS KOLON KONTROLU	
Sayfa 43	-KOLONLARIN KESME DAYANIM KONTROLU	
Sayfa 44	-KOLONLARIN KESME GÜVENLÝK KONTROLU	
Sayfa 46	-TEMLERE GELEN KOLON YÜKLERÝ	
Sayfa 47	-TEMLERE KOLONLARDAN GELEN SÜNEK TASARIM DEPREM MOMENTLERÝ	
Sayfa 48	-TEMEL STATÝK HESAP SONUÇLARI	
Sayfa 49	-T5 TEKİL TEMELİ S105	
Sayfa 50	-TEMEL BETONARME HESAP SONUÇLARI	

## ÖZET

Bu yapının analizinde STA4CAD programından yararlanılmıştır. Yapıda oluşan zati ağırlıkları (kolon, döşeme) program tarafından hesaplatılmıştır. Döşemenin analizi SAFE programıyla daha da ayrıntılı incelenmiştir. Diğer yükler (hareketli, döşeme yükü, duvar yükleri, deprem kuvveti) ise TS500 ve deprem bölgelerinde yapılacak binalar hakkında yönetmelik 2018 ile ilgili esaslar dikkate alınarak hesaplanmıştır. Sistem ölü, hareketli, deprem, ve rüzgar yük kombinasyonları oluşturularak yüklenmiş ve statik analizi elde edilmiştir. Maksimum olan kesme, moment ve normal kuvvet diyagramları belirlenmiştir. Sistem olarak yapı gerilme kontrolü yapılmıştır. Kolonda kuşatılmış kolon, güçlü kolon, kesme güvenliği, zımbalama, burkulma kontrolü yapılmıştır. Fiktif kirişlerde kesme güvenliği, sehim ve çatlak kontrolü yapılmıştır. Döşemelerde de sehim kontrolü yapılmıştır. Temelde ise zemin gerilmesi ve kazık kapasitesi kontrolüne bakılmıştır.

## SİSTEMİN TANITILMASI

Konya Açık Hava Müzesi projesi X yönünde 3, Y yönünde 2 akstan oluşmaktadır. X yönündeki açıklık 12 m Y yönündeki 22 m'dir. 2 katlı betonarme çerçeve taşıyıcı sisteme sahip binanın (müzenin) statik ve dinamik analizi yapılmıştır. Mevcut beton dayanımı C35 (karakteristik silindirik basınç dayanımı 350 kg/cm<sup>2</sup>). Donatı sınıfı S420 (çelik akma gerilmesi) dir. Deprem tasarım sınıfı DTS=4a'dır. standart tasarım deprem yer hareketi DD-2 (Spektral büyüklüklerin 50 yılda aşılma olasılığının %10 ve buna karşı gelen tekrarlanma periyodunun 475 yıl olduğu seyrek deprem yer hareketi) dir. Spektral ivme katsayısı  $S_{ds}/S_{d1} = 0,329/0,092$ 'dir. Bina yükseklik sınıfı BYS= 8'dir. Bina kullanım sınıfı BKS=1' dir. Zemin sınıfı ZC'dir. Zemin yatak sayısı  $K_0(t/m^2)$  1000'dir. Zemin taşıma yük azaltma katsayısı  $q_t (t/m^2)$  21 olarak analiz edilmiştir. Taşıyıcı sistem davranış katsayısı  $R_x/R_y$  3,36'dır. Dayanım fazlalığı katsayısı  $D = 2,5$  'tir. Deprem yapı önem katsayısı  $I=1,5$ 'tur. 'dir Hareketli yük katsayısı  $n=0,3$ 'tür. Hareketli yük azaltma katsayısı  $C_z=1$ 'dir. Deprem yükü eksantirisitesi 0,05'tir. Modal analiz minimum yük oranı 0,9 : (düzensiz yapı)'dır. Kolon çapı 70 cm, döşeme tipi kirişsiz döşeme kalınlığı ise 45cm olarak belirlenmiş. Duvar tipi bims ve cam olarak tasarlanmıştır. Temel tipi projenin olduğu konumun tarihi dokusu göz önünde bulundurularak açıklığın ve sistem yükünün fazla olması da hesaba katılarak tekil temellerin altına 20 m derinliğinde fore kazıklar yapılması düşünülmüştür.

PROJE :

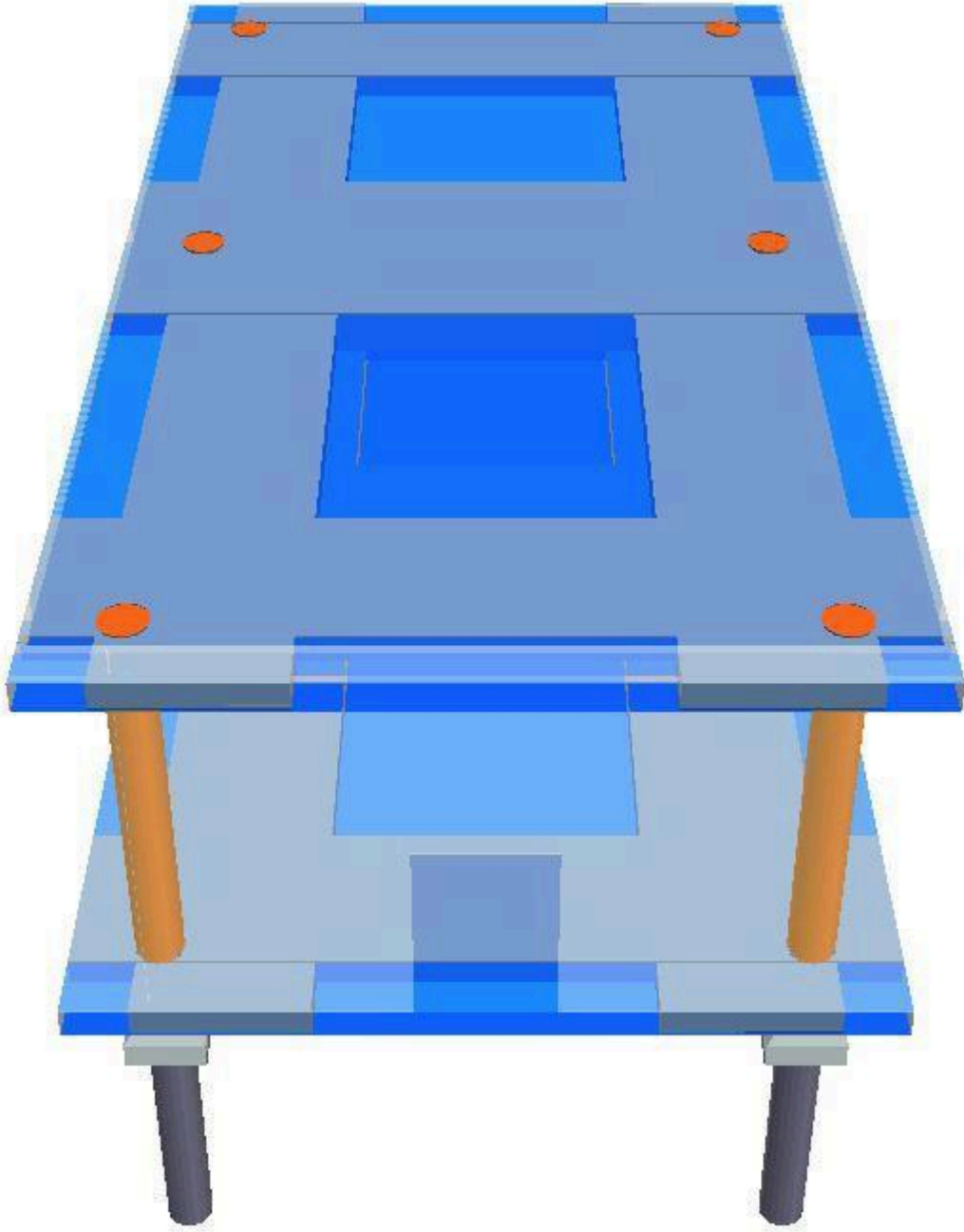

# TEMEL APLIKASYON PLANI

S102

T2



S104

T4



S106

T6



S101

T1



S103

T3



S105

T5



:

1. NORMAL KAT KALIP APLIKASYON PLANI

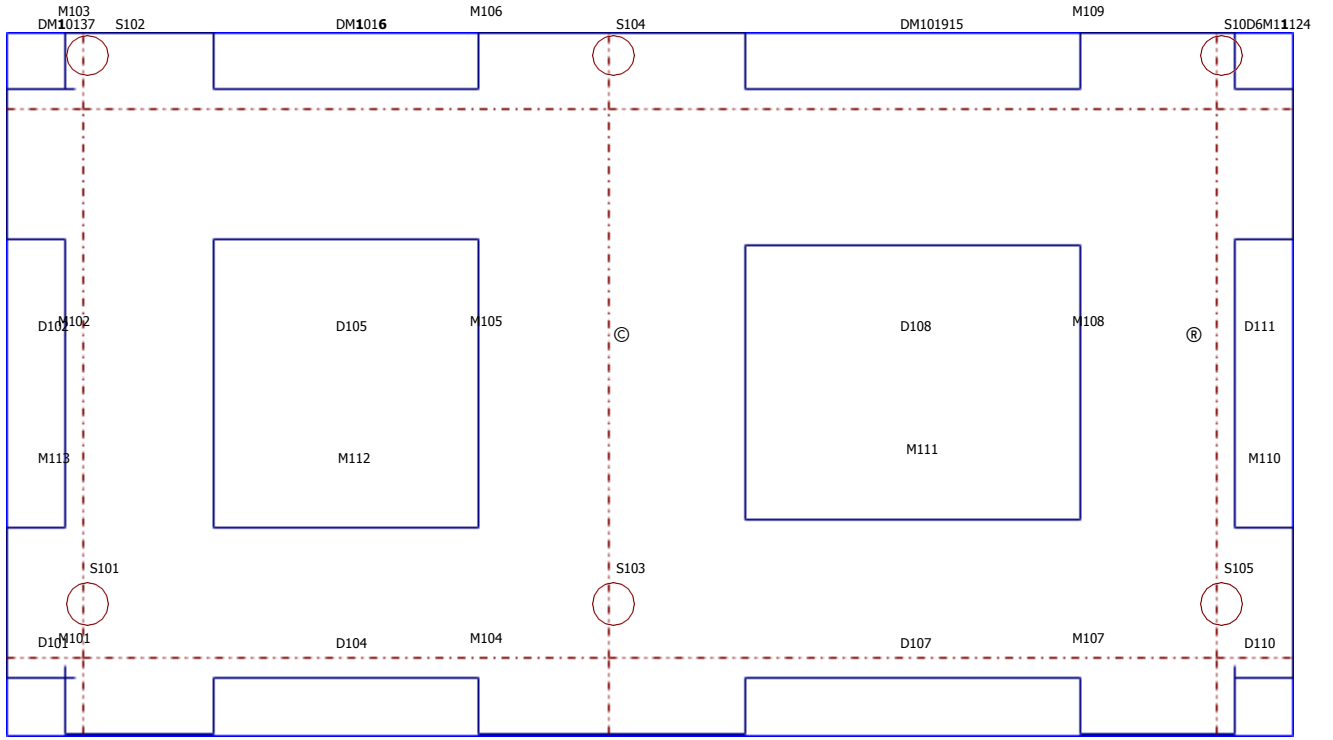

:  
PROJE :

## 2. NORMAL KAT KALIP APLIKASYON PLANI

M203  
DM20137 S202



DM2016

M206

S204



DM202915

M209

S20D6M221124



M202  
D202

D205

M205

©

®

D208

M208

D211

M213

M212

M211

M210

S201  
M201  
D201



D204

M204

S203



D207

M207

S205



D210

:  
PROJE :

26-10-2022 SAYFA: 6  
(KONYA AÇIK HAVA MÜZESİ.ST4)

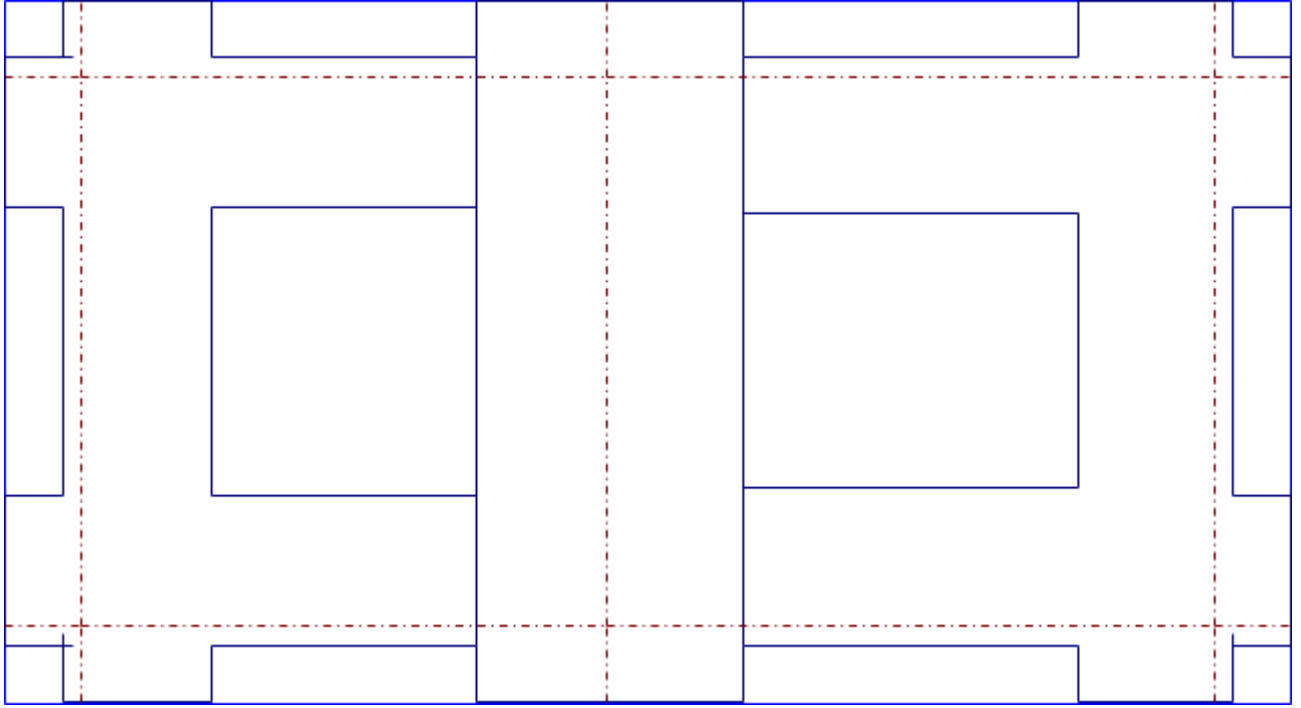

**DÖPEME YÜK ANALİZİ**

ÜAA¿  
;KAPLAMA  
i  
;Kaplama harcý 2.200 t/m<sup>3</sup> × 0.020 m : 0.044 i  
;Tepsiye betonu 2.000 t/m<sup>3</sup> × 0.030 m : 0.060 i  
;Sýva 2.200 t/m<sup>3</sup> × 0.020 m : 0.044 i  
;TOPLAM.....: 0.148 i  
AA---'  
(Döpeme zatileri, döpeme yük hesabýnda ilave edilecek)



## STA4-CAD PROGRAMI

ÇOK KATLI BETONARME YAPILARIN STATİK ve BETONARME ANALİZ PROGRAMI Ver.14.1 Rev. (21.4.2022)

PROJE İSMİ..... :  
 KAT ADEDİ..... : 2  
 Bir kattaki KOLON SAYISI..... : 6  
 X yönü aks sayısý..... : 4  
 Y yönü aks sayısý..... : 6  
 DEPREM YER HAREKETÝ DÜZEYÝ..... : DD2 50 yýlda apýlma olasýlýđý  
 %10 ZEMÝN SINIFI..... : ZC  
 BÝNA KOORDÝNATI..... (ENLEM/BOYLAM) : 37.87115° / 32.49194°  
 YEREL SPECTRAL ÝVME KATSAYISI..... Ss/Sý : 0.253 / 0.061  
 YAPI DAVRANIŞ KATSAYISI R : 3.36  
 SÝSTEM DAYANIM FAZLALIĐI KATSAYISI..... D : 2,5  
 SPEKTRUM KAREKTERÝSTÝK PERYODU..... (Ta/Tb) : 0.056 / 0.280  
 HAREKETLÝ YÜK KATSAYISI..... (n) : 0.3  
 SIFIR RÖLATÝF HAREKET YÜKSEKLÝĐÝ..... (m) : 0.00  
 HAREKETLÝ YÜK AZALTMA KATSAYISI..... (Cz) : 1.0  
 ZEMÝN TAĐIMA GÜCÜ TASARIM GERÝLMESÝ. (t/m²) : 21.0  
 ZEMÝN YATAK KATSAYISI..... (t/m³) : 1000.0  
 BETON YODUNLUĐU..... (t/m³) : 2.5  
 GENLEME ISI FARKI..... (°C) : 0.0  
 STATİK ANALİZ YÖNTEMÝ..... : FEA3D LINEER ANALİZ / Birim Mesh Genisliđi 1m  
 DEPREM STANDARDI..... : TBDY2018 CODE  
 BETONARME HESAP YÖNTEMÝ..... : TAĐIMA GÜCÜ YÖNTEMÝ TS500-2000  
 BETONARME KESÝT DONATI HESAP YÖNTEMÝ..... : BRÜT KESÝTE GÖRE  
 DEPREM HESABI YÖNTEMÝ..... : MOD SÜPERPOZÝSYONU ÝLE DÝNAMÝK ANALİZ  
 TEMEL ANALİZ OPSÝYONU..... : TEMELLER DÝKKATE ALINMADAN, YAPI ANALİZÝ  
 Zemin gerilmesi hareketli yük azaltma deđeri : 1.00  
 Kolonun oturduđu kirip tesir çarpaný..... : Düşey deprem analizi yapılmýptýr.  
 Kirip & Kolon rijitlik bölgesi opsiyonu..... : Yarı Sonsuz Rijit davranýp  
 Kirip uçlarınday elastik ankastrelilik opsiyonu : Elastik ankastre

STA ID: 434135942

## ÇATLAMIS KESÝT ETKÝN KESÝT RÝJÝTLÝĐÝ BÝLGÝLERÝ

Elementler	Eđilme	Eksenel	Lokal X kesme	Lokal Y kesme
Perde	0.25	0.50	0.50	1.00
Bodrum perdesi	0.50	0.80	0.50	1.00
Döbeme	0.25	0.25	0.25	1.00
Çerçeve kiripi	0.35	1.00	1.00	1.00
Çerçeve kolonu	0.70	1.00	1.00	1.00
Bađ kiripi	0.15	1.00	1.00	1.00
Perde çubuk	0.50	1.00	0.50	0.50

## BETON ve ÇELÝK MALZEME BÝLGÝLERÝ (kg/cm²)

Yapý Elemanı	Malzeme	Elastisite Modülü	Beton dayaným	Çelik akma gerilmesi	Birim Ađýrlýk			
		E	G	(Genel)	(Etriye)	t/m³		
Plak/Nervür	E1	C35	332000	132800	350	4200	4200	2.50
HNP		C35	332000	132800	350	5000	5000	2.50
Temel		C35	332000	132800	350	4200	4200	2.50
Kirip\Kolon	E1	C35	332000	132800	350	4200	4200	2.50

HNP : Hazýr Nervürlü Plak

TAĐIMA GÜCÜ MALZEME KATSAYILARI	BETON	ÇELÝK
	1.50	1.15
TAĐIMA GÜCÜ YÜK KATSAYILARI	SABÝT YÜK	HAREKETLÝ YÜK
	1.40	1.60

PROJE :

(KONYA AÇIK HAVA MÜZESİ.ST4)

**BETONARME HESAP YÜK KOMBİNASYONU**

Ölü yük	Hareketli yük	Zemin	Deprem	Rüzgar	Isı
Cg	yük Cq	Cs	± Ce	± Cw	Ct
1.40	1.60	0.00	0.00	0.00	0.00
1.40	1.60	1.60	0.00	0.00	0.00
1.00	1.20	0.00	0.00	0.00	1.20
1.00	1.00	0.00	1.00	0.00	0.00
1.00	1.00	1.00	1.00	0.00	0.00
0.90	0.00	0.00	1.00	0.00	0.00
1.00	1.30	0.00	0.00	1.30	0.00
1.00	1.30	1.00	0.00	1.30	0.00
0.90	0.00	0.00	0.00	1.30	0.00
0.90	0.00	0.90	0.00	1.30	0.00

TBDY2018 Düşey Deprem Kombinasyonu : G + Q + 0.2 S + Edh + 0.3 Edz, 0.9 G + H + Edh - 0.3 Edz  
CODE:TS500T.COD

**ZEMİN GERİLMESİ YÜK KOMBİNASYONU  $q_0 < q_t$** 

ZEMİN GERİLMESİ OPSİYONU:ZEMİN TAÇIMA GÜCÜ TASARIM GERİLMESİ

Ölü yük	Hareketli yük	Zemin	Deprem	Rüzgar	Isı
Cg	yük Cq	Cs	± Ce	± Cw	Ct
1.40	1.60	0.00	0.00	0.00	0.00
1.40	1.60	1.60	0.00	0.00	0.00
1.00	1.20	0.00	0.00	0.00	1.20
1.00	1.00	0.00	1.00	0.00	0.00
1.00	1.00	1.00	1.00	0.00	0.00
0.90	0.00	0.00	1.00	0.00	0.00
1.00	1.30	0.00	0.00	1.30	0.00
1.00	1.30	1.00	0.00	1.30	0.00
0.90	0.00	0.00	0.00	1.30	0.00
0.90	0.00	0.90	0.00	1.30	0.00

**ZEMİN GERİLMESİ HAREKETLİ YÜK AZALTMA DEĞERLERİ**

Kat	1	2	3	4	5	6	7	8	9	10
Eksiltme %			20	40	60	80	80	90	40	

**RÜZGAR YÜKÜ VE KATSAYILARI**

RÜZGAR YÜKÜ BASINÇ KATSAYISI : 0.8

Yükseklik bölgesi	H	Qw
1. bölge	8.00	0.05
2. bölge	20.00	0.08
3. bölge	100.00	0.11

**YAPI AKS BİLGİLERİ**

X yönü aks bilgileri				Y yönü aks bilgileri			
no	isim	Ax	Bx	no	isim	Ay	By
1	1	0.00	0.00	1	A	0.00	0.00
2	2	0.00	9.40	2	B	0.00	9.00
3	3	0.00	10.70	3	C	0.00	19.40
4	4	0.00	-1.30	4	4	0.00	20.70
				5	5	0.00	-1.30
				6	6	0.00	10.50

**1. KAT KOLONLARI AKS BİLGİLERİ**

Kolon no;X aksı;Y aksı; dx ; dy ;alt yük.;				Kolon no;X aksı;Y aksı; dx ; dy ;alt yük.;			
101	1X	1Y	0.0;	102	2X	1Y	0.0;
103	1X	2Y	0.0;	104	2X	2Y	0.0;
105	1X	3Y	0.0;	106	2X	3Y	0.0;
			0.0;				-2.52 ;
			-2.78 ;				-2.78 ;
			1.95 ;				1.95





:  
PROJE :

26-10-2022 SAYFA: 12  
(KONYA AÇIK HAVA MÜZESİ.ST4)

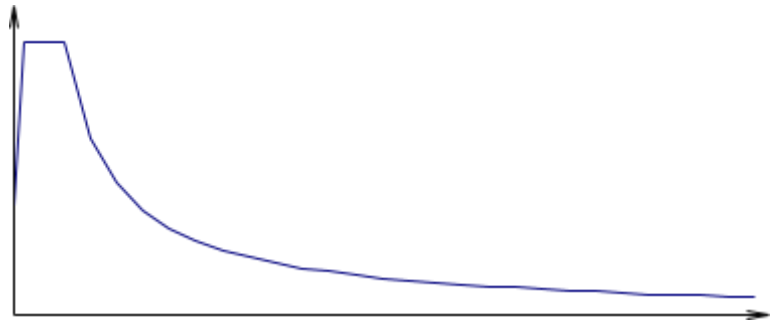
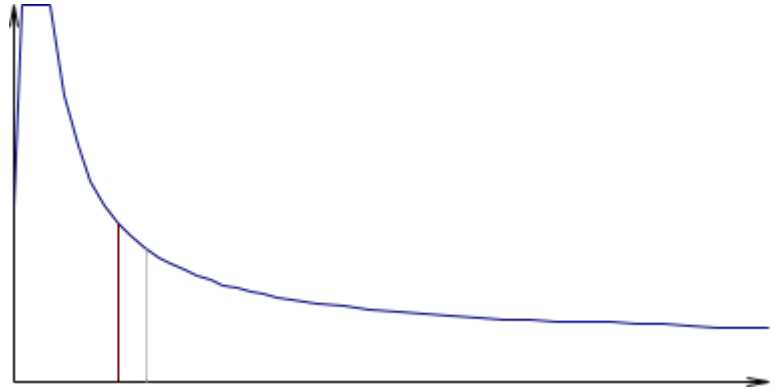

ÜAAA;  
 Myr% i 0.000 i 52.912 i 0.004 i 0.000 i 45.320 i 0.021 i ä= 98.26  
 AAAU  
 Mr = ä (mi·âxir<sup>2</sup>+mi·âyir<sup>2</sup>+mêi·âéir<sup>2</sup>)  
 Mxr=â [(â·m·â)<sup>2</sup>/Mr]= %98.88 > %95.00 Dinamik kütle oraný  
 yeterli. Myr=â [(â·m·â)<sup>2</sup>/Mr]= %98.26 > %95.00 Dinamik kütle oraný  
 yeterli.

EĐEĐER DEPREM HESABI 1. DOĐAL TÝTREĐÝM PERYODUNUN KONTROLU

Hn=8.9m Ctx=0.07 Cty=0.07  
 Tlx=Ctx · Hn<sup>3/4</sup> = 0.361 s., Tx= 0.784 s. > 1.4 x 0.361 s. >> Tx1=0.505 s.  
 Tly=Cty · Hn<sup>3/4</sup> = 0.361 s., Ty= 0.645 s. > 1.4 x 0.361 s. >> Ty1=0.505 s.

KAT KÜTLESÝ ve RÝJÝTLÝK MERKEZÝ (t)

ÜAA;  
 i Kat i H i Wg i Wq i ni R i D i ä Wk i  
 i (dyf) i (m) i i i i Rx/Ry i Dx/Dy i  
 i  
 AA  
 i 2 i 8.90 i 339.35 i 52.80 i 0.30 i 3.36 i 2.5 i 355.188 i  
 i 1 i 3.00 i 427.33 i 132.00 i 0.30 i 3.36 i 2.5 i  
 466.928 i  
 AA  
 Ü äwt = 822.116

EĐEĐER DEPREM FORMÜLÜ Fdi= (Vt-Ft)  $\frac{Wi \cdot Hi}{\sum Wi \cdot Hi}$

DEPREM KUVVETÝ (t)

Deprem tepe yükü Ftx= 0.67 Fty= 0.67 (t)  
 ÜAAAAAAAAAAAAAAAAAAAAAAAAA x YÖNÜ AAAAAAAAAAAAAAAAAAAAAAAAAA Y YÖNÜ AAAAAAAAAAAAAAAAAA;  
 ÜAA  
 i Kat i Modal i Epdeöer i Deprem i Kat i Modal i Epdeöer i Deprem i Kat i  
 i no i Analiz i dep.yön. i yükü i tipi i Analiz i dep.yön. i yükü i tipi i  
 AA  
 A  
 i 2 i 15.972 i 31.095 i 18.213 i UST KAT i 17.070 i 31.095 i 17.070 i UST KAT i  
 i 1 i 19.210 i 13.482 i 21.906 i NORMAL i 29.205 i 13.482 i 29.205 i NORMAL i  
 AA  
 i ä i 35.182 i 44.577 i 40.120 i GENEL i 46.275 i 44.577 i 46.275 i GENEL i  
 AAÜ  
 Fea3d analizde ek dýpmerkezlik etkisi; ömi=mixe<sup>2</sup> kütle artýmý ile düzenlenmiptir.  
 Vtx= 35.18 > 0.04 · I.Sds · W = 10.82 TBDY2018 4.7.1.1  
 Vty= 46.28 > 0.04 · I.Sds · W = 10.82  
 X Deprem kontrol: 0.90 x 44.577 = 40.120 > 35.182 >>> 40.120  
 Y Deprem kontrol: 0.90 x 44.577 = 40.120 < 46.275 >>> 46.275

YAPI DEPREM YÜKLERÝ (t)

Yapý peryodlarý Tx=0.784 Ty=0.645 R=3.36  
 X yönü W=822.12 Fdeprem=44.58 tepe yükü Fd=0.67 Y  
 yönü W=822.12 Fdeprem=44.58 tepe yükü Fd=0.67  
 ÜAA;  
 i Kat (DyF) i F modal X i F epdeöer X i F deprem X i F modal Y i F epdeöer Y i F deprem Y i  
 AA  
 i 2 ( 2 ) i 15.97 i 31.09 i 18.21 i 17.07 i 31.09 i 17.07 i  
 i 1 ( 1 ) i 19.21 i 13.48 i 21.91 i 29.20 i 13.48 i 29.20 i  
 AA  
 i ä i 35.18 i 44.58 i 40.12 i 46.28 i 44.58 i 46.28 i  
 AAÜ  
 X Deprem kontrol: 0.90 x 44.577 = 40.120 > 35.182 >>> 40.120  
 Y Deprem kontrol: 0.90 x 44.577 = 40.120 < 46.275 >>> 46.275

Rüzgar kuvvetleri (t)

ÜAA;  
 i Kat i X-yönü F i X-yönü ey i Y-yönü F i Y-yönü ex i  
 i (dyf) i i m i i m i  
 i  
 AA  
 i 2 i 12.461 i 4.700 i 6.797 i 9.700 i  
 i 1 i 3.960 i 4.700 i 2.160 i 9.700 i  
 i  
 AA  
 Ü

Yapýda Deprem Perdeleri bulunamadý.  
 Sds<0.5 >> Perdelerde, M/Mo<1/3 kontrolu yapýlmaz.

Deprem perde taban devrilme oraný Mdev/Mo= 0.00

Bina Tabýýýcý Sistem seçimi : Süneklilik düzeyi sýnýrlý tabýýýcý sistem  
 Hn= 8.9m >> BYS=8

Sds<0.5 Kenar aks perdeleri kontrolu yapýlmaz.

Boşluklu perde bulunmamýptýr

:  
PROJE :

26-10-2022 SAYFA: 13  
(KONYA AÇIK HAVA MÜZESİ.ST4)



MODAL ANALİZ MOD GRAFİĞİ (1000 x Dep. vektörü)

15.8 -3.1

X yönü

3.2

11.6

1. MOD

2. MOD

16.4

-1.4

Y yönü

1.2

14.4

1. MOD

2. MOD

PROJE :

(KONYA AÇIK HAVA MÜZESİ.ST4)

## KÝRÝP DÜPEY YÜK BÝLGÝLERÝ

Kirip	A1	A2	G1	G2	Q1	Q2	Yük elemanı
no	m	m	t/m	t/m	t/m	t/m	no
M101	0.00	1.06	5.06	5.06	2.25	2.25	D104
M101	0.00	1.06	5.69	1.70	0.00	0.00	D104 Duvar
M101	0.00	1.06	1.46	1.46	0.65	0.65	D101
M101	0.00	1.06	3.16	1.27	0.00	0.00	D101 Duvar
M102	0.24	8.91	1.46	1.46	0.65	0.65	D102
M102	0.24	8.91	1.17	1.11	0.00	0.00	D102 Duvar
M102	0.24	8.91	5.06	5.06	2.25	2.25	D105
M103	0.24	1.06	5.06	5.06	2.25	2.25	D106
M103	0.24	1.06	1.77	5.87	0.00	0.00	D106 Duvar
M103	0.24	1.06	1.46	1.46	0.65	0.65	D103
M103	0.24	1.06	1.05	2.73	0.00	0.00	D103 Duvar
M104	0.00	0.95	5.06	5.06	2.25	2.25	D104
M104	0.00	0.95	5.69	1.70	0.00	0.00	D104 Duvar
M104	0.00	0.95	5.85	5.85	2.60	2.60	D107
M104	0.00	0.95	3.38	1.19	0.00	0.00	D107 Duvar
M105	0.35	8.71	5.06	5.06	2.25	2.25	D105
M105	0.35	8.71	5.85	5.85	2.60	2.60	D108
M105	0.35	8.71	0.65	0.62	0.00	0.00	D108 Duvar
M106	0.35	0.95	5.06	5.06	2.25	2.25	D106
M106	0.35	0.95	1.77	5.87	0.00	0.00	D106 Duvar
M106	0.35	0.95	5.85	5.85	2.60	2.60	D109
M106	0.35	0.95	0.26	0.26	0.00	0.00	D109 Duvar
M106	0.35	0.95	0.84	2.90	0.00	0.00	D109 Duvar
M107	0.00	1.10	5.85	5.85	2.60	2.60	D107
M107	0.00	1.10	1.56	0.57	0.00	0.00	D107 Duvar
M107	0.00	1.10	1.46	1.46	0.65	0.65	D110
M107	0.00	1.10	1.29	0.45	0.00	0.00	D110 Duvar
M108	0.20	9.01	5.85	5.85	2.60	2.60	D108
M108	0.20	9.01	0.04	0.04	0.00	0.00	D108 Duvar
M108	0.20	9.01	1.46	1.46	0.65	0.65	D111
M108	0.20	9.01	0.38	0.36	0.00	0.00	D111 Duvar
M109	0.20	1.10	5.85	5.85	2.60	2.60	D109
M109	0.20	1.10	0.58	1.58	0.00	0.00	D109 Duvar
M109	0.20	1.10	1.46	1.46	0.65	0.65	D112
M109	0.20	1.10	0.37	1.11	0.00	0.00	D112 Duvar
M110	0.24	1.06	5.29	5.29	2.35	2.35	D111
M110	0.24	1.06	0.77	2.55	0.00	0.00	D111 Duvar
M110	0.24	1.06	1.46	1.46	0.65	0.65	D110
M110	0.24	1.06	0.39	1.01	0.00	0.00	D110 Duvar
M111	0.20	10.01	1.46	1.46	0.65	0.65	D107
M111	0.20	1.30	0.31	0.38	0.00	0.00	D107 Duvar
M111	1.50	8.70	0.38	0.02	0.00	0.00	D107 Duvar
M111	0.20	0.60	0.30	0.10	0.00	0.00	D107 Duvar
M111	0.80	9.40	0.10	0.01	0.00	0.00	D107 Duvar
M111	0.20	5.80	0.28	0.51	0.00	0.00	D107 Duvar
M111	6.00	4.20	0.51	0.61	0.00	0.00	D107 Duvar
M111	0.20	10.01	5.29	5.29	2.35	2.35	D108
M111	0.20	1.30	0.90	1.12	0.00	0.00	D108 Duvar
M111	1.50	8.70	1.12	0.12	0.00	0.00	D108 Duvar
M112	0.24	8.51	1.46	1.46	0.65	0.65	D104
M112	0.24	8.51	1.01	1.01	0.00	0.00	D104 Duvar
M112	0.24	8.51	5.29	5.29	2.35	2.35	D105
M113	0.00	1.06	5.29	5.29	2.35	2.35	D102
M113	0.00	1.06	6.39	1.91	0.00	0.00	D102 Duvar
M113	0.00	1.06	1.46	1.46	0.65	0.65	D101
M113	0.00	1.06	3.16	1.27	0.00	0.00	D101 Duvar
M114	0.25	1.05	5.29	5.29	2.35	2.35	D111
M114	0.25	1.05	0.43	1.18	0.00	0.00	D111 Duvar
M114	0.25	1.05	1.46	1.46	0.65	0.65	D112
M114	0.25	1.05	0.37	1.11	0.00	0.00	D112 Duvar
M115	0.22	9.97	5.29	5.29	2.35	2.35	D108
M115	0.22	1.28	0.77	0.66	0.00	0.00	D108 Duvar
M115	1.50	8.68	0.66	0.10	0.00	0.00	D108 Duvar
M115	0.22	9.97	1.46	1.46	0.65	0.65	D109
M115	0.22	1.28	0.24	0.41	0.00	0.00	D109 Duvar
M115	1.50	8.68	0.41	0.02	0.00	0.00	D109 Duvar
M115	0.22	9.97	0.05	0.05	0.00	0.00	D109 Duvar
M115	0.22	5.68	0.27	0.48	0.00	0.00	D109 Duvar
M115	5.90	4.28	0.48	0.58	0.00	0.00	D109 Duvar
M116	0.25	8.50	1.46	1.46	0.65	0.65	D106
M116	0.25	8.50	0.85	0.85	0.00	0.00	D106 Duvar
M116	0.25	8.50	5.29	5.29	2.35	2.35	D105
M117	0.00	1.05	5.29	5.29	2.35	2.35	D102
M117	0.00	1.05	3.44	1.24	0.00	0.00	D102 Duvar
M117	0.00	1.05	1.46	1.46	0.65	0.65	D103
M117	0.00	1.05	3.48	1.22	0.00	0.00	D103 Duvar
M201	0.00	1.06	5.06	5.06	0.90	0.90	D204
M201	0.00	1.06	0.58	0.17	0.00	0.00	D204 Duvar
M201	0.00	1.06	1.46	1.46	0.26	0.26	D201
M201	0.00	1.06	0.32	0.13	0.00	0.00	D201 Duvar
M202	0.24	8.91	1.46	1.46	0.26	0.26	D202
M202	0.24	8.91	0.12	0.11	0.00	0.00	D202 Duvar
M202	0.24	8.91	5.06	5.06	0.90	0.90	D205

:  
PROJE :

26-10-2022 SAYFA: 16  
(KONYA AÇIK HAVA MÜZESİ.ST4)

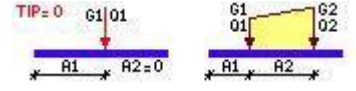

KÝRÝP DÜBEY YÜK BÝLGÝLERÝ

Kirip no	A1 m	A2 m	G1 t/m	G2 t/m	Q1 t/m	Q2 t/m	Yük elemani no
M203	0.24	1.06	5.06	5.06	0.90	0.90	D206
M203	0.24	1.06	0.18	0.60	0.00	0.00	D206 Duvar
M203	0.24	1.06	1.46	1.46	0.26	0.26	D203
M203	0.24	1.06	0.11	0.28	0.00	0.00	D203 Duvar
M204	0.00	0.95	5.06	5.06	0.90	0.90	D204
M204	0.00	0.95	0.58	0.17	0.00	0.00	D204 Duvar
M204	0.00	0.95	5.85	5.85	1.04	1.04	D207
M204	0.00	0.95	0.67	0.20	0.00	0.00	D207 Duvar
M205	0.35	8.71	5.06	5.06	0.90	0.90	D205
M205	0.35	8.71	5.85	5.85	1.04	1.04	D208
M206	0.35	0.95	5.06	5.06	0.90	0.90	D206
M206	0.35	0.95	0.18	0.60	0.00	0.00	D206 Duvar
M206	0.35	0.95	5.85	5.85	1.04	1.04	D209
M206	0.35	0.95	0.22	0.73	0.00	0.00	D209 Duvar
M207	0.00	1.10	5.85	5.85	1.04	1.04	D207
M207	0.00	1.10	0.36	0.13	0.00	0.00	D207 Duvar
M207	0.00	1.10	1.46	1.46	0.26	0.26	D210
M207	0.00	1.10	0.35	0.12	0.00	0.00	D210 Duvar
M208	0.20	9.01	5.85	5.85	1.04	1.04	D208
M208	0.20	9.01	1.46	1.46	0.26	0.26	D211
M208	0.20	9.01	0.10	0.10	0.00	0.00	D211 Duvar
M209	0.20	1.10	5.85	5.85	1.04	1.04	D209
M209	0.20	1.10	0.12	0.34	0.00	0.00	D209 Duvar
M209	0.20	1.10	1.46	1.46	0.26	0.26	D212
M209	0.20	1.10	0.10	0.31	0.00	0.00	D212 Duvar
M210	0.24	1.06	5.29	5.29	0.94	0.94	D211
M210	0.24	1.06	0.21	0.71	0.00	0.00	D211 Duvar
M210	0.24	1.06	1.46	1.46	0.26	0.26	D210
M210	0.24	1.06	0.11	0.28	0.00	0.00	D210 Duvar
M211	0.20	10.01	1.46	1.46	0.26	0.26	D207
M211	0.20	10.01	0.12	0.12	0.00	0.00	D207 Duvar
M211	0.20	10.01	5.29	5.29	0.94	0.94	D208
M212	0.24	8.51	1.46	1.46	0.26	0.26	D204
M212	0.24	8.51	0.10	0.10	0.00	0.00	D204 Duvar
M212	0.24	8.51	5.29	5.29	0.94	0.94	D205
M213	0.00	1.06	5.29	5.29	0.94	0.94	D202
M213	0.00	1.06	0.65	0.19	0.00	0.00	D202 Duvar
M213	0.00	1.06	1.46	1.46	0.26	0.26	D201
M213	0.00	1.06	0.32	0.13	0.00	0.00	D201 Duvar
M214	0.25	1.05	5.29	5.29	0.94	0.94	D211
M214	0.25	1.05	0.12	0.33	0.00	0.00	D211 Duvar
M214	0.25	1.05	1.46	1.46	0.26	0.26	D212
M214	0.25	1.05	0.10	0.31	0.00	0.00	D212 Duvar
M215	0.22	9.97	5.29	5.29	0.94	0.94	D208
M215	0.22	9.97	1.46	1.46	0.26	0.26	D209
M215	0.22	9.97	0.11	0.11	0.00	0.00	D209 Duvar
M216	0.25	8.50	1.46	1.46	0.26	0.26	D206
M216	0.25	8.50	0.09	0.09	0.00	0.00	D206 Duvar
M216	0.25	8.50	5.29	5.29	0.94	0.94	D205
M217	0.00	1.05	5.29	5.29	0.94	0.94	D202
M217	0.00	1.05	0.35	0.13	0.00	0.00	D202 Duvar
M217	0.00	1.05	1.46	1.46	0.26	0.26	D203
M217	0.00	1.05	0.35	0.12	0.00	0.00	D203 Duvar

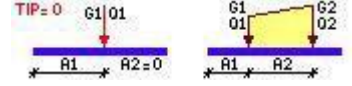

KOLON YÜK BİLGİLERİ

Kolon no	Kombinasyon	Px t	Py t	Pz t	Mx tm	My tm	Eleman no
S101	Olu yuk	0.00	0.00	1.85	0.00	-0.32	D105
S101	Hareketli yuk	0.00	0.00	0.82	0.00	-0.14	D105
S101	Olu yuk	0.00	0.00	0.51	0.00	-0.09	D104
S101	Hareketli yuk	0.00	0.00	0.23	0.00	-0.04	D104
S101	Olu yuk	0.00	0.00	0.35	0.00	-0.06	D104 Duvar
S101	Olu yuk	0.00	0.00	0.41	-0.07	0.00	D102 Duvar
S101	Olu yuk	0.00	0.00	0.51	-0.09	0.00	D102
S101	Hareketli yuk	0.00	0.00	0.23	-0.04	0.00	D102
S101	Olu yuk	0.00	0.00	1.77	0.31	0.00	D104
S101	Hareketli yuk	0.00	0.00	0.79	0.14	0.00	D104
S101	Olu yuk	0.00	0.00	0.51	0.09	0.00	D101
S101	Hareketli yuk	0.00	0.00	0.23	0.04	0.00	D101
S101	Olu yuk	0.00	0.00	0.34	0.06	0.00	D104 Duvar
S101	Olu yuk	0.00	0.00	0.32	0.06	0.00	D101 Duvar
S101	Olu yuk	0.00	0.00	1.77	-0.31	0.00	D105
S101	Hareketli yuk	0.00	0.00	0.79	-0.14	0.00	D105
S101	Olu yuk	0.00	0.00	0.32	0.00	0.06	D101 Duvar
S101	Olu yuk	0.00	0.00	0.38	0.00	0.07	D102 Duvar
S101	Olu yuk	0.00	0.00	0.51	0.00	0.09	D101
S101	Hareketli yuk	0.00	0.00	0.23	0.00	0.04	D101
S101	Olu yuk	0.00	0.00	1.85	0.00	0.32	D102
S101	Hareketli yuk	0.00	0.00	0.82	0.00	0.14	D102
S102	Olu yuk	0.00	0.00	1.85	0.00	-0.32	D105
S102	Hareketli yuk	0.00	0.00	0.82	0.00	-0.14	D105
S102	Olu yuk	0.00	0.00	0.51	0.00	-0.09	D106
S102	Hareketli yuk	0.00	0.00	0.23	0.00	-0.04	D106
S102	Olu yuk	0.00	0.00	0.30	0.00	-0.05	D106 Duvar
S102	Olu yuk	0.00	0.00	0.35	-0.06	0.00	D106 Duvar
S102	Olu yuk	0.00	0.00	0.51	-0.09	0.00	D103
S102	Hareketli yuk	0.00	0.00	0.23	-0.04	0.00	D103
S102	Olu yuk	0.00	0.00	0.26	-0.05	0.00	D103 Duvar
S102	Olu yuk	0.00	0.00	1.77	0.31	0.00	D105
S102	Hareketli yuk	0.00	0.00	0.79	0.14	0.00	D105
S102	Olu yuk	0.00	0.00	0.51	0.09	0.00	D102
S102	Hareketli yuk	0.00	0.00	0.23	0.04	0.00	D102
S102	Olu yuk	0.00	0.00	1.77	-0.31	0.00	D106
S102	Hareketli yuk	0.00	0.00	0.79	-0.14	0.00	D106
S102	Olu yuk	0.00	0.00	0.39	0.07	0.00	D102 Duvar
S102	Olu yuk	0.00	0.00	0.29	0.00	0.05	D102 Duvar
S102	Olu yuk	0.00	0.00	0.28	0.00	0.05	D103 Duvar
S102	Olu yuk	0.00	0.00	0.51	0.00	0.09	D103
S102	Hareketli yuk	0.00	0.00	0.23	0.00	0.04	D103
S102	Olu yuk	0.00	0.00	1.85	0.00	0.32	D102
S102	Hareketli yuk	0.00	0.00	0.82	0.00	0.14	D102
S103	Olu yuk	0.00	0.00	1.85	0.00	-0.32	D108
S103	Hareketli yuk	0.00	0.00	0.82	0.00	-0.14	D108
S103	Olu yuk	0.00	0.00	0.51	0.00	-0.09	D107
S103	Hareketli yuk	0.00	0.00	0.23	0.00	-0.04	D107
S103	Olu yuk	0.00	0.00	0.30	0.00	-0.05	D108 Duvar
S103	Olu yuk	0.00	0.00	0.10	0.00	-0.02	D107 Duvar
S103	Olu yuk	0.00	0.00	0.10	0.00	-0.02	D107 Duvar
S103	Olu yuk	0.00	0.00	0.13	0.00	-0.02	D107 Duvar
S103	Olu yuk	0.00	0.00	0.27	0.05	0.00	D107 Duvar
S103	Olu yuk	0.00	0.00	0.34	0.06	0.00	D104 Duvar
S103	Olu yuk	0.00	0.00	2.05	-0.36	0.00	D108
S103	Hareketli yuk	0.00	0.00	0.91	-0.16	0.00	D108
S103	Olu yuk	0.00	0.00	2.05	0.36	0.00	D107
S103	Hareketli yuk	0.00	0.00	0.91	0.16	0.00	D107
S103	Olu yuk	0.00	0.00	0.23	-0.04	0.00	D108 Duvar
S103	Olu yuk	0.00	0.00	1.77	-0.31	0.00	D105
S103	Hareketli yuk	0.00	0.00	0.79	-0.14	0.00	D105
S103	Olu yuk	0.00	0.00	1.77	0.31	0.00	D104
S103	Hareketli yuk	0.00	0.00	0.79	0.14	0.00	D104
S103	Olu yuk	0.00	0.00	0.35	0.00	0.06	D104 Duvar
S103	Olu yuk	0.00	0.00	0.51	0.00	0.09	D104
S103	Hareketli yuk	0.00	0.00	0.23	0.00	0.04	D104
S103	Olu yuk	0.00	0.00	1.85	0.00	0.32	D105
S103	Hareketli yuk	0.00	0.00	0.82	0.00	0.14	D105
S104	Olu yuk	0.00	0.00	1.85	0.00	-0.32	D108
S104	Hareketli yuk	0.00	0.00	0.82	0.00	-0.14	D108
S104	Olu yuk	0.00	0.00	0.51	0.00	-0.09	D109
S104	Hareketli yuk	0.00	0.00	0.23	0.00	-0.04	D109
S104	Olu yuk	0.00	0.00	0.27	0.00	-0.05	D108 Duvar
S104	Olu yuk	0.00	0.00	0.09	0.00	-0.02	D109 Duvar
S104	Olu yuk	0.00	0.00	0.07	0.00	-0.01	D109 Duvar
S104	Olu yuk	0.00	0.00	0.22	0.04	0.00	D108 Duvar
S104	Olu yuk	0.00	0.00	1.77	-0.31	0.00	D106
S104	Hareketli yuk	0.00	0.00	0.79	-0.14	0.00	D106
S104	Olu yuk	0.00	0.00	0.09	-0.02	0.00	D109 Duvar
S104	Olu yuk	0.00	0.00	2.05	-0.36	0.00	D109
S104	Hareketli yuk	0.00	0.00	0.91	-0.16	0.00	D109
S104	Olu yuk	0.00	0.00	1.77	0.31	0.00	D105
S104	Hareketli yuk	0.00	0.00	0.79	0.14	0.00	D105

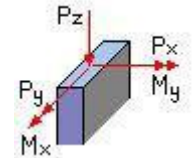

PROJE :

(KONYA AÇIK HAVA MÜZESİ.ST4)

## KOLON YÜK BİLGİLERİ

Kolon no	Kombinasyon	Px	Py	Pz	Mx	My	Eleman no
S104	Olu yuk	0.00	0.00	0.35	-0.06	0.00	D106 Duvar
S104	Olu yuk	0.00	0.00	2.05	0.36	0.00	D108 Duvar
S104	Hareketli yuk	0.00	0.00	0.91	0.16	0.00	D108 Duvar
S104	Olu yuk	0.00	0.00	0.02	0.00	0.00	D109 Duvar
S104	Olu yuk	0.00	0.00	0.16	-0.03	0.00	D109 Duvar
S104	Olu yuk	0.00	0.00	0.30	0.00	0.05	D106 Duvar
S104	Olu yuk	0.00	0.00	0.51	0.00	0.09	D106 Duvar
S104	Hareketli yuk	0.00	0.00	0.23	0.00	0.04	D106 Duvar
S104	Olu yuk	0.00	0.00	1.85	0.00	0.32	D105 Duvar
S104	Hareketli yuk	0.00	0.00	0.82	0.00	0.14	D105 Duvar
S105	Olu yuk	0.00	0.00	1.85	0.00	-0.32	D111 Duvar
S105	Hareketli yuk	0.00	0.00	0.82	0.00	-0.14	D111 Duvar
S105	Olu yuk	0.00	0.00	0.51	0.00	-0.09	D110 Duvar
S105	Hareketli yuk	0.00	0.00	0.23	0.00	-0.04	D110 Duvar
S105	Olu yuk	0.00	0.00	0.15	0.00	-0.03	D111 Duvar
S105	Olu yuk	0.00	0.00	0.10	0.00	-0.02	D110 Duvar
S105	Olu yuk	0.00	0.00	0.13	-0.02	0.00	D111 Duvar
S105	Olu yuk	0.00	0.00	0.51	-0.09	0.00	D111 Duvar
S105	Hareketli yuk	0.00	0.00	0.23	-0.04	0.00	D111 Duvar
S105	Olu yuk	0.00	0.00	2.05	-0.36	0.00	D108 Duvar
S105	Hareketli yuk	0.00	0.00	0.91	-0.16	0.00	D108 Duvar
S105	Olu yuk	0.00	0.00	0.51	0.09	0.00	D110 Duvar
S105	Hareketli yuk	0.00	0.00	0.23	0.04	0.00	D110 Duvar
S105	Olu yuk	0.00	0.00	0.10	0.02	0.00	D110 Duvar
S105	Olu yuk	0.00	0.00	2.05	0.36	0.00	D107 Duvar
S105	Hareketli yuk	0.00	0.00	0.91	0.16	0.00	D107 Duvar
S105	Olu yuk	0.00	0.00	0.02	0.00	0.00	D108 Duvar
S105	Olu yuk	0.00	0.00	0.13	0.02	0.00	D107 Duvar
S105	Olu yuk	0.00	0.00	0.03	0.00	0.01	D108 Duvar
S105	Olu yuk	0.00	0.00	0.21	0.00	0.04	D107 Duvar
S105	Olu yuk	0.00	0.00	0.51	0.00	0.09	D107 Duvar
S105	Hareketli yuk	0.00	0.00	0.23	0.00	0.04	D107 Duvar
S105	Olu yuk	0.00	0.00	1.85	0.00	0.32	D108 Duvar
S105	Hareketli yuk	0.00	0.00	0.82	0.00	0.14	D108 Duvar
S106	Olu yuk	0.00	0.00	1.85	0.00	-0.32	D111 Duvar
S106	Hareketli yuk	0.00	0.00	0.82	0.00	-0.14	D111 Duvar
S106	Olu yuk	0.00	0.00	0.51	0.00	-0.09	D112 Duvar
S106	Hareketli yuk	0.00	0.00	0.23	0.00	-0.04	D112 Duvar
S106	Olu yuk	0.00	0.00	0.10	0.00	-0.02	D111 Duvar
S106	Olu yuk	0.00	0.00	0.08	0.00	-0.01	D112 Duvar
S106	Olu yuk	0.00	0.00	2.05	-0.36	0.00	D109 Duvar
S106	Hareketli yuk	0.00	0.00	0.91	-0.16	0.00	D109 Duvar
S106	Olu yuk	0.00	0.00	0.02	0.00	0.00	D109 Duvar
S106	Olu yuk	0.00	0.00	0.51	0.09	0.00	D111 Duvar
S106	Hareketli yuk	0.00	0.00	0.23	0.04	0.00	D111 Duvar
S106	Olu yuk	0.00	0.00	0.51	-0.09	0.00	D112 Duvar
S106	Hareketli yuk	0.00	0.00	0.23	-0.04	0.00	D112 Duvar
S106	Olu yuk	0.00	0.00	0.08	-0.01	0.00	D112 Duvar
S106	Olu yuk	0.00	0.00	0.13	0.02	0.00	D111 Duvar
S106	Olu yuk	0.00	0.00	0.02	0.00	0.00	D108 Duvar
S106	Olu yuk	0.00	0.00	2.05	0.36	0.00	D108 Duvar
S106	Hareketli yuk	0.00	0.00	0.91	0.16	0.00	D108 Duvar
S106	Olu yuk	0.00	0.00	0.14	-0.02	0.00	D109 Duvar
S106	Olu yuk	0.00	0.00	0.03	0.00	0.01	D108 Duvar
S106	Olu yuk	0.00	0.00	0.21	0.00	0.04	D109 Duvar
S106	Olu yuk	0.00	0.00	0.51	0.00	0.09	D109 Duvar
S106	Hareketli yuk	0.00	0.00	0.23	0.00	0.04	D109 Duvar
S106	Olu yuk	0.00	0.00	1.85	0.00	0.32	D108 Duvar
S106	Hareketli yuk	0.00	0.00	0.82	0.00	0.14	D108 Duvar
S201	Olu yuk	0.00	0.00	1.85	0.00	-0.32	D205 Duvar
S201	Hareketli yuk	0.00	0.00	0.33	0.00	-0.06	D205 Duvar
S201	Olu yuk	0.00	0.00	0.51	0.00	-0.09	D204 Duvar
S201	Hareketli yuk	0.00	0.00	0.09	0.00	-0.02	D204 Duvar
S201	Olu yuk	0.00	0.00	0.04	0.00	-0.01	D204 Duvar
S201	Olu yuk	0.00	0.00	1.77	-0.31	0.00	D205 Duvar
S201	Hareketli yuk	0.00	0.00	0.31	-0.06	0.00	D205 Duvar
S201	Olu yuk	0.00	0.00	1.77	0.31	0.00	D204 Duvar
S201	Hareketli yuk	0.00	0.00	0.32	0.06	0.00	D204 Duvar
S201	Olu yuk	0.00	0.00	0.03	0.01	0.00	D204 Duvar
S201	Olu yuk	0.00	0.00	0.51	-0.09	0.00	D202 Duvar
S201	Hareketli yuk	0.00	0.00	0.09	-0.02	0.00	D202 Duvar
S201	Olu yuk	0.00	0.00	0.51	0.09	0.00	D201 Duvar
S201	Hareketli yuk	0.00	0.00	0.09	0.02	0.00	D201 Duvar
S201	Olu yuk	0.00	0.00	0.03	0.01	0.00	D201 Duvar
S201	Olu yuk	0.00	0.00	0.04	-0.01	0.00	D202 Duvar
S201	Olu yuk	0.00	0.00	0.04	0.00	0.01	D202 Duvar
S201	Olu yuk	0.00	0.00	0.03	0.00	0.01	D201 Duvar
S201	Olu yuk	0.00	0.00	0.51	0.00	0.09	D201 Duvar
S201	Hareketli yuk	0.00	0.00	0.09	0.00	0.02	D201 Duvar
S201	Olu yuk	0.00	0.00	1.85	0.00	0.32	D202 Duvar
S201	Hareketli yuk	0.00	0.00	0.33	0.00	0.06	D202 Duvar
S202	Olu yuk	0.00	0.00	1.85	0.00	-0.32	D205 Duvar
S202	Hareketli yuk	0.00	0.00	0.33	0.00	-0.06	D205 Duvar

:  
PROJE :

26-10-2022 SAYFA: 19  
(KONYA AÇIK HAVA MÜZESİ.ST4)

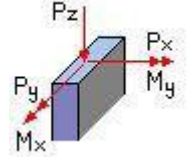

KOLON YÜK BİLGİLERİ

Kolon no	Kombinasyon	Px	Py	Pz	Mx	My	Eleman no
S202	Olu yuk	0.00	0.00	0.51	0.00	-0.09	D206
S202	Hareketli yuk	0.00	0.00	0.09	0.00	-0.02	D206
S202	Olu yuk	0.00	0.00	0.03	0.00	-0.01	D206 Duvar
S202	Olu yuk	0.00	0.00	0.04	0.01	0.00	D202 Duvar
S202	Olu yuk	0.00	0.00	0.04	-0.01	0.00	D206 Duvar
S202	Olu yuk	0.00	0.00	1.77	-0.31	0.00	D206
S202	Hareketli yuk	0.00	0.00	0.31	-0.06	0.00	D206
S202	Olu yuk	0.00	0.00	0.51	0.09	0.00	D202
S202	Hareketli yuk	0.00	0.00	0.09	0.02	0.00	D202
S202	Olu yuk	0.00	0.00	0.51	-0.09	0.00	D203
S202	Hareketli yuk	0.00	0.00	0.09	-0.02	0.00	D203
S202	Olu yuk	0.00	0.00	0.03	0.00	0.00	D203 Duvar
S202	Olu yuk	0.00	0.00	0.03	0.00	0.00	D203 Duvar
S202	Olu yuk	0.00	0.00	1.77	0.31	0.00	D205
S202	Hareketli yuk	0.00	0.00	0.31	0.06	0.00	D205
S202	Olu yuk	0.00	0.00	0.03	0.00	0.01	D202 Duvar
S202	Olu yuk	0.00	0.00	0.51	0.00	0.09	D203
S202	Hareketli yuk	0.00	0.00	0.09	0.00	0.02	D203
S202	Olu yuk	0.00	0.00	1.85	0.00	0.32	D202
S202	Hareketli yuk	0.00	0.00	0.33	0.00	0.06	D202
S203	Olu yuk	0.00	0.00	1.85	0.00	-0.32	D208
S203	Hareketli yuk	0.00	0.00	0.33	0.00	-0.06	D208
S203	Olu yuk	0.00	0.00	0.51	0.00	-0.09	D207
S203	Hareketli yuk	0.00	0.00	0.09	0.00	-0.02	D207
S203	Olu yuk	0.00	0.00	0.04	0.00	-0.01	D207 Duvar
S203	Olu yuk	0.00	0.00	1.77	-0.31	0.00	D205
S203	Hareketli yuk	0.00	0.00	0.31	-0.06	0.00	D205
S203	Olu yuk	0.00	0.00	0.04	0.01	0.00	D207 Duvar
S203	Olu yuk	0.00	0.00	2.05	0.36	0.00	D207
S203	Hareketli yuk	0.00	0.00	0.36	0.06	0.00	D207
S203	Olu yuk	0.00	0.00	0.03	0.01	0.00	D204 Duvar
S203	Olu yuk	0.00	0.00	1.77	0.31	0.00	D204
S203	Hareketli yuk	0.00	0.00	0.32	0.06	0.00	D204
S203	Olu yuk	0.00	0.00	2.05	-0.36	0.00	D208
S203	Hareketli yuk	0.00	0.00	0.36	-0.06	0.00	D208
S203	Olu yuk	0.00	0.00	0.04	0.00	0.01	D204 Duvar
S203	Olu yuk	0.00	0.00	0.51	0.00	0.09	D204
S203	Hareketli yuk	0.00	0.00	0.09	0.00	0.02	D204
S203	Olu yuk	0.00	0.00	1.85	0.00	0.32	D205
S203	Hareketli yuk	0.00	0.00	0.33	0.00	0.06	D205
S204	Olu yuk	0.00	0.00	1.85	0.00	-0.32	D208
S204	Hareketli yuk	0.00	0.00	0.33	0.00	-0.06	D208
S204	Olu yuk	0.00	0.00	0.51	0.00	-0.09	D209
S204	Hareketli yuk	0.00	0.00	0.09	0.00	-0.02	D209
S204	Olu yuk	0.00	0.00	0.04	0.00	-0.01	D209 Duvar
S204	Olu yuk	0.00	0.00	0.04	-0.01	0.00	D209 Duvar
S204	Olu yuk	0.00	0.00	0.04	-0.01	0.00	D206 Duvar
S204	Olu yuk	0.00	0.00	1.77	-0.31	0.00	D206
S204	Hareketli yuk	0.00	0.00	0.31	-0.06	0.00	D206
S204	Olu yuk	0.00	0.00	1.77	0.31	0.00	D205
S204	Hareketli yuk	0.00	0.00	0.31	0.06	0.00	D205
S204	Olu yuk	0.00	0.00	2.05	0.36	0.00	D208
S204	Hareketli yuk	0.00	0.00	0.36	0.06	0.00	D208
S204	Olu yuk	0.00	0.00	2.05	-0.36	0.00	D209
S204	Hareketli yuk	0.00	0.00	0.36	-0.06	0.00	D209
S204	Olu yuk	0.00	0.00	0.03	0.00	0.01	D206 Duvar
S204	Olu yuk	0.00	0.00	0.51	0.00	0.09	D206
S204	Hareketli yuk	0.00	0.00	0.09	0.00	0.02	D206
S204	Olu yuk	0.00	0.00	1.85	0.00	0.32	D205
S204	Hareketli yuk	0.00	0.00	0.33	0.00	0.06	D205
S205	Olu yuk	0.00	0.00	1.85	0.00	-0.32	D211
S205	Hareketli yuk	0.00	0.00	0.33	0.00	-0.06	D211
S205	Olu yuk	0.00	0.00	0.51	0.00	-0.09	D210
S205	Hareketli yuk	0.00	0.00	0.09	0.00	-0.02	D210
S205	Olu yuk	0.00	0.00	0.04	0.00	-0.01	D211 Duvar
S205	Olu yuk	0.00	0.00	0.03	0.01	0.00	D207 Duvar
S205	Olu yuk	0.00	0.00	2.05	-0.36	0.00	D208
S205	Hareketli yuk	0.00	0.00	0.36	-0.06	0.00	D208
S205	Olu yuk	0.00	0.00	0.51	0.09	0.00	D210
S205	Hareketli yuk	0.00	0.00	0.09	0.02	0.00	D210
S205	Olu yuk	0.00	0.00	0.51	-0.09	0.00	D211
S205	Hareketli yuk	0.00	0.00	0.09	-0.02	0.00	D211
S205	Olu yuk	0.00	0.00	0.03	0.00	0.00	D210 Duvar
S205	Olu yuk	0.00	0.00	0.03	0.00	0.00	D210 Duvar
S205	Olu yuk	0.00	0.00	0.04	-0.01	0.00	D211 Duvar
S205	Olu yuk	0.00	0.00	2.05	0.36	0.00	D207
S205	Hareketli yuk	0.00	0.00	0.36	0.06	0.00	D207
S205	Olu yuk	0.00	0.00	0.04	0.00	0.01	D207 Duvar
S205	Olu yuk	0.00	0.00	0.51	0.00	0.09	D207
S205	Hareketli yuk	0.00	0.00	0.09	0.00	0.02	D207
S205	Olu yuk	0.00	0.00	1.85	0.00	0.32	D208
S205	Hareketli yuk	0.00	0.00	0.33	0.00	0.06	D208
S206	Olu yuk	0.00	0.00	1.85	0.00	-0.32	D211

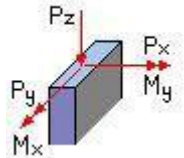

**KOLON YÜK BİLGİLERİ**

Kolon no	Kombinasyon	Px t	Py t	Pz t	Mx tm	My tm	Eleman no
S206	Hareketli yuk	0.00	0.00	0.33	0.00	-0.06	D211
S206	Olu yuk	0.00	0.00	0.51	0.00	-0.09	D212
S206	Hareketli yuk	0.00	0.00	0.09	0.00	-0.02	D212
S206	Olu yuk	0.00	0.00	0.03	0.00	-0.01	D211 Duvar
S206	Olu yuk	0.00	0.00	0.51	0.09	0.00	D211
S206	Hareketli yuk	0.00	0.00	0.09	0.02	0.00	D211
S206	Olu yuk	0.00	0.00	0.03	-0.01	0.00	D209 Duvar
S206	Olu yuk	0.00	0.00	2.05	0.36	0.00	D208
S206	Hareketli yuk	0.00	0.00	0.36	0.06	0.00	D208
S206	Olu yuk	0.00	0.00	0.51	-0.09	0.00	D212
S206	Hareketli yuk	0.00	0.00	0.09	-0.02	0.00	D212
S206	Olu yuk	0.00	0.00	0.02	0.00	0.00	D212 Duvar
S206	Olu yuk	0.00	0.00	2.05	-0.36	0.00	D209
S206	Hareketli yuk	0.00	0.00	0.36	-0.06	0.00	D209
S206	Olu yuk	0.00	0.00	0.02	0.00	0.00	D212 Duvar
S206	Olu yuk	0.00	0.00	0.03	0.01	0.00	D211 Duvar
S206	Olu yuk	0.00	0.00	0.04	0.00	0.01	D209 Duvar
S206	Olu yuk	0.00	0.00	0.51	0.00	0.09	D209
S206	Hareketli yuk	0.00	0.00	0.09	0.00	0.02	D209
S206	Olu yuk	0.00	0.00	1.85	0.00	0.32	D208
S206	Hareketli yuk	0.00	0.00	0.33	0.00	0.06	D208

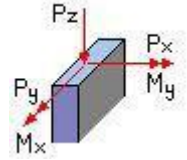

**DUVAR YÜK BİLGİLERİ**

Duvar kat	aks	sol	sağ	H	B	Duvar tipi	G (t/m)	L (m)	Yüklenen eleman
1	1	5y	4x	1x	550	30;Bims duvar	1.880	1.30	D101
2	1	5y	1x	2x	550	30;Bims duvar	1.880	9.40	D102
3	1	5y	2x	3x	550	30;Bims duvar	1.880	1.30	D103
4	1	6y	4x	1x	550	30;Bims duvar	1.880	1.30	D107
5	1	6y	1x	2x	550	30;Bims duvar	1.880	9.40	D108
6	1	6y	2x	3x	550	30;Bims duvar	1.880	1.30	D109
7	1	4y	4x	1x	550	5;Cam Bölme	0.690	1.30	D110
8	1	4y	1x	2x	550	5;Cam Bölme	0.690	9.40	D111
9	1	4y	2x	3x	550	5;Cam Bölme	0.690	1.30	D112
10	1	4x	5y	1y	550	30;Bims duvar	1.880	1.30	D101
11	1	4x	1y	2y	550	30;Bims duvar	1.880	9.00	D104
12	1	4x	2y	6y	550	30;Bims duvar	1.880	1.50	D107
13	1	4x	6y	3y	550	5;Cam Bölme	0.690	8.90	D107
14	1	4x	3y	4y	550	5;Cam Bölme	0.690	1.30	D110
15	1	3x	5y	1y	550	30;Bims duvar	1.880	1.30	D103
16	1	3x	1y	2y	550	30;Bims duvar	1.880	9.00	D106
17	1	3x	2y	6y	550	30;Bims duvar	1.880	1.50	D109
18	1	3x	6y	3y	550	5;Cam Bölme	0.690	8.90	D109
19	1	3x	3y	4y	550	5;Cam Bölme	0.690	1.30	D112
20	2	5y	4x	1x	50	15;BA parapet	0.190	1.30	D201
21	2	5y	1x	2x	50	15;BA parapet	0.190	9.40	D202
22	2	5y	2x	3x	50	15;BA parapet	0.190	1.30	D203
23	2	4y	4x	1x	50	15;BA parapet	0.190	1.30	D210
24	2	4y	1x	2x	50	15;BA parapet	0.190	9.40	D211
25	2	4y	2x	3x	50	15;BA parapet	0.190	1.30	D212
26	2	4x	5y	1y	50	15;BA parapet	0.190	1.30	D201
27	2	4x	1y	2y	50	15;BA parapet	0.190	9.00	D204
28	2	4x	2y	3y	50	15;BA parapet	0.190	10.40	D207
29	2	4x	3y	4y	50	15;BA parapet	0.190	1.30	D210
30	2	3x	5y	1y	50	15;BA parapet	0.190	1.30	D203
31	2	3x	1y	2y	50	15;BA parapet	0.190	9.00	D206
32	2	3x	2y	3y	50	15;BA parapet	0.190	10.40	D209
33	2	3x	3y	4y	50	15;BA parapet	0.190	1.30	D212



PROJE :

(KONYA AÇIK HAVA MÜZESİ.ST4)

## DÖBEME BİLGİLERİ

Döbeme;	Sol	Sag	Üst	Alt	yön	d,	dmin;	bo;	bt;	g	q	gx	gy	qx	qy	
;	no	Aks	Aks	Aks	Aks	;	cm	cm;	cm;	t/m <sup>2</sup>	t/m <sup>2</sup>	t/m <sup>2</sup>	t/m <sup>2</sup>	t/m <sup>2</sup>	t/m <sup>2</sup>	
AAA																
D101	4X	1X	5Y	1Y	PLAK	45E	8			1.125	0.500	0.563	0.563	0.250	0.250	
D102	1X	2X	5Y	1Y	PLAK	45E	8			1.125	0.500	0.000	1.125	0.000	0.500	
D103	2X	3X	5Y	1Y	PLAK	45E	8			1.125	0.500	0.562	0.563	0.250	0.250	
D104	4X	1X	1Y	2Y	PLAK	45E	8			1.125	0.500	1.125	0.000	0.500	0.000	
D105	1X	2X	1Y	2Y	PLAK	45E	10			1.125	0.500	0.660	0.465	0.294	0.206	
D106	2X	3X	1Y	2Y	PLAK	45E	8			1.125	0.500	1.125	0.000	0.500	0.000	
D107	4X	1X	2Y	3Y	PLAK	45E	8			1.125	0.500	1.125	0.000	0.500	0.000	
D108	1X	2X	2Y	3Y	PLAK	45E	11			1.125	0.500	0.826	0.299	0.367	0.133	
D109	2X	3X	2Y	3Y	PLAK	45E	8			1.125	0.500	1.125	0.000	0.500	0.000	
D110	4X	1X	3Y	4Y	PLAK	45E	8			1.125	0.500	0.563	0.562	0.250	0.250	
D111	1X	2X	3Y	4Y	PLAK	45E	8			1.125	0.500	0.000	1.125	0.000	0.500	
D112	2X	3X	3Y	4Y	PLAK	45E	8			1.125	0.500	0.563	0.562	0.250	0.250	
D201	4X	1X	5Y	1Y	PLAK	45E	8			1.125	0.200	0.563	0.563	0.100	0.100	
D202	1X	2X	5Y	1Y	PLAK	45E	8			1.125	0.200	0.000	1.125	0.000	0.200	
D203	2X	3X	5Y	1Y	PLAK	45E	8			1.125	0.200	0.562	0.563	0.100	0.100	
D204	4X	1X	1Y	2Y	PLAK	45E	8			1.125	0.200	1.125	0.000	0.200	0.000	
D205	1X	2X	1Y	2Y	PLAK	45E	10			1.125	0.200	0.660	0.465	0.117	0.083	
D206	2X	3X	1Y	2Y	PLAK	45E	8			1.125	0.200	1.125	0.000	0.200	0.000	
D207	4X	1X	2Y	3Y	PLAK	45E	8			1.125	0.200	1.125	0.000	0.200	0.000	
D208	1X	2X	2Y	3Y	PLAK	45E	11			1.125	0.200	0.826	0.299	0.147	0.053	
D209	2X	3X	2Y	3Y	PLAK	45E	8			1.125	0.200	1.125	0.000	0.200	0.000	
D210	4X	1X	3Y	4Y	PLAK	45E	8			1.125	0.200	0.563	0.562	0.100	0.100	
D211	1X	2X	3Y	4Y	PLAK	45E	8			1.125	0.200	0.000	1.125	0.000	0.200	
D212	2X	3X	3Y	4Y	PLAK	45E	8			1.125	0.200	0.563	0.562	0.100	0.100	
AAA																

AAA

Dmin: TS500 minimum yükseklik

PROJE :

(KONYA AÇIK HAVA MÜZESİ.ST4)

**MANTAR DÖŞEME STATİK HESAP SONUÇLARI**

(tm)

D= 45 cm kot: 0 cm g= 1.125 (t/m <sup>2</sup> )			q= 0.500 (t/m <sup>2</sup> )	fmax=0.5<3.6mm	ø
D101					
Sol Mx	0.00x0.00/=0.00	M101	0.00x0.82/0.98=0.00	Mx	0.000
Ac. Mx	0.00x0.00/=0.00		0.10x0.00/0.98=0.00		0.000
Sađ Mx	0.00x0.00/=0.00		0.06x29.32/0.98=1.83		1.829
Üst My					
Ac. My	0.00x0.00/0.98=0.00	M113	0.00x1.27/0.98=0.00	My	0.000
Alt My	0.00x0.00/0.98=0.00		0.10x0.00/0.98=0.00		0.000
			0.06x29.32/0.98=1.94		1.940
D102					
D= 45 cm kot: 0 cm g= 1.125 (t/m <sup>2</sup> )					
q= 0.500 (t/m <sup>2</sup> )					
fmax=0.2<3.6mm					
ø					
Sol Mx	0.00x0.00/=0.00	M102	0.06x29.32/0.98=1.83	Mx	1.829
Ac. Mx	0.00x0.00/=0.00		0.10x31.84/0.98=3.18		3.178
Sađ Mx	0.00x0.00/=0.00		0.06x29.02/0.98=1.81		1.811
Üst My					
Ac. My	0.00x1.27/3.74=0.00	M113	0.00x1.27/3.74=0.00	My	0.000
Alt My	0.30x0.00/3.74=0.00	M117	0.30x0.00/3.74=0.00		0.000
	0.19x29.32/3.74=1.46		0.19x29.32/3.74=1.46		2.910
D103					
D= 45 cm kot: 0 cm g= 1.125 (t/m <sup>2</sup> )					
q= 0.500 (t/m <sup>2</sup> )					
fmax=0.5<3.6mm					
ø					
Sol Mx	0.00x0.00/=0.00	M103	0.06x29.02/0.98=1.81	Mx	1.811
Ac. Mx	0.00x0.00/=0.00		0.10x0.00/0.98=0.00		0.000
Sađ Mx	0.00x0.00/=0.00		0.00x0.79/0.98=0.00		0.000
Üst My					
Ac. My	0.00x1.27/0.98=0.00	M117	0.00x0.00/0.98=0.00	My	0.000
Alt My	0.10x0.00/0.98=0.00		0.00x0.00/0.98=0.00		0.000
	0.06x29.32/0.98=1.94		0.00x0.00/0.98=0.00		1.940
D104					
D= 45 cm kot: 0 cm g= 1.125 (t/m <sup>2</sup> )					
q= 0.500 (t/m <sup>2</sup> )					
fmax=0.7<3.6mm					
ø					
Sol Mx	0.00x0.82/4.04=0.00	M101	0.00x2.43/4.04=0.00	Mx	0.000
Ac. Mx	0.30x0.00/4.04=0.00	M104	0.19x0.00/4.04=0.00		0.000
Sađ Mx	0.19x29.32/4.04=1.37		0.12x61.48/4.04=1.76		3.137
Üst My					
Ac. My	0.00x0.00/4.04=0.00	M112	0.06x29.32/0.98=1.94	My	1.940
Alt My	0.00x0.00/4.04=0.00		0.10x28.34/0.98=3.00		3.001
			0.06x67.60/0.98=4.47		4.473
D105					
D= 45 cm kot: 0 cm g= 1.125 (t/m <sup>2</sup> )					
q= 0.500 (t/m <sup>2</sup> )					
fmax=2.3<20.8mm					
ø					
Sol Mx	0.19x29.32/4.04=1.37	M102	0.12x61.48/4.04=1.76	Mx	3.137
Ac. Mx	0.30x31.84/4.04=2.38	M105	0.19x64.22/4.04=2.95		5.333
Sađ Mx	0.19x29.02/4.04=1.36		0.12x61.49/4.04=1.76		3.123
Üst My					
Ac. My	0.19x29.32/3.74=1.46	M112	0.19x29.32/3.74=1.46	My	2.910
Alt My	0.30x28.34/3.74=2.25		0.30x28.23/3.74=2.24		4.492
	0.19x67.60/3.74=3.35		0.19x67.81/3.74=3.37		6.720
D106					
D= 45 cm kot: 0 cm g= 1.125 (t/m <sup>2</sup> )					
q= 0.500 (t/m <sup>2</sup> )					
fmax=0.7<3.6mm					
ø					
Sol Mx	0.19x29.02/4.04=1.36	M103	0.12x61.49/4.04=1.76	Mx	3.123
Ac. Mx	0.30x0.00/4.04=0.00		0.19x0.00/4.04=0.00		0.000
Sađ Mx	0.00x0.79/4.04=0.00		0.00x2.43/4.04=0.00		0.000
Üst My					
Ac. My	0.06x29.32/0.98=1.94	M116	0.00x0.00/0.98=0.00	My	1.940
Alt My	0.10x28.23/0.98=2.99		0.00x0.00/0.98=0.00		2.988
	0.06x67.81/0.98=4.49		0.00x0.00/0.98=0.00		4.487

PROJE :

(KONYA AÇIK HAVA MÜZESİ.ST4)

MANTAR DÖŞEME STATİK HESAP SONUÇLARI (tm)

D107 D= 45 cm kot: 0 cm g= 1.125 (t/m <sup>2</sup> )			q= 0.500 (t/m <sup>2</sup> )	fmax=0.7<3.6mm	ø
M104	M107				Mx
Sol Mx;0.00x2.43/4.67=0.00	0.00x1.06/4.67=0.00				0.000
Ac. Mx;0.21x0.00/4.67=0.00	0.31x0.00/4.67=0.00				0.000
Sađ Mx;0.13x61.48/4.67=1.76	0.20x30.00/4.67=1.26				3.021
Üst My;0.00x0.00/4.67=0.00	M111				My
Ac. My;0.00x0.00/4.67=0.00	0.07x68.23/0.98=4.56				4.560
Alt My;0.00x0.00/4.67=0.00	0.10x39.87/0.98=4.26				4.263
	0.07x30.45/0.98=2.03				2.035
D108 D= 45 cm kot: 0 cm g= 1.125 (t/m <sup>2</sup> )			q= 0.500 (t/m <sup>2</sup> )	fmax=2.7<20.5mm	ø
M105	M108				Mx
Sol Mx;0.13x61.48/4.67=1.76	0.20x30.00/4.67=1.26				3.021
Ac. Mx;0.21x64.22/4.67=2.95	0.31x33.19/4.67=2.22				5.174
Sađ Mx;0.13x61.49/4.67=1.76	0.20x30.19/4.67=1.26				3.030
Üst My;0.18x68.23/3.69=3.42	M115				My
Ac. My;0.30x39.87/3.69=3.20	0.18x68.45/3.69=3.43				6.851
Alt My;0.18x30.45/3.69=1.53	0.30x40.44/3.69=3.24				6.441
	0.18x30.61/3.69=1.53				3.060
D109 D= 45 cm kot: 0 cm g= 1.125 (t/m <sup>2</sup> )			q= 0.500 (t/m <sup>2</sup> )	fmax=0.7<3.6mm	ø
M106	M109				Mx
Sol Mx;0.13x61.49/4.67=1.76	0.20x30.19/4.67=1.26				3.030
Ac. Mx;0.21x0.00/4.67=0.00	0.31x0.00/4.67=0.00				0.000
Sađ Mx;0.00x2.43/4.67=0.00	0.00x1.11/4.67=0.00				0.000
Üst My;0.07x68.45/0.98=4.57	M110				My
Ac. My;0.10x40.44/0.98=4.32	0.00x0.00/0.98=0.00				4.575
Alt My;0.07x30.61/0.98=2.05	0.00x0.00/0.98=0.00				4.324
	0.00x0.00/0.98=0.00				2.045
D110 D= 45 cm kot: 0 cm g= 1.125 (t/m <sup>2</sup> )			q= 0.500 (t/m <sup>2</sup> )	fmax=0.7<3.6mm	ø
M107					Mx
Sol Mx;0.00x1.06/0.98=0.00	0.00x0.00/0.98=0.00				0.000
Ac. Mx;0.09x0.00/0.98=0.00	0.00x0.00/0.98=0.00				0.000
Sađ Mx;0.05x30.00/0.98=1.68	0.00x0.00/0.98=0.00				1.676
Üst My;0.00x0.00/0.98=0.00	M110				My
Ac. My;0.00x0.00/0.98=0.00	0.06x30.16/0.98=2.00				1.995
Alt My;0.00x0.00/0.98=0.00	0.10x0.00/0.98=0.00				0.000
	0.00x1.02/0.98=0.00				0.000
D111 D= 45 cm kot: 0 cm g= 1.125 (t/m <sup>2</sup> )			q= 0.500 (t/m <sup>2</sup> )	fmax=0.9<3.6mm	ø
M108					Mx
Sol Mx;0.05x30.00/0.98=1.68	0.00x0.00/0.98=0.00				1.676
Ac. Mx;0.09x33.19/0.98=2.97	0.00x0.00/0.98=0.00				2.966
Sađ Mx;0.05x30.19/0.98=1.69	0.00x0.00/0.98=0.00				1.686
Üst My;0.19x30.16/3.74=1.50	M114				My
Ac. My;0.30x0.00/3.74=0.00	0.19x30.32/3.74=1.50				3.001
Alt My;0.00x1.02/3.74=0.00	0.30x0.00/3.74=0.00				0.000
	0.00x1.02/3.74=0.00				0.000
D112 D= 45 cm kot: 0 cm g= 1.125 (t/m <sup>2</sup> )			q= 0.500 (t/m <sup>2</sup> )	fmax=0.7<3.6mm	ø
M109					Mx
Sol Mx;0.05x30.19/0.98=1.69	0.00x0.00/0.98=0.00				1.686
Ac. Mx;0.09x0.00/0.98=0.00	0.00x0.00/0.98=0.00				0.000
Sađ Mx;0.00x1.11/0.98=0.00	0.00x0.00/0.98=0.00				0.000
Üst My;0.06x30.32/0.98=2.01	M114				My
Ac. My;0.10x0.00/0.98=0.00	0.00x0.00/0.98=0.00				2.006
Alt My;0.00x1.02/0.98=0.00	0.00x0.00/0.98=0.00				0.000
	0.00x0.00/0.98=0.00				0.000

PROJE :

(KONYA AÇIK HAVA MÜZESİ.ST4)

MANTAR DÖŞEME STATİK HESAP SONUÇLARI (tm)

D201 D= 45 cm kot: 0 cm g= 1.125 (t/m <sup>2</sup> )			q= 0.200 (t/m <sup>2</sup> )	fmax=0.6<3.6mm	δ
Sol Mx	0.00x0.00/=0.00	M201	0.00x0.32/0.98=0.00	Mx	0.000
Ac. Mx	0.00x0.00/=0.00		0.10x0.00/0.98=0.00		0.000
Sađ Mx	0.00x0.00/=0.00		0.06x15.80/0.98=0.99		0.986
Üst My	0.00x0.00/0.98=0.00	M213	0.00x0.64/0.98=0.00	My	0.000
Ac. My	0.00x0.00/0.98=0.00		0.10x0.00/0.98=0.00		0.000
Alt My	0.00x0.00/0.98=0.00		0.06x16.02/0.98=1.06		1.060
D202 D= 45 cm kot: 0 cm g= 1.125 (t/m <sup>2</sup> )			q= 0.200 (t/m <sup>2</sup> )	fmax=0.4<3.6mm	δ
Sol Mx	0.00x0.00/=0.00	M202	0.06x15.80/0.98=0.99	Mx	0.986
Ac. Mx	0.00x0.00/=0.00		0.10x25.76/0.98=2.57		2.572
Sađ Mx	0.00x0.00/=0.00		0.06x15.70/0.98=0.98		0.979
Üst My	0.00x0.64/3.74=0.00	M213	0.00x0.64/3.74=0.00	My	0.000
Ac. My	0.30x0.00/3.74=0.00		0.30x0.00/3.74=0.00		0.000
Alt My	0.19x16.02/3.74=0.80		0.19x16.05/3.74=0.80		1.591
D203 D= 45 cm kot: 0 cm g= 1.125 (t/m <sup>2</sup> )			q= 0.200 (t/m <sup>2</sup> )	fmax=0.6<3.6mm	δ
Sol Mx	0.00x0.00/=0.00	M203	0.06x15.70/0.98=0.98	Mx	0.979
Ac. Mx	0.00x0.00/=0.00		0.10x0.00/0.98=0.00		0.000
Sađ Mx	0.00x0.00/=0.00		0.00x0.32/0.98=0.00		0.000
Üst My	0.00x0.64/0.98=0.00	M217	0.00x0.00/0.98=0.00	My	0.000
Ac. My	0.10x0.00/0.98=0.00		0.00x0.00/0.98=0.00		0.000
Alt My	0.06x16.05/0.98=1.06		0.00x0.00/0.98=0.00		1.062
D204 D= 45 cm kot: 0 cm g= 1.125 (t/m <sup>2</sup> )			q= 0.200 (t/m <sup>2</sup> )	fmax=0.8<3.6mm	δ
Sol Mx	0.00x0.32/4.04=0.00	M201	0.00x1.62/4.04=0.00	Mx	0.000
Ac. Mx	0.30x0.00/4.04=0.00		0.19x0.00/4.04=0.00		0.000
Sađ Mx	0.19x15.80/4.04=0.74		0.12x39.12/4.04=1.12		1.862
Üst My	0.00x0.00/4.04=0.00	M212	0.06x16.02/0.98=1.06	My	1.060
Ac. My	0.00x0.00/4.04=0.00		0.10x19.43/0.98=2.06		2.058
Alt My	0.00x0.00/4.04=0.00		0.06x47.10/0.98=3.12		3.117
D205 D= 45 cm kot: 0 cm g= 1.125 (t/m <sup>2</sup> )			q= 0.200 (t/m <sup>2</sup> )	fmax=2.2<20.8mm	δ
Sol Mx	0.19x15.80/4.04=0.74	M202	0.12x39.12/4.04=1.12	Mx	1.862
Ac. Mx	0.30x25.76/4.04=1.93		0.19x52.68/4.04=2.42		4.348
Sađ Mx	0.19x15.70/4.04=0.73		0.12x39.13/4.04=1.12		1.858
Üst My	0.19x16.02/3.74=0.80	M216	0.19x16.05/3.74=0.80	My	1.591
Ac. My	0.30x19.43/3.74=1.54		0.30x19.36/3.74=1.54		3.080
Alt My	0.19x47.10/3.74=2.34		0.19x47.25/3.74=2.34		4.682
D206 D= 45 cm kot: 0 cm g= 1.125 (t/m <sup>2</sup> )			q= 0.200 (t/m <sup>2</sup> )	fmax=0.8<3.6mm	δ
Sol Mx	0.19x15.70/4.04=0.73	M203	0.12x39.13/4.04=1.12	Mx	1.858
Ac. Mx	0.30x0.00/4.04=0.00		0.19x0.00/4.04=0.00		0.000
Sađ Mx	0.00x0.32/4.04=0.00		0.00x1.61/4.04=0.00		0.000
Üst My	0.06x16.05/0.98=1.06	M216	0.00x0.00/0.98=0.00	My	1.062
Ac. My	0.10x19.36/0.98=2.05		0.00x0.00/0.98=0.00		2.049
Alt My	0.06x47.25/0.98=3.13		0.00x0.00/0.98=0.00		3.126

PROJE :

(KONYA AÇIK HAVA MÜZESİ.ST4)

MANTAR DÖŞEME STATİK HESAP SONUÇLARI (tm)

D= 45 cm kot: 0 cm g= 1.125 (t/m <sup>2</sup> )			q= 0.200 (t/m <sup>2</sup> )	fmax=0.7<3.6mm	δ
D207					
M204	M207	Mx			
Sol Mx	0.00x1.62/4.67=0.00	0.00x0.64/4.67=0.00	0.00		
Ac. Mx	0.21x0.00/4.67=0.00	0.31x0.00/4.67=0.00	0.00		
Sađ Mx	0.13x39.12/4.67=1.12	0.20x18.96/4.67=0.79	1.917		
Üst My	0.00x0.00/4.67=0.00	0.07x47.52/0.98=3.18	3.176		
Ac. My	0.00x0.00/4.67=0.00	0.10x31.11/0.98=3.33	3.327		
Alt My	0.00x0.00/4.67=0.00	0.07x19.31/0.98=1.29	1.291		
D208					
D= 45 cm kot: 0 cm g= 1.125 (t/m <sup>2</sup> )			q= 0.200 (t/m <sup>2</sup> )	fmax=2.3<20.5mm	δ
D208					
M205	M208	Mx			
Sol Mx	0.13x39.12/4.67=1.12	0.20x18.96/4.67=0.79	1.917		
Ac. Mx	0.21x52.68/4.67=2.42	0.31x28.77/4.67=1.93	4.347		
Sađ Mx	0.13x39.13/4.67=1.12	0.20x18.96/4.67=0.79	1.917		
Üst My	0.18x47.52/3.69=2.38	0.18x47.67/3.69=2.39	4.772		
Ac. My	0.30x31.11/3.69=2.50	0.30x31.74/3.69=2.55	5.040		
Alt My	0.18x19.31/3.69=0.97	0.18x19.36/3.69=0.97	1.938		
D209					
D= 45 cm kot: 0 cm g= 1.125 (t/m <sup>2</sup> )			q= 0.200 (t/m <sup>2</sup> )	fmax=0.7<3.6mm	δ
D209					
M206	M209	Mx			
Sol Mx	0.13x39.13/4.67=1.12	0.20x18.96/4.67=0.79	1.917		
Ac. Mx	0.21x0.00/4.67=0.00	0.31x0.00/4.67=0.00	0.000		
Sađ Mx	0.00x1.61/4.67=0.00	0.00x0.65/4.67=0.00	0.000		
Üst My	0.07x47.67/0.98=3.19	0.00x0.00/0.98=0.00	3.186		
Ac. My	0.10x31.74/0.98=3.39	0.00x0.00/0.98=0.00	3.394		
Alt My	0.07x19.36/0.98=1.29	0.00x0.00/0.98=0.00	1.294		
D210					
D= 45 cm kot: 0 cm g= 1.125 (t/m <sup>2</sup> )			q= 0.200 (t/m <sup>2</sup> )	fmax=0.7<3.6mm	δ
D210					
M207	Mx				
Sol Mx	0.00x0.64/0.98=0.00	0.00x0.00/0.98=0.00	0.000		
Ac. Mx	0.09x0.00/0.98=0.00	0.00x0.00/0.98=0.00	0.000		
Sađ Mx	0.05x18.96/0.98=1.06	0.00x0.00/0.98=0.00	1.059		
Üst My	0.00x0.00/0.98=0.00	0.06x19.21/0.98=1.27	1.271		
Ac. My	0.00x0.00/0.98=0.00	0.10x0.00/0.98=0.00	0.000		
Alt My	0.00x0.00/0.98=0.00	0.00x0.66/0.98=0.00	0.000		
D211					
D= 45 cm kot: 0 cm g= 1.125 (t/m <sup>2</sup> )			q= 0.200 (t/m <sup>2</sup> )	fmax=0.8<3.6mm	δ
D211					
M208	Mx				
Sol Mx	0.05x18.96/0.98=1.06	0.00x0.00/0.98=0.00	1.059		
Ac. Mx	0.09x28.77/0.98=2.57	0.00x0.00/0.98=0.00	2.571		
Sađ Mx	0.05x18.96/0.98=1.06	0.00x0.00/0.98=0.00	1.059		
Üst My	0.19x19.21/3.74=0.95	0.19x19.25/3.74=0.96	1.909		
Ac. My	0.30x0.00/3.74=0.00	0.30x0.00/3.74=0.00	0.000		
Alt My	0.00x0.66/3.74=0.00	0.00x0.66/3.74=0.00	0.000		
D212					
D= 45 cm kot: 0 cm g= 1.125 (t/m <sup>2</sup> )			q= 0.200 (t/m <sup>2</sup> )	fmax=0.7<3.6mm	δ
D212					
M209	Mx				
Sol Mx	0.05x18.96/0.98=1.06	0.00x0.00/0.98=0.00	1.059		
Ac. Mx	0.09x0.00/0.98=0.00	0.00x0.00/0.98=0.00	0.000		
Sađ Mx	0.00x0.65/0.98=0.00	0.00x0.00/0.98=0.00	0.000		
Üst My	0.06x19.25/0.98=1.27	0.00x0.00/0.98=0.00	1.274		
Ac. My	0.10x0.00/0.98=0.00	0.00x0.00/0.98=0.00	0.000		
Alt My	0.00x0.66/0.98=0.00	0.00x0.00/0.98=0.00	0.000		

PROJE :

(KONYA AÇIK HAVA MÜZESİ.ST4)

## DÖPEME BETONARME HESAP SONUÇLARI

Döpeme	Msol	As	Maç	As	Msađ	As	Donatı
ı no	ı (tm)	ı cm <sup>2</sup>	ı (tm)	ı cm <sup>2</sup>	ı (tm)	ı cm <sup>2</sup>	ı
ıD101	Xı	0.00ı	0.00ı	1.19ı	1.04ı	12.40ı	10.97ı ø6/20 (düz)
ıd=45cm	Yı	0.00ı	0.00ı	0.18ı	0.16ı	8.55ı	7.52ı ø6/20 (düz)
ıD102	Xı	12.40ı	10.97ı	18.10ı	13.47ı	12.40ı	10.97ı ø14/11 (düz)+ø18/23 (sol ıla)+ø18/23 (sađ ıla)
ıd=45cm	Yı	0.06ı	0.05ı	0.89ı	0.77ı	11.58ı	10.23ı ø6/20 (düz)+ø12/20 (Mon.)
ıD103	Xı	12.40ı	10.97ı	1.21ı	1.05ı	0.00ı	0.00ı ø6/20 (düz)
ıd=45cm	Yı	0.00ı	0.00ı	0.16ı	0.14ı	8.55ı	7.52ı ø6/20 (düz)
ıD104	Xı	0.13ı	0.12ı	1.38ı	1.20ı	12.30ı	10.88ı ø6/20 (düz)+ø12/20 (Mon.)
ıd=45cm	Yı	8.55ı	7.52ı	14.66ı	13.02ı	27.16ı	18.95ı ø14/11 (düz)+ø14/20 (sol ıla)+ø22/20 (sađ ıla)
ıD105	Xı	1.59ı	1.39ı	17.90ı	12.30ı	1.60ı	1.39ı ø14/25 (düz)+ø14/25 (pil)
ıd=45cm	Yı	1.03ı	0.90ı	13.28ı	9.05ı	6.80ı	5.96ı ø12/24 (düz)+ø12/24 (pil)
ıD106	Xı	12.30ı	10.89ı	1.49ı	1.29ı	0.13ı	0.12ı ø6/20 (düz)+ø12/20 (Mon.)
ıd=45cm	Yı	8.55ı	7.52ı	14.23ı	12.63ı	27.17ı	18.95ı ø14/12 (düz)+ø14/20 (sol ıla)+ø22/20 (sađ ıla)
ıD107	Xı	0.34ı	0.29ı	3.10ı	2.70ı	13.88ı	12.31ı ø10/20 (düz)+ø14/20 (Mon.)
ıd=45cm	Yı	27.16ı	18.95ı	18.74ı	13.47ı	8.63ı	7.59ı ø14/11 (düz)+ø14/20 (sađ ıla)
ıD108	Xı	0.63ı	0.55ı	17.90ı	12.30ı	0.63ı	0.55ı ø14/25 (düz)+ø14/25 (pil)
ıd=45cm	Yı	6.80ı	5.96ı	17.62ı	12.10ı	0.75ı	0.65ı ø14/25 (düz)+ø14/25 (pil)
ıD109	Xı	13.88ı	12.31ı	2.90ı	2.53ı	0.34ı	0.29ı ø10/20 (düz)+ø14/20 (Mon.)
ıd=45cm	Yı	27.17ı	18.95ı	18.83ı	13.47ı	8.63ı	7.59ı ø14/11 (düz)+ø14/20 (sađ ıla)
ıD110	Xı	0.00ı	0.00ı	3.10ı	2.70ı	6.34ı	5.56ı ø10/20 (düz)
ıd=45cm	Yı	8.63ı	7.59ı	4.04ı	3.53ı	0.00ı	0.00ı ø10/20 (düz)
ıD111	Xı	6.34ı	5.56ı	16.10ı	13.47ı	6.34ı	5.56ı ø14/11 (düz)+ø12/20 (sol ıla)+ø12/20 (sađ ıla)
ıd=45cm	Yı	12.64ı	11.19ı	4.04ı	3.53ı	0.19ı	0.17ı ø10/20 (düz)+ø12/20 (Mon.)
ıD112	Xı	6.34ı	5.56ı	2.90ı	2.53ı	0.00ı	0.00ı ø10/20 (düz)
ıd=45cm	Yı	8.63ı	7.59ı	3.74ı	3.27ı	0.00ı	0.00ı ø10/20 (düz)
ıD201	Xı	0.00ı	0.00ı	2.33ı	2.03ı	5.89ı	5.16ı ø10/20 (düz)
ıd=45cm	Yı	0.00ı	0.00ı	0.99ı	0.86ı	3.12ı	2.72ı ø6/20 (düz)
ıD202	Xı	5.89ı	5.16ı	13.13ı	11.63ı	5.89ı	5.16ı ø14/13 (düz)+ø12/21 (sol ıla)+ø12/21 (sađ ıla)
ıd=45cm	Yı	0.08ı	0.07ı	1.71ı	1.49ı	6.40ı	5.61ı ø10/20 (düz)+ø12/20 (Mon.)
ıD203	Xı	5.89ı	5.16ı	2.34ı	2.04ı	0.00ı	0.00ı ø10/20 (düz)
ıd=45cm	Yı	0.00ı	0.00ı	1.04ı	0.91ı	3.11ı	2.72ı ø6/20 (düz)
ıD204	Xı	0.17ı	0.15ı	2.35ı	2.05ı	7.54ı	6.62ı ø10/20 (düz)+ø12/20 (Mon.)
ıd=45cm	Yı	3.12ı	2.72ı	9.96ı	8.78ı	17.91ı	13.47ı ø12/12 (düz)+ø10/28 (sol ıla)+ø20/23 (sađ ıla)
ıD205	Xı	0.00ı	0.00ı	14.49ı	9.90ı	0.00ı	0.00ı ø12/22 (düz)+ø12/22 (pil)
ıd=45cm	Yı	0.00ı	0.00ı	9.61ı	8.20ı	4.71ı	4.12ı ø12/27 (düz)+ø12/27 (pil)
ıD206	Xı	7.54ı	6.62ı	2.35ı	2.05ı	0.17ı	0.15ı ø10/20 (düz)+ø12/20 (Mon.)
ıd=45cm	Yı	3.11ı	2.72ı	9.88ı	8.71ı	17.92ı	13.47ı ø12/12 (düz)+ø10/28 (sol ıla)+ø20/23 (sađ ıla)
ıD207	Xı	0.27ı	0.23ı	2.35ı	2.05ı	8.94ı	7.87ı ø10/20 (düz)+ø12/20 (Mon.)
ıd=45cm	Yı	17.91ı	13.47ı	14.47ı	12.84ı	5.77ı	5.06ı ø14/11 (düz)+ø12/22 (sađ ıla)
ıD208	Xı	0.00ı	0.00ı	14.49ı	9.90ı	0.00ı	0.00ı ø12/22 (düz)+ø12/22 (pil)
ıd=45cm	Yı	4.71ı	4.12ı	13.66ı	9.32ı	0.00ı	0.00ı ø12/24 (düz)+ø12/24 (pil)
ıD209	Xı	8.94ı	7.87ı	2.35ı	2.05ı	0.27ı	0.23ı ø10/20 (düz)+ø12/20 (Mon.)
ıd=45cm	Yı	17.92ı	13.47ı	14.66ı	13.02ı	5.77ı	5.05ı ø14/11 (düz)+ø12/22 (sađ ıla)
ıD210	Xı	0.00ı	0.00ı	1.90ı	1.65ı	4.73ı	4.14ı ø10/20 (düz)
ıd=45cm	Yı	5.77ı	5.06ı	2.30ı	2.00ı	0.00ı	0.00ı ø10/20 (düz)
ıD211	Xı	4.73ı	4.14ı	13.89ı	12.33ı	4.73ı	4.14ı ø14/12 (düz)+ø12/27 (sol ıla)+ø12/27 (sađ ıla)
ıd=45cm	Yı	7.71ı	6.77ı	2.30ı	2.00ı	0.10ı	0.09ı ø10/20 (düz)+ø12/20 (Mon.)



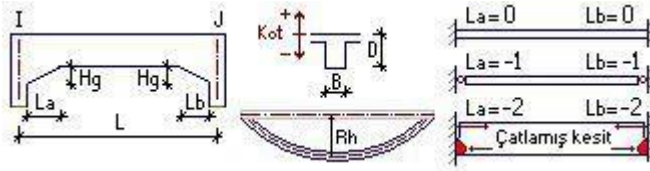

**KYRYP VE PANEL BYLGYLERV**

no	1 aks	2 aks	3 aks	cm	cm	(t/m)	Nokta	L	Rh	Tabla	sol	sağ	Mal
M101	1Y	4X	1X	40	257	0.000	0-1	1.30	0.00		0/0	0/0	E1
M102	1Y	1X	2X	40	257	0.000	1-3	9.40	0.00		0/0	0/0	E1
M103	1Y	2X	3X	40	257	0.000	3-0	1.30	0.00		0/0	0/0	E1
M104	2Y	4X	1X	40	460	0.000	0-4	1.30	0.00		0/0	0/0	E1
M105	2Y	1X	2X	40	460	0.000	4-7	9.40	0.00		0/0	0/0	E1
M106	2Y	2X	3X	40	460	0.000	7-0	1.30	0.00		0/0	0/0	E1
M107	3Y	4X	1X	40	267	0.000	0-8	1.30	0.00		0/0	0/0	E1
M108	3Y	1X	2X	40	267	0.000	8-11	9.40	0.00		0/0	0/0	E1
M109	3Y	2X	3X	40	267	0.000	11-0	1.30	0.00		0/0	0/0	E1
M113	1X	5Y	1Y	40	257	0.000	0-1	1.30	0.00		0/0	0/0	E1
M112	1X	1Y	2Y	40	257	0.000	1-4	9.00	0.00		0/0	0/0	E1
M111	1X	2Y	3Y	40	267	0.000	4-8	10.40	0.00		0/0	0/0	E1
M110	1X	3Y	4Y	40	257	0.000	8-0	1.30	0.00		0/0	0/0	E1
M117	2X	5Y	1Y	40	258	0.000	0-3	1.30	0.00		0/0	0/0	E1
M116	2X	1Y	2Y	40	258	0.000	3-7	9.00	0.00		0/0	0/0	E1
M115	2X	2Y	3Y	40	268	0.000	7-11	10.40	0.00		0/0	0/0	E1
M114	2X	3Y	4Y	40	258	0.000	11-0	1.30	0.00		0/0	0/0	E1
M201	1Y	4X	1X	40	257	0.000	0-2	1.30	0.00		0/0	0/0	E1
M202	1Y	1X	2X	40	257	0.000	2-5	9.40	0.00		0/0	0/0	E1
M203	1Y	2X	3X	40	257	0.000	5-0	1.30	0.00		0/0	0/0	E1
M204	2Y	4X	1X	40	460	0.000	0-6	1.30	0.00		0/0	0/0	E1
M205	2Y	1X	2X	40	460	0.000	6-9	9.40	0.00		0/0	0/0	E1
M206	2Y	2X	3X	40	460	0.000	9-0	1.30	0.00		0/0	0/0	E1
M207	3Y	4X	1X	40	267	0.000	0-10	1.30	0.00		0/0	0/0	E1
M208	3Y	1X	2X	40	267	0.000	10-12	9.40	0.00		0/0	0/0	E1
M209	3Y	2X	3X	40	267	0.000	12-0	1.30	0.00		0/0	0/0	E1
M213	1X	5Y	1Y	40	257	0.000	0-2	1.30	0.00		0/0	0/0	E1
M212	1X	1Y	2Y	40	257	0.000	2-6	9.00	0.00		0/0	0/0	E1
M211	1X	2Y	3Y	40	267	0.000	6-10	10.40	0.00		0/0	0/0	E1
M210	1X	3Y	4Y	40	257	0.000	10-0	1.30	0.00		0/0	0/0	E1
M217	2X	5Y	1Y	40	258	0.000	0-5	1.30	0.00		0/0	0/0	E1
M216	2X	1Y	2Y	40	258	0.000	5-9	9.00	0.00		0/0	0/0	E1
M215	2X	2Y	3Y	40	268	0.000	9-12	10.40	0.00		0/0	0/0	E1
M214	2X	3Y	4Y	40	258	0.000	12-0	1.30	0.00		0/0	0/0	E1



KYRYP STATYK HESAP SONUÇLARI

İM109	GGGGG	QQQQQ	Q Q Q	Q Q Q	QQ QQ	QQ QQ	Q QQ Q	Zemin	Maçyklık
SolM	15.39	5.28	-3.75	-1.53	5.40	-1.67	3.49	0.00	0.00 (tm)
SagM	-0.57	-0.17	-0.15	-0.02	-0.20	-0.03	-0.10	0.00	
SolV	18.87	7.91	6.52	1.76	7.94	1.70	6.79	0.00	Xaç (m)
SagV	-8.10	-3.12	-2.63	-0.71	-3.07	-0.68	-2.86	0.00	1.30
Deprem+X		Deprem-X	Deprem+Y	Deprem-Y	Rüzgar X	Rüzgar Y	Deprem Z		
SolM	1.62	-1.63	0.79	-0.78	0.86	0.24	3.38		
SagM	-0.04	0.06	-0.07	0.06	-0.02	-0.02	-0.13		
SolV	3.68	3.39	1.18	1.20	1.93	0.35	4.14	Z1=	3.00m
SagV	-1.67	-1.61	-0.63	-0.62	-0.88	-0.18	-1.78	Z2=	3.00m
İM113	GGGGG	QQQQQ	Q Q Q	Q Q Q	QQ QQ	QQ QQ	Q QQ Q	Zemin	Maçyklık
SolM	0.72	0.16	-0.04	-0.12	0.06	-0.16	-0.10	0.00	0.00 (tm)
SagM	-16.13	-4.17	-1.32	-2.85	-1.50	-4.21	-2.63	0.00	
SolV	10.49	3.92	1.12	3.03	1.21	3.84	3.17	0.00	Xaç (m)
SagV	-13.26	-4.77	-1.21	-3.76	-1.26	-4.83	-3.79	0.00	0.01
Deprem+X		Deprem-X	Deprem+Y	Deprem-Y	Rüzgar X	Rüzgar Y	Deprem Z		
SolM	-0.13	0.16	-0.01	-0.01	-0.08	0.00	0.16		
SagM	1.12	-1.29	0.84	-0.75	0.67	0.28	-3.54		
SolV	2.24	2.72	0.99	1.04	1.36	0.36	2.30	Z1=	3.00m
SagV	-2.24	-2.74	-1.11	-1.16	-1.36	-0.40	-2.91	Z2=	3.00m
İM112	GGGGG	QQQQQ	Q Q Q	Q Q Q	QQ QQ	QQ QQ	Q QQ Q	Zemin	Maçyklık
SolM	16.13	4.17	-1.32	-2.85	-1.50	-4.21	-2.63	0.00	28.34 (tm)
SagM	-34.40	-12.15	-6.60	-5.56	-6.60	-6.62	-11.08	0.00	
SolV	13.26	4.77	1.21	3.76	1.26	4.83	3.79	0.00	Xaç (m)
SagV	-15.43	-5.61	-3.73	-3.13	-3.89	-3.47	-5.41	0.00	4.14
Deprem+X		Deprem-X	Deprem+Y	Deprem-Y	Rüzgar X	Rüzgar Y	Deprem Z		
SolM	-1.12	1.29	-0.84	0.75	-0.67	-0.28	3.54		
SagM	1.42	-1.54	0.12	-0.06	0.87	0.00	-7.54		
SolV	2.24	2.74	1.11	1.16	1.36	0.40	2.91	Z1=	3.00m
SagV	-1.64	-1.82	-1.42	-1.51	-0.99	-0.51	-3.38	Z2=	3.00m
İM111	GGGGG	QQQQQ	Q Q Q	Q Q Q	QQ QQ	QQ QQ	Q QQ Q	Zemin	Maçyklık
SolM	34.72	12.26	6.69	5.58	6.70	6.65	11.18	0.00	39.87 (tm)
SagM	-15.60	-5.38	-3.79	-1.59	-4.67	-1.52	-4.57	0.00	
SolV	15.60	5.67	3.76	3.16	3.93	3.50	5.47	0.00	Xaç (m)
SagV	-14.88	-5.87	-4.73	-1.33	-5.41	-1.28	-5.28	0.00	5.46
Deprem+X		Deprem-X	Deprem+Y	Deprem-Y	Rüzgar X	Rüzgar Y	Deprem Z		
SolM	-1.45	1.58	-0.11	0.05	-0.89	0.00	7.62		
SagM	1.44	-1.49	-1.08	1.11	0.76	-0.33	-3.42		
SolV	1.64	1.81	1.43	1.52	0.99	0.52	3.42	Z1=	3.00m
SagV	-1.98	-2.09	-1.46	-1.63	-1.05	-0.46	-3.26	Z2=	3.00m
İM110	GGGGG	QQQQQ	Q Q Q	Q Q Q	QQ QQ	QQ QQ	Q QQ Q	Zemin	Maçyklık
SolM	15.44	5.34	3.76	1.58	4.63	1.51	4.54	0.00	0.00 (tm)
SagM	-0.53	-0.17	-0.13	-0.04	-0.16	-0.04	-0.15	0.00	
SolV	14.83	5.86	4.72	1.33	5.40	1.27	5.27	0.00	Xaç (m)
SagV	-11.24	-4.58	-3.67	-1.08	-4.48	-1.06	-3.79	0.00	1.30
Deprem+X		Deprem-X	Deprem+Y	Deprem-Y	Rüzgar X	Rüzgar Y	Deprem Z		
SolM	-1.40	1.45	1.04	-1.07	-0.74	0.32	3.39		
SagM	0.06	-0.04	0.00	-0.01	0.03	0.00	-0.12		
SolV	1.99	2.09	1.45	1.61	1.05	0.46	3.25	Z1=	3.00m
SagV	-1.92	-1.91	-1.33	-1.48	-1.01	-0.42	-2.47	Z2=	3.00m
İM117	GGGGG	QQQQQ	Q Q Q	Q Q Q	QQ QQ	QQ QQ	Q QQ Q	Zemin	Maçyklık
SolM	0.72	0.16	-0.04	-0.12	0.04	-0.15	-0.13	0.00	0.00 (tm)
SagM	-16.17	-4.18	-1.32	-2.86	-1.25	-3.69	-3.41	0.00	
SolV	10.53	3.94	1.12	3.03	1.08	3.80	3.23	0.00	Xaç (m)
SagV	-13.32	-4.78	-1.22	-3.77	-1.16	-4.46	-4.19	0.00	0.01
Deprem+X		Deprem-X	Deprem+Y	Deprem-Y	Rüzgar X	Rüzgar Y	Deprem Z		
SolM	0.13	-0.16	0.01	-0.01	0.08	0.00	0.16		
SagM	-1.11	1.28	0.76	-0.84	-0.66	0.28	-3.55		
SolV	2.25	2.74	1.04	1.00	1.36	0.36	2.31	Z1=	3.00m
SagV	-2.25	-2.75	-1.17	-1.11	-1.36	-0.40	-2.92	Z2=	3.00m
İM116	GGGGG	QQQQQ	Q Q Q	Q Q Q	QQ QQ	QQ QQ	Q QQ Q	Zemin	Maçyklık
SolM	16.17	4.18	-1.32	-2.86	1.25	-3.69	3.41	0.00	28.23 (tm)
SagM	-34.51	-12.19	-6.61	-5.57	-8.00	-5.53	-10.84	0.00	
SolV	13.32	4.78	1.22	3.77	1.16	4.46	4.19	0.00	Xaç (m)
SagV	-15.50	-5.64	-3.74	-3.15	-4.23	-3.18	-5.27	0.00	4.14
Deprem+X		Deprem-X	Deprem+Y	Deprem-Y	Rüzgar X	Rüzgar Y	Deprem Z		
SolM	1.11	-1.28	-0.76	0.84	0.66	-0.28	3.55		
SagM	-1.41	1.53	0.07	-0.12	-0.86	0.00	-7.57		
SolV	2.25	2.75	1.17	1.11	1.36	0.40	2.92	Z1=	3.00m
SagV	-1.65	-1.83	-1.52	-1.42	-1.00	-0.51	-3.40	Z2=	3.00m
İM115	GGGGG	QQQQQ	Q Q Q	Q Q Q	QQ QQ	QQ QQ	Q QQ Q	Zemin	Maçyklık
SolM	34.84	12.30	6.71	5.59	8.11	5.55	10.93	0.00	40.44 (tm)
SagM	-15.63	-5.39	-3.79	-1.60	-5.45	-1.74	-3.59	0.00	
SolV	15.67	5.70	3.78	3.18	4.26	3.21	5.33	0.00	Xaç (m)
SagV	-14.94	-5.89	-4.75	-1.34	-5.96	-1.34	-4.79	0.00	5.46
Deprem+X		Deprem-X	Deprem+Y	Deprem-Y	Rüzgar X	Rüzgar Y	Deprem Z		
SolM	1.44	-1.57	-0.06	0.11	0.88	0.00	7.64		
SagM	-1.44	1.49	-1.11	1.08	-0.76	-0.33	-3.43		
SolV	1.65	1.82	1.53	1.43	1.00	0.52	3.44	Z1=	3.00m
SagV	-1.99	-2.10	-1.63	-1.46	-1.05	-0.46	-3.28	Z2=	3.00m

KYRYP STATYK HESAP SONUÇLARI

İM	GGGGG	QQQQQ	Q Q Q	Q Q Q	QQ QQ	QQ QQ	Q QQ Q	Zemin	Maçyklık
M114	SolM	15.48	5.35	-3.76	-1.58	5.40	-1.73	0.00	0.00 (tm)
	SagM	-0.53	-0.17	-0.13	-0.04	-0.18	-0.06	0.00	
	SolV	14.89	5.88	4.74	1.33	5.94	1.33	0.00	Xaç (m)
	SagV	-11.27	-4.59	-3.68	-1.08	-4.54	-1.10	0.00	1.30
	Deprem+X		Deprem-X	Deprem+Y	Deprem-Y	Rüzgar X	Rüzgar Y	Deprem Z	
	SolM	1.40	-1.45	1.08	-1.04	0.74	0.32	3.39	
	SagM	-0.06	0.04	0.01	0.00	-0.03	0.00	-0.12	
	SolV	2.00	2.10	1.62	1.45	1.06	0.46	3.27	Z1= 3.00m
	SagV	-1.93	-1.92	-1.48	-1.33	-1.02	-0.42	-2.47	Z2= 3.00m
M201	SolM	0.17	0.03	-0.04	-0.01	0.01	-0.00	0.05	0.00
	SagM	-9.31	-1.67	-1.10	-0.57	-0.94	-0.67	-1.73	0.00
	SolV	5.18	1.00	0.70	0.32	0.81	0.38	0.93	0.00
	SagV	-13.38	-2.60	-1.86	-0.82	-1.99	-0.91	-2.48	0.00
	Deprem+X		Deprem-X	Deprem+Y	Deprem-Y	Rüzgar X	Rüzgar Y	Deprem Z	
	SolM	0.00	-0.02	-0.08	0.09	0.01	-0.03	0.04	
	SagM	1.50	-1.72	1.06	-0.95	1.04	0.38	-2.04	
	SolV	1.63	1.99	0.74	0.69	1.18	0.26	1.14	Z1= 8.90m
	SagV	-4.22	-5.24	-1.49	-1.40	-3.07	-0.53	-2.93	Z2= 8.90m
M202	SolM	9.31	1.67	-1.10	-0.57	0.94	-0.67	1.73	0.00
	SagM	-9.30	-1.67	-1.10	-0.57	-1.33	-0.54	-1.47	0.00
	SolV	13.38	2.60	1.86	0.82	1.99	0.91	2.48	0.00
	SagV	-13.37	-2.60	-1.86	-0.82	-1.96	-0.85	-2.49	0.00
	Deprem+X		Deprem-X	Deprem+Y	Deprem-Y	Rüzgar X	Rüzgar Y	Deprem Z	
	SolM	-1.50	1.72	-1.06	-0.95	-1.04	-0.38	2.04	
	SagM	-1.50	1.72	0.95	-1.06	-1.04	0.38	-2.04	
	SolV	4.22	5.24	1.49	1.40	3.07	0.53	2.93	Z1= 8.90m
	SagV	-4.22	-5.24	-1.39	-1.50	-3.07	-0.53	-2.93	Z2= 8.90m
M203	SolM	9.30	1.67	-1.10	-0.57	1.33	-0.54	1.47	0.00
	SagM	-0.17	-0.03	-0.04	0.01	-0.03	0.01	-0.05	0.00
	SolV	13.37	2.60	1.86	0.82	1.96	0.85	2.49	0.00
	SagV	-5.18	-1.00	-0.70	-0.32	-0.75	-0.33	-0.94	0.00
	Deprem+X		Deprem-X	Deprem+Y	Deprem-Y	Rüzgar X	Rüzgar Y	Deprem Z	
	SolM	1.50	-1.72	-0.95	1.06	1.04	-0.38	2.04	
	SagM	0.00	-0.02	0.09	-0.08	0.01	0.03	-0.04	
	SolV	4.22	5.24	1.39	1.50	3.07	0.53	2.93	Z1= 8.90m
	SagV	-1.63	-1.99	-0.68	-0.74	-1.18	-0.26	-1.14	Z2= 8.90m
M204	SolM	0.98	0.15	-0.06	-0.08	0.15	-0.08	0.07	0.00
	SagM	-23.26	-4.09	-1.94	-2.15	-3.65	-2.10	-2.43	0.00
	SolV	12.82	2.49	1.38	1.47	2.32	1.52	1.50	0.00
	SagV	-29.21	-5.76	-3.08	-3.38	-5.46	-3.43	-3.45	0.00
	Deprem+X		Deprem-X	Deprem+Y	Deprem-Y	Rüzgar X	Rüzgar Y	Deprem Z	
	SolM	0.05	-0.06	0.00	0.00	0.04	0.00	0.22	
	SagM	2.53	-2.64	-0.10	0.15	1.67	-0.04	-5.10	
	SolV	3.39	3.52	1.37	1.44	2.24	0.53	2.81	Z1= 8.90m
	SagV	-8.40	-8.70	-2.50	-2.63	-5.54	-0.97	-6.41	Z2= 8.90m
M205	SolM	23.26	4.09	-1.94	-2.15	3.65	-2.10	2.43	0.00
	SagM	-23.27	-4.09	-1.94	-2.15	-3.54	-2.65	-2.00	0.00
	SolV	29.21	5.76	3.08	3.38	5.46	3.43	3.45	0.00
	SagV	-29.22	-5.76	-3.08	-3.38	-5.38	-3.34	-3.74	0.00
	Deprem+X		Deprem-X	Deprem+Y	Deprem-Y	Rüzgar X	Rüzgar Y	Deprem Z	
	SolM	-2.53	2.64	0.10	-0.15	-1.67	0.04	5.10	
	SagM	-2.53	2.64	-0.15	0.10	-1.67	-0.04	-5.10	
	SolV	8.40	8.70	2.50	2.63	5.54	0.97	6.41	Z1= 8.90m
	SagV	-8.40	-8.70	-2.62	-2.50	-5.54	-0.97	-6.41	Z2= 8.90m
M206	SolM	23.27	4.09	-1.94	-2.15	3.54	-2.65	2.00	0.00
	SagM	-0.98	-0.15	-0.06	-0.08	-0.14	-0.12	-0.04	0.00
	SolV	29.22	5.76	3.08	3.38	5.38	3.34	3.74	0.00
	SagV	-12.82	-2.49	-1.38	-1.47	-2.29	-1.42	-1.64	0.00
	Deprem+X		Deprem-X	Deprem+Y	Deprem-Y	Rüzgar X	Rüzgar Y	Deprem Z	
	SolM	2.53	-2.64	0.15	-0.10	1.67	0.04	5.10	
	SagM	0.05	-0.06	0.00	0.00	0.04	0.00	-0.22	
	SolV	8.40	8.70	2.62	2.50	5.54	0.97	6.41	Z1= 8.90m
	SagV	-3.39	-3.52	-1.44	-1.37	-2.24	-0.53	-2.81	Z2= 8.90m
M207	SolM	0.38	0.07	-0.01	-0.06	0.06	-0.06	-0.01	0.00
	SagM	-11.28	-1.98	-0.66	-1.32	-1.70	-1.57	-0.68	0.00
	SolV	5.88	1.09	0.31	0.82	0.94	0.97	0.32	0.00
	SagV	-14.99	-2.82	-0.78	-2.15	-2.42	-2.55	-0.79	0.00
	Deprem+X		Deprem-X	Deprem+Y	Deprem-Y	Rüzgar X	Rüzgar Y	Deprem Z	
	SolM	0.01	0.01	0.08	-0.08	0.00	0.03	0.08	
	SagM	1.47	-1.26	-0.90	0.80	0.91	-0.33	-2.47	
	SolV	1.75	1.41	0.70	0.64	1.05	0.26	1.29	Z1= 8.90m
	SagV	-4.47	-3.52	-1.35	-1.24	-2.65	-0.49	-3.29	Z2= 8.90m

KYRYP STATYK HESAP SONUÇLARI

M208	GGGGG	QQQQQ	Q Q Q	Q Q Q	QQ QQ	QQ QQ	Q QQ Q	Zemin	Maçyklık
SolM	11.28	1.98	-0.66	-1.32	1.70	-1.57	-0.68	0.00	28.77 (tm)
SagM	-11.28	-1.98	-0.66	-1.32	-1.29	-1.91	-0.76	0.00	
SolV	14.99	2.82	0.78	2.15	2.42	2.55	0.79	0.00	Xaç (m)
SagV	-14.99	-2.82	-0.78	-2.15	-2.50	-2.66	-0.75	0.00	4.75
Deprem+X		Deprem-X	Deprem+Y	Deprem-Y	Rüzgar X	Rüzgar Y	Deprem Z		
SolM	-1.47	1.26	0.90	-0.80	-0.91	0.33	2.47		
SagM	-1.47	1.26	-0.80	0.91	-0.91	-0.33	-2.47		
SolV	4.47	3.52	1.35	1.24	2.65	0.49	3.29	Z1=	8.90m
SagV	-4.47	-3.52	-1.24	-1.36	-2.65	-0.49	-3.29	Z2=	8.90m
M209	GGGGG	QQQQQ	Q Q Q	Q Q Q	QQ QQ	QQ QQ	Q QQ Q	Zemin	Maçyklık
SolM	11.28	1.98	-0.66	-1.32	1.29	-1.91	-0.76	0.00	0.00 (tm)
SagM	-0.38	-0.07	-0.01	-0.06	-0.04	-0.07	-0.02	0.00	
SolV	14.99	2.82	0.78	2.15	2.50	2.66	0.75	0.00	Xaç (m)
SagV	-5.88	-1.09	-0.31	-0.82	-1.04	-1.03	-0.31	0.00	1.30
Deprem+X		Deprem-X	Deprem+Y	Deprem-Y	Rüzgar X	Rüzgar Y	Deprem Z		
SolM	1.47	-1.26	0.80	-0.91	0.91	0.33	2.47		
SagM	0.01	0.01	-0.08	0.07	0.00	-0.03	-0.08		
SolV	4.47	3.52	1.24	1.36	2.65	0.49	3.29	Z1=	8.90m
SagV	-1.75	-1.41	-0.64	-0.70	-1.05	-0.26	-1.29	Z2=	8.90m
M213	GGGGG	QQQQQ	Q Q Q	Q Q Q	QQ QQ	QQ QQ	Q QQ Q	Zemin	Maçyklık
SolM	0.38	0.06	-0.04	-0.02	0.04	-0.03	0.06	0.00	0.00 (tm)
SagM	-9.51	-1.69	-1.06	-0.63	-0.97	-0.74	-1.67	0.00	
SolV	8.40	1.58	1.11	0.48	1.14	0.54	1.51	0.00	Xaç (m)
SagV	-10.39	-1.92	-1.41	-0.53	-1.41	-0.58	-1.90	0.00	0.01
Deprem+X		Deprem-X	Deprem+Y	Deprem-Y	Rüzgar X	Rüzgar Y	Deprem Z		
SolM	-0.11	0.14	0.00	-0.01	-0.08	0.00	0.08		
SagM	1.13	-1.26	1.33	-1.26	0.78	0.49	-2.09		
SolV	2.03	2.49	1.61	1.68	1.47	0.62	1.84	Z1=	8.90m
SagV	-2.01	-2.48	-1.81	-1.88	-1.46	-0.70	-2.28	Z2=	8.90m
M212	GGGGG	QQQQQ	Q Q Q	Q Q Q	QQ QQ	QQ QQ	Q QQ Q	Zemin	Maçyklık
SolM	9.51	1.69	1.06	0.63	0.97	-0.74	1.67	0.00	19.43 (tm)
SagM	-28.04	-4.90	-2.22	-2.68	-4.46	-2.67	-2.68	0.00	
SolV	10.39	1.92	1.41	0.53	1.41	0.58	1.90	0.00	Xaç (m)
SagV	-12.80	-2.29	-1.20	-1.45	-2.23	-1.44	-1.38	0.00	3.92
Deprem+X		Deprem-X	Deprem+Y	Deprem-Y	Rüzgar X	Rüzgar Y	Deprem Z		
SolM	-1.13	1.26	-1.33	1.26	-0.78	-0.49	2.09		
SagM	1.92	-2.00	-0.12	0.16	1.27	-0.05	-6.15		
SolV	2.01	2.48	1.81	1.88	1.46	0.70	2.28	Z1=	8.90m
SagV	-1.98	-2.06	-2.05	-2.17	-1.31	-0.80	-2.81	Z2=	8.90m
M211	GGGGG	QQQQQ	Q Q Q	Q Q Q	QQ QQ	QQ QQ	Q QQ Q	Zemin	Maçyklık
SolM	28.29	4.95	2.23	2.72	4.50	-2.71	2.69	0.00	31.11 (tm)
SagM	-11.49	-2.02	-0.70	-1.32	-1.68	-1.63	-0.73	0.00	
SolV	12.94	2.31	1.21	1.46	2.25	1.46	1.39	0.00	Xaç (m)
SagV	-12.08	-2.20	-0.57	-1.67	-1.94	-1.90	-0.58	0.00	5.77
Deprem+X		Deprem-X	Deprem+Y	Deprem-Y	Rüzgar X	Rüzgar Y	Deprem Z		
SolM	-1.96	2.05	0.14	-0.18	-1.29	0.05	6.20		
SagM	1.12	-0.98	-1.23	1.16	0.71	-0.47	-2.52		
SolV	1.98	2.06	2.06	2.18	1.31	0.81	2.84	Z1=	8.90m
SagV	-2.05	-1.62	-1.65	-1.72	-1.21	-0.66	-2.65	Z2=	8.90m
M210	GGGGG	QQQQQ	Q Q Q	Q Q Q	QQ QQ	QQ QQ	Q QQ Q	Zemin	Maçyklık
SolM	11.43	2.01	-0.70	-1.31	1.67	-1.62	-0.72	0.00	0.00 (tm)
SagM	-0.39	-0.07	-0.02	-0.05	-0.06	-0.05	-0.02	0.00	
SolV	12.02	2.19	0.56	1.66	1.93	1.89	0.58	0.00	Xaç (m)
SagV	-9.07	-1.66	-0.45	-1.24	-1.41	-1.50	-0.44	0.00	1.30
Deprem+X		Deprem-X	Deprem+Y	Deprem-Y	Rüzgar X	Rüzgar Y	Deprem Z		
SolM	-1.09	0.96	1.19	-1.12	-0.69	0.45	2.51		
SagM	0.12	-0.09	0.00	-0.01	0.07	0.00	-0.09		
SolV	2.06	1.63	1.64	1.71	1.22	0.65	2.64	Z1=	8.90m
SagV	-2.08	-1.66	-1.49	-1.55	-1.24	-0.59	-1.99	Z2=	8.90m
M217	GGGGG	QQQQQ	Q Q Q	Q Q Q	QQ QQ	QQ QQ	Q QQ Q	Zemin	Maçyklık
SolM	0.38	0.06	-0.04	-0.02	0.05	-0.02	0.06	0.00	0.00 (tm)
SagM	-9.53	-1.69	-1.06	-0.63	-1.29	-0.60	-1.49	0.00	
SolV	8.42	1.58	1.12	0.48	1.19	0.48	1.50	0.00	Xaç (m)
SagV	-10.43	-1.93	-1.41	-0.54	-1.58	-0.52	-1.79	0.00	0.01
Deprem+X		Deprem-X	Deprem+Y	Deprem-Y	Rüzgar X	Rüzgar Y	Deprem Z		
SolM	0.11	-0.14	0.01	0.00	0.08	0.00	0.08		
SagM	-1.12	1.26	1.27	-1.34	-0.77	0.49	-2.09		
SolV	2.04	2.50	1.69	1.62	1.47	0.63	1.85	Z1=	8.90m
SagV	-2.02	-2.50	-1.89	-1.81	-1.46	-0.70	-2.29	Z2=	8.90m
M216	GGGGG	QQQQQ	Q Q Q	Q Q Q	QQ QQ	QQ QQ	Q QQ Q	Zemin	Maçyklık
SolM	9.53	1.69	1.06	0.63	1.29	-0.60	1.49	0.00	19.36 (tm)
SagM	-28.13	-4.92	-2.23	-2.69	-4.30	-3.28	-2.25	0.00	
SolV	10.43	1.93	1.41	0.54	1.58	0.52	1.79	0.00	Xaç (m)
SagV	-12.86	-2.30	-1.21	-1.45	-2.16	-1.62	-1.39	0.00	3.92
Deprem+X		Deprem-X	Deprem+Y	Deprem-Y	Rüzgar X	Rüzgar Y	Deprem Z		
SolM	1.12	-1.26	-1.27	1.34	0.77	-0.49	2.09		
SagM	-1.91	2.00	-0.16	0.12	-1.26	-0.05	-6.17		
SolV	2.02	2.50	1.89	1.81	1.46	0.70	2.29	Z1=	8.90m
SagV	-1.99	-2.07	-2.17	-2.06	-1.32	-0.81	-2.82	Z2=	8.90m





**KÝRYP BETONARME HESAP SONUÇLARI**

ÜA									
;	Kirib	üstMsol	altMsol	Mac.	üstMsađ	altMsađ	DONATI		
M110	Mduz. (tm)	0.00	0.00	( 1.30m)	0.00	0.00	0.00	0.00	
	max M (tm)	30.16	0.00	0.00	-1.02	0.00	0.00	0.00	ø6/20 (düz)
	D=40 fcd (kg/cm <sup>2</sup> )	233.33	0.00	0.00	0.00	0.00	0.00	0.00	ø14/26 (sol üst ila.)
	B=257 As' (cm <sup>2</sup> )	0.00	0.00	0.00	0.00	0.00	0.00	0.00	
	As (cm <sup>2</sup> )	11.83	0.00	0.00	0.00	0.00	0.00	0.00	
	Asw (cm <sup>2</sup> )	0.00			0.00				
M117	Mduz. (tm)	0.00	0.00	( 0.01m)	0.00	0.00	0.00	0.00	
	max M (tm)	1.27	0.00	0.00	-29.32	0.00	0.00	0.00	ø6/20 (düz)
	D=40 fcd (kg/cm <sup>2</sup> )	0.00	0.00	0.00	233.33	0.00	0.00	0.00	
	B=258 As' (cm <sup>2</sup> )	0.00	0.00	0.00	0.00	0.00	0.00	0.00	
	As (cm <sup>2</sup> )	0.00	0.00	0.00	11.50	0.00	0.00	0.00	
	Asw (cm <sup>2</sup> )	0.00			0.00				
M116	Mduz. (tm)	0.00	0.00	( 4.14m)	0.00	0.00	0.00	0.00	
	max M (tm)	29.32	0.00	28.23	-67.81	0.00	0.00	0.00	ø16/36 (düz)+ø16/36 (pilye)
	D=40 fcd (kg/cm <sup>2</sup> )	233.33	0.00	233.33	233.33	0.00	0.00	0.00	ø14/26 (sol üst ila.)
	B=258 As' (cm <sup>2</sup> )	0.00	0.00	0.00	0.00	0.00	0.00	0.00	
	As (cm <sup>2</sup> )	11.50	0.00	11.06	21.13	0.00	0.00	0.00	
	Asw (cm <sup>2</sup> )	0.00			0.00				Wk=0.16
M115	Mduz. (tm)	0.00	0.00	( 5.46m)	0.00	0.00	0.00	0.00	
	max M (tm)	68.45	0.00	40.44	-30.61	0.00	0.00	0.00	ø16/32 (düz)+ø16/32 (pilye)
	D=40 fcd (kg/cm <sup>2</sup> )	233.33	0.00	233.33	233.33	0.00	0.00	0.00	ø16/21 (sol üst ila.)
	B=268 As' (cm <sup>2</sup> )	0.00	0.00	0.00	0.00	0.00	0.00	0.00	
	As (cm <sup>2</sup> )	20.50	0.00	11.83	11.55	0.00	0.00	0.00	
	Asw (cm <sup>2</sup> )	0.00			0.00				Wk=0.16
M114	Mduz. (tm)	0.00	0.00	( 1.30m)	0.00	0.00	0.00	0.00	
	max M (tm)	30.32	0.00	0.00	-1.02	0.00	0.00	0.00	ø6/20 (düz)
	D=40 fcd (kg/cm <sup>2</sup> )	233.33	0.00	0.00	0.00	0.00	0.00	0.00	ø12/20 (sol üst ila.)
	B=258 As' (cm <sup>2</sup> )	0.00	0.00	0.00	0.00	0.00	0.00	0.00	
	As (cm <sup>2</sup> )	11.83	0.00	0.00	0.00	0.00	0.00	0.00	
	Asw (cm <sup>2</sup> )	0.00			0.00				
M201	Mduz. (tm)	0.00	0.00	( 0.01m)	0.00	0.00	0.00	0.00	
	max M (tm)	0.32	0.00	0.00	-15.80	0.00	0.00	0.00	ø6/20 (düz)
	D=40 fcd (kg/cm <sup>2</sup> )	0.00	0.00	0.00	233.33	0.00	0.00	0.00	ø14/26 (sađ üst ila.)
	B=257 As' (cm <sup>2</sup> )	0.00	0.00	0.00	0.00	0.00	0.00	0.00	
	As (cm <sup>2</sup> )	0.00	0.00	0.00	10.88	0.00	0.00	0.00	
	Asw (cm <sup>2</sup> )	0.00			0.00				
M202	Mduz. (tm)	0.00	0.00	( 4.70m)	0.00	0.00	0.00	0.00	
	max M (tm)	15.80	0.00	25.76	-15.70	0.00	0.00	0.00	ø14/30 (düz)+ø14/30 (pilye)
	D=40 fcd (kg/cm <sup>2</sup> )	233.33	0.00	233.33	233.33	0.00	0.00	0.00	ø14/26 (sađ üst ila.)
	B=257 As' (cm <sup>2</sup> )	0.00	0.00	0.00	0.00	0.00	0.00	0.00	
	As (cm <sup>2</sup> )	10.88	0.00	10.11	10.88	0.00	0.00	0.00	
	Asw (cm <sup>2</sup> )	0.00			0.00				Wk=0.16
M203	Mduz. (tm)	0.00	0.00	( 1.30m)	0.00	0.00	0.00	0.00	
	max M (tm)	15.70	0.00	0.00	-0.32	0.00	0.00	0.00	ø6/20 (düz)
	D=40 fcd (kg/cm <sup>2</sup> )	233.33	0.00	0.00	0.00	0.00	0.00	0.00	
	B=257 As' (cm <sup>2</sup> )	0.00	0.00	0.00	0.00	0.00	0.00	0.00	
	As (cm <sup>2</sup> )	10.88	0.00	0.00	0.00	0.00	0.00	0.00	
	Asw (cm <sup>2</sup> )	0.00			0.00				
M204	Mduz. (tm)	0.00	0.00	( 0.01m)	0.00	0.00	0.00	0.00	
	max M (tm)	1.62	0.00	0.00	-39.12	0.00	0.00	0.00	ø6/20 (düz)
	D=40 fcd (kg/cm <sup>2</sup> )	0.00	0.00	0.00	233.33	0.00	0.00	0.00	ø20/23 (sađ üst ila.)
	B=460 As' (cm <sup>2</sup> )	0.00	0.00	0.00	0.00	0.00	0.00	0.00	
	As (cm <sup>2</sup> )	0.00	0.00	0.00	10.88	0.00	0.00	0.00	
	Asw (cm <sup>2</sup> )	0.00			0.00				
M205	Mduz. (tm)	0.00	0.00	( 4.75m)	0.00	0.00	0.00	0.00	
	max M (tm)	39.12	0.00	52.68	-39.13	0.00	0.00	0.00	ø16/30 (düz)+ø16/30 (pilye)
	D=70 fcd (kg/cm <sup>2</sup> )	233.33	0.00	233.33	233.33	0.00	0.00	0.00	ø20/23 (sađ üst ila.)
	B=460 As' (cm <sup>2</sup> )	0.00	0.00	0.00	0.00	0.00	0.00	0.00	
	As (cm <sup>2</sup> )	19.94	0.00	13.20	19.94	0.00	0.00	0.00	
	Asw (cm <sup>2</sup> )	0.00			0.00				Wk=0.19
M206	Mduz. (tm)	0.00	0.00	( 1.30m)	0.00	0.00	0.00	0.00	
	max M (tm)	39.13	0.00	0.00	-1.61	0.00	0.00	0.00	ø6/20 (düz)
	D=40 fcd (kg/cm <sup>2</sup> )	233.33	0.00	0.00	0.00	0.00	0.00	0.00	
	B=460 As' (cm <sup>2</sup> )	0.00	0.00	0.00	0.00	0.00	0.00	0.00	
	As (cm <sup>2</sup> )	10.88	0.00	0.00	0.00	0.00	0.00	0.00	
	Asw (cm <sup>2</sup> )	0.00			0.00				
M207	Mduz. (tm)	0.00	0.00	( 0.01m)	0.00	0.00	0.00	0.00	
	max M (tm)	0.64	0.00	0.00	-18.96	0.00	0.00	0.00	ø6/20 (düz)
	D=40 fcd (kg/cm <sup>2</sup> )	0.00	0.00	0.00	233.33	0.00	0.00	0.00	ø12/21 (sađ üst ila.)
	B=267 As' (cm <sup>2</sup> )	0.00	0.00	0.00	0.00	0.00	0.00	0.00	
	As (cm <sup>2</sup> )	0.00	0.00	0.00	10.88	0.00	0.00	0.00	
	Asw (cm <sup>2</sup> )	0.00			0.00				

ÜA

KYRYP BETONARME HESAP SONUÇLARI

Table with columns for element ID (e.g., M208, M213, M212, M211, M210, M217, M216, M215, M214), dimensions (Mduz., max M), and reinforcement data (D=40 fcd, B=267 As', As, Asw). Includes a 'DONATI' section at the top and 'Wk=0.15' for several elements.

Ck : Kirip üstüne oturan kolonların Dinamik Etki çarpanı
A4 : (Ba=Bax+0.3\*Bay, Ba=0.3\*Bax+Bay)

**KOLON STATİK HESAP SONUÇLARI**

ANALİZLERDE CATLAMLI KESİT ETKİN KESİT BÜYÜTLÜK ÇARPANI DÜKKATE ALINMIŞTIR TB DY2018 4 5 8

AA									
S201	GGGGGG	QQQQQQ	Q Q Q	Q Q Q	QQ QQ	QQ QQ	Q QQ Q	Zemin	Material:El
Üst Mx	-23.90	-4.62	-3.15	-1.47	-3.33	-1.59	-4.32	0.00	
Alt Mx	-17.87	-5.98	-2.10	-3.88	-1.87	-4.93	-5.17	0.00	I = 2
Üst My	-17.39	-3.54	-2.73	-0.81	-2.55	-0.79	-3.73	0.00	J = 1
Alt My	-13.19	-4.30	-0.97	-3.32	-1.08	-4.11	-3.40	0.00	
Tx	-7.08	-1.80	-0.89	-0.91	-0.88	-1.11	-1.61	0.00	R = 70 cm
Ty	-5.18	-1.33	-0.63	-0.70	-0.62	-0.83	-1.21	0.00	
Nz	43.15	6.45	4.38	2.07	3.95	2.44	6.51	0.00	H = 5.90 m
	Deprem+X	Deprem-X	Deprem+Y	Deprem-Y	Rüzgar X	Rüzgar Y	Deprem Z		
Üst Mx	7.95	-9.93	0.84	0.06	5.84	0.15	-5.24		
Alt Mx	6.78	-8.65	0.66	0.15	5.89	0.09	-3.92		
Üst My	0.54	0.25	6.82	-7.20	0.09	2.69	-3.81		
Alt My	1.41	-0.50	8.86	-9.29	0.41	3.59	-2.89		
Tx	2.50	-3.15	0.25	0.04	1.99	0.04	-1.55		
Ty	0.33	-0.04	2.66	-2.80	0.08	1.06	-1.14		
Nz	-1.65	1.89	-1.43	1.31	-1.15	-0.52	9.47		
AA									
S101	GGGGGG	QQQQQQ	Q Q Q	Q Q Q	QQ QQ	QQ QQ	Q QQ Q	Zemin	Material:El
Üst Mx	-9.96	-6.00	-0.91	-5.09	-0.83	-6.57	-4.61	0.00	
Alt Mx	-5.00	-2.98	-0.46	-2.52	-0.57	-3.32	-2.08	0.00	I = 1
Üst My	-7.20	-4.59	-0.19	-4.40	0.18	-5.66	-3.70	0.00	J =
Alt My	-4.67	-2.73	-0.53	-2.19	-0.34	-2.78	-2.33	0.00	
Tx	-2.71	-1.63	-0.25	-1.38	-0.25	-1.79	-1.21	0.00	R = 70 cm
Ty	-2.15	-1.33	-0.13	-1.20	-0.03	-1.53	-1.09	0.00	
Nz	106.20	22.53	9.53	12.99	10.03	18.61	16.41	0.00	H = 5.52 m
	Deprem+X	Deprem-X	Deprem+Y	Deprem-Y	Rüzgar X	Rüzgar Y	Deprem Z		
Üst Mx	2.49	-2.75	0.13	0.06	-0.25	0.02	-2.19		
Alt Mx	10.15	-12.12	0.50	0.53	4.47	0.00	-1.10		
Üst My	-1.74	1.46	-3.97	4.01	-0.68	-1.87	-1.58		
Alt My	-2.65	3.01	0.09	-0.34	-1.28	-0.37	-1.02		
Tx	2.29	-2.70	0.11	0.11	0.77	0.00	-0.59		
Ty	-0.79	0.81	-0.70	0.67	-0.35	-0.41	-0.47		
Nz	-3.35	3.87	-2.34	2.08	-2.17	-0.83	23.29		
AA									
S202	GGGGGG	QQQQQQ	Q Q Q	Q Q Q	QQ QQ	QQ QQ	Q QQ Q	Zemin	Material:El
Üst Mx	23.90	4.62	-3.15	-1.47	3.20	-1.53	-4.51	0.00	
Alt Mx	17.86	5.98	-2.10	-3.88	2.23	4.97	-4.77	0.00	I = 5
Üst My	-17.38	-3.54	-2.73	-0.81	-3.52	-0.66	-2.90	0.00	J = 3
Alt My	-13.18	-4.30	-0.97	-3.32	-1.32	-3.06	-4.22	0.00	
Tx	7.08	1.80	0.89	0.91	0.92	1.10	1.57	0.00	R = 70 cm
Ty	-5.18	-1.33	-0.63	-0.70	-0.82	-0.63	-1.21	0.00	
Nz	43.25	6.45	4.38	2.07	5.35	1.94	5.61	0.00	H = 5.90 m
	Deprem+X	Deprem-X	Deprem+Y	Deprem-Y	Rüzgar X	Rüzgar Y	Deprem Z		
Üst Mx	7.95	-9.93	0.04	0.86	5.84	-0.15	5.24		
Alt Mx	6.78	-8.65	0.13	0.68	5.89	-0.09	3.92		
Üst My	-0.54	0.25	7.19	-6.81	-0.09	2.69	-3.81		
Alt My	-1.41	-0.50	9.28	-8.85	-0.41	3.59	-2.89		
Tx	2.50	-3.15	0.03	0.26	1.99	-0.04	1.55		
Ty	-0.33	0.04	2.79	-2.65	-0.08	1.06	-1.14		
Nz	1.65	-1.89	-1.32	1.43	1.15	-0.52	9.49		
AA									
S102	GGGGGG	QQQQQQ	Q Q Q	Q Q Q	QQ QQ	QQ QQ	Q QQ Q	Zemin	Material:El
Üst Mx	9.96	6.00	-0.91	-5.09	0.63	-6.93	-4.46	0.00	
Alt Mx	5.00	2.98	-0.46	-2.52	0.17	-3.36	-2.44	0.00	I = 3
Üst My	-7.20	-4.59	-0.19	-4.40	0.29	-3.92	-5.54	0.00	J =
Alt My	-4.67	-2.73	-0.53	-2.19	-0.37	-1.96	-3.12	0.00	
Tx	2.71	1.63	0.25	1.38	0.14	1.87	1.25	0.00	R = 70 cm
Ty	-2.15	-1.33	-0.13	-1.20	-0.02	-1.07	-1.57	0.00	
Nz	106.40	22.53	9.53	12.99	10.27	15.92	18.86	0.00	H = 5.52 m
	Deprem+X	Deprem-X	Deprem+Y	Deprem-Y	Rüzgar X	Rüzgar Y	Deprem Z		
Üst Mx	2.49	-2.75	0.05	0.13	-0.25	-0.02	2.19		
Alt Mx	10.15	-12.12	0.51	0.53	4.47	0.00	1.10		
Üst My	-1.74	1.46	-4.01	3.96	0.68	-1.87	-1.58		
Alt My	2.65	-3.01	0.34	-0.08	1.28	-0.37	-1.02		
Tx	2.29	-2.70	0.10	0.12	0.77	0.00	0.60		
Ty	0.79	-0.81	-0.67	0.70	0.35	-0.41	-0.47		
Nz	3.35	-3.87	-2.08	2.35	2.17	-0.83	23.34		
AA									
S203	GGGGGG	QQQQQQ	Q Q Q	Q Q Q	QQ QQ	QQ QQ	Q QQ Q	Zemin	Material:El
Üst Mx	-36.30	-7.43	-3.58	-3.85	-6.85	-3.89	-4.11	0.00	
Alt Mx	-26.47	-9.34	-4.81	-4.53	-5.96	-4.40	-8.32	0.00	I = 6
Üst My	-7.90	-1.46	0.62	-2.09	-2.56	-1.92	1.56	0.00	J = 4
Alt My	-7.32	-1.64	-2.10	0.46	-3.59	1.36	-1.05	0.00	
Tx	-10.64	-2.84	-1.42	-1.42	-2.17	-1.40	-2.11	0.00	R = 70 cm
Ty	-2.58	-0.53	-0.25	-0.28	-1.04	-0.09	0.09	0.00	
Nz	78.43	12.58	5.97	6.61	11.50	6.50	7.17	0.00	H = 5.90 m
	Deprem+X	Deprem-X	Deprem+Y	Deprem-Y	Rüzgar X	Rüzgar Y	Deprem Z		
Üst Mx	10.42	-10.79	0.08	0.10	6.81	0.00	-7.96		
Alt Mx	10.42	-10.51	0.06	-0.02	7.13	0.01	-5.81		
Üst My	0.09	1.12	9.82	-10.43	-0.32	3.82	-1.73		
Alt My	0.66	0.63	11.01	-11.64	-0.09	4.31	-1.61		
Tx	3.53	-3.61	0.02	0.01	2.36	0.00	-2.33		
Ty	0.13	0.30	3.53	-3.74	-0.07	1.38	-0.57		
Nz	-2.36	2.48	0.27	-0.33	-1.56	0.10	17.20		
AA									

**KOLON STATİK HESAP SONUÇLARI**

Üst	Alt	Üst	Alt	Tx	Ty	Nz	Deprem+X	Deprem-X	Deprem+Y	Deprem-Y	Rüzgar X	Rüzgar Y	Deprem Z	Zemin	Material:El	I	J	R	H
S103																			
Üst Mx	-13.86	-8.89	-4.77	-4.12	-4.28	-3.90	-9.60	0.00	0.00	0.00	0.00	0.00	0.00	0.00					
Alt Mx	-6.96	-4.43	-2.38	-2.05	-2.21	-1.97	-4.68	0.00	0.00	0.00	0.00	0.00	0.00	0.00			4		
Üst My	-4.81	-1.81	-4.40	1.29	-3.63	3.88	-3.87	0.00	0.00	0.00	0.00	0.00	0.00	0.00					
Alt My	-3.35	-1.31	-2.58	2.57	-2.19	1.94	-2.37	0.00	0.00	0.00	0.00	0.00	0.00	0.00					
Tx	-3.61	-2.31	-1.24	-1.07	-1.12	-1.02	-2.47	0.00	0.00	0.00	0.00	0.00	0.00	0.00				70	
Ty	-1.41	-0.54	-1.21	0.67	-1.01	1.01	-1.08	0.00	0.00	0.00	0.00	0.00	0.00	0.00					
Nz	177.28	43.96	22.39	21.57	27.67	24.66	35.60	0.00	0.00	0.00	0.00	0.00	0.00	0.00					5.78
Deprem+X																			
Deprem-X																			
Deprem+Y																			
Deprem-Y																			
Rüzgar X																			
Rüzgar Y																			
Deprem Z																			
Üst Mx	-1.04	0.40	0.19	0.14	-1.66	0.00	-3.04												
Alt Mx	4.46	-5.55	0.28	0.28	1.69	0.00	-1.53												
Üst My	-2.20	2.03	-3.23	3.20	-0.92	-1.66	-1.05												
Alt My	-2.69	3.04	0.21	-0.46	-1.29	-0.34	-0.74												
Tx	0.59	-0.89	0.08	0.07	0.00	0.00	-0.79												
Ty	-0.85	0.88	-0.52	0.47	-0.38	-0.34	-0.31												
Nz	-4.03	4.29	0.16	-0.28	-2.59	0.12	38.88												
S204																			
Üst Mx	36.32	7.43	-3.58	-3.85	6.83	-3.70	4.33	0.00	0.00	0.00	0.00	0.00	0.00	0.00					
Alt Mx	26.48	9.34	4.81	4.53	5.79	4.56	8.32	0.00	0.00	0.00	0.00	0.00	0.00	0.00			9		
Üst My	-7.90	-1.46	0.62	-2.09	-1.21	-3.09	1.38	0.00	0.00	0.00	0.00	0.00	0.00	0.00					
Alt My	-7.32	-1.64	-2.10	0.46	-4.03	0.03	0.72	0.00	0.00	0.00	0.00	0.00	0.00	0.00					
Tx	10.64	2.84	1.42	1.42	-2.14	1.40	2.14	0.00	0.00	0.00	0.00	0.00	0.00	0.00				70	
Ty	-2.58	-0.53	-0.25	-0.28	-0.89	-0.52	0.35	0.00	0.00	0.00	0.00	0.00	0.00	0.00					
Nz	77.69	12.58	5.97	6.61	11.20	8.17	5.79	0.00	0.00	0.00	0.00	0.00	0.00	0.00					5.90
Deprem+X																			
Deprem-X																			
Deprem+Y																			
Deprem-Y																			
Rüzgar X																			
Rüzgar Y																			
Deprem Z																			
Üst Mx	10.41	-10.78	0.10	0.08	6.81	0.00	7.97												
Alt Mx	10.41	-10.51	-0.02	0.06	7.13	-0.01	5.81												
Üst My	-0.09	-1.12	10.41	-9.80	0.32	3.82	-1.73												
Alt My	-0.66	-0.63	11.62	-10.99	0.09	4.31	-1.61												
Tx	3.53	-3.61	0.01	0.02	2.36	0.00	2.33												
Ty	-0.13	-0.30	3.73	-3.52	0.07	1.38	-0.57												
Nz	2.36	-2.48	0.33	-0.27	1.56	0.10	17.04												
S104																			
Üst Mx	13.87	8.89	-4.77	-4.12	3.69	-4.27	9.82	0.00	0.00	0.00	0.00	0.00	0.00	0.00					
Alt Mx	6.97	4.43	2.38	2.05	1.78	2.10	4.98	0.00	0.00	0.00	0.00	0.00	0.00	0.00			7		
Üst My	-4.80	-1.81	-4.40	2.59	-5.59	2.88	-0.90	0.00	0.00	0.00	0.00	0.00	0.00	0.00					
Alt My	-3.35	-1.31	-2.58	1.27	-3.23	1.41	-0.79	0.00	0.00	0.00	0.00	0.00	0.00	0.00					
Tx	3.61	2.31	1.24	1.07	0.95	1.10	2.56	0.00	0.00	0.00	0.00	0.00	0.00	0.00				70	
Ty	-1.41	-0.54	-1.21	0.67	-1.53	0.74	-0.29	0.00	0.00	0.00	0.00	0.00	0.00	0.00					
Nz	175.80	43.96	22.39	21.57	31.32	22.89	33.72	0.00	0.00	0.00	0.00	0.00	0.00	0.00					5.78
Deprem+X																			
Deprem-X																			
Deprem+Y																			
Deprem-Y																			
Rüzgar X																			
Rüzgar Y																			
Deprem Z																			
Üst Mx	-1.04	0.40	0.13	0.20	-1.66	0.00	3.04												
Alt Mx	4.46	-5.55	0.27	0.29	1.69	0.00	-1.53												
Üst My	2.20	-2.03	-3.20	3.23	0.92	-1.66	-1.05												
Alt My	2.69	-3.04	0.46	-0.21	1.29	-0.34	-0.74												
Tx	0.59	-0.89	0.07	0.08	0.00	0.00	0.79												
Ty	0.85	-0.88	-0.48	0.52	0.38	-0.34	-0.31												
Nz	4.03	-4.29	0.28	-0.16	-2.59	0.12	38.56												
S205																			
Üst Mx	-24.64	-4.62	-1.22	-3.40	-3.70	-4.36	-1.18	0.00	0.00	0.00	0.00	0.00	0.00	0.00					
Alt Mx	-15.76	-4.44	-2.55	-1.89	-4.29	-2.16	-2.42	0.00	0.00	0.00	0.00	0.00	0.00	0.00			10		
Üst My	26.54	5.11	1.20	3.90	5.09	3.71	1.42	0.00	0.00	0.00	0.00	0.00	0.00	0.00					
Alt My	19.26	5.82	3.97	1.86	4.96	1.67	5.02	0.00	0.00	0.00	0.00	0.00	0.00	0.00					
Tx	-6.85	-1.54	-0.64	-0.90	-1.35	-1.11	-0.61	0.00	0.00	0.00	0.00	0.00	0.00	0.00				70	
Ty	7.76	1.85	0.88	0.98	1.70	0.91	1.09	0.00	0.00	0.00	0.00	0.00	0.00	0.00					
Nz	48.57	7.37	2.38	4.99	6.19	6.20	2.35	0.00	0.00	0.00	0.00	0.00	0.00	0.00					5.90
Deprem+X																			
Deprem-X																			
Deprem+Y																			
Deprem-Y																			
Rüzgar X																			
Rüzgar Y																			
Deprem Z																			
Üst Mx	8.39	-6.56	-0.74	-0.08	4.98	-0.14	-5.40												
Alt Mx	9.79	-7.29	-0.61	-0.52	6.12	-0.05	-3.46												
Üst My	0.11	0.60	6.23	-6.58	-0.26	2.51	5.82												
Alt My	4.23	-3.90	6.41	-6.49	1.71	3.12	4.22												
Tx	3.08	-2.35	-0.23	-0.10	1.88	-0.03	-1.50												
Ty	0.73	-0.56	2.14	-2.22	0.25	0.96	1.70												
Nz	-1.67	1.43	1.13	-1.01	-1.04	0.42	10.65												
S105																			
Üst Mx	-15.05	-8.61	-7.63	-0.98	-9.24	-0.71	-7.27	0.00	0.00	0.00	0.00	0.00	0.00	0.00					
Alt Mx	0.40	0.59	0.65	-0.06	1.03	-0.04	0.19	0.00	0.00	0.00	0.00	0.00	0.00	0.00			8		
Üst My	18.09	8.46	7.84	0.61	6.43	0.48	10.00	0.00	0.00	0.00	0.00	0.00	0.00	0.00					
Alt My	-14.33	-6.49	-6.43	-0.06	-5.79	0.33	-7.52	0.00	0.00	0.00	0.00	0.00	0.00	0.00					
Tx	-13.92	-7.62	-6.63	-0.99	-7.80	-0.71	-6.72	0.00	0.00	0.00	0.00	0.00	0.00	0.00				70	
Ty	3.57	1.87	1.34	0.53	0.61	0.77	2.35	0.00	0.00	0.00	0.00	0.00	0.00	0.00					
Nz	100.83	25.91	14.99	10.92	21.81	11.94	18.07	0.00	0.00	0.00	0.00	0.00	0.00	0.00					1.05
Deprem+X																			
Deprem-X																			

KOLON STATİK HESAP SONUÇLARI

Ü										
S206		GGGGG	QQQQQ	Q Q Q	- Q Q Q	QQ QQ	- QQ QQ	Q QQ Q	Zemin	Material:El
Üst Mx	24.64	4.62	-1.22	-3.40	3.91	-4.30	-1.03	0.00		
Alt Mx	15.75	4.44	2.55	1.89	4.04	2.28	2.56	0.00	I = 12	
Üst My	26.53	5.11	1.20	3.90	4.13	4.82	1.26	0.00	J = 11	
Alt My	19.26	5.82	3.97	1.86	5.67	2.04	3.94	0.00		
Tx	6.85	1.54	0.64	0.90	1.35	1.11	0.61	0.00	R = 70 cm	
Ty	7.76	1.85	0.88	0.98	1.66	1.16	0.88	0.00		
Nz	48.24	7.37	2.38	4.99	4.68	7.27	2.79	0.00	H = 5.90 m	
		Deprem+X	Deprem-X	Deprem+Y	Deprem-Y	Rüzgar X	Rüzgar Y	Deprem Z		
Üst Mx	8.38	-6.56	-0.06	-0.76	4.98	0.14	5.40			
Alt Mx	9.79	-7.29	-0.48	-0.64	6.12	0.05	3.45			
Üst My	-0.11	-0.60	6.57	-6.22	0.26	2.51	5.82			
Alt My	-4.23	3.90	6.49	-6.40	-1.71	3.12	4.22			
Tx	3.08	-2.35	-0.09	-0.24	1.88	0.03	1.50			
Ty	-0.73	0.56	2.21	-2.14	-0.25	0.96	1.70			
Nz	1.67	-1.43	1.02	-1.13	1.04	0.42	10.58			
A										
S106		GGGGG	QQQQQ	Q Q Q	- Q Q Q	QQ QQ	- QQ QQ	Q QQ Q	Zemin	Material:El
Üst Mx	15.06	8.61	-7.63	0.98	8.86	-0.35	8.02	0.00		
Alt Mx	-0.41	-0.59	-0.65	0.06	-0.35	0.23	-1.07	0.00	I = 11	
Üst My	18.08	8.46	7.84	0.61	9.45	0.06	7.40	0.00	J =	
Alt My	-14.33	-6.49	-6.43	-0.06	-7.38	0.02	-5.63	0.00		
Tx	13.91	7.62	6.63	0.99	8.08	0.55	6.60	0.00	R = 70 cm	
Ty	3.56	1.87	1.34	0.53	1.96	0.08	1.69	0.00		
Nz	100.17	25.91	14.99	10.92	23.02	14.06	14.74	0.00	H = 1.05 m	
		Deprem+X	Deprem-X	Deprem+Y	Deprem-Y	Rüzgar X	Rüzgar Y	Deprem Z		
Üst Mx	-4.40	2.81	0.73	0.02	-3.22	0.08	3.30			
Alt Mx	22.48	-20.15	0.02	-1.16	11.05	0.13	-0.09			
Üst My	5.66	-5.94	-2.40	2.67	2.59	-1.79	3.97			
Alt My	22.34	-28.28	29.70	-26.51	11.57	7.30	-3.14			
Tx	17.17	-16.47	0.71	-1.08	7.44	0.20	3.05			
Ty	26.60	-32.50	25.93	-22.63	13.45	5.23	0.78			
Nz	3.42	-3.18	1.93	-2.05	1.97	0.70	21.97			
A										



**KOLON BETONARME HESAP SONUÇLARI**

Kolon	N (t)	minor M	major M	fcd	i	As	Donatý
S201	Bx=70	X-(G+Q)	70.734	-26.25	-35.74	233.3	0.0108; 41.72; 11ø22
	By=0	X-(G+Q+E)	51.495	-19.10	-33.86	233.3	0.0108; 41.72; ø8/20/10(etriye)
I:2		Y-(G+Q)	70.734	-35.38	-26.64	233.3	0.0108; 41.72; Cx:1 Cy:1
J:1	Hk=5.9m	Y-(G+Q+E)	50.917	-24.88	-27.20	233.3	0.0108; 41.72;
	Sx =1.000	X-(G-E)	34.846	-11.46	-8.82	233.3	0.0108; 41.72;
A4 ò	Sy =1.000	Y-(G-E)	35.478	-15.99	-6.99	233.3	0.0108; 41.72; aAs/Ac=0.0217
S101	Bx=70	X-(G+Q)	184.716	-16.95	-21.79	233.3	0.0108; 41.72; 11ø22
	By=0	X-(G+Q+E)	132.591	-4.75	-20.60	233.3	0.0108; 41.72; ø8/20/10(etriye)
I:1		Y-(G+Q)	184.716	-21.79	-16.95	233.3	0.0108; 41.72; Cx:1 Cy:1
J:0	Hk=5.516m	Y-(G+Q+E)	130.799	-15.32	-15.56	233.3	0.0108; 41.72;
	Sx =1.000	X-(G-E)	84.721	-4.16	-5.71	233.3	0.0108; 41.72;
A4 ò	Sy =1.000	Y-(G-E)	86.250	-3.67	-2.91	233.3	0.0108; 41.72; aAs/Ac=0.0217
S202	Bx=70	X-(G+Q)	70.874	-26.24	35.73	233.3	0.0108; 41.72; 11ø22
	By=0	X-(G+Q+E)	54.441	-19.09	35.43	233.3	0.0108; 41.72; ø8/20/10(etriye)
I:5		Y-(G+Q)	70.874	34.01	-26.54	233.3	0.0108; 41.72; Cx:1 Cy:1
J:3	Hk=5.9m	Y-(G+Q+E)	48.386	24.89	-27.18	233.3	0.0108; 41.72;
	Sx =1.000	X-(G-E)	34.929	-12.27	9.22	233.3	0.0108; 41.72;
A4 ò	Sy =1.000	Y-(G-E)	35.562	15.98	-6.99	233.3	0.0108; 41.72; aAs/Ac=0.0217
S102	Bx=70	X-(G+Q)	185.000	-14.47	22.32	233.3	0.0108; 41.72; 11ø22
	By=0	X-(G+Q+E)	139.794	-3.93	20.97	233.3	0.0108; 41.72; ø8/20/10(etriye)
I:3		Y-(G+Q)	185.000	18.76	-16.74	233.3	0.0108; 41.72; Cx:1 Cy:1
J:0	Hk=5.516m	Y-(G+Q+E)	126.841	13.43	-15.42	233.3	0.0108; 41.72;
	Sx =1.000	X-(G-E)	84.889	-6.42	5.76	233.3	0.0108; 41.72;
A4 ò	Sy =1.000	Y-(G-E)	86.412	4.70	-2.91	233.3	0.0108; 41.72; aAs/Ac=0.0217
S203	Bx=70	X-(G+Q)	129.939	-12.87	-52.00	233.3	0.0108; 41.72; 11ø22
	By=0	X-(G+Q+E)	93.494	-8.82	-46.34	233.3	0.0108; 41.72; ø8/20/10(etriye)
I:6		Y-(G+Q)	129.939	-46.59	-16.00	233.3	0.0108; 41.72; Cx:1 Cy:1
J:4	Hk=5.9m	Y-(G+Q+E)	90.685	-34.19	-22.75	233.3	0.0108; 41.72;
	Sx =1.000	X-(G-E)	63.870	-6.68	-14.94	233.3	0.0108; 41.72;
A4 ò	Sy =1.000	Y-(G-E)	65.098	-23.98	-14.37	233.3	0.0108; 41.72; aAs/Ac=0.0217
S103	Bx=70	X-(G+Q)	318.538	-11.44	-31.17	233.3	0.0108; 41.72; 11ø22
	By=0	X-(G+Q+E)	231.068	-9.48	-25.78	233.3	0.0108; 41.72; ø10/20/10(etriye)
I:4		Y-(G+Q)	318.538	-24.23	-12.21	233.3	0.0108; 41.72; Cx:1 Cy:1
J:0	Hk=5.776m	Y-(G+Q+E)	221.406	-17.36	-11.73	233.3	0.0108; 41.72; 28ø8/20 (zýmba etr.)
	Sx =1.000	X-(G-E)	145.299	-4.31	-4.03	233.3	0.0108; 41.72;
A4 ò	Sy =1.000	Y-(G-E)	147.767	-11.18	-1.46	233.3	0.0108; 41.72; aAs/Ac=0.0217
S204	Bx=70	X-(G+Q)	128.902	-12.87	52.01	233.3	0.0108; 41.72; 11ø22
	By=0	X-(G+Q+E)	97.866	-8.81	48.08	233.3	0.0108; 41.72; ø8/20/10(etriye)
I:9		Y-(G+Q)	128.902	46.34	-16.69	233.3	0.0108; 41.72; Cx:1 Cy:1
J:7	Hk=5.9m	Y-(G+Q+E)	90.605	34.03	-23.17	233.3	0.0108; 41.72;
	Sx =1.000	X-(G-E)	63.252	-6.50	14.98	233.3	0.0108; 41.72;
A4 ò	Sy =1.000	Y-(G-E)	64.482	24.17	-14.35	233.3	0.0108; 41.72; aAs/Ac=0.0217
S104	Bx=70	X-(G+Q)	316.461	-7.20	31.48	233.3	0.0108; 41.72; 11ø22
	By=0	X-(G+Q+E)	229.584	-6.03	26.03	233.3	0.0108; 41.72; ø10/20/10(etriye)
I:7		Y-(G+Q)	316.461	22.70	-13.90	233.3	0.0108; 41.72; Cx:1 Cy:1
J:0	Hk=5.776m	Y-(G+Q+E)	219.607	16.39	-12.80	233.3	0.0108; 41.72; 28ø8/20 (zýmba etr.)
	Sx =1.000	X-(G-E)	144.061	-1.73	4.21	233.3	0.0108; 41.72;
A4 ò	Sy =1.000	Y-(G-E)	146.529	11.18	-1.46	233.3	0.0108; 41.72; aAs/Ac=0.0217
S205	Bx=70	X-(G+Q)	79.788	39.80	-37.07	233.3	0.0108; 41.72; 11ø22
	By=0	X-(G+Q+E)	54.266	29.23	-33.25	233.3	0.0108; 41.72; ø8/20/10(etriye)
I:10		Y-(G+Q)	79.788	-35.71	39.86	233.3	0.0108; 41.72; Cx:1 Cy:1
J:8	Hk=5.9m	Y-(G+Q+E)	60.147	-26.46	35.32	233.3	0.0108; 41.72;
	Sx =1.000	X-(G-E)	39.480	19.05	-6.84	233.3	0.0108; 41.72;
A4 ò	Sy =1.000	Y-(G-E)	40.100	-14.23	14.21	233.3	0.0108; 41.72; aAs/Ac=0.0217
S105	Bx=70	X-(G+Q)	182.613	33.23	-23.08	233.3	0.0108; 41.72; 11ø22
	By=0	X-(G+Q+E)	136.796	-43.40	24.28	233.3	0.0108; 41.72; ø12/10/9(etriye)
I:8		Y-(G+Q)	182.613	-20.62	37.82	233.3	0.0108; 41.72; Cx:1 Cy:1
J:0	Hk=1.053m	Y-(G+Q+E)	129.915	20.77	-59.06	233.3	0.0108; 41.72;
	Sx =1.000	X-(G-E)	80.684	8.23	-12.17	233.3	0.0108; 41.72;
A4 ò	Sy =1.000	Y-(G-E)	82.060	-7.91	18.35	233.3	0.0108; 41.72; aAs/Ac=0.0217
S206	Bx=70	X-(G+Q)	79.330	39.79	37.07	233.3	0.0108; 41.72; 11ø22
	By=0	X-(G+Q+E)	60.459	29.23	34.88	233.3	0.0108; 41.72; ø8/20/10(etriye)
I:12		Y-(G+Q)	79.330	37.07	39.79	233.3	0.0108; 41.72; Cx:1 Cy:1
J:11	Hk=5.9m	Y-(G+Q+E)	59.801	27.33	35.26	233.3	0.0108; 41.72;
	Sx =1.000	X-(G-E)	39.207	15.62	7.21	233.3	0.0108; 41.72;
A4 ò	Sy =1.000	Y-(G-E)	39.827	14.22	14.21	233.3	0.0108; 41.72; aAs/Ac=0.0217
S106	Bx=70	X-(G+Q)	181.698	37.19	22.29	233.3	0.0108; 41.72; 11ø22
	By=0	X-(G+Q+E)	129.508	-43.24	-24.31	233.3	0.0108; 41.72; ø12/10/9(etriye)
I:11		Y-(G+Q)	181.698	22.29	37.19	233.3	0.0108; 41.72; Cx:1 Cy:1
J:0	Hk=1.053m	Y-(G+Q+E)	122.905	-20.93	-58.90	233.3	0.0108; 41.72;
	Sx =1.000	X-(G-E)	80.139	19.56	12.45	233.3	0.0108; 41.72;
A4 ò	Sy =1.000	Y-(G-E)	81.511	7.94	18.35	233.3	0.0108; 41.72; aAs/Ac=0.0217

Sx, Sy : Kolon Moment büyütm katsayýsý  
 Cx , Cy : Güçlü kolon Moment büyütm katsayýsý

Ck : Kirib üstüne oturan kolonlarýn Dinamik Etki çarpaný  
A4 : (Ba=Bax+0.3\*Bay, Ba=0.3\*Bax+Bay)

:  
PROJE :

26-10-2022 SAYFA: 41  
(KONYA AÇIK HAVA MÜZESİ.ST4)

**GÜÇLÜ KOLONLARIN, KAT KESME GÜVENLİDİĞİ (t)**

Kat	Dyf	Vsx	Vkx	ax	Vsy	Vky	ay
1	1	40.12	40.12	1.00	46.28	46.28	1.00
2	2	18.21	18.21	1.00	17.07	17.07	1.00

Vs/Vk > .70 KOPULU SAĞLANMAKTADIR. GÜÇLÜ KOLONLAR, (1/â) İLE ÇARPILMIŞTIR.

**GÜÇLÜ KOLON KONTROLÜ (tm)**

Yön	Kolon	Mrc	Kirip	Mrb	AÇIKLAMA
+X	S201 (53.4)	53.4	K202 (17.6)	21.11	Kolon üst kat kopulu
-X	S201 (53.4)	53.4	K202 (37.33)	44.8	Kolon üst kat kopulu
+Y	S201 (53.29)	53.29	K212 (13.24)	15.89	Kolon üst kat kopulu
-Y	S201 (53.29)	53.29	K212 (37.75)	45.3	Kolon üst kat kopulu
+X	S201 (53.4)+S101 (66.68)	120.08	K102 (20.24)	24.29	Nd < 0,10.Ac.fck kopulu
-X	S201 (53.4)+S101 (66.68)	120.08	K102 (39.02)	46.83	Nd < 0,10.Ac.fck kopulu
+Y	S201 (53.29)+S101 (66.42)	119.72	K112 (19.13)	22.96	Nd < 0,10.Ac.fck kopulu
-Y	S201 (53.29)+S101 (66.42)	119.72	K112 (39.59)	47.51	Nd < 0,10.Ac.fck kopulu
+X	S202 (53.95)	53.95	K202 (37.33)	44.8	Kolon üst kat kopulu
-X	S202 (53.95)	53.95	K202 (17.6)	21.11	Kolon üst kat kopulu
+Y	S202 (52.82)	52.82	K216 (13.02)	15.63	Kolon üst kat kopulu
-Y	S202 (52.82)	52.82	K216 (37.63)	45.16	Kolon üst kat kopulu
+X	S202 (53.95)+S102 (67.71)	121.67	K102 (39.02)	46.83	Nd < 0,10.Ac.fck kopulu
-X	S202 (53.95)+S102 (67.71)	121.67	K102 (20.24)	24.29	Nd < 0,10.Ac.fck kopulu
+Y	S202 (52.82)+S102 (65.86)	118.68	K116 (19.2)	23.04	Nd < 0,10.Ac.fck kopulu
-Y	S202 (52.82)+S102 (65.86)	118.68	K116 (38.97)	46.76	Nd < 0,10.Ac.fck kopulu
+X	S203 (61.08)	61.08	K205 (74.76)	89.71	Kolon üst kat kopulu
-X	S203 (61.08)	61.08	K205 (222.79)	267.35	Kolon üst kat kopulu
+Y	S203 (60.68)	60.68	K211 (21.03)+K212 (48.46)	83.38	Kolon üst kat kopulu
-Y	S203 (60.68)	60.68	K211 (50.35)+K212 (13.24)	76.3	Kolon üst kat kopulu
+X	S203 (61.08)+S103 (77.79)	138.87	K105 (36.22)	43.47	0
-X	S203 (61.08)+S103 (77.79)	138.87	K105 (71.4)	85.68	0
+Y	S203 (60.68)+S103 (77.06)	137.74	K111 (21.03)+K112 (70.83)	110.23	0
-Y	S203 (60.68)+S103 (77.06)	137.74	K111 (73.59)+K112 (19.13)	111.26	0
+X	S204 (61.71)	61.71	K205 (222.79)	267.35	Kolon üst kat kopulu
-X	S204 (61.71)	61.71	K205 (74.76)	89.71	Kolon üst kat kopulu
+Y	S204 (60.67)	60.67	K215 (21.1)+K216 (49.06)	84.19	Kolon üst kat kopulu
-Y	S204 (60.67)	60.67	K215 (50.96)+K216 (13.02)	76.78	Kolon üst kat kopulu
+X	S204 (61.71)+S104 (77.68)	139.39	K105 (71.4)	85.68	0
-X	S204 (61.71)+S104 (77.68)	139.39	K105 (36.22)	43.47	0
+Y	S204 (60.67)+S104 (76.92)	137.59	K115 (22.4)+K116 (70.77)	111.8	0
-Y	S204 (60.67)+S104 (76.92)	137.59	K115 (73.51)+K116 (19.2)	111.26	0
+X	S205 (53.92)	53.92	K208 (19.87)	23.85	Kolon üst kat kopulu
-X	S205 (53.92)	53.92	K208 (38.51)	46.21	Kolon üst kat kopulu
+Y	S205 (55.02)	55.02	K211 (38.79)	46.55	Kolon üst kat kopulu
-Y	S205 (55.02)	55.02	K211 (21.03)	25.23	Kolon üst kat kopulu
+X	S205 (53.92)+S105 (67.28)	121.2	K108 (21.03)	25.23	Nd < 0,10.Ac.fck kopulu
-X	S205 (53.92)+S105 (67.28)	121.2	K108 (40.54)	48.65	Nd < 0,10.Ac.fck kopulu
+Y	S205 (55.02)+S105 (66.3)	121.32	K111 (41.44)	49.73	Nd < 0,10.Ac.fck kopulu
-Y	S205 (55.02)+S105 (66.3)	121.32	K111 (21.03)	25.23	Nd < 0,10.Ac.fck kopulu
+X	S206 (55.08)	55.08	K208 (38.51)	46.21	Kolon üst kat kopulu
-X	S206 (55.08)	55.08	K208 (19.87)	23.85	Kolon üst kat kopulu
+Y	S206 (54.95)	54.95	K215 (38.94)	46.72	Kolon üst kat kopulu
-Y	S206 (54.95)	54.95	K215 (21.1)	25.32	Kolon üst kat kopulu
+X	S206 (55.08)+S106 (66.24)	121.32	K108 (40.54)	48.65	Nd < 0,10.Ac.fck kopulu
-X	S206 (55.08)+S106 (66.24)	121.32	K108 (21.03)	25.23	Nd < 0,10.Ac.fck kopulu
+Y	S206 (54.95)+S106 (65.29)	120.25	K115 (41.95)	50.34	Nd < 0,10.Ac.fck kopulu
-Y	S206 (54.95)+S106 (65.29)	120.25	K115 (22.4)	26.88	Nd < 0,10.Ac.fck kopulu

:  
PROJE :

(KONYA AÇIK HAVA MÜZESİ ST4)

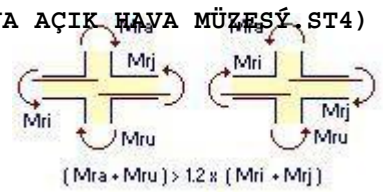

**KUPATILMIS KOLON KONTROLU**

TBDY 2018'e göre yapılmıştır.  
 $V_e = 1.25 f_{yk} (A_{s1} + A_{s2}) - V_{kol} < V_{max} = (1.7 + 1.0) b_j hc \hat{u}fck$   
 Konsol kirişler, kupatılımyıp kolon kontrolunda dikkate alınmamıştır.

Perdelerde kupatılımyıp kolon kontrolu yapılmaz. Sadece kolonlarda yapıılır.

Kolon	Bx/By	bw1	bw2	bj	Asu1	Asa1	Asu2	Asa2	Ast	Vkol	Ve	Vmax	ACIKLAMA
iS201	x	70	0.0	0.0	0.0	0.0	0.0	0.0	0.0	0.0	0.0	0.0	V=1,0·bj·hc·ûfck
iS201	y	70	0.0	0.0	0.0	0.0	0.0	0.0	0.0	0.0	0.0	0.0	δ
iS101	x	70	0.0	0.0	0.0	0.0	0.0	0.0	0.0	0.0	2.3	0.0	V=1,0·bj·hc·ûfck
iS101	y	70	0.0	0.0	0.0	0.0	0.0	0.0	0.0	0.0	0.7	0.0	δ
iS202	x	70	0.0	0.0	0.0	0.0	0.0	0.0	0.0	0.0	0.0	0.0	V=1,0·bj·hc·ûfck
iS202	y	70	0.0	0.0	0.0	0.0	0.0	0.0	0.0	0.0	0.0	0.0	δ
iS102	x	70	0.0	0.0	0.0	0.0	0.0	0.0	0.0	0.0	2.3	0.0	V=1,0·bj·hc·ûfck
iS102	y	70	0.0	0.0	0.0	0.0	0.0	0.0	0.0	0.0	0.7	0.0	δ
iS203	x	70	0.0	0.0	0.0	0.0	0.0	0.0	0.0	0.0	0.0	0.0	V=1,0·bj·hc·ûfck
iS203	y	70	0.0	0.0	0.0	0.0	0.0	0.0	0.0	0.0	0.0	0.0	δ
iS103	x	70	0.0	0.0	0.0	0.0	0.0	0.0	0.0	0.0	0.6	0.0	V=1,0·bj·hc·ûfck
iS103	y	70	0.0	0.0	0.0	0.0	0.0	0.0	0.0	0.0	0.5	0.0	δ
iS204	x	70	0.0	0.0	0.0	0.0	0.0	0.0	0.0	0.0	0.0	0.0	V=1,0·bj·hc·ûfck
iS204	y	70	0.0	0.0	0.0	0.0	0.0	0.0	0.0	0.0	0.0	0.0	δ
iS104	x	70	0.0	0.0	0.0	0.0	0.0	0.0	0.0	0.0	0.6	0.0	V=1,0·bj·hc·ûfck
iS104	y	70	0.0	0.0	0.0	0.0	0.0	0.0	0.0	0.0	0.5	0.0	δ
iS205	x	70	0.0	0.0	0.0	0.0	0.0	0.0	0.0	0.0	0.0	0.0	V=1,0·bj·hc·ûfck
iS205	y	70	0.0	0.0	0.0	0.0	0.0	0.0	0.0	0.0	0.0	0.0	δ
iS105	x	70	0.0	0.0	0.0	0.0	0.0	0.0	0.0	0.0	2.3	0.0	V=1,0·bj·hc·ûfck
iS105	y	70	0.0	0.0	0.0	0.0	0.0	0.0	0.0	0.0	2.2	0.0	δ
iS206	x	70	0.0	0.0	0.0	0.0	0.0	0.0	0.0	0.0	0.0	0.0	V=1,0·bj·hc·ûfck
iS206	y	70	0.0	0.0	0.0	0.0	0.0	0.0	0.0	0.0	0.0	0.0	δ
iS106	x	70	0.0	0.0	0.0	0.0	0.0	0.0	0.0	0.0	2.3	0.0	V=1,0·bj·hc·ûfck
iS106	y	70	0.0	0.0	0.0	0.0	0.0	0.0	0.0	0.0	2.1	0.0	δ

**KOLONLARIN KESME DAYANIM KONTROLÜ**

$V_w = (A_{sw}/s) \cdot f_{ywd} \cdot d$  ,  $V_c = 0.65 \cdot f_{ctd} \cdot A_c$  ,  $V_r = 0.8 \cdot V_{cr} + V_w$  ,  $0.85 \times A_c \times f_{ck} \leq V_d$  (t)

$f_{ctd} = 13.79$  (kg/cm<sup>2</sup>)

Kolon		Asw/s	Vw	Vcr	Vd	Vr=0.8 Vcr+ Vw
iS201	x	0.1005	25.688	34.506	12.787	53.293
iS201	y	0.1005	25.688	34.506	10.132	53.293
iS101	x	0.1005	25.688	34.506	7.201	53.293
iS101	y	0.1005	25.688	34.506	6.641	53.293
iS202	x	0.1005	25.688	34.506	12.784	53.293
iS202	y	0.1005	25.688	34.506	10.129	53.293
iS102	x	0.1005	25.688	34.506	7.274	53.293
iS102	y	0.1005	25.688	34.506	6.713	53.293
iS203	x	0.1005	25.688	34.506	19.442	53.293
iS203	y	0.1005	25.688	34.506	9.345	53.293
iS103	x	0.1570	40.137	34.506	9.004	67.742
iS103	y	0.1570	40.137	34.506	5.934	67.742
iS204	x	0.1005	25.688	34.506	19.447	53.293
iS204	y	0.1005	25.688	34.506	9.344	53.293
iS104	x	0.1570	40.137	34.506	9.151	67.742
iS104	y	0.1570	40.137	34.506	6.078	67.742
iS205	x	0.1005	25.688	34.506	12.041	53.293
iS205	y	0.1005	25.688	34.506	13.325	53.293
iS105	x	0.2512	64.220	34.506	38.890	91.825
iS105	y	0.2512	64.220	34.506	37.931	91.825
iS206	x	0.1005	25.688	34.506	12.040	53.293
iS206	y	0.1005	25.688	34.506	13.323	53.293
iS106	x	0.2512	64.220	34.506	39.170	91.825
iS106	y	0.2512	64.220	34.506	37.925	91.825

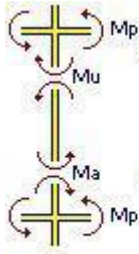

$$M_u = \frac{M_{hu}}{M_{hu} + M_{ha}} \sum M_p$$

$$V_e = \frac{M_u + M_a}{L_n}$$

$$M_a = \frac{M_{ha}}{M_{hu} + M_{ha}} \sum M_p$$

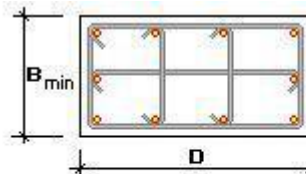

Ln : Kolon girişler arası serbest yüksekligi  
 Hk : Kolon kat yüksekligi  
 Fk : Kolon boyunca etriye alan toplamı  
 Letr : hesap doğrultusundaki etriye boylarının toplamı

$$g = \frac{F_k \cdot L_{etr}}{A_c \cdot H_k} \geq 0,0025$$

$$V_r = 0,65 \cdot A_c \cdot f_{ctd} + g \cdot A_c \cdot f_{yd} > V_e$$

Dikdörtgen kolonlarda  $L_{etr} \geq D$   $A_c = B \cdot D$

$$g = \frac{F_k \cdot D}{B \cdot D \cdot H_k} = \frac{F_k}{B \cdot H_k}$$

$$V_r = 0,65 \cdot B \cdot D \cdot f_{ctd} + F_k \cdot D \cdot f_{yd} / H_k > V_e$$

$V_e > V_d (G+Q+D.E, Bax+0.3 \times Bay) \Rightarrow V_e = V_d (G+Q+D.E, Bax+0.3 \times Bay)$   
 10cm'den genip tuöla duvarlar, kesme güvenliöinde dikkäte alýnmýptýr.

**KOLONLARIN KESME GUVENLYK KONTROLU**

Kolon	+X			-X			+Y			-Y		
	Mp	Mc	Mr	Mp	Mc	Mr	Mp	Mc	Mr	Mp	Mc	Mr
S201	20.30	0.00	61.64	-43.21	0.00	61.64	15.26	0.00	61.51	-43.70	0.00	61.51
LnX= 5.50	61.64			61.64			61.51		61.51			61.51
Lny= 5.50	23.35	61.64	17.72	-45.19	61.64	34.29	22.07	61.51	15.41	-45.85	61.51	32.02
	77.80			77.80			77.47		77.47			77.47
	Ve= 14.43 Vr= 53.28 ð; Ve= 17.44 Vr= 53.28 ð; Ve= 13.99 Vr= 53.28 ð; Ve= 15.86 Vr= 53.28 ð;											
S101	23.35	61.64	6.28	-45.19	61.64	12.15	22.07	61.51	6.82	-45.85	61.51	14.17
LnX= 5.12	61.64			61.64			61.51		61.51			61.51
Lny= 5.12	0.00	61.64	77.80	0.00	61.64	77.80	0.00	61.51	77.47	0.00	61.51	77.47
	0.00			0.00			0.00		0.00			0.00
	Ve= 11.77 Vr= 53.28 ð; Ve= 11.77 Vr= 53.28 ð; Ve= 7.46 Vr= 53.28 ð; Ve= 7.46 Vr= 53.28 ð;											
S202	43.21	0.00	62.32	-20.30	0.00	62.32	15.01	0.00	60.93	-43.57	0.00	60.93
LnX= 5.50	62.32			62.32			60.93		60.93			60.93
Lny= 5.50	45.19	62.32	34.29	-23.35	62.32	17.72	22.16	60.93	15.47	-45.12	60.93	31.51
	79.12			79.12			76.75		76.75			76.75
	Ve= 17.56 Vr= 53.28 ð; Ve= 14.55 Vr= 53.28 ð; Ve= 13.89 Vr= 53.28 ð; Ve= 15.85 Vr= 53.28 ð;											
S102	45.19	62.32	12.15	-23.35	62.32	6.28	22.16	60.93	6.85	-45.12	60.93	13.95
LnX= 5.12	62.32			62.32			60.93		60.93			60.93
Lny= 5.12	0.00	62.32	79.12	0.00	62.32	79.12	0.00	60.93	76.75	0.00	60.93	76.75
	0.00			0.00			0.00		0.00			0.00
	Ve= 11.84 Vr= 53.28 ð; Ve= 11.84 Vr= 53.28 ð; Ve= 7.26 Vr= 53.28 ð; Ve= 7.26 Vr= 53.28 ð;											
S203	86.16	0.00	70.63	-257.9	0.00	70.63	80.48	0.00	70.11	-73.66	0.00	70.11
LnX= 5.20	70.63			70.63			70.11		70.11			70.11
Lny= 5.50	41.80	70.63	40.29	-82.70	70.63	70.63	106.80	70.11	70.11	-107.8	70.11	70.11
	93.20			93.20			91.76		91.76			91.76
	Ve= 21.33 Vr= 53.28 ð; Ve= 25.31 Vr= 53.28 ð; Ve= 15.68 Vr= 53.28 ð; Ve= 15.68 Vr= 53.28 ð;											
S103	41.80	70.63	3.78	-82.70	70.63	7.48	106.80	24.20	70.11	-107.8	70.11	24.43
LnX= 5.38	70.63			70.63			70.11		70.11			70.11
Lny= 5.38	0.00	70.63	93.20	0.00	70.63	93.20	0.00	70.11	91.76	0.00	70.11	91.76
	0.00			0.00			0.00		0.00			0.00
	Ve= 8.74 Vr= 67.73 ð; Ve= 8.74 Vr= 67.73 ð; Ve= 4.88 Vr= 67.73 ð; Ve= 4.88 Vr= 67.73 ð;											
S204	257.94	0.00	71.43	-86.16	0.00	71.43	81.27	0.00	70.10	-74.13	0.00	70.10
LnX= 5.20	71.43			71.43			70.10		70.10			70.10
Lny= 5.50	82.70	71.43	71.43	-41.80	71.43	40.28	108.32	70.10	70.10	-107.8	70.10	70.10
	92.98			92.98			91.50		91.50			91.50
	Ve= 25.31 Vr= 53.28 ð; Ve= 21.48 Vr= 53.28 ð; Ve= 15.51 Vr= 53.28 ð; Ve= 15.51 Vr= 53.28 ð;											
S104	82.70	71.43	7.49	-41.80	71.43	3.78	108.32	24.58	70.10	-107.8	70.10	24.46
LnX= 5.38	71.43			71.43			70.10		70.10			70.10
Lny= 5.38	0.00	71.43	92.98	0.00	71.43	92.98	0.00	70.10	91.50	0.00	70.10	91.50
	0.00			0.00			0.00		0.00			0.00
	Ve= 8.74 Vr= 67.73 ð; Ve= 8.74 Vr= 67.73 ð; Ve= 5.20 Vr= 67.73 ð; Ve= 5.20 Vr= 67.73 ð;											
S205	22.93	0.00	62.28	-44.57	0.00	62.28	44.90	0.00	63.63	-24.26	0.00	63.63
LnX= 5.50	62.28			62.28			63.63		63.63			63.63
Lny= 5.50	24.26	62.28	17.52	-46.95	62.28	33.90	48.00	35.06	63.63	-24.26	63.63	17.72
	78.57			78.57			77.31		77.31			77.31
	Ve= 14.51 Vr= 53.28 ð; Ve= 17.49 Vr= 53.28 ð; Ve= 17.47 Vr= 53.28 ð; Ve= 14.79 Vr= 53.28 ð;											
S105	24.26	62.28	7.52	-46.95	62.28	14.55	48.00	14.12	63.63	-24.26	63.63	7.14
LnX= 0.65	62.28			62.28			63.63		63.63			63.63
Lny= 0.65	0.00	62.28	78.57	0.00	62.28	78.57	0.00	63.63	77.31	0.00	63.63	77.31
	0.00			0.00			0.00		0.00			0.00
	Ve= 84.16 Vr= 91.81 ð; Ve= 84.16 Vr= 91.81 ð; Ve= 87.48 Vr= 91.81 ð; Ve= 87.48 Vr= 91.81 ð;											

KOLONLARIN KESME GUVENLYK KONTROLU

Ü															
	+X			-X			+Y			-Y					
Kolon	Mp	Mc	Mr	Mp	Mc	Mr	Mp	Mc	Mr	Mp	Mc	Mr			
S206	0.00			0.00			0.00			0.00					
iLnX= 5.50	44.57 Å	Mu= 63.70		-22.93 Å	Mu= 63.70		45.07 Å	Mu= 63.55		-24.35 Å	Mu= 63.55				
iLnY= 5.50	46.95 Å	Ma= 33.90		-24.26 Å	Ma= 17.52		48.59 Å	Ma= 35.47		-25.86 Å	Ma= 18.87				
	77.24			77.24			76.02			76.02					
	Ve= 17.74	Vr= 53.28	ò	Ve= 14.77	Vr= 53.28	ò	Ve= 17.46	Vr= 53.28	ò	Ve= 14.99	Vr= 53.28	ò			
Ä															
S106	63.70			63.70			63.55			63.55					
iLnX= 0.65	46.95 Å	Mu= 14.55		-24.26 Å	Mu= 7.52		48.59 Å	Mu= 14.32		-25.86 Å	Mu= 7.62				
iLnY= 0.65	0.00 Å	Ma= 77.24		0.00 Å	Ma= 77.24		0.00 Å	Ma= 76.02		0.00 Å	Ma= 76.02				
	77.24			77.24			76.02			76.02					
	Ve= 84.38	Vr= 91.81	ò	Ve= 84.38	Vr= 91.81	ò	Ve= 87.58	Vr= 91.81	ò	Ve= 87.58	Vr= 91.81	ò			
Û															

PROJE :

(KONYA AÇIK HAVA MÜZESİ.ST4)

## TEMELLERE GELEN KOLON YÜKLERÝ

S101	N	Alt Mx	Alt My	Deprem+X	Deprem-X	Deprem+Y	Deprem-Y	Rüzgar X	Rüzgar Y	Zemin
	106.20	-5.00	-4.67	-3.35	3.87	-2.34	2.08	2.08	-2.17	0.00
	22.53	-2.98	-2.73	-3.35	3.87	-2.34	2.08	2.08	-2.17	0.00
	(azaltma)	-0.46	-0.53	-0.46	-0.53	-0.46	-0.53	-0.46	-0.53	0.00
	Nq=	-2.52	-2.19	-2.52	-2.19	-2.52	-2.19	-2.52	-2.19	0.00
	22.53xI.000 =	-0.57	-0.34	-0.57	-0.34	-0.57	-0.34	-0.57	-0.34	0.00
	-22.53)	-3.32	-2.78	-3.32	-2.78	-3.32	-2.78	-3.32	-2.78	0.00
	Alt Mx	10.15	-12.12	10.15	-12.12	10.15	-12.12	10.15	-12.12	0.00
	Alt My	-2.65	3.01	-2.65	3.01	-2.65	3.01	-2.65	3.01	0.00

S102	N	Alt Mx	Alt My	Deprem+X	Deprem-X	Deprem+Y	Deprem-Y	Rüzgar X	Rüzgar Y	Zemin
	106.40	5.00	-4.67	3.35	-3.87	-2.08	2.35	2.17	-0.83	0.00
	22.53	2.98	-2.73	3.35	-3.87	-2.08	2.35	2.17	-0.83	0.00
	(azaltma)	0.46	-0.53	0.46	-0.53	0.46	-0.53	0.46	-0.53	0.00
	Nq=	2.52	-2.19	2.52	-2.19	2.52	-2.19	2.52	-2.19	0.00
	22.53xI.000 =	0.17	-0.37	0.17	-0.37	0.17	-0.37	0.17	-0.37	0.00
	-22.53)	3.36	-1.96	3.36	-1.96	3.36	-1.96	3.36	-1.96	0.00
	Alt Mx	10.15	-12.12	10.15	-12.12	10.15	-12.12	10.15	-12.12	0.00
	Alt My	2.65	-3.01	2.65	-3.01	2.65	-3.01	2.65	-3.01	0.00

S103	N	Alt Mx	Alt My	Deprem+X	Deprem-X	Deprem+Y	Deprem-Y	Rüzgar X	Rüzgar Y	Zemin
	177.28	-6.96	-3.35	4.46	-5.55	0.28	0.28	1.69	0.12	0.00
	43.96	-4.43	-1.31	4.46	-5.55	0.28	0.28	1.69	0.12	0.00
	(azaltma)	-2.38	-2.58	-2.38	-2.58	-2.38	-2.58	-2.38	-2.58	0.00
	Nq=	-2.05	1.27	-2.05	1.27	-2.05	1.27	-2.05	1.27	0.00
	43.96xI.000 =	-2.21	-2.19	-2.21	-2.19	-2.21	-2.19	-2.21	-2.19	0.00
	-43.96)	-1.97	1.94	-1.97	1.94	-1.97	1.94	-1.97	1.94	0.00
	Alt Mx	4.46	-5.55	4.46	-5.55	4.46	-5.55	4.46	-5.55	0.00
	Alt My	-2.69	3.04	-2.69	3.04	-2.69	3.04	-2.69	3.04	0.00

S104	N	Alt Mx	Alt My	Deprem+X	Deprem-X	Deprem+Y	Deprem-Y	Rüzgar X	Rüzgar Y	Zemin
	175.80	6.97	-3.35	4.03	-4.29	0.28	-0.16	2.59	0.12	0.00
	43.96	4.43	-1.31	4.03	-4.29	0.28	-0.16	2.59	0.12	0.00
	(azaltma)	2.38	-2.58	2.38	-2.58	2.38	-2.58	2.38	-2.58	0.00
	Nq=	2.05	1.27	2.05	1.27	2.05	1.27	2.05	1.27	0.00
	43.96xI.000 =	1.78	-3.23	1.78	-3.23	1.78	-3.23	1.78	-3.23	0.00
	-43.96)	2.10	1.41	2.10	1.41	2.10	1.41	2.10	1.41	0.00
	Alt Mx	4.46	-5.55	4.46	-5.55	4.46	-5.55	4.46	-5.55	0.00
	Alt My	2.69	-3.04	2.69	-3.04	2.69	-3.04	2.69	-3.04	0.00

S105	N	Alt Mx	Alt My	Deprem+X	Deprem-X	Deprem+Y	Deprem-Y	Rüzgar X	Rüzgar Y	Zemin
	100.83	0.40	-14.33	-3.42	3.18	-1.14	-0.01	11.05	-0.13	0.00
	25.91	0.59	-6.49	-3.42	3.18	-1.14	-0.01	11.05	-0.13	0.00
	(azaltma)	0.65	-6.43	0.65	-6.43	0.65	-6.43	0.65	-6.43	0.00
	Nq=	-0.06	-0.06	-0.06	-0.06	-0.06	-0.06	-0.06	-0.06	0.00
	25.91xI.000 =	1.03	-5.79	1.03	-5.79	1.03	-5.79	1.03	-5.79	0.00
	-25.91)	-0.04	0.33	-0.04	0.33	-0.04	0.33	-0.04	0.33	0.00
	Alt Mx	22.48	-20.15	22.48	-20.15	22.48	-20.15	22.48	-20.15	0.00
	Alt My	-22.34	28.28	-22.34	28.28	-22.34	28.28	-22.34	28.28	0.00

S106	N	Alt Mx	Alt My	Deprem+X	Deprem-X	Deprem+Y	Deprem-Y	Rüzgar X	Rüzgar Y	Zemin
	100.17	-0.41	-14.33	3.42	-3.18	1.93	-2.05	11.05	0.13	0.00
	25.91	-0.59	-6.49	3.42	-3.18	1.93	-2.05	11.05	0.13	0.00
	(azaltma)	-0.65	-6.43	-0.65	-6.43	-0.65	-6.43	-0.65	-6.43	0.00
	Nq=	0.06	-0.06	0.06	-0.06	0.06	-0.06	0.06	-0.06	0.00
	25.91xI.000 =	-0.35	0.02	-0.35	0.02	-0.35	0.02	-0.35	0.02	0.00
	-25.91)	0.23	-7.38	0.23	-7.38	0.23	-7.38	0.23	-7.38	0.00
	Alt Mx	22.48	-20.15	22.48	-20.15	22.48	-20.15	22.48	-20.15	0.00
	Alt My	22.34	-28.28	22.34	-28.28	22.34	-28.28	22.34	-28.28	0.00

TOPLAM  $\Delta N_g = 766.68$   $\Delta N_q = 184.80$   $\Delta N_{qf} = 184.80$ 

## Temellerin kayma kontrolü TBDY2018-16.8.4

 $\Delta = 30.0$   $K_{pd} = 1.5$ 

Ü

Kat ; Hi ; Lx ; Ly ; Hi · Kpd · Lx ; Hi · Kpd · Ly ;

TEMEL ; 0.70 ; 35.00 ; 35.00 ; 46.30 ; 46.30 ;

RpX = 46.30/1.4 = 33.07 , RpY = 46.30/1.4 = 33.07

VeX = 40.12 < Wg · tan $\delta$  + 0.3 · RptX = 966.5 · 0.5 + 0.3 · 33.07 = 493.17VeY = 46.28 < Wg · tan $\delta$  + 0.3 · RptY = 966.5 · 0.5 + 0.3 · 33.07 = 493.17

Temellerin kayma kontrolü yeterlidir





T4 TEKİL TEMELİ S104

Kombinasyon	N	Mx	My	sol Gz	sağ Gz	üst Gz	alt Gz	
GGGGG	180.51	0.00	0.00	1.53	1.53	1.53	1.53	Bx = 130 cm
QQQQQ	43.96	0.00	0.00	0.37	0.37	0.37	0.37	By = 130 cm
Q Q Q	22.39	0.00	0.00	0.19	0.19	0.19	0.19	D = 70 cm
Q Q Q	21.57	0.00	0.00	0.18	0.18	0.18	0.18	I = 4
QQ QQ	31.32	0.00	0.00	0.27	0.27	0.27	0.27	Ko = 1000 t/m <sup>3</sup>
QQ QQ	22.89	0.00	0.00	0.19	0.19	0.19	0.19	qzem= 21 t/m <sup>2</sup>
Q QQ Q	33.72	0.00	0.00	0.29	0.29	0.29	0.29	
Deprem+X	6.05	0.00	0.00	0.05	0.05	0.05	0.05	Gz = 0.00 t/m <sup>2</sup>
Deprem-X	-6.43	0.00	0.00	-0.05	-0.05	-0.05	-0.05	
Deprem+Y	0.42	0.00	0.00	0.00	0.00	0.00	0.00	g = 4.71 t/m
Deprem-Y	-0.23	0.00	0.00	0.00	0.00	0.00	0.00	
Rüzgar X	2.59	0.00	0.00	0.02	0.02	0.02	0.02	
Rüzgar Y	0.12	0.00	0.00	0.00	0.00	0.00	0.00	

PROJE :

(KONYA AÇIK HAVA MÜZESİ.ST4)

T5 TEKİL TEMELİ S105

Kombinasyon	N	Mx	My	sol Gz	sağ Gz	üst Gz	alt Gz	
GGGGG	104.26	0.00	0.00	1.15	1.15	1.15	1.15	Bx = 120 cm
QQQQQ	25.91	0.00	0.00	0.28	0.28	0.28	0.28	By = 120 cm
Q Q Q	14.99	0.00	0.00	0.16	0.16	0.16	0.16	D = 60 cm
Q Q Q	10.92	0.00	0.00	0.12	0.12	0.12	0.12	I = 5
QQ QQ	21.81	0.00	0.00	0.24	0.24	0.24	0.24	Ko = 1000 t/m <sup>3</sup>
QQ QQ	11.94	0.00	0.00	0.13	0.13	0.13	0.13	qzem= 21 t/m <sup>2</sup>
Q QQ Q	18.07	0.00	0.00	0.20	0.20	0.20	0.20	
Deprem+X	-5.14	0.00	0.00	-0.06	-0.06	-0.06	-0.06	Gz = 0.00 t/m <sup>2</sup>
Deprem-X	4.77	0.00	0.00	0.05	0.05	0.05	0.05	
Deprem+Y	3.07	0.00	0.00	0.03	0.03	0.03	0.03	g = 3.43 t/m
Deprem-Y	-2.90	0.00	0.00	-0.03	-0.03	-0.03	-0.03	
Rüzgar X	-1.97	0.00	0.00	-0.02	-0.02	-0.02	-0.02	
Rüzgar Y	0.70	0.00	0.00	0.01	0.01	0.01	0.01	

T6 TEKİL TEMELİ S106

Kombinasyon	N	Mx	My	sol Gz	sağ Gz	üst Gz	alt Gz	
GGGGG	103.60	0.00	0.00	1.14	1.14	1.14	1.14	Bx = 120 cm
QQQQQ	25.91	0.00	0.00	0.28	0.28	0.28	0.28	By = 120 cm
Q_Q_Q	14.99	0.00	0.00	0.16	0.16	0.16	0.16	D = 60 cm
Q_Q_Q	10.92	0.00	0.00	0.12	0.12	0.12	0.12	I = 6
QQ_QQ	23.02	0.00	0.00	0.25	0.25	0.25	0.25	Ko = 1000 t/m <sup>3</sup>
QQ_QQ	14.06	0.00	0.00	0.15	0.15	0.15	0.15	qzem= 21 t/m <sup>2</sup>
Q_QQ_Q	14.74	0.00	0.00	0.16	0.16	0.16	0.16	
Deprem+X	5.14	0.00	0.00	0.06	0.06	0.06	0.06	Gz = 0.00 t/m <sup>2</sup>
Deprem-X	-4.77	0.00	0.00	-0.05	-0.05	-0.05	-0.05	
Deprem+Y	2.90	0.00	0.00	0.03	0.03	0.03	0.03	g = 3.43 t/m
Deprem-Y	-3.08	0.00	0.00	-0.03	-0.03	-0.03	-0.03	
Rüzgar X	1.97	0.00	0.00	0.02	0.02	0.02	0.02	
Rüzgar Y	0.70	0.00	0.00	0.01	0.01	0.01	0.01	

PROJE :

**TEMEL BETONARME HESAP SONUÇLARI**

**T1 TEKÝL TEMELÝ BETONARME SONUÇLARI - S101**

i	x yönü i	y yönü i	I= 1	D= 60 cm	Bx= 120 cm	By= 120 cm
iM max (tm) i	0.00	0.00	Ko= 1000 t/m <sup>3</sup>	qzem= 21 t/m <sup>2</sup>		
iM amp. (tm) i	0.00	0.00	qzx = 0.000 t/m <sup>2</sup>	qzy = 0.000 t/m <sup>2</sup>		
ifcd (kg/cm <sup>2</sup> ) i	0.00	0.00	Vpr =270.787 (t)	Vpd =184.716 (t)		
iAs' (cm <sup>2</sup> ) i	0.00	0.00				
iAs (cm <sup>2</sup> ) i	16.25	16.25	DONATI :7ø18/18(X yönü.)+7ø18/18(Y yönü.)			

**T2 TEKÝL TEMELÝ BETONARME SONUÇLARI - S102**

i	x yönü i	y yönü i	I= 2	D= 60 cm	Bx= 120 cm	By= 120 cm
iM max (tm) i	0.00	0.00	Ko= 1000 t/m <sup>3</sup>	qzem= 21 t/m <sup>2</sup>		
iM amp. (tm) i	0.00	0.00	qzx = 0.000 t/m <sup>2</sup>	qzy = 0.000 t/m <sup>2</sup>		
ifcd (kg/cm <sup>2</sup> ) i	0.00	0.00	Vpr =270.805 (t)	Vpd =185.000 (t)		
iAs' (cm <sup>2</sup> ) i	0.00	0.00				
iAs (cm <sup>2</sup> ) i	16.25	16.25	DONATI :7ø18/18(X yönü.)+7ø18/18(Y yönü.)			

**T3 TEKÝL TEMELÝ BETONARME SONUÇLARI - S103**

i	x yönü i	y yönü i	I= 3	D= 70 cm	Bx= 140 cm	By= 140 cm
iM max (tm) i	0.00	0.00	Ko= 1000 t/m <sup>3</sup>	qzem= 21 t/m <sup>2</sup>		
iM amp. (tm) i	0.00	0.00	qzx = 0.000 t/m <sup>2</sup>	qzy = 0.000 t/m <sup>2</sup>		
ifcd (kg/cm <sup>2</sup> ) i	0.00	0.00	Vpr =352.547 (t)	Vpd =318.538 (t)		
iAs' (cm <sup>2</sup> ) i	0.00	0.00				
iAs (cm <sup>2</sup> ) i	21.06	21.06	DONATI :9ø18/16(X yönü.)+9ø18/16(Y yönü.)			

**T4 TEKÝL TEMELÝ BETONARME SONUÇLARI - S104**

i	x yönü i	y yönü i	I= 4	D= 70 cm	Bx= 130 cm	By= 130 cm
iM max (tm) i	0.00	0.00	Ko= 1000 t/m <sup>3</sup>	qzem= 21 t/m <sup>2</sup>		
iM amp. (tm) i	0.00	0.00	qzx = 0.000 t/m <sup>2</sup>	qzy = 0.000 t/m <sup>2</sup>		
ifcd (kg/cm <sup>2</sup> ) i	0.00	0.00	Vpr =351.469 (t)	Vpd =316.461 (t)		
iAs' (cm <sup>2</sup> ) i	0.00	0.00				
iAs (cm <sup>2</sup> ) i	19.94	19.94	DONATI :9ø18/16(X yönü.)+9ø18/16(Y yönü.)			

**T5 TEKÝL TEMELÝ BETONARME SONUÇLARI - S105**

i	x yönü i	y yönü i	I= 5	D= 60 cm	Bx= 120 cm	By= 120 cm
iM max (tm) i	0.00	0.00	Ko= 1000 t/m <sup>3</sup>	qzem= 21 t/m <sup>2</sup>		
iM amp. (tm) i	0.00	0.00	qzx = 0.000 t/m <sup>2</sup>	qzy = 0.000 t/m <sup>2</sup>		
ifcd (kg/cm <sup>2</sup> ) i	0.00	0.00	Vpr =254.422 (t)	Vpd =182.613 (t)		
iAs' (cm <sup>2</sup> ) i	0.00	0.00				
iAs (cm <sup>2</sup> ) i	16.25	16.25	DONATI :7ø18/18(X yönü.)+7ø18/18(Y yönü.)			

**T6 TEKÝL TEMELÝ BETONARME SONUÇLARI - S106**

i	x yönü i	y yönü i	I= 6	D= 60 cm	Bx= 120 cm	By= 120 cm
iM max (tm) i	0.00	0.00	Ko= 1000 t/m <sup>3</sup>	qzem= 21 t/m <sup>2</sup>		
iM amp. (tm) i	0.00	0.00	qzx = 0.000 t/m <sup>2</sup>	qzy = 0.000 t/m <sup>2</sup>		
ifcd (kg/cm <sup>2</sup> ) i	0.00	0.00	Vpr =254.293 (t)	Vpd =181.698 (t)		
iAs' (cm <sup>2</sup> ) i	0.00	0.00				
iAs (cm <sup>2</sup> ) i	16.25	16.25	DONATI :7ø18/18(X yönü.)+7ø18/18(Y yönü.)			