

- 1) Connect the **ESP32** to your PC with USB cable
- 2) Navigate to **Web ESPHome** ( <https://web.esphome.io/> ) [ **Chrome or Edge only** ]
- 3) Click on **CONNECT**

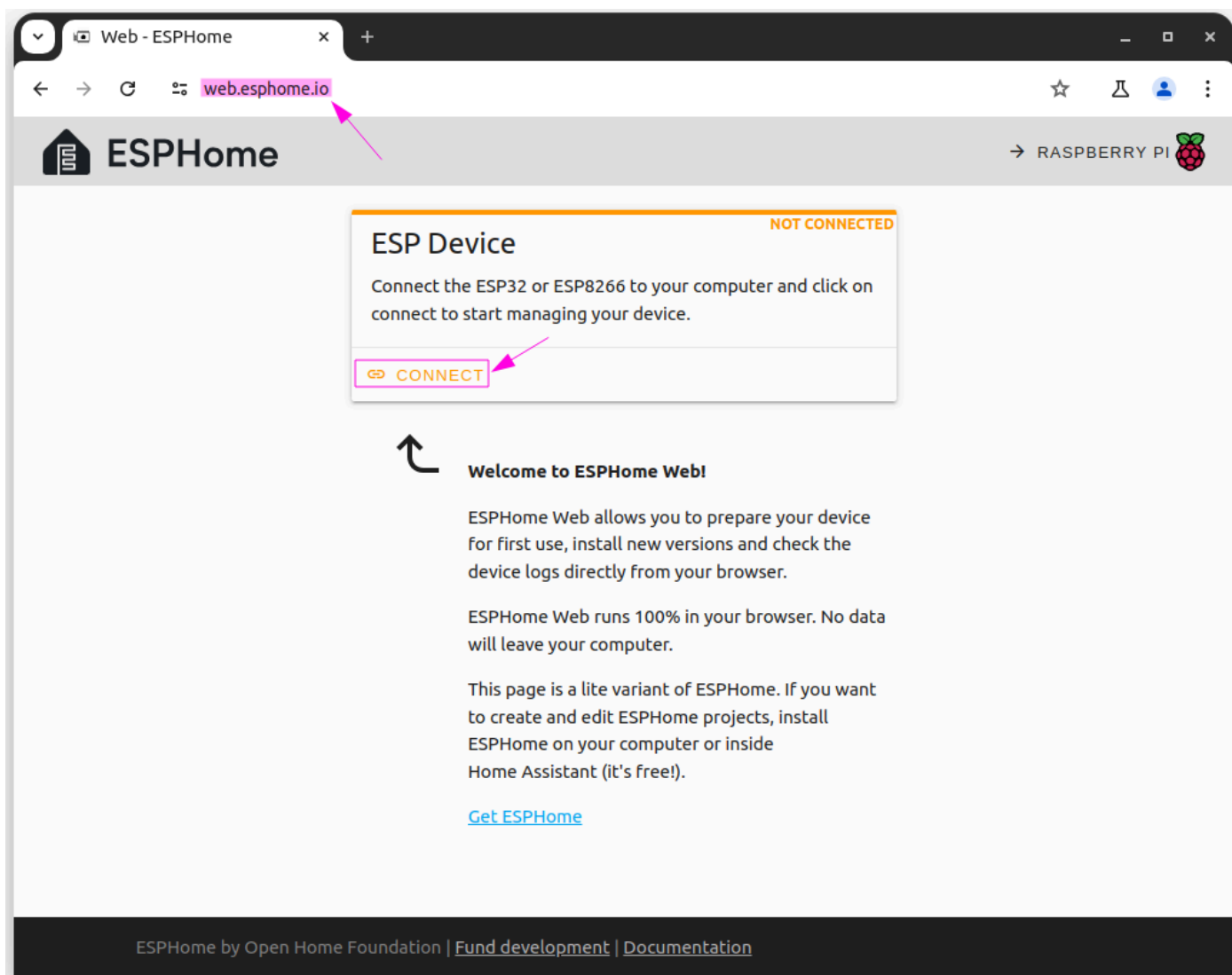

- 4) Choose the COM port of the ESP32 (it may be necessary to install the correct driver)

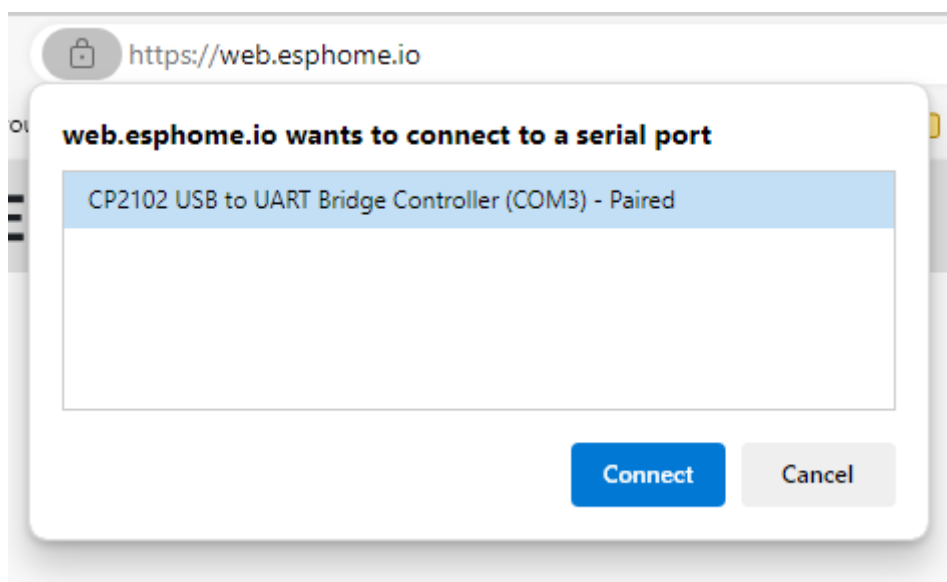

5) Click on **INSTALL**



6) Select the **firmware.factory.bin** file then click on **INSTALL**

- YamBMS\_DEMO\_ESP32.factory.bin

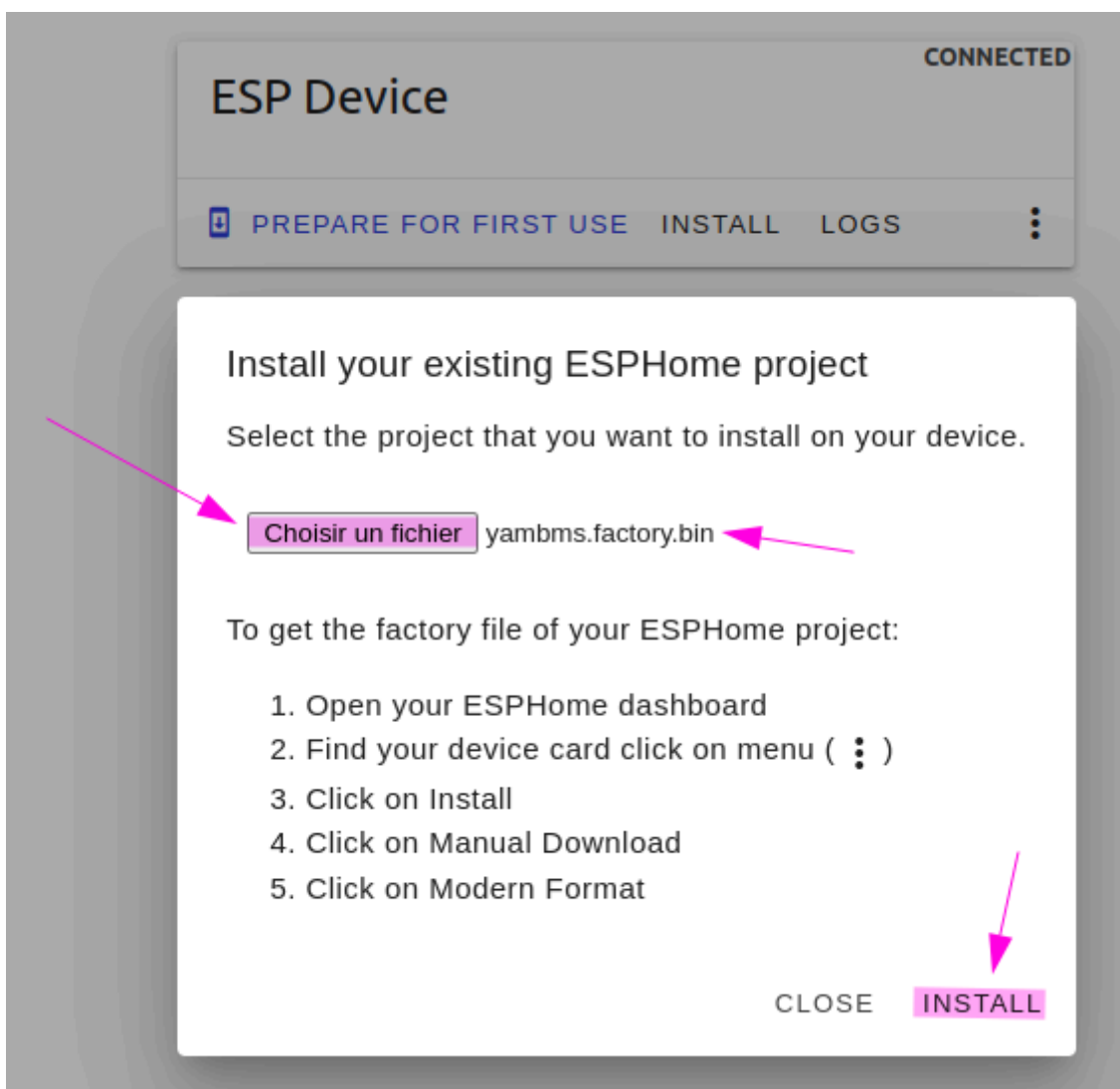

7) Wait and see this message then click on **CLOSE**

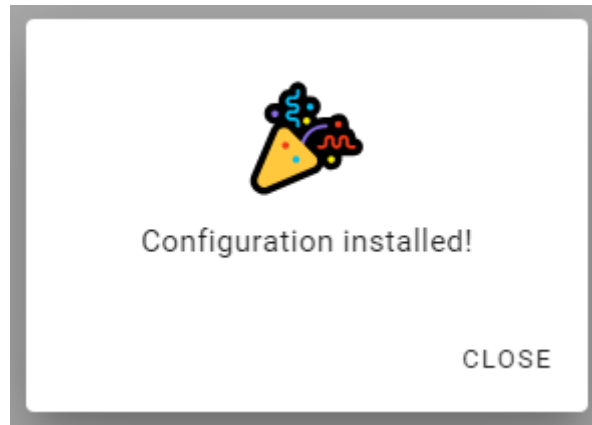

8) The firmware is now installed, click on the **WiFi network** underlined in yellow then on **Connect**

WiFi SSID : **YamBMS Fallback Hotspot**

WiFi password : **Y4mBM\$85**

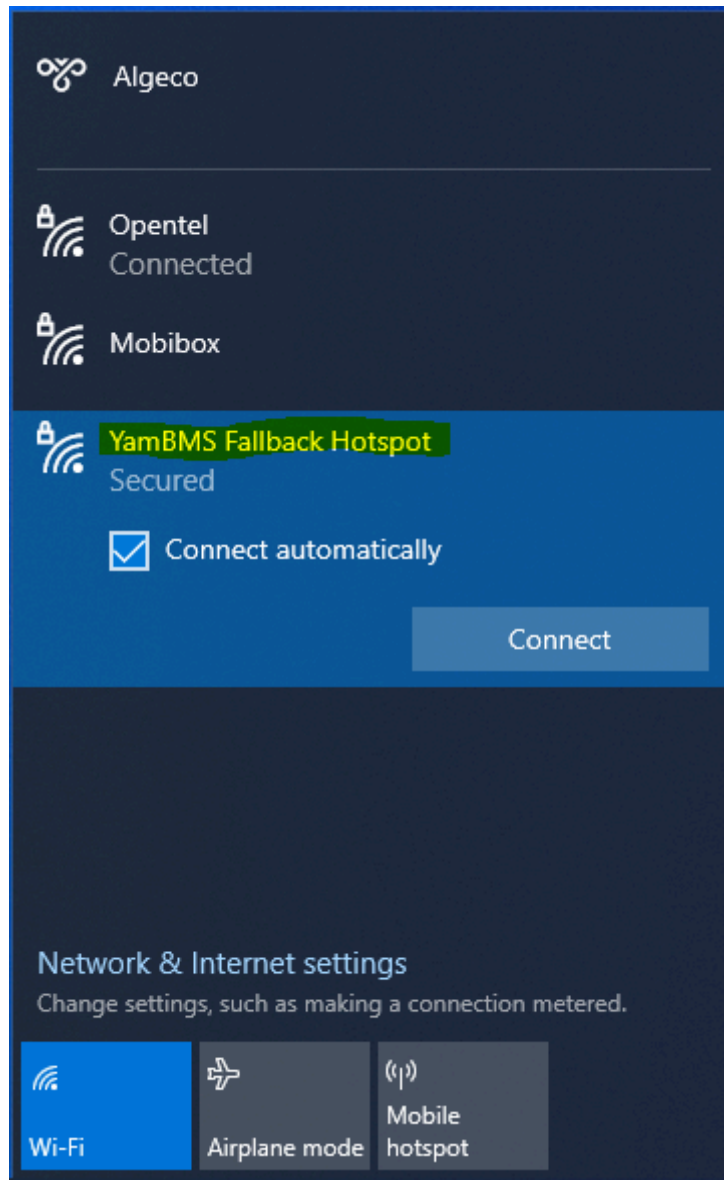

- 9) Go to the web page at : **192.168.4.1**  
Complete the information to connect to your **WiFi network** then click **Save**  
Wait a little, the ESP32 will connect to your WiFi.

esp32devkitv1

Non sécurisé 192.168.4.1

## MAC Address: B0:A7:32:17:06:E0

## WiFi Networks: esp32devkitv1

[Mobibox](#)

[Opentel](#)

### WiFi Settings

SSID

Password

Save

## OTA Update

Choisir un fichier Aucun fichier choisi

Update

The ESP will now try to connect to the network...  
Please give it some time to connect.

10) The ESP32 is discovered in your **Home Assistant** and can be added by clicking on **CONFIGURE**

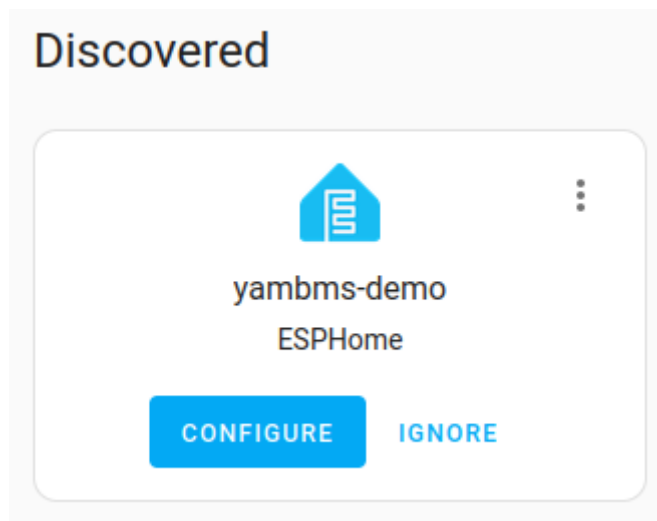

11) Create a new dashboard and **COPY/PAST** the **YamBMS\_HA\_Dashboard\_DEMO.yaml** code

