

E-Test

1. See figure and call the type of rear axle below :

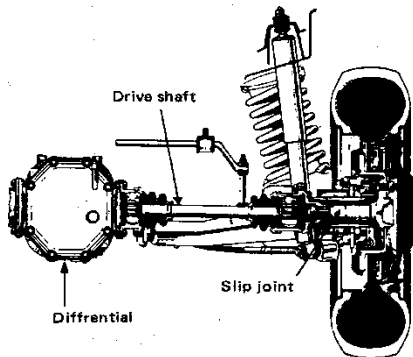

- Floating shaft type
- Full floating type
- Semi floating type
- Three-quarter floating type
- No floating type

2. See figure and call the type of wheel alignment factor below :

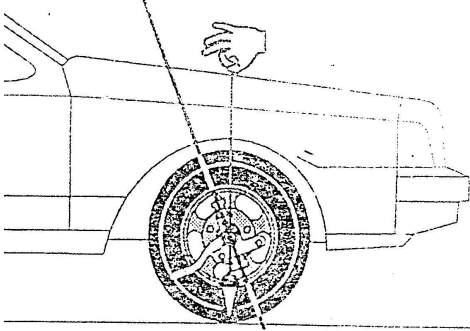

- Camber
- Caster
- King pin
- Toe-in
- Toe-out

3. See figure and call the name 1st and 3rd and 6th component of power train below :

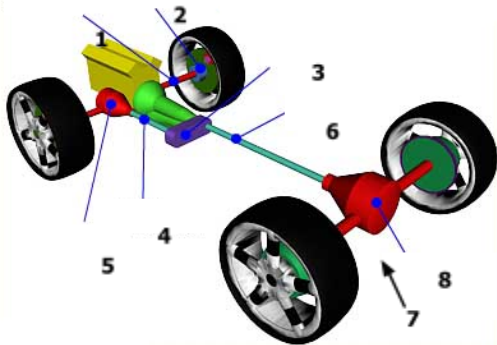

- Front axle, wheel, transmission and rear axle
- Front axle, free wheel hub, transfer and propeller shaft
- Rear axle, transfer, free wheel hub and propeller shaft
- Front axle, transfer, free wheel hub and propeller shaft
- Front axle, free wheel hub, transfer and rear axle

4. See figure and call the name component of clutch below:

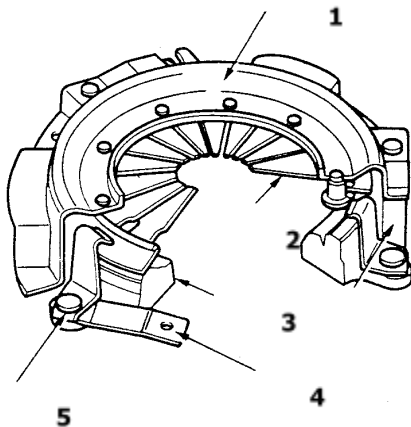

- pressure plate, clutch cover, diaphragm spring, straps and retracting spring
- straps, diaphragm spring, boss, retracting spring and pressure plate
- clutch cover, diaphragm spring, pressure plate, straps and retracting spring
- clutch cover, diaphragm spring, pressure plate, retracting spring and straps
- straps, diaphragm spring, pressure plate, retracting spring and boss

5. The advantage of construction and characteristic diaphragm spring clutch comparison to coil spring clutch is **(except)** :
- a. the aggregate more less
 - b. adjusting more easy
 - c. stress of coil spring decrease on high speed
 - d. the power less for release clutch heavier
 - e. pressure still good even clutch disc wear

6.  Component of clutch mechanism below :

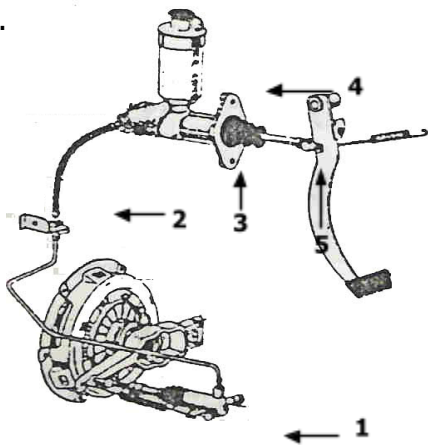

- master cylinder, cable, release cylinder, reservoir and pedal
- wheel cylinder, cable, master cylinder, reservoir and pedal
- release cylinder, flexible hose, master cylinder, reservoir and push-rod
- wheel cylinder, flexible hose, master cylinder, reservoir and push-rod
- push-rod, flexible hose, release cylinder, master cylinder and reservoir

7. An automobile requires a great amount of driving force for ... **(except)** :
- a. starting to move
 - b. accelerating
 - c. climbing hills
 - d. carrying heavy loads
 - e. running on high way